

"Crossroads of
West-central
Illinois"

McDONOUGH COUNTY
HISTORICAL AND GENEALOGICAL
MISCELLANY
1826 - 1976

RURAL CEMETERIES
OF
McDONOUGH COUNTY, ILLINOIS

VOLUME I

ELDORADO & INDUSTRY
TOWNSHIPS

McDONOUGH COUNTY, ILLINOIS

REF. 977.342 L567 V. 1
Lester, Duane.
Rural cemeteries of
McDonough County, Illinois

MID-CONTINENT PUBLIC LIBRARY
Midwest Genealogy Center
3440 S. Lee's Summit Rd.
Independence, MO 64055 **MGC**

MID-CONTINENT PUBLIC LIBRARY

NO-COPYRIGHT PERMISSION
Revised Copyright Form
© 1963 U.S. Govt. Printing Office
Washington, D.C. 20540

RURAL
CEMETERIES
of
MC DONOUGH COUNTY, ILLINOIS

Volume I

Eldorado-Industry

Cookley Cemetery 1-15
Leak Cemetery 16-25
Springer Grove 26-34
Standard Cemetery 35-71
Tall Cemetery 72-75
Vance Cemetery 76-83
Wilhelm Cemetery 84-88
Penniston Family 89

By Duane Lester
Good Hope, Illinois

Printed by
Schuyler - Brown
Historical and Genealogical Society
and
The Schuyler Jail Museum



Volume I

Table of Contents

Preface i - ii

Maps and plats iii - x

Chockley Cemetery 1 - 13

Peak Cemetery 14 - 15

Springer Grave 16

Standard Cemetery 17 - 21

Vail Cemetery 22 - 25

Vance Cemetery 26 - 42

Wilhelm Cemetery 43 - 45

Pennington Family 46

Profess

of McDonough County, Illinois are... graves and gravestones ranging in size... the extensive Oakwood Cemetery at... are the remains of an early... since the first settlers... years ago. Scores of countless others... McDonough County; but... these burial places are no longer... During the early days of this... be obviously for burial grounds; thus... having the reputation of being one of the... the deceased in a grave as a family homestead... a wake-night marker. A number of these family... later became public structures, however, some of... sites soon became "lost". Graves were... increased stone monuments... were collected; scores of families were... in this area only a short time... moved ones shortly became... of families passing through... losses. A prime example... in a history of Ethel Town... an emigrant family died while... they were buried... two miles southwest... long been gone.

"A monument is erected,
not because a person died,
but because a person lived."

at her home in... dressed without... she was buried... no evidence remained... ing place. A family... prairies a few miles north... ily burial site for... graves of about 12... 1900's, the farm changed... new owner removed all... graveyard because... the countless... burial sites. At this time... locations of hundreds of... in this county.

Vandalism is responsible for the destruction of many grave stones. Countless markers have been partially or totally destroyed. Inscriptions have been obliterated by cherted blades. Stones have been broken into dozens of pieces, and some markers have been entirely removed from their original locations.

While weather-wear and vandalism accounts for most of the destruction of individual monuments, neglect is directly responsible for the eventual deterioration of graveyards. Several local cemeteries have had no protective fencing for a number of years and the grounds have become grazing land for livestock. Groundhogs and other burrowing animals have undermined large portions of various cemeteries. Some areas are nearly invisible because of massive growths of weeds and brush. Stones have fallen, broken, and become completely covered with soil and debris.

Proface

Within the boundaries of McDonough County, Illinois are more than a hundred cemeteries and gravesites ranging in size from a single burial site to the expansive Oakwood Cemetery at Macomb. Within these cemeteries are the remains of an estimated 40,000 individuals who have died since the first settler arrived here over 150 years ago. Graves of countless others are scattered over the countryside of McDonough County; but, exact sites of many of these resting places are no longer known for various reasons. During the early days of this county, there were obviously no central burial grounds; thus, a pioneer family having the misfortune of losing one of its members placed the deceased in a grave on a family homestead and erected a makeshift marker. A number of these family burial grounds later became public cemeteries, however, many of the grave sites soon became "lost". Crude wooden markers or a hand engraved stone soon succumbed to the elements and were never replaced; scores of families moved further west after staying in this area only a short time and the gravesites of their loved ones shortly became insignificant mounds of earth; a number of families passing through this vicinity suffered individual losses. A prime example of the latter is contained in a history of Bethel Township. In 1830, four children of an emigrant family died while enroute through McDonough County. They were buried near their places of death which occurred about two miles southwest of Fandon. All traces of those graves have long been gone. During the summer of 1834, a widow lady died at her home in northern Tennessee Township. Her coffin of dressed walnut lumber was built by a local cabinet maker and she was buried in the timber near her home. Within a few years, no evidence remained to indicate the presence of her final resting place. A family who created an excellent farm from the prairies a few miles north of Macomb, maintained a fenced family burial site for several years. This cemetery contained the graves of about 12 former family members. During the early 1900's, the farm changed ownership. Shortly thereafter, the new owner removed all the stones, took down the fence, and this graveyard became part of a cornfield. These are only three of the countless incidents involving the total disappearance of burial sites. At this time, it is impossible to determine the locations of hundreds of individual's graves in this county.

Vandalism is responsible for the destruction of many grave stones. Countless markers have been partially or totally destroyed. Inscriptions have been obliterated by shotgun blasts, stones have been broken into dozens of pieces, and some markers have been entirely removed from their original locations.

While weather-wear and vandalism accounts for most of the destruction of individual tombstones, neglect is directly responsible for the eventual deterioration of graveyards. Several local cemeteries have had no protective fencing for a number of years and the grounds have become grazing land for livestock. Groundhogs and other burrowing animals have undermined large portions of various cemeteries. Some areas are nearly invisible because of massive growths of weeds and brush. Stones have fallen, broken, and become completely covered with soil and debris.

The overall conditions of our county cemeteries is a pathetic case. While some grounds are well maintained, or at least partially kept-up by various families, many have been totally forgotten. This situation is appalling and should never have come about. Apparently, lack of time, expense, and most of all regard has brought about the present-day poor conditions of many of our rural cemeteries.

Genealogical notes accompanying the various cemetery listings were prepared from a wide variety of sources including: Local area history books and atlases; newspaper files; county, state, and federal archives; family histories. These notes were collected at random from readily available sources and little, or no attempts were made to search for material for more complete genealogies. These notes are presented only for the purposes of identification and/or clarification.

Every attempt has been made to present complete and accurate information. Readers will find errors and omissions. Others will not agree with portions of my findings; however, no information contained herein is based solely on assumption or guesswork. It must be remembered that this information has been prepared for use only as a tool for further research and that nothing must be taken as final and absolute.

The larger cemeteries contained in these volumes are accompanied by grave location charts. These charts in no way are intended to represent any professionally prepared plat or survey that may exist. Their preparation and presentation are solely for general location purposes.

When copying inscriptions from grave markers, it is sometimes impossible to read some portions of the engraving. Names, dates, ages, etc. that were found to be unclear or totally missing are indicated by the use of question marks or dashes, i.e., SPICER, James T., infant son of ?J.B. & S.J.?; d. -----; age -----. The letters or numbers enclosed in parenthesis following the inscription, indicate general location as indicated on the accompanying chart.

Abbreviations used are as follows:

b.	born	m.	months
Cav.	Cavalry	md.	married
Co.	County/Company	sec.	section
d.	died/days	twp.	township
dau.	daughter	y.	years
Inf.	Infantry		

Time and space prohibits proper recognition for all those individuals who gave assistance in preparing and publishing these volumes. Deep and sincere appreciation is extended to all concerned, especially to the following: My parents, Mr. and Mrs. Lloyd Lester, and my wife, Rose; and to Mrs. Lavina Walton and other members of the Schuyler County Historical and Genealogical Society for printing and binding the finished product. Thank you.

Duane Lester



Mc Donough County, Illinois

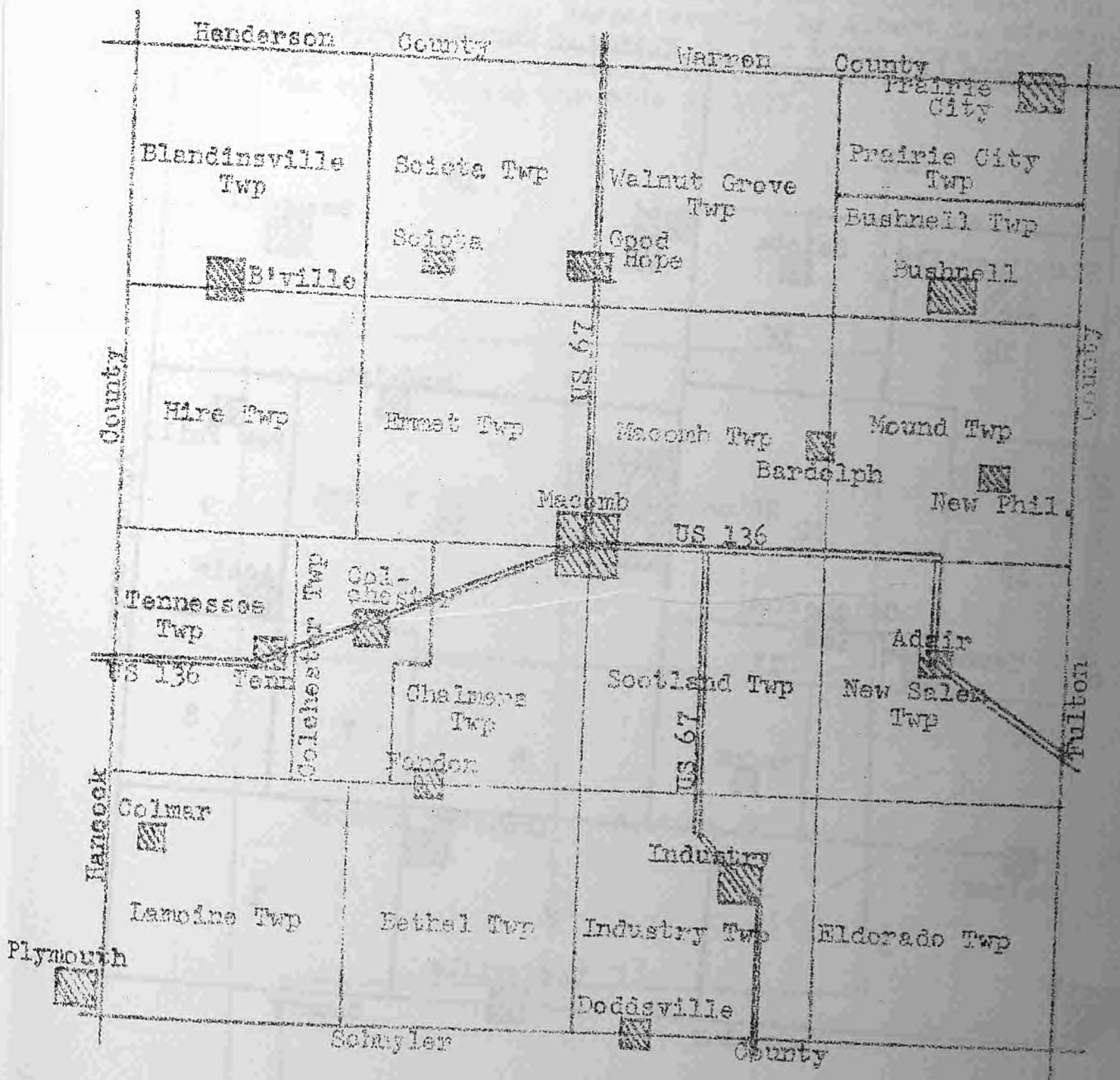

Areas covered by volumes I - XVII
 "Cemeteries of McDonough County, Illinois"

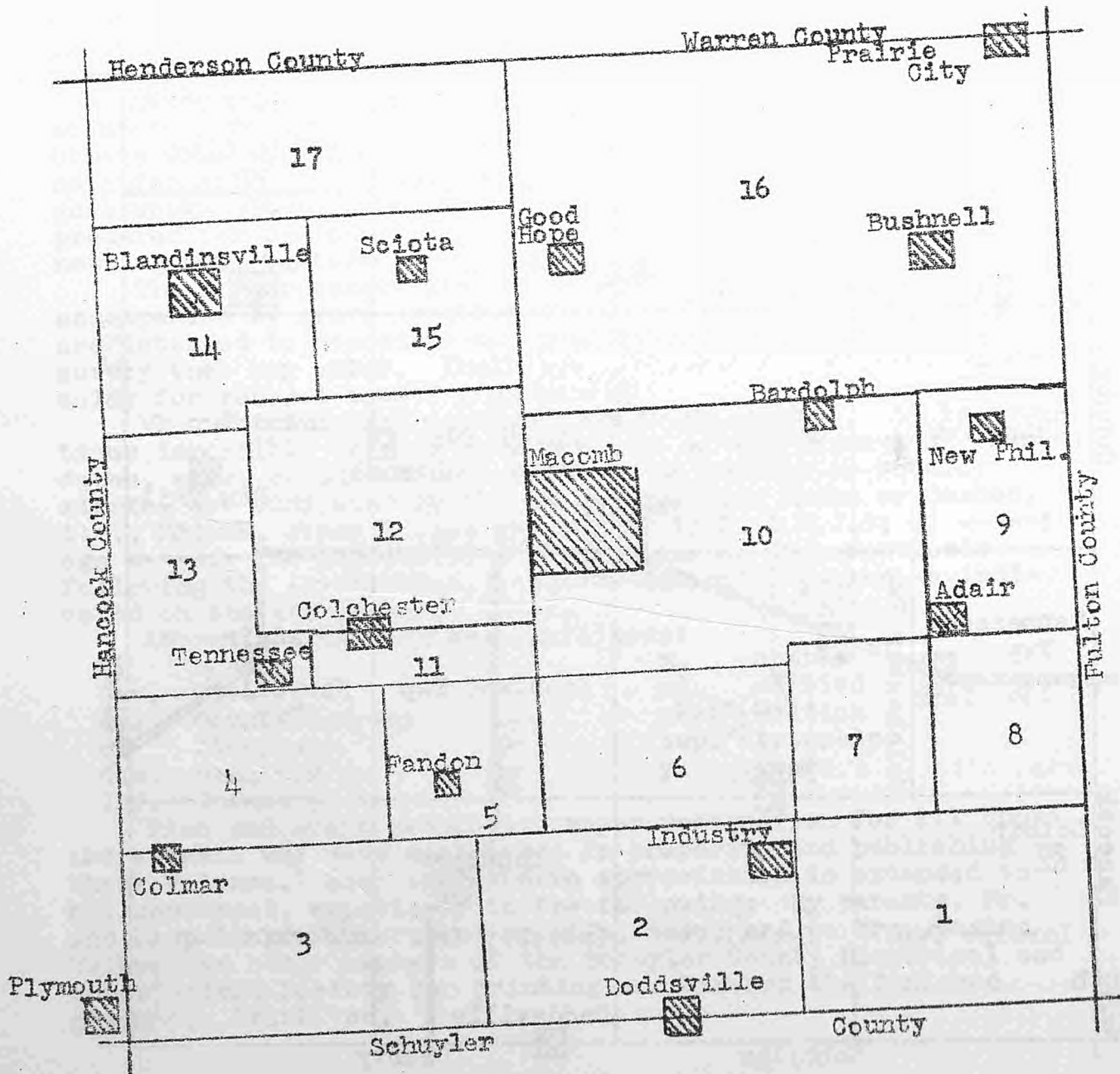

Chockley Cemetery

Location: Eldorado township, near the center of the SE $\frac{1}{4}$ of section 29; $3\frac{1}{2}$ miles east and 2 miles south of Industry.

Remarks: One of the few county owned cemeteries remaining, this cemetery was deeded to McDonough County several years ago and remains under that ownership at this time. The grounds are well maintained on a regular basis. Most stones are standing upright and the majority are completely readable, although several are badly weather-worn. In the northwest section, facing west, are two large monuments that read as follows: "In memory of Pres. Wilson, the unknown American soldier, and the Red Cross Nurse; erected by Albert L. Adams, 1926". The other reads, "In memory of the brave boys who did not come home from the World War; erected by Albert L. Adams, 1921." This registration was made in 1975.

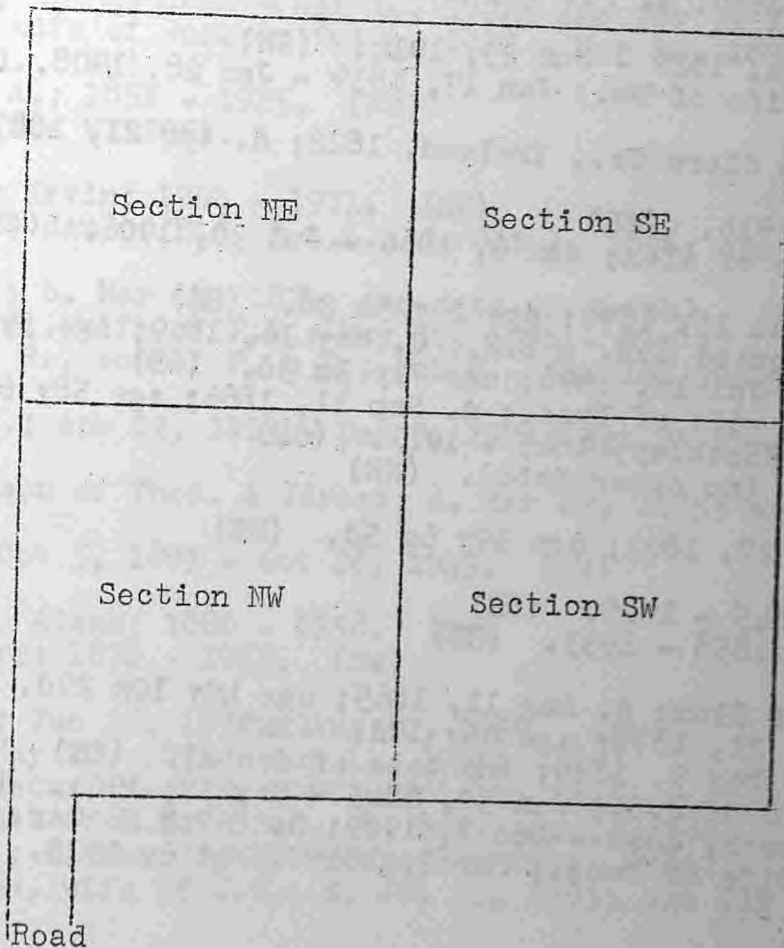
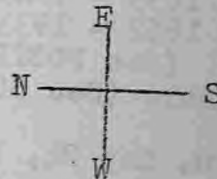

ABBOTT:
E-----, wife of James W.; d. Feb 13, 1864; age 37y. (NE)

ADAMS:
Jasper M.; Mar 26, 1857 - Jan 24, 1944. (NW)
Minnie M.; Feb 7, 1865 - Jan 11, 1944. (NW)
Frank W., son of J.W. & M.J.; d. Mar 23, 1894; age 11y 5m 25d. (SE)
Albert L.; Jul 16, 1850 - Sep 28, 1926. (SE)
Nancy A. Chockley, wife of A.; Oct 26, 1850 - Apr 26, 1911. (SE)
Nellie M., dau of A.L. & N.A.; d. Jan 7, 1899; age 13y 11m 14d. (SE)
Mary E., dau of A.L. & N.A.; Dec 18, 1881 - Oct 21, 1882. (SE)
Fern, dau of A.L. & N.A.; d. Feb 15, 1892; age 10m 16d. (SE)
Leona, dau of A.L. & N.A.; d. Jan 1, 1899; age 5y 5m 9d. (SE)
H.; Apr 6, 1806 - Oct 2, 1872. (SE)
Mary, wife of H.; Jun 26, 1813 - Feb 5, 1899. (SE)
Alex; (no dates); Co F 84th Ill Inf. (SE)
Mary J.; 1855 - 1943. (SW)
John W.; 1852 - 1933. (SW)
Alice M. (See FOSTER).
Lillie Mable (See SOWERS).

BAKER:
Andrew; d. Sep 24, 1854; age 41y 1m 24d. (NE)

BEAIRD:
Emma, wife of John; d. Feb 19, 1849; age 20y 4d. (NE)

BEGHTOL:
William; Aug 24, 1829 - Jun 23, 1914. (SW)
Martha Jane, wife of Wm.; Jan 17, 1839 - Jan 28, 1908. (SW)

BRADY:
Patrick; b. in Clare Co., Ireland, 1822; d. Apr 21, 1887. (NE)

BROOKS:
Alex; 1853 - 1916. (SE)
Sarah J., wife of Alex; Jun 6, 1866 - Jul 30, 1906. (SE)

BROWN:
John M.; d. Jan 15, 1870; age 29y 5m 3d. (SE)
Charlie R., son of J.M. & S.E.; d. May 16, 1869; age 5y 20d. (SE)
Thomas C.; d. Jul 18, 1896; age 79y 3m 3d. (SE)
Elizabeth C., wife of Thos.; d. Sep 11, 1866; age 58y 6m 6d. (SE)
Elizabeth J. Chockley; 1845 - 1911. (SE)
James; 1847 - (no other date). (NE)

BRYANT:
John; d. Mar 27, 1893; age 19y 6m 5d. (NE)

CASTER:
Hugh Knox; 1845 - 1926. (SE)
Annie Eliza; 1858 - 1933. (SE)

CHOCKLEY:
Jane, wife of Elam; d. Aug 11, 1865; age 49y 10m 29d. (SE)
Elam; d. Feb 21, 1878; age 65y 19d. (SE)
James E.; b. Nov 9, 1836; (no date of death). (SE)
Mary J., wife of J.E.; Jan 30, 1845 - May 17, 1904. (SE)
Benjamin; Apr 2, 1842 - Dec 7, 1909; Co B 7th Mo Cav. (SW)
Catherine, wife of Benj.; Mar 2, 1846 - Mar 6, 1920. (SW)

CHOCKLEY (cont'd):

Martha A.; 1869 - 1916. (SW)

Elma, dau of B. & C.; d. Feb 14, 1886; age 2y 2m 13d. (SW)

Bennie, son of O.R. & M.P.; Aug 31, 1906 - Mar 26, 1907. (SW)

Gladys; Jul 16, 1909 - Dec 1, 1967. (SW)

William W.; Nov 10, 1909 - Nov 8, 1962. (SW)

Mary; 1882 - 1964. (SW)

Ordra; 1879 - 1962. (SW)

Eliza A.; b. Apr 13, 1838; (no date of death). (NE)

William R.; May 28, 1848 - Oct 31, 1885; age 37y 5m 3d. (NE)

Iney C., dau of R. & F.; d. Mar 4, 1872; age 3y 7m 27d. (NE)

Joel Edgar, son of R. & F.; d. Dec 15, 1881; age 19y 11m 3d. (NE)

Richard; Apr 24, 1816 - Apr 28, 1890. (NE)

Fidila, wife of R.; Mar 16, 1823 - Oct 31, 1892. (NE)

Ethelbert, son of T.W.; 1877 - 1878. (SW)

Nancy A. (See ADAMS).

Elizabeth J. (See BROWN).

COLIARD:

W. S.; 1847 - 1912. (SW)

Elizabeth, wife of W.S.; 1832 - 1915. (SW)

COX:

John F.; 1892 - 1941. (SW)

Carl D.; 1914 - 1934. (SW)

DAVIDS:

Joseph; Sep 3, 1822 - Apr 14, 1902; age 78y 7m 11d. (NW)

Emily, wife of Joseph; Oct 4, 1828 - Mar 12, 1899; age 70y 5m 8d. (NW)

Joseph A.; 1851 - 1925. (NW)

Emily (See WILSON).

DEAN:

William Irvin; 1904 - 1971. (NW)

Ella M., dau of E.S. & A.L.; d. Oct 1, 1896; age 1y 6m 1d. (NW)

EASLEY:

Fred C.; b. Mar 18, 1874; (no date of death). (NW)

Hettie J., wife of F.C.; May 30, 1876 - Feb 17, 1902. (NW)

Freeman R., son of F. & H.; Feb 8 - Aug 18, 1902. (NW)

EDDINGTON:

Cecil E.; Apr 12, 1913 - Dec 9, 1971; Sgt US Army WWII. (NW)

EDGER:

Paoli, son of Thos. & Idress; d. Mar 29, 1875; age 1y. (SE)

ENGLE:

Katie; Oct 5, 1893 - Oct 28, 1945. (SW)

FOSTER:

Alice M. Adams; 1880 - 1958. (SW)

C. Edward; 1876 - 1955. (SW)

FOWLER:

Anna H.; Jun 25, 1872 - Aug 31, 1959. (SW)

Homer; May 18, 1871 - Jun 11, 1901. (SW)

Susan Justus; Mar 19, 1860 - Jul 12, 1895. (SW)

Infant dau of P.S. & S.M.; b. & d. Apr 13, 1883. (SW)

Jesse B.; d. Mar 20, 1900; age 78y 20d. (SE)

Catherine, wife of J.B.; d. Jul 24, 1903; age 73y 7m 16d. (SE)

FOWLER (cont'd):

Leila Z.; 1889 - 1907. (NE)

Orrin R.; 1891 - 1908. (NE)

(Latter 2 were children of H. & D. Fowler)

Huram; 1855 - 1934. (NE)

Delila Hills, wife of Hiram; 1867 - 1926. (NE)

Cyrena (See NELSON).

GORSUCH:

Larkin; Nov 20, 1865 - Jun 21, 1950. (NW)

Alzina; Nov 24, 1863 - Aug 28, 1905. (NW)

Anna, dau of J.S. & I.A.; Jun 12, 1883 - Oct 21, 1896. (SE)

Infant dau of J.S. & I.A.; b. & d. Sep 16, 1890. (SE)

Ralph E.; son of J.S. & I.A.; Feb 19, 1887 - Aug 4, 1887. (SE)

Jonah N.; son of J.S. & I.A.; Dec 12, 1895 - Sep 17, 1898. (SE)

J. S.; 1853 - 1928. (SE)

Ida A., wife of J.S.; 1859 - 1926. (SE)

HAYES:

Lulu M., dau of G. & S.J.; Jan 21, 1892 - Aug 22, 1899. (NW)

HAYS:

Aris; d. Jun 23, 1889; age 90y 8m 17d. (NE)

HEATON:

Inez Ada; 1884 - 1917. (SW)

Albert L.; 1880 - 1969. (SW)

HILLS:

John T.; 1841 - 1919; Co C 7th Mo Cav. (NE)

Martha A.; 1852 - 1917. (NE)

Mary E.; 1842 - 1888. (NE)

Delila (See FOWLER).

JUSTUS:

Thomas M.; d. Jan 23, 1881; age 32y 4m 18d. (SW)

Susan (See FOWLER).

KEE:

Locky M., dau of A.J. & S.; d. Feb 29, 1856; age 2m 6d. (NE)

Sarah (See LAWYER).

KEERAN:

J. William; 1869 - 1919. (SE)

S. Anna; 1870 - 1945. (SE)

KENNEDY:

Nelson D.; 1897 - 1972. (SW)

Katie Nelson; 1871 - 1934. (SW)

LANCASTER:

Suphrona; 1843 - 1918. (NW)

Thomas J.; 1840 - 1931. (NW)

L. Ross; 1868 - 1955. (NW)

Emma; 1877 - 1972. (NW)

LAWYER:

Elvy; 1890 - 1900. (NW)

Ronald L.; Mar 29 - Apr 18, 1905. (NW)

Dallas; 1868 - 1945. (NW)

Jessie; 1870 - 1948. (NW)

Avanel E., dau of Charlie & Nora; 1894-1895; age 1y 6m 3d. (NW)

A. Carl; 1866 - 1934. (NW)

LAWYER (cont'd):

- Nora E.; 1869 - 1932. (NW)
Ivan David; 1919 - 1942. (NW)
-----; d. 1942. (NW)
Emisiah, son of M. & S.E.; d. Feb 2-, 1861; age 6m 9d. (NE)
Isaac Luther, son of M. & S.E.; d. Aug 31, 1863; age 1y 10m 1d. (NE)
Sarah Kee; 1834 - 1865. (NE)
George; Apr 12, 1881 - Apr 9, 1935. (NE)
Jacob; Dec 7, 1832 - Jan 6, 1928. (NE)
Nancy E., wife of J.; Dec 31, 1841 - Dec 14, 1915. (NE)
Walter; Nov 7, 1872 - Nov 5, 1879. (NE)
Alma W.; Mar 15, 1862 - Sep 19, 1863. (NE)
Alonzo Pinson, son of W. & J.A.; d. Jan 30, 1863; age 7y 3m 8d. (NE)
Henry Melvin, son of W. & J.A.; d. Jan 27, 1863; age 3y 4m 11d. (NE)
George Milton, son of Wm. & J.A.; d. Oct 21, 1861; age 8y 2m 6d. (NE)
Mary E.; d. Feb 15, 1843; -age 84y. (NE)
John; Apr 23, 1801 - Aug 22, 1883; age 82y 3m 29d. (NE)
Massa; Dec 28, 1804 - May 13, 1887; age 82y 5m 15d. (NE)
Martha E.; Jun 27, 1845 - Oct 17, 1850. (SE)
Jefferson; Jun 6, 1834 - Feb 10, 1855. (SE)
Mary J.; Dec 12, 1842 - Jan 12, 1857. (SE)
Abigail E.; Oct 12, 1840 - Mar 3, 1859. (SE)
Linnie M., dau of M. & S.E.; d. Apr 23, 1875; age 2y 11m 20d. (SE)
Anna Ellen, dau of T. & C.; d. Sep 21, 1863; age 7m 19d. (SE)
Thomas; d. Dec 14, 1891; age 65y 7d. (SE)
Cathrine, wife of Thos.; d. Mar 4, 1908; age 75y 2m 25d. (SE)
Luther, son of J.R. & M.E.; d. May 4, 1878; age 1y 1m 16d. (SE)
- LOVELL:
John H., son of J.D. & N.; d. Mar 27, 1865; age 24y 11d; Co D 124th Ill Inf. (SE)
- MARR:
Henry D., son of B. & S.J.; d. Aug 7, 1870; age 1m 17d. (NW)
J. B.; Jun 19, 1800 - May 10, 1884. (NE)
Hapsebeth; Oct 9, 1800 - Sep 16, 1868. (NE)
- MATHENY:
John; d. May 7, 1904; age 64y. (NE)
- MC DONALD:
Franklin, son of S. & A.; d. Aug 31, 1876; age 16y 11m 7d. (SE)
- MERRICK:
Mary Elsie, dau of M.C. & L.M.; Jan 25, 1896 - Aug 10, 1902. (NW)
- MICKEY:
William; d. Apr 16, 1856; in the 16th year of his age. (SE)
William, son of J. & M.; d. Aug 27, 1855; age 3m 9d. (SE)
- MILLER:
Stella, dau of Elmore & Ida; May 28, 1895 - Oct 28, 1898. (NE)
Elmore; 1870 - 1946. (NE)
Ida Irene; 1878 - 1934. (NE)

NELSON:
 Edith; 1878 - 1964. (SW)
 Alice; 1880 - 1950. (SW)
 Clara; 1873 - 1928. (SW)
 John; 1823 - 1899. (SW)
 Cyrena Fowler, wife of John; 1848 - 1907. (SW)
 Altie; b. & d., 1876. (SW)
 Katie (See KENNEDY).

PEAK:
 Robert; 1842 - (no date of death); Co G 62d Ill Inf. (NW)
 Eliza J., wife of Robt., 1847 - 1912. (NW)

POWELL:
 Melva Marie; 1942 - 1944. (NW)

PRATHER:
 Julia Emma Lee; 1924 - 1949. (NW)
 Ruth Ann, infant; 1936. (NW)
 Elvire; 1902 - 1958. (NW)

PRICE:
 George L.; 1858 - 1935. (NW)
 M. Etta; 1865 - 1956. (NW)
 John; Oct 23, 1830 - Mar 21, 1896. (NW)
 Mary Ellen, wife of John; Oct 19, 1838 - Jan 1, 1873. (NW)
 Freddie E., son of J. & M.J.; d. Nov 4, 1861; age 7m 4d. (NE)

RILEY:
 Thomas; d. Dec 14, 1906; age 71y. (NE)

ROBINSON:
 J. T.; (no dates). (NW)
 Sarah E., wife of J.T.; d. Jul 27, 1902; age 28y 8m 1d. (NW)
 Ilda G., dau of J. & S.; d. Mar 27, 1899; age 1y 4m 23d. (NW)

RUSSELL:
 Eve E.; d. Dec 16, 1866; age 48y 8m 29d. (NE)
 Mathew W., son of J. & E.; d. Sep 20, 1860; age 17y 7m 2d. (NE)

SANDIDGE:
 Permelia L., dau of D. & P.; Aug 25, 1836 - Jan 28, 1845. (SE)
 Permelia, wife of Dan'l; Mar 9, 1803 - Feb 11, 1845. (SE)
 Daniel; Feb 23, 1804 - Aug 5, 1882. (SE)
 George, son of Joshua & Mary; d. Oct 2, 1854; age 2y 3m 3d. (SE)
 Ervin M.; d. Feb 7, 1890; age 45y 11m 20d. (NE)

SCHRODER:
 Louisa, wife of C.; d. May 24, 1864; age 38y 10d. (SE)
 Christopher; d. Dec 12, 1883; age 67y 4m 6d. (SE)

SELLERS:
 William H.; d. Aug 16, 1874; age 14y 11m 12d. (NE)

SHARP:
 George & Remina; (small metal markers; nearly unreadable). (NW)

SOWERS:
 Lillie Mable Adams, wife of Noah Isaac; 1889 - 1918. (SW)

STAMBAUGH:
 Emily Maree, dau of A.B. & L.M.; Sep 7, 1898 - Dec 4, 1902. (NW)
 Arthur B.; 1867 - 1937. (NW)
 Lovena M.; 1870 - (no date of death). (NW)
 George; d. Apr 19, 1856; age 39y 3m 4d. (SE)

STOCKTON:

Daniel; Aug 17, 1800 - Jan 28, 1883. (NE)
Frank; 1857 - 1922. (NW)
Nattie, wife of Frank; 1861 - (no date of death). (NW)
Rebecca; 1863 - 1890. (NW)
Nellie, infant of F. & R.; d. 1887. (NW)
Sarah; 1808 - 1899. (NW)

SWEARINGEN:

Hugh L.; 1849 - 1926. (SW)
Mary A., wife of Hugh; 1858 - 1933. (SW)

TOLAND:

Addie; 1894 - 1962. (NW)
Clara A. Swift; 1864 - 1943. (NW)
S. Ernest; 1860 - 1929. (NW)
Freddie, son of S.E. & C.A.; Nov 9, 1884 - Jul 2, 1889. (NW)
Infant son of S.E. & C.A.; Dec 7, 1888 - Jan 3, 1889. (NW)
Angeline, wife of John; 1856 - 1931. (NW)
John; 1853 - 1896. (NW)
Sarah E., dau of W.J. & S.; d. Jun 3, 1846; age 8y 5m 3d. (NE)
Infant dau of W.J. & S.; d. Apr 12, 1846; age 18d. (NE)
Lillian; 1868 - 1943. (NE)
Milton; 1862 - 1939. (NE)
Earl; Dec 11, 1886 - Nov 10, 1888. (NE)
Lela; Nov 28, 1887 - Oct 27, 1888. (NE)
(Latter 2 were children of M. & E. Toland)
J. Newton; 1860 - 1936. (SE)
Carl E., son of J.N.; 1889 - 1919. (SE)
Sara E., wife of J. B.; d. Nov 12, 1871; age 23y 8m 23d. (SE)
J. B. (no dates); Sgt Co H 12th Ill Cav. (SE)
George F., son of W.J. & E.H.; d. Nov 16, 1871; age 20y 5m
11d. (SE)
J. T., son of W.J. & S.; d. Jun 3, 1865; age 24y 2m 21d; Co
B 84th Ill Inf. (SE)
Sarah, wife of W. J.; d. Aug 30, 1846; age 31y 10m 26d. (SE)
Eliza, wife of W. J.; Jul 1, 1831 - Sep 2, 1885; age 54y 2m
1d. (SE)
Thomas; d. 1863; age 43y; Co B 7th Mo Cav. (SE)
Mary A., wife of Thos.; d. Jul 9, 1897; age 75y 20d. (SE)
Infant son of J. Newton; d. Dec 20, 1890; age 7d. (SE)

VINCENT:

John T.; Oct 12, 1870 - Aug 26, 1939. (SE)
Tina C., wife of John; Feb 28, 1873 - Dec 24, 1952. (SE)
Elbia E.; Oct 11, 1902 - Apr 29, 1918. (SE)
Herbert & Harold; Dec 20 - 21, 1907. (SE)
Mary E.; Jan 1 - 15, 1912. (SE)

WALKER:

Tennessee, wife of J.F.; Apr 18, 1874 - Jun 23, 1901. (NE)
Harry L., son of J.F. & T.; b. Sep 29, 1895; d. in France,
Jan 13, 1919. (NE)
Elza Glee, son of J.F. & T.; Jun 20 - Jul 1, 1901. (NE)

WILSON:

Emily Davids; 1857 - 1946. (NW)

WYCKOFF:

Russell; 1867 - 1942. (SW)
Anna H., wife of Russell; 1872 - 1959. (SW)
Harold H.; 1906 - 1927. (SW)

YOUNG:

Myrtle, dau of J.P. & M.A.; d. Mar 19, 1881; age 2y 5m 26d.
(SW)
Ann, wife of J.P.; 1852 - 1893. (SW)
Willis; Nov 16, 1880 - Dec 31, 1910. (SW)

Genealogical Notes - Chockley Cemetery

ABBOTT: Elizabeth (1827-1864) was the wife of James W.; she was b. in Ind.; md. James & had the following children: Mary (b. 1848); John (b. 1850); David (b. 1851); Francis (b. 1853); Lucetta (b. 1856); & William (b. 1857). All the children were born in Ill.

ADAMS: Alexander, son of Hawthorne and Mary (Wirts) Adams; b. in Beaver Co., Pa., 1838; to Fulton Co., Ill., 1851; to Eldorado Twp., this county, in 1866; settled on section 28. Entered service in Aug., 1862; served 3 years; wounded at Elk River, Tenn.

Nellie M. (1885-1899) was a daughter of Albert & Nancy A. Adams. (Death notice, in part, from The Macomb Times; Jan 19, 1899): "Al Adams' little daughter died with diphtheria, Sunday.....The school in that district has been closed on account of this disease."

BEGHTOL: William (1829-1914) b. in Bullitt Co., Ky.; son of Abraham & Sarah (Pohon) Beghtol; grandson of Henry & Elizabeth (Horine) Beghtol and Wm. & Elizabeth (King) Pohon. Wm. Pohon was b. in England. Wm. Beghtol moved to Schuyler Co., Ill. in 1853; then to this county in 1854; bought 160A in Eldorado Twp.; md. Apr 25, 1854, to Martha J. Swink; had the following children: Ballard (moved to Dodge City, Kan.); Maria (Mrs. Meador); George W.; Alice; Abigail (Mrs. Miller); Samuel E.; Ulysses G.; and Anna. The latter two children died in infancy. In 1873, Mr. Beghtol went to Rocky Ford, Colo. and worked with his brother-in-law, Geo. W. Swink, for 3 years; returned to this county & resumed farming; moved to Industry in about 1897.

BROOKS: Sarah J. (1866-1906), wife of Alex, died after giving birth to twins in Eldorado Twp.; one of the twins, Tina Marie, died in October. (Death notice, in part, from The Macomb By-Stander, Oct 17, 1906): "Tina Marie Wilson died at the home of Hugh Wilson, one and a half miles east of Industry Monday evening at 4:50 o'clock, aged about ten weeks.interment at Chockley cemetery. The baby was a daughter of Mr. and Mrs. Alexander Brooks, but the mother having died,

Mr. and Mrs. Roy Wilson of Littleton adopted the infant, giving it their name. It was sick about ten days This baby girl was one of a pair of twins." NOTE: No stone was located for this child.

BROWN: Thomas C. (1815-1896) was a native of Ky., his wife, Elizabeth (1808-1866) was b. in Virginia; son, John H. (1840-1870), also born in Ky.

CHOCKLEY: Elam (1813-1878) b. in Ky.; wife, Jane, a native of Ky.; in 1860, 11 of their children were living with them, all b. in Ill.; they were: Elijah (b. 1837); James (b. 1839); John (b. 1841); Wm. (b. 1843); Burril (b. 1844); Eliza (b. 1846); Thos. (b. 1848); George (b. 1851); Fountain (b. 1854); and Franklin and Mary (twins - b. 1860). Elam appears as # 512 on the 1840 county tax list. He owned \$80.00 worth of horses, \$55.00 cattle, and \$91.00 in other property; no real estate; taxes were \$1.13.

Richard (1816-1890) b. in Ky.; Fidelia, wife of Richard, and all of their children, b. in Ill.; the children included: Benjamin (b. 1842); Betsey (b. 1845); Wm. (b. 1849); Nancy (b. 1850); Agnes (b. 1854); Clementine (b. 1856); Ellen (b. 1858); Joel (b. 1862); and Iney (b. 1868).

Catherine (1846-1920), wife of Benj. F.; md. May 24, 1866; daughter of Moses J. and Sarah Ann (Peak) Justus.

COLIARD: Elizabeth (1832-1915). (Obit, in part, from The Macomb Daily Journal, Oct 12, 1915): "..... died Monday night at 10:45 at the home of her nephew, Geo. Beghtol, of near Industry. The cause of death was heart trouble with which she has suffered for some time. Her age was 83 years, 1 month, and 25 days..... Elizabeth, daughter of Abraham and Sarah Beghtol, was born in Ky., Aug 16, 1839, and later moved to this State, where she was united in marriage to W. S. Coliard, now deceased, in 1867. No children were born to this union"

EASLEY: Fred C., son of Mark B. and Sarah Jane (Chipman) Easley; b. in this county; Mark b. in 1844 in Fulton Co., Ill.; Sarah b. in Schuyler Co., Ill., a daughter of Levi and Delilah (Cook) Chipman).

FOWLER: Jesse B. (1822-1900); b. in Ky.; son of Thos. J. and Mary (Fowler) Fowler; md. Catherine Bruner.

Catherine (1830-1903); b. in Ky.; daughter of Jacob and Maria (Beghtol) Bruner; md. Jesse B. Fowler.

Susan (1860-1895), daughter of Moses J. and Sarah Ann (Peak) Justus; md. Peter S. Fowler, Dec 25, 1879.

HAYS: Aris (1798-1889), b. in S. Carolina; moved to this State prior to 1830; lived in Eldorado Twp.; in 1860, Mr. Hays was living in the J. B. Marr household in Eldorado Twp.; the 1860 federal census indicated that Mr. Hays was blind.

JUSTUS: Thomas M. (1848-1881), son of Moses Jefferson and Sarah Ann (Peak) Justus; Thos. b. in Ill. and was a brother to Catherine (Mrs. Benj. Chockley); Mary (Mrs. James F. Coker); William; Jane; Margaret; Cassey Jane (Mrs. John W. Carter); Susan M. (Mrs. Peter S. Fowler). Moses and Sarah were md. in Schuyler Co., Ill., Dec 28, 1843.

LAWYER: Thomas (1826-1891) b. in Fayette Co., Ohio, Dec 7, 1826; son of John and Massie (Cooper) Lawyer; moved to this county, 1837; Thos. md., Jan 15, 1852, to Catherine Comer; they had 7 children: John R. (moved to Seward Co., Nebr.); Frank P.; James N.; Joseph F.; Mary P. (Mrs. Wm. Moore); Emma; Charles; and Annie (d. 1863).

Catherine (1832-1908), wife of Thos.; daughter of Robert and Nancy (Wilkinson) Comer, both natives of Ohio; Mr. and Mrs. Comer are buried in the Vance Cemetery.

Jacob (1832-1928); son of John and Massie Lawyer; md. Nancy E. Standard; they had 9 children: Arthur E., Alvin C., Dallas, Alva L., Shered, Franklin, George, Alma W., & Walter.

John (1801-1883), a native of Va.; lived and md. in Ohio to Massie Cooper; moved to this county in 1837; had 7 children; Thomas (b. 1826); William (b. 1829); Jacob (b. 1832); Jefferson (b. 1834); M. V. (b. 1836); and 2 others. John appears on the 1840 county tax list as # 490. He owned \$260.00 worth of horses, \$60.00 cattle, \$10.00 clocks and watches, \$80.00 wagons, and \$115.00 in other property; no real estate; taxes were \$2.63.

Sarah (1834-1865), wife of Michael Lawyer; she was a native of Ohio and md. Mr. Lawyer Sep 27, 1857; had 4 children: Emisiah, Isaac Luther, William K. and another. After the death of Sarah in 1865, Michael remarried, in 1868, to Minerva Downen, widow of David Downen. Michael Lawyer died in 1898 and was buried at Vance Cemetery.

Elvy (1890-1900) (Death notice, in part, from The Bardolph News, Nov 21, 1900): "Elva, the 10-year-old daughter of Mr. and Mrs. Dal Lawyer, of Eldorado Twp., was burned to death on Wednesday of last week. Mr. Lawyer set fire to a heap of corn cobs in his hog lot. Children from the schoolhouse nearby, among whom was the little victim, were playing about the fire during Mr. Lawyer's absence. Little Elva's clothes became ignited and before the flames could be quenched she received injuries which resulted in death."

- LAWYER (cont'd): Alonzo, Henry, and George were sons of Wm. and Julia Ann Lawyer; Wm. was a carpenter, b. in Ohio, a son of John and Massie Lawyer. Wm. and Julia had another son, James, b. in 1858. Mrs. Lawyer and all of their children were b. in Ill.
- KENNEDY: Katie (1871-1934) was a daughter of John and Serena (Fowler) Nelson; b. in this county; md. Wm. Kennedy.
- MARR: Jonathan Benjamin (1800-1884), native of S. Carolina; veteran of the Black Hawk War, serving from this county.
- Hapsebeth "Happy" (1800-1868), native of S. Carolina; md. J. B. Marr; a daughter, Nancy, was b. Ill. in 1839.
- MATHENY: John (1840-1904) died at his home north of Macomb; he had lived for several years in Eldorado Twp.
- MC DONALD: Franklin (1859-1876) was a son of Samuel and Amanda (Sandidge) McDonald, who lived in Eldorado Twp. Amanda was a daughter of Joshua and Mary (Hoag) Sandidge. Franklin was killed when struck by lightning while plowing on a farm in Eldorado Twp.
- MICKEY: William (1851-1855) was a son of Jacob and Mary A. Sandidge) Mickey; Wm. was b. in Eldorado Twp. and was a brother to J. Ross Mickey, who later became a Macomb lawyer.
- MILLER: Elmore (1870-1946), a son of Mason and Sarah Ann (Miller) Miller; a brother to Marion, Lucy, and Catherine Miller.
- NELSON: John (1823-1899) b. in Butler Co., Ohio Mar 29, 1823; a son of Joel and Rachael (Dennis) Nelson, both natives of Ohio; Joel died in that State; John had a brother, David, and a younger sister; at age 8 years, John, his mother, and his grandparents moved to Schuyler Co., Ill. where the family lived for several years; in 1850, John went to Calif. and mined for 2 years; returned to this area and lived with an uncle, Isaiah Dennis, in McDonough Co. till 1854; then returned to Calif. and ran a cattle ranch for about 11 years; again returned to this county and in 1865, bought a farm in Eldorado Twp.; md. Serine Fowler, daughter of Jesse B. and Catherine (Bruner) Fowler, on Nov 13, 1870; had 9 children: Katie (Mrs. Wm. Kennedy); Clara; Alta; Edith; Alice; Annie; Marie Elizabeth; Laura Fern; Ralph Waldo; and Jesse Ward.
- PEAK: Eliza J. (1847-1912) (Death notice, in part, from The Macomb Daily Journal, Aug 15, 1912): "Mrs. Robert Peak of Vermont, formerly of Eldorado township, died at her home last Thursday morning, having had the second stroke of paralysis. Mrs. Peak was born and reared in Eldorado township, having moved to Vermont several years ago.....".

PRICE: George L. (1859-1935), b. in Eldorado Twp.; son of John and Mary E. (Breeze) Price; md. in 1883, to Etta Schroder, daughter of Christopher and Louisa Schroder.

John (1830-1896), b. in Pa.; moved to Fulton Co., Ill. in 1849, with parents, John and Catherine (McElhaney) Price; John, Sr., b. in Franklin Co., Pa. in 1803; d. in 1867; Catherine d., 1877; both buried at Vermont, Ill.

RUSSELL: Eve (1818-1866), wife of James; both b. in Ohio and md. there; had 2 children, Matthew & Mary, b. in that State; moved to Ill. in about 1847; lived in Industry Twp.; had the following children b. in Ill.: Joshua (b. 1848); Asel (b. 1850); George (b. 1852); Sidnor (b. 1856); and Lawrence (b. 1858).

SANDIDGE: Dan'l (1802-1882), b. in Va.; son of John; Dan'l md. in 1826, to Permelia Tate; moved to this county, 1832; lived in Industry Twp. a short time; then moved to Eldorado Twp. and lived there till 1850; moved to Schuyler Co. and lived there till his death; first wife died in 1845; Dan'l remarried in Aug, 1845, to Cynthia Phillips, daughter of Sam'l Phillips. By his first marriage, Dan'l had 11 children: Lucy Jane (Mrs. Isom David); William (moved to Mont.); John (lived in Vermont, Ill.); Mary (Mrs. Jonah Lindsay); Harriet (Mrs. L. Gorsuch); Eugénia (Mrs. Albert Pittinger); Permelia L.; Virginia (Mrs. Nathan Lindsay); Dan'l (lived in Brown Co.); Charles Clayton (moved to Mont.); and Larkin (moved to Mont.). By his second marriage, Mr. Sandidge had 2 children: Ellen (Mrs. M. McCarty of Shelby Co., Mo.) and Sam'l (d. at an early age). The Sandidge family had lived in Lincoln Co., Ky. prior to moving to this county. Daniel appears as # 516 on the 1840 county tax list; he owned \$80.00 in horses, \$98.00 cattle, \$45.00 wagons, and \$219.00 in other property; taxes - \$2.21.

George (1852-1854) was a son of Joshua and Mary (Hoag) Sandidge; Joshua and Dan'l, above, were brothers; George was a brother to Mary A. (Mrs. Jacob Mickey); Patience (Mrs. M. Elwell); William; Irvin; Pullam; Amanda (Mrs. Sam'l McDonald); James (moved to Nebr.); Mary (Hoag) Sandidge was a daughter of Andrew Hoag, a Revolutionary War vet.

SCHRODER: Christopher (1826-1864), b. in Hanover, Germany; md. Louisa Jane Stockton, a daughter of Dan'l and Sarah Stockton; the Schroder's had the following children b. in Ill.: John (b. 1847); Thos. (b. 1850); and Mary (b. 1856).

STOCKTON: Dan'l (1800-1883) moved to this county in 1833; b. in Ky.; wife, Sarah, also a native of Ky. Mr. Stockton appears as # 509 on the 1840 county tax list; he owned \$75.00 worth of horses, \$174.00 cattle, \$25.00 wagons, \$100.00 cash on loan, \$156.00 in other property; taxes were \$2.65.

YOUNG: Ann (1852-1893), wife of J. P.; Margaret Anna was born in Industry Twp., a daughter of Moses J. and Sarah Ann Peak Justus; md. James P. Young, Mar 23, 1876.

Notes, Corrections, Additions, and Changes

Information from: Manford J. Toland

Chockley Cemetery--Eldorado Township--McDonough Co.

The first burial in this cemetery is in the NE, near the east fence. A boy by the name of SANDAGE or SANDRIDGE. He died of the cholera. As near as I can tell: it's J.S. on sandstone, 1834. They just carried him back in the woods and buried him; soon others started burying there.

ADDITIONS:	WILLIAM J. TOLAND	1814-1903	SE near fence--New stone
	WILLIAM R. TOLAND	1845-1931	near center-NO MARKER
<u>COOK</u>	NANCY ANN TOLAND	1850-1922	" " " "
	INGRAM TOLAND	1869-1947	near fr. fence-NO MARKER
	ISAAC TOLAND	1818-1894	E side-NO MARKER
<u>CHOCKLEY</u>	ELIZABETH TOLAND	-1891	" " "
	GEORGE SHARP	1874-1952	NW--new marker
<u>TOLAND</u>	REMINA SHARP	1872-1938	" "

I was told by my parents that my great grandfather, WILLIAM, came to ILLINOIS from PENNSYLVANIA in 1837; also buried here, with no marker.

CLIFFORD SWEARINGEN 1897--3Mo.-12da.
(son of Hugh and Mary)

HYNEK, MARY 13 Aug 1934-20 Sep 1986 NW
(wife of EMIL)

Peak Cemetery

Location: Industry township, NW $\frac{1}{4}$, section 23; a half mile south southeast of Industry.

Remarks: Present condition of this family cemetery is extremely poor; the fencing is gone; all stones that were located were broken and covered with grass and brush. A number of unreadable field-stones were found in this cemetery. The Wilhelm graveyard lies about 100 yards to the east of this site.

CHAMBER:

Phillip R.; d. Oct --, 1873; age 44y --m 2d.

CORDELL:

Collen, d. Jun 7, 1868.

Margaret; d. ----.

(Above were 2 infants of A. & J. W. Cordell)

OSBORN:

Joseph; d. Nov 12, 1870; age 89y.

PEAK:

William, son of Robt. & Julia Ann; d. Feb 5, 1872; age 27y
3m 11d; Co G 62d Ill Inf.

SPRINGER:

Margaret; d. Mar 9, 1863; age 46y 7m.

NOTE: According to Illinois VA records, Hugh Smith, a War of 1812 veteran, is buried in this cemetery; however, no stone was located for Mr. Smith during this survey made in 1975.

Genealogical Notes - Peak Cemetery

CORDELL: Collen and Margaret were children of James W. and Annie (Springer) Cordell. James W. was a son of James, Sr., and Catherine (Cartwright) Cordell, natives of Ohio. James, Jr. came to this county with his grandfather, Alexander Cordell, and lived with him till age 19 years; married Jun 24, 1866, to Ann Springer; had 9 children. James was later the postmaster at Industry. Collen was named for an uncle who was killed during the Civil War.

OSBORN: Joseph (1781-1870) was b. in Va.; his wife, Nancy, was b. in 1790, also in Va.; Joseph was a veteran of the War of 1812; he and his family moved to this area prior to 1830; he appears on the 1830 census for Industry Twp.; on the 1840 county tax list, Mr. Osborn is shown as the owner of 80A, the west $\frac{1}{4}$ of the NW $\frac{1}{4}$ of section 23, Industry Twp.; also, he had \$80.00 worth of horses, \$58.00 cattle, \$10.00 clocks and watches, and \$100.00 in other property; taxes were \$3.24. Other Osborn's on that list included John and Andrew J. In 1860, Joseph and Nancy Osborn were living in Industry Twp. and living in their household were Joshua Osborn, age 17, and Emaline Smith, age 10.

PEAK: William (1844-1872) entered military service on Dec 9, 1863; discharged May 23, 1865.

SPRINGER: Margaret (1816-1863) was the wife of William; she and her husband were natives of Ky.

Notes, Corrections, Additions, and Changes

[Faint, mostly illegible text follows, appearing to be a list of names and dates.]

Margaret: d. Dec 23, 1863

Elizabeth: d. Dec 23, 1863

Lizzie, dau of William and Margaret, born Dec 23, 1863

William: Sep 17, 1863

Elizabeth: d. Dec 23, 1863

Geo. E., son of William and Margaret, born Dec 23, 1863

Bartholomew: d. Dec 23, 1863

Geo., wife of William and Margaret, born Dec 23, 1863

SPENTWELL:

Simp R., wife of William and Margaret, born Dec 23, 1863

HILLS:

Elizabeth: d. Dec 23, 1863

HURFAM:

John: d. Dec 23, 1863

Matilda J., wife of William and Margaret, born Dec 23, 1863

JOHNSON:

Mary E., wife of William and Margaret, born Dec 23, 1863

Fredrick W., son of William and Margaret, born Dec 23, 1863

1876; age 64.

Columbie A., son of William and Margaret, born Dec 23, 1863

Alexander: d. Dec 23, 1863

Cassie (See SPENTWELL)

Springer Grave

The grave of Mordecai Springer, who died Nov 13, 1887, at age 76y 7m 24d, is located in a small, fenced area in the NW $\frac{1}{4}$ of section 26, Industry township. This is about 2 miles south-southeast of Industry, near the former site of the Crossroads School.

Mr. Springer's gravesite is just north of a former cemetery, known as Crossroads or Pleasant Grove Cemetery. Carter's Settlement was located in this general area and was one of the first settled areas in this county. Pioneer families came here in 1826-27, and in 1827, built a log fort for protection against local Indians. A cemetery was established here in the late 1820's, but all traces of it have long been gone. Early settlers in this vicinity included: Riggs Pennington, William Carter, Sela Tomberlin (a widow), Stephen Osborn, John Wilson, James Vance, Rev. John Logan, Isaac Fowler, and a Mr. Jenkins.

In 1871, M. Springer was indicated as the owner of 40A in this section; his home was located near the site of his grave. W. L. Springer owned 20A just to the west of Mr. Springer's property. The 1840 county tax list shows Lewis Springer as the owner of the entire NW $\frac{1}{4}$ (160A) of section 26. He also owned the SE $\frac{1}{4}$ of the same section, and his residence was located on the SE $\frac{1}{4}$. No other Springers were recorded on that 1840 tax list.

Notes, Corrections, Additions and Changes

Standard Cemetery

Location: Industry township; SW $\frac{1}{2}$, Section 24; about 2 miles southeast of Industry.

Remarks: Standard Cemetery, so named for the family owning this farm for several years during the 1800's, is situated in pasture land nearly a half-mile east of an all-weather township road. It's current condition is extremely poor; the old fencing has been knocked down by livestock; stones are strewn over the area; many are broken; the entire cemetery area is covered with brush and weeds. The survey was made in early 1975.

ADKISSON:

John C.; d. May 18, 1857; age 30y 8d.

CREEL:

Mary E., wife of D. M.; d. May 23, 1855; age 27y 8m 24d.

DAVID:

William D.; d. Jul 15, 1866; age 61y 10m 9d.

James; d. Mar 15, 1851; age 24y.

Joshua; d. May 1, 1840; age 30y.

John E.; 1831 - 1906.

Cassinda, wife of John; 1837 - 1904.

ELLIOTT:

Polly (See SEAWARD).

FLACK/FLACH:

Margaret; d. Dec 10, 1854; age 16y 7m 15d.

Elizabeth J.; d. Mar 25, 1843; age 2m 5d.

(Above were daughters of B. & E. Flack)

Lizzie, dau of A. & C.; d. Mar 5, 1877; age 5y 9m 4d.

William; Sep 19, 1817 - Feb 26, 1885.

Elizabeth E., wife of Bartholomew; Aug 15, 1811 - Oct 22, 1891.

Ora E., son of Jacob W. & Bell; Sep 27, 1879 - Jan 10, 1881.

Bartholomew; Aug 18, 1811 - Aug 15, 1893.

Cas---, wife of Jacob; Jan 7, 1871 (remainder unreadable).

GREENWELL:

Sinah R., wife of R. G.; d. Jan 7, 1882; age 32y 4m 19d.

HILLS:

Elizabeth; d. Aug 12, 1845; age 1y 7d.

HUSHAW:

Jonas; d. Dec 22, 1889; age 74y.

Matilda J., wife of Jonas; d. Mar 11, 1894; age 74y 3m 9d.

JOHNSON:

Mary E., wife of W. P.; d. Apr 17, 1859; age 37y 5d.

Fredrick W., son of Geo. T. & Priscilla M.; d. ?Mar? 9,
?1876?; age 6d.

KEE:

Columbia A., dau of J. & S.J.; d. Sep 3, 1863; age 5m 29d.

MATHENY:

Alexander; d. Sep 15, 1872; age 55y 5m 25d.

MC KEE:

Cassie (See SEAWARD).

MEADOR:

Elvira S., dau of G.C. & M.A.; d. Sep 9, 1863; age 8y 9m 27d.
Jesse; d. Dec 18, 1865; age 73y 1m 9d.
Nancy, wife of Jesse; d. Mar 4, 1859; age 66y.

MITCHELL:

Sarah E., wife of Warren; Mar 31, 1865 - Sep 6, 1893.
Dennis; Dec 4, 1885 - Mar 19, 1886.

PARR:

Indiana E., wife of O.; d. Mar 29, 1848; age 34y.
John, son of O. & I.E.; d. May 13, 1846; age ?13?y 3m 23d.

PATTEN:

Elizabeth J., dau of G.P. & M.P.; d. Sep 21, 1848; age 3y 9m 27d.

PENNINGTON:

J. S., son of T. J. & P. H.; d. Oct 31, 1843; age 15y 3m 3d.
William, son of T. J. & P. H.; d. of diptheria on Sep 10, 1850;
age 24y 11d.
P. H., wife of T. J.; d. Aug 8, 1840; age 32y 8m 19d.
Ulissus, son of T. J. & M. J.; d. Aug 21, 1862; age 7m 16d.
Infant son of T. J. & M. J.; (no dates).
Infant son of T. J. & P. H.; (no dates).

PITTMAN:

William; Mar 2, 1805 - Jun 2, 1881.
Nancy, wife of ?Wm.?; d. Sep 3, 1863; age 51y.
Nancy, dau of G.M. & L.; d. Aug 31, 1863; age 2y 1m 7d.
Infant son of B.E. & J.E.; (no dates).
Emily, dau of W. & N.; d. Jul 18, 1846; age 13y 7m.
Taylor, son of W. & N.; d. Mar 25, 1860; age 12y 5m 6d.

POWELL:

Mary J., wife of Edmund & dau of J.J. & E. Wyatt; d. -----;
age 24y 7m 7d.

SEAWARD:

Polly Ellicott, wife of W.; d. May 20, 1852; age 66y 26d.
William; d. Jun 30, 1849; age 67y 1m 9d.
Leicester; d. Feb 19, 1852; age 43y 7m 12d.
Cassie McKee, wife of L.; d. Mar 2, 1899; age 82y 3m 3d.
Rebecca, dau of W.J. & E.; (remainder unreadable).
Leicester L., son of J. & R.; d. Apr 8, 1854; age 15y.
Garret W., son of L. & C.; d. Oct 11, 1861; age 19y 1m 20d.

SPRINGER:

Jane, wife of Lewis; d. Oct 11, 1845; age 36y 1m 10d.

WYATT:

John J.; d. Sep 6, 1865; age 52y; Capt of Co I 62d Reg Ill Vol.
Elizabeth; d. Apr 16, 1891; age 79y 11m 16d.
Daniel W.; (dates unreadable); Co I 62d Ill Inf.
Francis M., son of J.J. & E.; d. Sep 22, 1839; age 8m 6d.
Mary J. (See POWELL).

Genealogical Notes - Standard Cemetery

ADKISSON: John C. (1827-1857), son of Thos. & Margaret (Gibson) Adkisson; the family arrived in this county in 1831, settling in Industry Twp.; Thos. died in 1857 & was buried at Camp Creek; Margaret died in 1834.

CREEL: Mary E. (1827-1855), first wife of Durham M. Creel; daughter of Gideon and Sina (Wyatt) Standard; Mary b. in Ky. and moved to this county with her parents in the 1830's; md. in 1850, to Mr. Creel, son of Durham & Mary (Smith) Creel, also of Ky.; at her death, Mary E. (Standard) Creel was survived by her husband, Durham, and 2 children. Mr. Creel later became a physician, served during the Civil War, and practiced medicine in Industry for several years. He re-married in 1857, to Mary C. Adkisson. Dr. Creel, died in 1902; buried at Camp Creek.

DAVID: Joshua (1810-1840), son of Abraham & Elizabeth David; parents were natives of Tenn. and moved to this county in about 1830, from Hardin Co., Ky. Abraham died in 1863; Mrs. David, in 1878.

John E. (1831-1906), b. in Ky.; wife, Cassinda, native of Ill.; in 1860, their household in Eldorado Tp. consisted of the following persons: Shelvy, age 4; Narcissa, 3; Chauncy, age 2; and a farm laborer, Andrew Fees, age 22.

FLACK: (Also spelled "Flach"). Bartholomew (1811-1893), b. in Germany; md. Elizabeth E. Hertzell in 1833; moved to Schuyler Co., Ill. in 1839; to this county, 1849; had the following children: John, Elizabeth J., Alexander, William, Margaret, and Jacob. Also living in the household in 1860, was Mary Flack, age 12 years, a native of the State of N. Y.

Ora E. (1879-1881) was a son of Jacob W. and Mary Bell (Cordell) Flack; Ora was a brother to Edward L. & Rosa May.

HUSHAW: Jonas (1814-1889), b. in Ross Co., Ohio in 1814; moved to this county in 1839; md. Oct 29, 1839, to Matilda Jane David, a native of Ky.; they had no children, however, adopted a girl -- Mary Jane, b. in Ind., 1847 (later was Mrs. David C. Harris); also raised another child, George Pearson, b. in Ind. in 1853. Jonas appears on the 1840 county tax list as # 479. He owned \$145.00 worth of horses, \$10.00 cattle, and \$45.00 in other property; taxes were \$1.00. Also listed on this tax report was John Hushaw, who owned 160A, the SE $\frac{1}{4}$ of section 13, Industry Twp.

Matilda J. (1820-1894), b. in Ky.; daughter of Abraham and Elizabeth David.

MATHENY: Alexander (1817-1872), b. in Ky.; in June, 1860, his household in Industry Twp. consisted of the following individuals: Mike (age 23, b. Ill.); Andrew (21); John (17); Wm. (15); Sarah (13); Joel (11); Morgan (9); and Charles (4).

MEADOR: Jesse (1807-1865), native of Franklin Co., Va.; son of Watts Meador; lived in Tenn. prior to moving to Ill. in 1833; then moved to Gallatin Co., Ill.; thence to Schuyler Co., Ill. about 1837; to this county about 1849.

MEADOR (cont'd): Nancy (1812-1859), wife of Jesse; native of Franklin Co., Va.; daughter of George Chuning; Jesse & Nancy had 6 children, including twins.

George C., father of Elvira S. (1854-1863); a twin, and son of Jesse & Nancy Meador. Geo. md. Mary A. Pittman, native of Todd Co., Ky., Feb 15, 1849; they had the following children: Eugene B., Emma, Jesse, Palastine, Jennie, Alice, Ona, Ina, and Elvira.

PENNINGTON: J. S. (1828-1832), William (1826-1850), and an infant son were children of Thos. J. and Polly H. (Vanters/Vawter) Pennington. Both parents were natives of Ky. After her death in 1840, Thos. md. Mrs. Mary J. (Smithers) Rogers in April, 1841. Ulissus and an infant son were children of Thos. and Mary Jane. Both Thos. and his second wife are buried in the Pennington family cemetery in Industry Twp.

PITTMAN: William (1805-1881) b. in N. Carolina, son of John; the family moved to Christian Co., Ky., in 1808; thence, in 1812, to Bedford Co., Tenn.; returned to Ky. in 1817; Wm. md. in Ky. to Nancy Wyatt; moved to Morgan Co., Ill. in 1828; to this county, 1835; lived in section 24, Industry Twp.; later farmed on section 26, Ind. Twp.; Nancy Pittman was a native of Tenn.; Wm. & Nancy had the following children: Burris E. (1826); Polly Ann (1828); Wm. R. (1830); George Monroe (1832); Emily (1834); Elizabeth (1835); Jane (1837); Iva (1839); Henry Clay (1843); Harrison (1845); Taylor (1847); and John T. (1850). After the death of Nancy in 1863, Wm. md. the widow of John Rose; she was a daughter of Elijah M. Wilson of Schuyler Co., Ill.; Wm. and his second wife had a son, Freddy (b. 1865). Wm. appears as # 492 on the 1840 county tax list. He owned 40A in the SW $\frac{1}{4}$ of section 23, Industry Twp.; \$180.00 worth of horses, \$165.00 cattle, \$10.00 clocks and watches, \$40.00 wagons, \$200.00 cash loaned out, and \$170.00 in other property; total taxes were \$4.83.

Nancy (1861-1865) was a daughter of George Monroe & Esther Pittman; George was b. in Ill.; Esther, in Ind.; a son, Wesley, was also b. in Ind. in 1859.

The infant son listed under the Pittman's was a child of Burris E. and Julia (Cressman) Pittman). Burris was an artist and several drawings by him appear in the 1871 McDpnough County atlas. Other children of Burris & Julia were: Wm. (b. 1840); Emily (b. 1852); Grove (b. 1854); Ella (b. 1856); Eudora (b. 1858); and Mary (b. 1860.).

POWELL: Mary J. was a daughter of John J. and Elizabeth Wyatt; she was b. in Todd Co., Ky.

SEAWARD: William (1782-1849) and family appear in the 1830 federal census as living in Industry Twp.; the family consisted of a female under 5 years of age; a male between 5-10 years old; 2 males & 1 female between 20-30; a female, 30-40; and Wm., aged between 40-50 years.

SEAWARD (cont'd): William appears as # 505 on the 1840 county tax list. He owned 50A in the NW $\frac{1}{2}$ of section 25, Industry Twp.; also, \$10.00 worth of horses, \$10.00 cattle, \$10.00 clocks & watches; and \$21.00 in other property; taxes were \$1.51. Also appearing, as # 498, on that list, was John Seaward who owned 80A in section 16, Eldorado Twp.

SPRINGER: Jane (1809-1845), wife of Lewis; Mr. Springer appears on the 1840 county tax list as # 496. He owned 320A in section 26, Industry Twp. and resided in the SE $\frac{1}{2}$ of that section; also owned \$120.00 worth of horses, \$112.00 cattle, \$10.00 clocks and watches, \$50.00 wagons, \$12.00 cash loaned out, and \$219.00 worth of other property; taxes were \$9.02.

TOMBERLIN: James B. (1809-1854) b. in Virginia; son of Celia, referred to as "Widow" Tomberlin in local histories; Celia & family moved to this county in 1826 & were among the first settlers to arrive in this area; the family lived near the "Crossroads" in Industry Twp. James md. Clarissa "Clarkey" Hays in this county on Jan 12, 1832; they had the following children: Lacy (1832); Celia (1834-Mrs. Robt. Outlaw); Priscilla (1837); Mary (1838); Elizabeth (1841-Mrs. Asa Sellers); Fountain C. (1844-45); Martha E. (1845); Susannah (1847-Mrs. Stewart Pennington); and James F. (1852). James had a brother, Fountain C., b. in about 1811. James B. appears as #491 on the 1840 county tax list. He owned \$60.00 worth of horses, \$20.00 cattle, & \$58.00 in other property; taxes were \$.69. After James' death, his widow continued to live on the family farm south of Industry till her death in 1879; she and several members of this family are buried in Industry Cemetery.

WYATT: John J. (1813-1865), a native of Ky.; md. Elizabeth, a native of Tenn.; had the following children living in the household in 1860: Wm. (b. 1841); Andrew (b. 1843); Daniel (b. 1847); Sina (b. 1851); and Thos. (b. 1853). John J. Wyatt appears as # 493 on the 1840 county tax list; owned \$20.00 worth of cattle, \$10.00 clocks and watches, and \$42.00 in other property; taxes were \$.36.

Notes, Corrections, Additions, and Changes

Vail Cemetery

Location: Industry township, SW $\frac{1}{4}$, section 14; on the east edge of the Industry city limits, south side of the road.

Remarks: Neglect and vandalism have caused this family graveyard to deteriorate to near oblivion. The partially fenced grounds are covered with brush, weeds, briars, small trees, etc. The stones and their inscriptions are in surprisingly good condition. However, nearly all of them have been pushed from their original positions. Large stones, some weighing several hundred pounds have been toppled from their bases and are lying in deep underbrush. This survey was made in March, 1975.

ARNOLD:

Ira; (no dates); Co I 78th Ill Inf.

Edward, son of Ira & S.J.; d. Feb 3, 1893; age 23y 3m 22d.

Charles, son of I. & S.J.; d. Jun 13, 1873; age 1y 8m.

ARVIN:

Sarah E., dau of W.G. & F.M.; d. Jan 25, 1869; age 29d.

Frances J., dau of W.G. & F.M.; d. Jan 26, 1869; age 30d.

BROWN:

May, dau of J.E. & M.C.; d. Feb 15, 1890; age 5y 10m 18d.

Jesse; d. Feb 26, 1889; age 80y 8m 10d.

Stephen A. D., son of J. & J.; d. Feb 3, 1858; age 2m 19d.

Mary D., dau of J. & J.; d. Oct 16, 1854; age 1y 1m 16d.

Jesse, son of A.H. & M.R.; d. Mar 10, 1839; age 11m 16d.

Mary R.; 1813 - 1854.

Amos H.; 1809 - 1860.

Infant son of S.R. & S. (no dates).

Sophia (See VAIL.)

COX:

R. Carrie, dau of D. & M.; d. Apr 23, 1867; age ---.

DOWNEN:

Jennie, wife of J.J.; d. May 31, 1871; age 21y 1m 12d.

Cora V., twin dau; d. Aug 29, 1871; age 1y 3m 1d.

Bertha, dau of J. & S.L.; d. Nov --, 1873; age ---.

Amaziah J.; d. Dec 16, 1867; age 18y 9m 21d.

David; d. Jul 10, 1865; age 35y 2m 16d.

W. R.; d. Dec 26, 1861; age 36y 6m 7d.

Samuel; Sep 3, 1831 - Jun 24, 1861.

Evaline; Nov 21, 1859 - May 2, 1860.

Francis M.; Aug 21, 1858 - Jan 27, 1859.

Florence E., dau of D. & M.J.; d. May 8, 1858; age 1y 9m 4d.

Samuel P.; Feb 11, 1861 - Jul 6, 1861.

Francis M.; d. Apr 8, 1845; age 3y 5m 14d.

Sarah A.; d. Feb 17, 1846; age 28d.

Josiah; d. Mar 20, 1855; age 22y 3m 23d.

Mary E.; d. Sep 5, 1855; age 15y 5m 28d.

(Latter 4 children were those of J. & H. Downen)

Johnson; d. Sep 11, 1855; age 50y 7m 16d.

Hicksy, wife of Johnson; d. Apr 27, 1869; age 61y 7m 7d.

PEOPLE BURIED IN VAIL CEMETARY, INDUSTRY, ILL.

orenza D. Vail 1857-1914
avid J. Vail 1818-1827
eziah Vail 1823-1877

Mrs. Reeder gave this to Neva Bar

Bartlett

u. of E. K. nkade (related to Goldie Lickey)
phia L. Kinkade

nuel Vail- War 1812 Mar. 11, 1868 78yrs.

na E. Vail 1866
lza J. Vail 1866 } Daus. of Christopher Vail.
nor L. Vail 1884 }

omas J. Vail d.1863
l. Infantry) John Vail Family
rina Vail 1863 - 17yrs

ets 1906
ail Teets(wife) d.1886
Teets (son) 1869

phia Brown d.1885

m B. Vail d. 1898
cy Vail d. 1907

mezer Vail b. 1821-1891
(wife) 1833-1892
is H. (son) 1873-1874
ah Lavina Hathaway (dau) 1882- 18yrsold

eva S. Vail dau. d1889
m L Vail son. d. 1890
hildren of WM and H. W.

tin Vail 1841-1914
n of John & Sophia

stophor Vail (Father of Horace Vail) 1836-1916
ah S. Vail (2nd wife) 1843-1926

be or Phoebe Friend - d. 1875 dau of A. H. Friend - (Edith Kemble - Verna
Baker

. Vail d. 1867. 50yrs.

Samuel Vail-2 stones one probably put up by Legion-Was a Mason-Pvt. in
Barnetts' Ohio Militia- War of 1812 Same as 3rd in opposite Col.

Rebecca Vail - dau. of Elizabeth Clawson -d. 1867.T B

GRAVE YARD ESTABLISHED BY THOMAS VAIL B. 1785-1873. Great Grandfather of
Mrs. Reeder's and Lloyd Clawson.
Nancy Vail (wife) - 1859

Jesse Brown 1889 88yrs 8 mo 10 day - Bro. in -law of John Vail.

R. Carrie Cox.Dau of David and Mary Cox

Jesse Janes 1904
Elizabeth Janes Vail Elmer's Grandfather's wife 1904

* Abraham Vail - Brother to Thomas from Ethel Hites family 1794-1874 . 795

Chas. Arnold Son
Edward Arnold son
Ira Arnold - 78th Ill. Inf.

Thomas C. Janes 1957-1899

Nancy Price Price- wife of Samuel Price 1862

Samuel Downen	1861	
Frances "	1859	
Johnson "	1855	G G of Dave Bruner.
Hicksy "	wife 1869	
Mary E.	1855	(ChildrenØ.)
Josiah	1855	"
Job	1855	"
W.R.	1861	"
David	1865	"
Sarah	1846	2nd burial in cem.
Francis	1845	Children of Johnson & Hicksy
Amaziah	1867	
Jennie	1871	
Bertha		

Stephen Brown	(Children of Jesse and JO Hanna Brown)	1854
Mary D. Brown	"	1858
Mary R.		1813- 1854
Amos H. "		1809 1860
Jesse Brown, Son		1839

Sarah E. Tracey & Frances I. Twins 1869

San Vail Wife of Ben. J. Vail d. 1899

th Cordell dau. of Thomas & Alice Vail Cordell (Sister of Ralph Sr. & Husband was Mrs. Reeder's Uncle.

na Vail (School Teacher . Sister of Wash Vail, Dr. Pollock Wifes' sister) No stone Daug. of David & Keziah.

by Son of Chas & May Anstine (Brother to Hazel Roe No stone)

rgaret Vail Daug. of George & Elizabeth Clawson age 20

- Abraham; d. Aug 2, 1874; age 75; 1st 20d.
- Thomas; d. Feb 25, 1870; age 67; 1st 20d.
- Nancy, wife of Thom.; d. Jan 2, 1860; age 77; 1st 20d.
- Thomas B., son of G. & M.; d. Feb 15, 1864; age 21; 1st 20d.
- David J.; 1818 - 1847.
- Lorenza D.; 1857 - 1911.
- Keziah; 1821 - 1877.
- Rebecca, dau of G. & M.; d. Jan 29, 18--; age ---.
- George; d. Jan --; 1867; age 50; 7d.
- Samuel; d. Mar 11, 1860; age 18; 1st 20d.
- Mer of 1812.
- Benjamin; Apr 12, 1813 - Jan 7, 1890.
- Susan, wife of Ben.; Aug 7, 1821 - Feb 9, 1892.
- Sarah S.; 1813 - 1820.
- Christopher; 1815 - 1816.
- Martin; May 29, 1821 - Sep 10, 1870.
- John L., son of G. & M.; d. Aug 21, 1830; age 14; 1st 20d.
- Genevra S., dau of G. & M.; d. Feb 1, 1831 - Mar 1, 1831.
- Rosamond, dau of G. & M.; d. Jul 20, 1830; age 10; 1st 20d.
- Nancy; Sep 2, 1830 - Jan 11, 1897.
- John S.; Dec 10, 1811 - Mar 20, 1868.
- Sophie Brown, wife of J. B.; d. Mar 20, 1837 - Sep 10, 1868.
- Levine, dau of J. & M.; d. Jan 6, 1840; age 17; 1st 20d.
- Thomas J., son of G. & M.; d. Feb 11, 1841; age 23; 1st 20d.
- Go -- 18th Feb 11 1841.
- Lenora L., dau of G. & M.; d. Mar 20, 1841; age 14; 1st 20d.
- Elixa J., wife of J. B.; d. Jul 10, 1841; age 17; 1st 20d.
- Ray, wife of M.; d. Sep 20, 1841; age 14; 1st 20d.
- Ebenezer; d. Jul 3, 1841; age 17; 1st 20d.
- Louis B. S., son of G. & M.; d. Feb 11, 1841; age 14; 1st 20d.

FRIEND:

Phebe, wife of A.H.; d. Apr 20, 1875; age 93y 8d.

HATHAWAY:

Sarah Lavina, dau of E. & A. Vail and wife of D. W.; d. Jan 31, 1882; age 18y 4m 25d.

JANES:

Jesse; Feb 6, 1820 - Jan 27, 1904.

Elizabeth; Sep --, 1827 - Nov 14, 1904.

Walter V.; d. Oct 21, 1862; age 2m 29d.

Lewella; d. Jan 18, 1865; age 3m 10d.

(Latter 2 were children of J. & E. Janes)

Thomas C.; Feb 7, 1857 - Mar 13, 1899.

KINKADE:

Sophia L., dau of H. & E.; d. Aug 2, 1869; age 6m 21d.

"Also an infant son" (no dates).

Elizabeth, wife of H.; d. Aug 23, 1869; age 21y 9m 8d.

PRICE:

Nancy, wife of Samuel; d. Mar 30, 1862; age 77y 10m 8d.

TEETS:

Alpha; Mar 3, 1831 - Jul 10, 1906.

Mary; Jul 3, 1835 - Dec 30, 1886.

John E., son of A. & M.; Jan 23, 1868 - Aug 23, 1868.

VAIL:

Abraham; d. Aug 2, 1874; age 79y 11m 21d.

Thomas; d. Feb 26, 1873; age 87y 9m.

Nancy, wife of Thos.; d. Jan 2, 1860; age 72y 1m 20d.

Thomas B., son of T. & N.; d. Feb 15, 1839; age 11y 8m 17d.

David J.; 1818 - 1887.

Lorenza D.; 1857 - 1914.

Keziah; 1823 - 1877.

Rebecca, dau of C. & E.; d. Jun 29, 18--; age ----.

George; d. Jun --, 1867; age 50y 7m.

Samuel; d. Mar 11, 1868; age 78y; Pvt Barnett's Co Ohio Mil War of 1812.

Benjamin; Apr 12, 1813 - Jan 7, 1899.

Susan, wife of Benj.; Aug 7, 1821 - Feb 6, 1899.

Sarah S.; 1843 - 1926.

Christopher; 1838 - 1916.

Martin; May 29, 1841 - Sep 30, 1914.

John L., son of Wm. & H.N.; d. Aug 21, 1890; age 16y 6m 24d.

Genevra S., dau of Wm. & H.; Sep 1, 1875 - Mar 13, 1889.

Rosamond, dau of Wm. & Harriet N.; d. Jul 20, 1880; age 6m 26d.

Nancy; Sep 2, 1836 - Jan 11, 1907.

John B.; Dec 18, 1811 - Mar 28, 1898.

Sophia Brown, wife of J. B.; May 22, 1807 - Oct 30, 1886.

Lavina, dau of J. & S.; d. Jan 8, 1868; age 17y 7m 7d.

Thomas J., son of J. & S.; d. Jul 31, 1863; age 23y 8m 13d;
Co -- 78th Reg Ill Vol.

Lenora L., dau of C. & E.; d. May 22, 1881; age 21y 1m 11d.

Eliza J., wife of Christopher; d. Jun 19, 1866; age 29y 8m 1d.

Amy, wife of E.; d. Sep 24, 1892; age 59y 2m 9d.

Ebenezer; d. Jul 3, 1891; age 69y 6m 20d.

Louis H. S., son of E. & A.; d. Sep 7, 1871; age 1y 1m 7d.

Genealogical Notes - Vail Cemetery

ARNOLD: Ira, father of Edward & Charles, lived on section 21, Industry Twp.; he was a native of Ohio and came to this county from Fulton Co., Ill. in 1857. Mr. Arnold enlisted in the Union Army in Bethel Twp. on Aug 14, 1862 and served as a private till his discharge on Jun 13, 1865.

DOWNEN: David (1830-1865) b. in Ill.; he and his wife, Minerva Jane, had several children, all b. in this county, including: Brazil (1857), Florence (1856), and Gideon (1859).

Minerva Jane, widow of David, married Michael Lawyer in this county in 1868.

Samuel (1831-1861), b. in Ill.; wife, Mary, b. in Ohio, 1835.

Johnson (1805-1855) appears on the 1830 federal census of Schuyler-McDonough County; at that time his family consisted of a wife and 3 sons under the age of 5 years. Mr. Downen appears on the 1840 McDonough Co. tax list as # 452. He owned: 160A, the SE $\frac{1}{2}$ of section 15, Industry Twp. (the present south half of the city of Industry); value of the land was \$4.00 per acre. He also owned, in 1840, \$180.00 worth of horses, \$45.00 cattle, \$75.00 wagons, and \$190.00 in other property; total taxes were \$5.65. In 1846, Mr. Downen gave an acre of his ground to a blacksmith, John Price, in order to entice the man to begin a business in that area. That blacksmith shop was the first business in that immediate vicinity, and was the beginning of the city of Industry.

JANES: Jesse (1820-1904), son of Walter and Ardra (Crook) Janes, both natives of Ky.; the family moved to this county in 1834, settling in Industry Twp.; Walter died in 1853; Ardra died in 1881; on Dec 31, 1846, Jesse md. Perlina Vanter; they had 5 children: William D., Sarah E., Harriet J., Mary M., and Thomas C. Perlina d. Apr 15, 1860; Jesse remarried on May 21, 1861, to Elizabeth Vail, a daughter of Thos. Vail; Jesse and Elizabeth (Vail) Janes had 2 children: Walter V. and Luella. Walter, father of Jesse, died in 1853; he is listed as # 448 on the 1840 county tax list; he owned 160A, the NW $\frac{1}{4}$ of section 20, Industry Twp.; also \$550.00 in personal property.

PRICE: Nancy (1784-1862), wife of Sam'l; a native of N. Carolina; in 1860, Sam'l & Nancy were living with Henry Downen in Industry Twp.; Henry was b. in N.C. in 1815; also in that household in 1860, were Thomas and Johnson Downen, ages 14 and 11. Nancy was the second wife of Sam'l Price; his first wife died in Ark. in 1834. Sam'l later moved to Rushville, Ill. where he died in about 1877 at age 91 years.

TEETS: Alpha (1831-1906), b. in Preston Co., W. Va., a son of Adam & Elizabeth (Mosser) Teets; the parents were natives of

TEETS (cont'd): W. Va.; Adam was b. in 1790; Elizabeth, on Jul 13, 1793; Adam & Elizabeth were md. in 1813; Mr. Teets d. in 1865; Mrs. Teets d. in 1869; Alpha moved to this county in about 1853 and worked as a farm hand for 2-3 years; on Mar 6, 1860, Alpha md. Mary Vail, a daughter of John Vail; Alpha and Mary had 5 children: Lucinda (1861); Adaline (1864); Nancy L. (1865); John E. (1868); and Bertha S. (1877). This family lived on section 8, Industry Twp.

VAIL:

Thomas (1785-1873), b. in N. Jersey; md. in 1810, to Nancy Bridge in Ohio; moved to this county in 1834. Mr. Vail is # 467 on the 1840 county tax list. He owned 149A in sections 14 & 15, Industry Twp.; also \$110.00 worth of horses, \$64.00 cattle, \$10.00 clocks and watches, \$60.00 wagons, and \$287.00 in other property; taxes were \$6.08; his residence was located in section 14.

John B. (1811-1898), son of Thos. & Nancy Vail; b. in Butler Co., Ohio, Dec 18, 1811; John had a twin sister that died in infancy; the family moved to this county in 1834; before leaving Ohio, John md. Sophia Brown, on May 11, 1834; John & Sophia farmed in Schuyler Co. for about 2 years, then moved to this county and lived on section 14, Industry Twp.; they had 9 children: Mary, Nancy, Christopher, Thos. J., Adaline, Lavina, Eliza, and William.

Thomas J. (1839-1863), son of John B. & Sophia (Brown) Vail; enlisted as a private in the Union Army on Aug 9, 1862; died at Nashville, Tenn. in 1863.

Christopher (1838-1916), b. in Industry Twp., May 28, 1838; a son of John B. & Sophia Vail; md. on Apr 27, 1862, to Eliza Hendrickson; they had 2 children: Lenora L. & Emma E.; Eliza d. in 1866; Mr. Vail then md., on Sep 6, 1868, Sarophene S. Dace; they had 2 children, Martha S. & Horace M.

Ebenezer (1821-1891), son of Thos. & Nancy Vail; b. in Butler Co., Ohio Dec 14, 1821; moved to this county with parents; md. on Mar 20, 1855, to Amy Garrison in Schuyler Co.; they had 6 children: Alice A., Elmer I., Etna A., Cora., Sarah L., and Lewis H. G.

Benjamin (1813-1899) appears on the 1840 county tax list as # 469; he owned no real estate; the only personal property he was taxed for that year was \$80.00 worth of mules; his total taxes were \$.40.

Notes, Corrections, Additions, and Changes

Vance Cemetery

Location: Industry township, NW $\frac{1}{4}$ section 24; one mile east of the south side of Industry.

Remarks: Vance Cemetery was established in the late 1830's. A survey was made, the grounds laid off in blocks and lots, and a plat is on file at the McDonough County Court House. This cemetery is currently in use and is regularly maintained. The grounds are completely fenced and are in excellent condition.

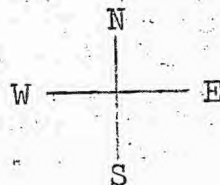

County Road # 9

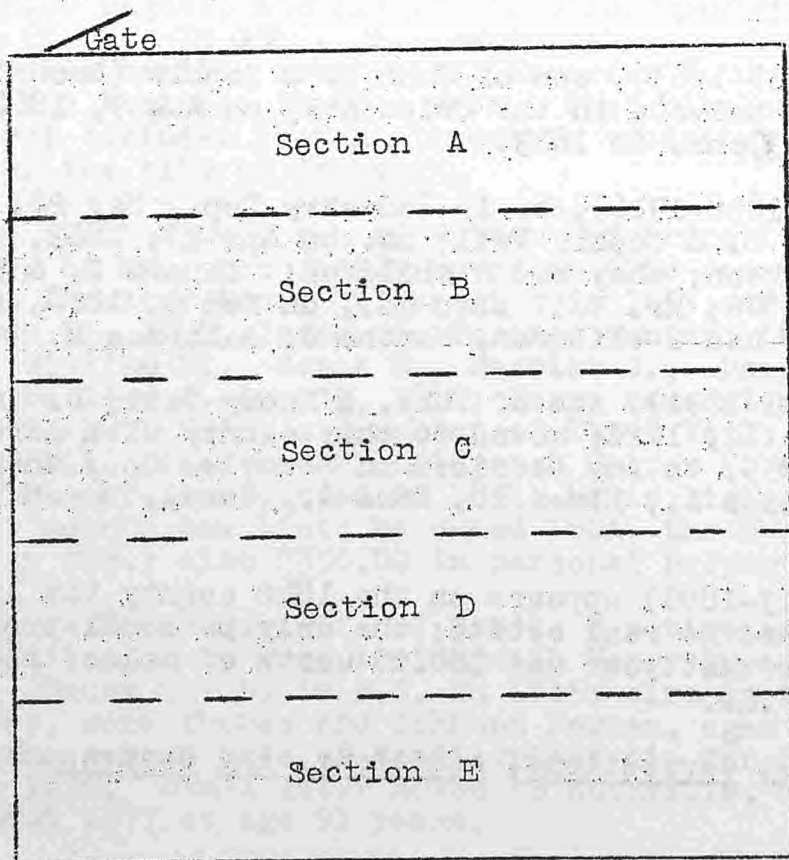

AGNEW:

Joseph T.; 1893 - 1918. (B)
James E.; 1863 - 1918. (B)
Edith S.; 1869 - 1943. (B)
Idress L.; (no dates). (B)
Retta, wife of O.M.; d. Jun 24, 1892; age 28y 9m 28d. (D)

ASHER:

Lewis D.; Jul 18-19, 1936. (B)

BEGHTOL:

Bertha B.; Dec 20, 1879 - Feb 5, 1889. (C)
Mary M.; Jul 14, 1886 - Dec 21, 1886. (C)
(Daughters of Shadrach & Lillie Beghtol)

BENNETT:

Columbia Anna; 1848 - 1927. (D)
John Riley; 1845 - 1915. (D)
---, son of J.R. & C.A.; d. Apr 7, 1869; age 2y 5m 9d. (D)
Maria, wife of George; d. Jun 20, 1887; age 60y 1m 28d. (D)
George; killed Nov 13, 1885; age 66y 4m 28d. (D)
Matilda, wife of Geo.; d. Feb 3, 1860; age 34y 8m 24d. (D)

BOONE:

Daniel; d. Aug 25, 1875; age 58y 7m 28d. (C)

BOTCHLETT:

Adam C.; Jul 20, 1837 - Feb 2, 1894. (E)
Elizabeth, wife of Adam; Dec 19, 1839 - Mar 3, 1909. (E)
Adam M., son of B.F. & N.J.; d. Oct 16, 1873; age 15y 7m 5d. (E)
B. F.; Aug 15, 1833 - Apr 28, 1895. (E)
Nancy J.; 1833 - 1926. (E)

BRIDGES:

Margaret; d. Jan 2, 1892; age 91y 3m 18d. (C)
John; d. May 24, 1844; age 47y 1m 30d. (C)
William A.; d. Feb 6, 1857; age 3y 1m 14d. (C)
John W.; d. Aug 30, 1856; age 9m 18d. (C)
(Wm. & John, sons of I.C. & L.L. Bridges)

BROWN:

Lydia A.; Jul 7, 1834 - Nov 11, 1877. (E)

BURNHAM:

Edgar; 1865 - 1923. (B)
Minnie, wife of Edgar; 1868 - 1942. (B)

CARNAHAN:

Matilda; 1860 - 1949. (D)
L. K.; 1854 - 1919. (D)
Benjamin M.; d. Apr 14, 1876; age ---. (D)
Cinderella E., dau of C.J. & M.A.; d. ---, 186-; age ---. (D)
Mary A., wife of C.J.; Oct 6, 1838 - Jun 26, 1867. (D)
James (no dates). (D)
James H.; 1812 - Jun 20, 1886; age 73y 5m 17d. (D)
Cynthia A.; 1814 - 1903. (D)
Irvin, son of L.K. & M.; Nov 15, 1890 - Dec 5, 1894. (E)

CARTER:

Sarah E., dau of S.L. & A.J.; d. Apr 12, 1864; age 1y 8m 10d. (C)

CHAMBERS:

James M.; d. Apr 15, 1863; age ?5?y 7m. (E)
Infant of T.F. & S.M.; d. Mar 24, 1883; age 4m 20d. (E)
Abigail, dau of T.F. & S.M.; d. Aug 29, 1882; age 2y 1m 5d. (E)

CHIPMAN:

Katie A.; 1874 - 1957. (C)
Arda D.; 1874 - 1947. (C)

COMER:

Robert; 1803 - 1880. (D)
Nancy, wife of Robt.; 1812 - 1875. (D)
John; 1833 - 1846. (D)
Jesse; 1836 - 1853. (D)
Martha M.; 1847 - 1849. (D)
George W.; 1851 - 1853. (D)
Milton; 1854 - 1863. (D)
Two infants; (no dates). (D)
(Latter 7 were all children of Robt. & Nancy Comer)

CORDELL:

Sarah, wife of Collin; Oct 7, 1833 - Nov 19, 1891. (C)
J. W.; (no dates). (C)
David Mortimer, son of J.W. & D.A.; d. Dec 12, 1889; age 25d. (C)
Sarah E.; Mar 18, 1860 - Apr 3, 1920. (C)
Elizabeth H.; d. Aug 8, 1868; age 46y 6m 24d. (Location not certain; stone located against fence in east side of section D).

CREEL:

Infant dau of M.L. & L.H.; (no dates). (D)

DAILEY:

Jane, wife of P.H.; d. Apr 9, 1871; age 17y 11m 6d. (E)

DAVID:

Elizabeth; 1863-1945. (B)
Shelton; 1859 - 1894. (B)
Ina Ethel, dau of H. & S.A.; d. Sep 11, 1890; age 10m 15d. (C)
Infant dau of H. & S.A.; d. Jun 26, 1901. (C)

D'CAMP:

Charles F., son of C.S. & S.A.; d. Mar 30, 1874; age 11m 30d. (C)
Joel; d. Jul 9, 1848, in his 51st year. (C)
Jeremiah, son of Joel & M.; d. Dec 6, 1854; age 27d. (C)

DEOBLER:

Harry; 1888 - 1945. (A)
Ethel; 1886 - ----. (A)

DEWITT:

John M.; 1883 - 1932. (B)
Deliliah J.; 1882 - 19--. (B)
Eva L.; 1874 - 1962. (B)
Luster L.; 1879 - 1955. (B)
Arthur D.; 1910 - 1910. (B)

DIXON:

Hannah, dau of A. & E.; d. Nov 22, 1870; age --y 2m 22d. (E)

DUNCAN:

Julia Ann, wife of Dr. B.A.; d. Nov 1, 1863; age ---. (D)
Jonathan, son of B.A. & Julia; killed Sep 29, 1867; age 14y 7m 29d. (D)

DUNCAN (cont'd):
 Dr. Basil A.; d. Mar 31, 1877; age 51y 11m 25d; Co A 138th
 Ill Inf. (D)

ELSBURY:
 Rhoda M.; 1871 - 1942. (A)
 W. Wilmer; 1868 - 1938. (A)
 Mary Everella; 1864 - 1941. (E)
 Martha J.; 1842 - 1925. (E)
 Dayton; d. Aug 8, 1882; age 15y 2m. (E)

FOWLER:
 Fred; 1885 - 1954. (B)

GOBLE:
 James D.; Dec 19, 1814 - Nov 10, 1894. (E)
 Amanda, wife of James; Sep 19, 1818 - Sep 10, 1892. (E)

GOMER:
 Caleb; d. Apr 10, 1875; age 24y 2m 21d. (E)

GORSUCH:
 Carlos E.; Apr 18, 1911 - Aug 9, 1944; Tec 5 US Army. (D)

GRAY:
 Katie M.; Oct 12, 1875 - Jul 12, 1902. (E)
 John N.; Jul 3, 1873 - (no other date). (E)

GREENUP:
 Martha A. Vance; 1830 - 1910. (C)

HANKINS:
 Middy, wife of Wm.; d. Oct 16, 1857; age 24y 6m 19d. (C)

HARKRADER:
 Martha Jane, wife of Joseph; d. Nov 2, 1860; age 39y 7m 17d. (D)
 Infant children of J. & M.; d. Feb 10, 1857 & Oct 24, 1860. (D)

HINSHAW:
 Ida A.; 1869 - Jan 5, 1872; age 2y 10m 21d. (E)
 Charles E.; 1870 - 1918. (E)
 Louie; 1875 - 1929. (E)
 Addie; 1874 - 1931. (E)
 Nathan; d. Aug 12, 1874; age 74y 1m 14d. (E)
 Dinah, wife of Nathan; d. Jun 21, ----; age 80y 16d. (E)
 Jesse S.; d. Mar 28, 1894; age 54y 4m. (E)
 Tamar; Oct 6, 1833 - Feb 1, 1902. (E)

HORTON:
 Sarah E. (See ROE).

HUSHAW:
 Jesse; d. Oct 29, 1849; age 6y 6m 11d. (C)
 Joseph; d. Sep 3, 1844; age 2y 7m 6d. (C)
 (Above 2 were children of J. & T. Hushaw)
 James F., son of ?H.? & E.; Jun 2, 1861 - Jun 18, 1864. (C)
 Jacob A.; Aug 28, 1851 - Aug 30, 1852. (C)
 Henry L.; Apr 11, 1858 - Apr 24, 1858. (C)
 (Above 2 were sons of Sam'l & Catherine Hushaw)
 Robt M., son of J. & A.; d. Jan 8, 1889; age 4y 24d. (C)
 Jacob E., son of J. & A.; d. Jul 6, 1890; age 7y 7m 9d. (C)
 Mary J.; Aug 9, 1829 - Dec 28, 1908. (D)
 Samuel; Oct 1, 1825 - Aug 18, 1902. (D)
 John; d. Sep 22, 1875 - age 74y 9m 8d. (D)
 Tamer, wife of John; d. Dec 29, 1875; age 70y 10m 15d. (D)

HUSHAW (cont'd):

Emily J.; Sep 4, 1839 - Apr 2, 1917. (D)
Henry; Sep 27, 1828 - Jan 20, 1902. (D)
Samuel P.; 1871 - 1943. (D)

HENDRICKSON:

Lydia M.; 1882 - 1960. (A)
Isaac P.; 1872 - 1949. (A)
Mary L.; 1850 - 1935. (A)
J. T.; (no dates); Corp Co I 10th Mo Inf. (A)
James O.; Nov 23, 1877 - Feb 17, 1950; Pvt 38th Co Ill
Coast Art. (A)

JEWISON:

Infant dau of W.R. & L.M.; d. Oct 7, 1893. (E)
Luella Lawyer, wife of W.R.; Dec 1, 1864 - Oct 13, 1897. (E)

KALTENBACHER:

J. W.; Feb 14, 1886 - Dec 7, 1912. (D) (NOTE: No stone
here; information from a metal marker from Turnbull Funeral
Home, Monmouth, Ill.).

KEE:

Samuel; Mar 7, 1847 - Feb 9, 1929. (A)
Edith E. Marshall, wife of Sam'l; Mar 21, 1853 - Mar 31,
1923. (A)
William; d. Jul 18, 1882; age 76y 6m 13d. (E)
Mary, wife of Wm.; d. May 10, 1890; age 82y 6m 24d. (E)
Viola (See Michaelis).

KELLY:

Ella M.; 1879 - 1963. (B)
William D.; 1878 - 1960. (B)
Alma Elsie; d. Oct 5, 1974; age 71y 4m 17d. (B)

KERR:

Rosetta, dau of A.P. & M.M.; d. Jun 13, 1886; age 21y 20d. (C)
Children of L.D. & Sarah D.; (no names nor dates). (C)

KNOTT:

Clara; 1862 - 1937. (B)
James B.; 1857 - 1945. (B)
Harvey S.; 1897 - 1958. (B)

LAWYER:

Mattie S.; 1870 - 1922. (A)
Joseph F.; 1858 - 1915. (A)
Atha H.; 1868 - 1967. (A)
Charles B.; 1874 - 1939. (A)
George W., son of J. & M.J.; d. Aug 10, 187-; age ----. (D)
Michael; d. Aug 27, 1898; age 65y 11m 5d. (E)
Manerva, wife of Michael; d. Mar 24, 1900; age 65y 9m 7d. (E)
Luella (See JEWISON).

LEIGHTY:

-----; d. ----, 1957. (C)

LINDSEY:

Don; 1894 - Sep 14, 1928; Pvt 1st C 106th Am Tr 31st Div. (A)
Nora; 1893 - ----. (A)
Ralph; 1904 - 1961. (A)
Melvin; Oct 14, 1897 - ----. (A)

LINDSEY (cont'd):

Glenn; Mar 22, 1893 - Apr 28, 1964. (A)
Nathan E.; Oct 21, 1864 - Jun 18, 1948. (A)
Sarah A.; Jan 11, 1870 - Nov 30, 1958. (A)
Otis; Sep 4, 1901 - ----. (A)
Ila Lucille; 1910 - 1948. (A)
Earl; 1899 - 1946. (A)

MAGERS:

Leona B., dau of W.T. & M.E.; d. Aug 12, ----; age ----. (C)

MARSHALL:

Edith E. (See KEE).

MATHENY:

Sarah; 1859 - 1921. (B)
George; 1851 - 1923. (B)
Lucy M.; Sep 8, 1894 - Nov 4, 1956. (B)
Everett L.; Mar 23, 1891 - Apr 3, 1955. (B)

MC KELVEY:

Sarah Ann, wife of Geo.; d. Oct 20, 1893; age 86y 10m 2d. (E)

MERRICK:

George D.; Oct 7, 1847 - Sep 14, 1858. (E)
Charles W.; Mar 28, 1845 - Mar 20, 1865. (E)
Mercy, wife of David; 1793 - Sep 29, 1866. (E)
John D.; May 5, 1843 - Jan 17, 1903; Corp Co H 55th Ill Inf. (E)

MICHAELIS:

Viola Kee; 1864 - 1939. (A)

MILLER:

Infant dau of R. & L.; Oct 22, 1897. (C)
Infant son of R. & L.; Dec 27, 1894. (C)
Wardie Lester, son of R. & L.; Jan 14, 1891 - Feb 9, 1900. (C)
J. M., son of J.W. & L.A.; b. Feb 29, 1860; d. Jan 5, 1931. (C)
Louisa A., wife of J.W.; d. Jul 6, 1879; age 39y 9m 10d. (C)
Lizzie A., dau of J.W. & L.A.; d. Jan 4, 1877; age 5y 9m 2d. (C)

MORGAN:

Emma L., dau of W.R. & M.E.; d. Sep 5, 1862; age 11m. (C)

MORRISON:

Charllotte; Feb 10, 1868 - Apr 19, 1955. (A)

MOSSER:

Albert Lee, son of J.F. & M.E.; d. May 13, 1862; age 1y 3m 22d. (D)

NEBERGALL:

William T., son of J. & M.; d. Aug 26, 1854; age 2y 1m 16d. (C)

PARKS:

Charles; 1896 - 1959. (B)

QUAIFE:

Gordon W.; 1921 - 1970. (A)

RAKESTRAW:

Virginia; 1869 - (no date). (D)
Marshall; 1871 - 1932. (D)

REED:

C. R.; d. Dec 1, 1859; age ----. (D)

RENNER:

Freddie; 1912 - 1954. (A)

RHOADES:

Alice E.; 1886 - 1960. (A)
William E.; 1882 - 1963. (A)

ROE:

Rosa B.; 1884 - 1955. (B)
Walter; 1878 - 1954. (B)
Sarah E. Horton, wife of Wm.; 1858 - 1920. (B)
William S.; 1856 - 1908. (B)
Clem Ivan; 1894 - 1930. (B)
Harry W.; 1886 - 1962. (B)

RUSSELL:

Mary Alta; 1881 - 1962. (A)
George W.; 1879 - 1950. (A)
Eleanor E.; Feb 6, 1908 - Jun 1, 1972. (A)
Ghlee L.; Jan 14, 1909 - Dec 13, 1957. (A)
George W.; 1853 - 1919. (B)
Malinda, wife of Geo.; 1858 - 1940. (B)
Della, dau of G. & M.; 1891 - 1911. (B)
Sidner Hogan; May 17, 1856 - Jun 27, 1885. (C)
Eva, dau of G.W. & M.; Aug 19, 1883 - Apr 29, 1885. (D)

SCHRODER:

Margaret M., wife of C.; d. Nov 21, 1887; age 66y. (C)

SHANNON:

William; d. Jan 23, 1866; age 61y 1m 11d. (Location not known;
stone located against east fence in section D.)

SKILES:

Mattie; 1866 - 1918. (C)
Ida A., dau of Eld. James R. & A.M.; d. Jun 18, 1883; age 18y
1m 24d. (E)
Bertie, son of F.M. & M.A.; d. Oct 18, 1877; age 1y 8m 11d. (E)

SPRINGER:

John W., son of W.L. & Mary V.; Dec 31, 1870 - Nov 20, 1890. (C)
William L.; Aug 9, 1833 - May 23, 1901. (C)
Mary V., wife of Wm.; Oct 1, 1830 - Apr 5, 1908. (C)

STANDARD:

Ica A.; Dec 11, 1888 - Jul 25, 1971. (A)
Roy; Apr 15, 1889 - Sep 23, 1952. (A)
Sherod R.; Apr 28, 1833 - Aug 31, 1911. (C)
Almira J., wife of S.R.; Mar 12, 1841 - May 11, 1915. (C)
Nettie; Dec 2, 1862 - Dec 23, 1943. (D)
John B.; Nov 10, 1862 - Oct 14, 1930. (D)
Ethel, dau of John Barnett & Lucy Duncan Standard; Feb 16, 1882 -
Nov 10, 1955.
Cora, dau of G.S. & L.S.; Dec 7, 1883 - Mar 11, 1887. (D)
Gideon; Sep 5, 1860 - Jan 25, 1908. (D)
Leanta, wife of Gideon; Oct 31, 1861 - Feb 9, 1936. (D)
Wayne, son of G. & L.; Mar 1, 1894 - Jan 5, 1915. (D)
Martha B.; Dec 29, 1844 - Feb 14, 1914. (D)
J. B.; Jun 23, 1824 - Apr 1, 1889. (D)
Sarah J., wife of J.B.; d. Sep 25, 1876; age 52y 4m. (D)
Matilda; d. Aug 20, 1871; age 17y 15d. (D)
Andrew A.; d. Nov 6, 1853; age 11m 3d. (D)
(Latter 2 were children of J.B. & S.J. Standard)

STANDARD (cont'd):

G. T.; d. Jan 25, 1867; age 66y. 3m. (D)
Sina, wife of G.T.; d. Apr 9, 1880; age 74y 2m 3d. (D)
James M.; d. Oct 1, 1862; age 24y 2m 1d. (D)
Lilly G., dau of S.R. & A.J.; d. Aug 29, 1868; age 1m 19d. (D)
Infant son of W.A. & L.B.; Nov 17 - Dec 5, 1897. (D)
William G.; Mar 20, 1836 - Sep 7, 1885. (D)
Maria E., wife of Wm. G.; Dec 17, 1837 - Jun 3, 1917. (D)
Sidner E., son of W.G. & M.E.; Dec 17, 1861-Sep 26, 1869. (D)

SULLIVAN:

Sarah E.; d. Sep 21, 1867; age 1m 20d. (D)
William A.; d. Sep 30, 1868; age 2m 10d. (D)
(Children of H. C. & C. M. Sullivan)

SWISHER:

Eliza E., dau of J. & P.; d. Nov 21, 1856; age 5y 1m 3d. (C)

THARP:

Marion, son of J. & A.E.; d. Apr 23, 1868; age 7m 13d. (E)

TONNER:

W. W.; May 16, 1838 - Jan 4, 1906. (D)
Nathan; Oct 15, 1806 - Apr 24, 1899; age 86y 6m 9d. (D)
Rachel Wyckoff, wife of N.; Apr 10, 1810 - Apr 17, 1892; age
82y 7d. (D)

VANCE:

Eleanor, wife of James; d. Aug 2, 1888; age 73y 9m 26d. (C)
James; d. Sep 27, 1872; age 65y. (C)
James; Sep 3, 1764 - Oct 7, 1835. (C)
Margaret, wife of James; Sep 21, 1762 - Oct 16, 1850. (C)
Nancy, dau of J. & M.; Oct 5, 1786 - Dec 30, 1851. (C)
Mary, dau of James & Margaret; d. Feb 8, 1873; age 90y 1m
7d. (C)
William R.; d. Nov 24, 18~~57~~⁵⁷; age 78y 4m 6d. (C)
Elizabeth, wife of Wm. R.; d. Oct 13, 1872; age 63y 10m 11d. (C)
C. F.; Nov 19, 1848 - (no date). (C)
E. F., wife of C.F.; Mar 30, 1852 - Jun 23, 1901. (C)
"Little" Roy, infant son of C.F. & E.F.; 1 week (no dates). (C)
Willie P., son of C.F. & E.F.; age 1y 7m; (no dates). (C)
Martha A. (See GREENUP).

WALRAVEN:

Harvey C.; 1887 - 1965. (B)
Rosa B.; 1883 - 1954. (B)
Rose; Feb 24, 1917. (B)
Rosalee; Feb 24, 1917. (B)
Rosezora; Feb 24, 1917. (B)

WEST:

Martha Anna, dau of Wm. & Catherine; d. Feb 21, 1886; age 9y
7m 18d. (C)

WHEELER:

Earl Lee; d. Oct 6, 1974; age 51y 8m 7d. (A)
Ethelyn F.; May 28, 1883 - Nov 30, 1886. (C)
Ernest M.; 1881 - 1944. (C)
"Baby"; b. Feb 11, 1879; (no other date). (C)

WHITING:

John E., son of J.T. & A.C.; 1873 - 1876. (E)

WILHELM:

Andrew J.; May 11, 1833 - Dec 17, 1909. (C)
Susanna Wilson, wife of A.J.; Apr 24, 1837 - Dec 21, 1864. (C)

WILSON:

Bertha N.; 1882 - 1967. (B)
Calvin L.; 1884 - 1967. (B)
Nora; 1881 - 1943. (B)
Guy; 1873 - 1941. (B)
Katharine; b. & d., 1912. (B)
Arden M.; 1905 - 1965. (B)
Clarissa R.; 1841 - 1917. (C)
James V.; 1835 - 1921. (C)
Magnetie F.; 1872 - 1922. (C)
Bernice; 1876 - 1924. (C)
Alba J.; 1879 - 1880. (C)
Dollie; 1887 - 1887. (C)
Infant son of W.V. & E.; d. Oct 18, 1874. (C)
Martha M., dau of W.V. & E.; d. Apr 16, 1864; age 1y 1m 13d. (C)
William V.; Sep 6, 1838 - Feb 19, 1908. (C)
Elizabeth, wife of Wm.; Aug 23, 1840 - Jan 16, 1910. (C)
Abby Ruth, dau of W. & S.; May 5, 1893 - Feb 9, 1894. (C)
Martha R., wife of John; d. Apr 26, 1881; age 76y 11m 10d. (C)
John; d. Jan 18, 1886; age 79y 2m 16d. (C)
Harriett; Apr 22, 1835 - Dec 21, 1910. (C)
Hugh; Apr 4, 1832 - Jan 16, 1912. (C)
Milo; 1857 - 1929. (C)
Caroline; 1870 - 1955. (C)

WYCKOFF:

Rachel (See TONNER).

YOUNG:

Elizabeth Ann, wife of John; d. Jul 16, 1857; age 27y --m
14d. (C)
Marilla B., wife of J. P.; Jan 4, 1861 - May 20, 1899. (C)

Genealogical Notes - Vance Cemetery

BENNETT: John Riley (1845-1915), b. Warren Co., Ohio Jan 10, 1845; son of George & Matilda (Brown) Bennett; moved to this county with parents in 1850; md. Jul 4, 1866, to Columbia Sanders; had a son, Edgar, b. Nov 4, 1867 & d. at age 2 yrs; John & Columbia adopted a daughter, Cora, who later md. a Macomb jeweler, A. E. Rush.

Columbia Ann (1848-1927), b. in Schuyler Co., Ill., daughter of James & Maria (Lewis) Sanders; James, b. in Ill; Maria, b. Ala.; Columbia's maternal grandparents were Abram and Elizabeth (Davis) Lewis, natives of Ala.

Matilda (1825-1860), b. Warren Co., Ohio; daughter of John Brown, native of Pa.

George (1819-1885), b. in Ohio; md. there to Matilda Brown; son, John R., b. in that State; moved to Ill., 1850; lived

BENNETT (cont'd): in Industry Twp.; after the death of his wife in 1860, Geo. then md. Maria ---; they had a daughter, Belle, who later md. a Mr. Miller & moved to Knox City, Mo. Geo. Bennett was killed in 1885 by a runaway team of horses.

BOTCHLETT: B. F. (1833-1895), b. in Pa.; came to this county in 1854; operated a boot & shoe business in Industry.

Elizabeth (1839-1909) (Obit, in part, from The Macomb Daily Journal, Mar 5, 1909): "Mrs. Elizabeth Botchlett died at her home in Blandinsville, Mar 3, 1909, at 12:30 p.m. Elizabeth McKelvey was born in Franklin Co., Pa. Dec 19, 1838, being 70 years, 2 months, and 14 days old. She came to Illinois about 30 years ago and has lived in Blandinsville most of the time. She was married to Adam Botchlett about 45 years ago and to this union three children were born, one dying in infancy, the two children living are George of Rock Island, Ill. and Mrs. Lee Wilson of Blandinsville....."

BRIDGES: John (1797-1844), b. in N. C.; md. Margaret Vance in the State of Tenn. in 1816; moved to Morgan Co., Ill., 1823; to this county, 1829; lived in Industry Twp. The 1830 federal census indicates the Bridges family consisted of the following members: 6 girls under age 15 years; a boy between 5-10 years old; a male between age 20-30; and a male between 30-40 years; 2 females, one aged between 30-40 years, and another between 50-60. Mr. Bridges appears as # 462 on the 1840 county tax list. He owned 80A in the NE $\frac{1}{4}$ of section 14, Industry Twp.; also \$135.00 worth of horses, \$65.00 cattle, \$10.00 clocks & watches, \$10.00 wagons, & \$170.00 in other property; taxes were \$3.95.

BURNHAM: Edgar (1865-1923). Charles Edgar Burnham was b. in Schuyler Co., Ill. Oct 3, 1865, a son of Edgar & Caroline (Armstrong) Burnham; Edgar, Sr., b. in N. Hampshire; Caroline, a daughter of John Armstrong, natives of Pa.; Edgar, Jr. was the 4th of 14 children b. to his parents; the family moved to this county in about 1872; Charles Edgar had a brother, John; on Feb 7, 1894, Edgar md. Minnie Wilson, a native of Industry Twp.; they had 4 children: Hugh Wilson, Edgar Wilson, Roy King, and Carl Hobart.

Minnie (1868-1942), wife of Chas. Edgar Burnham; a daughter of Hugh and Harriet (Hobart) Wilson.

CARNAHAN: James H. (1812-1886), a son of Aaron & Elvira (Mitchell) Carnahan, of Ohio; Aaron b. in Tenn.; Elvira, b. in Ky.; James b. in Clinton Co., Ohio; md. Aug 25, 1836, to Cynthia A. Murphy; moved to Ill. in 1852; Lived in Scotland Twp., this county; also lived in Mason Co., Ill., then moved to section 11, Industry Twp.; had 7 children: Anna M., Chas. J., Safronious, Sarah A., Benjamin, Lafayette K., & Mary I.

- CARNAHAN (cont'd): Benjamin M. (d. 1876); killed enroute to the West; a gun discharged after he jumped from a wagon at Coatsburg.
- CHAMBERS: Thomas F., father of the children listed on page 28, farmed on section 25, Industry Twp.; he was a native of Va., & moved to this county in 1855 from Washington Co., Iowa.
- CHIPMAN: Katie A. (1874-1957), wife of Arda D.; daughter of Wm. V. & Elizabeth (Wilhelm) Wilson.
- COMER: Robert (1803-1880), son of Jesse, a native of N. C.; Robt. b. near Chilicothe, Ohio; md. Nancy Wilkinson; moved to this county in 1836, from Franklin Co., Ind.; had 10 children; in addition to those buried in this cemetery, a son, Joseph, was b. in Eldorado Twp., Aug 23, 1839; a daughter of Robt. md. Thos. Lawyer. Robt. Comer appears on the 1840 county tax list as # 480. He owned \$225.00 worth of horses, \$254.00 cattle, \$75.00 wagons, \$40.00 cash loaned out, \$150.00 in other property; no real estate; taxes were \$3.72. In 1860, the following individuals were residing in the Comer household in Eldorado Twp.: Robt.; wife, Nancy; son, Joseph; Nancy, age 17; Milton, age 5; also living with the Comers was a 14-year-old boy, Sam'l Lateen, b. in N. J.
- CORDELL: Sarah (1833-1891), wife of Collin; daughter of John & Martha (Vance) Wilson. Sarah b. in Industry Twp.; md. Collin Cordell Mar 9, 1862; had one son, James W.; Collin enlisted in the army Aug 9, 1862; wounded at Vicksburg May 16, 1863; died at a Memphis, Tenn. hospital on Jun 6, 1863; buried at Memphis; Mrs. Cordell continued to live on her 80 acre farm in Industry Twp. till her death; she received a pension from the U.S. Gov't.
- James W., son of Collin & Sarah (Wilson) Cordell, b. in Industry Twp.; md. Dora A. Justus on Apr 3, 1884; had Evalina & David M.
- DAVID: Shelton (1859-1894), a son of Felix & Rebecca David; b. in this State; a brother to Abraham, John, & Thomas.
- D'CAMP: Joel (1797-1848) b. in Pa.; md. Matilda Bridge in Ohio & moved to Fulton Co., Ill. in 1839; thence to this county in about 1847; farmed in Eldorado Twp. A daughter of Joel & Matilda, Elizabeth, md. Wm. Legere in 1858; Wm. was killed in Louisiana during the Civil War; Elizabeth then md. Chas. F. Skiles, who died in 1876.
- DUNCAN: Basil A. (1825-1877), b. in Frankfort, Pa., Apr 6, 1825; studied medicine in Pittsburgh; md. in 1845, to Julia Standard; moved to this county, 1849; practiced medicine in Industry for 28 years; after the death of his first wife in 1863, Dr. Duncan then md. Martha Merrick, Nov 8, 1864. Martha (Merrick)

DUNCAN (cont'd): Duncan md. J. Barnett Standard after the death of Dr. Duncan.

GOBLE: James D. (1814-1894), b. in N. J.; a shoemaker by trade; md. Amanda Danley; lived in Whitney Co., Ind. before moving to this county in 1868; had 13 children including Edward Durphy Goble, b. in Ind. in 1862.

HINSHAW: Jesse B. (1839-1894) d. at Industry. His sister, Tamar Hinshaw, cared for him prior to his death.

HUSHAW: John (1801-1875) moved to this county in 1838; wife was the former Tamar Conner; children included: Sam'l (1825); Henry (1828); Ellen (b. in Ind., 1837); John (b. in Ill., 1838); Joseph (1842); Jesse (1843); Elizabeth (1845); and Isabel (1847). John Hushaw appears as # 479 on the 1840 county tax list. He owned 160 acres, the SE $\frac{1}{4}$ of section 13, Industry Twp.; also \$100.00 worth of horses, \$220.00 cattle, \$50.00 wagons, & \$132.00 in other property; taxes were \$5.71.

Henry (1828-1902), son of John & Tamar (Conner) Hushaw; b. in Fountain Co., Ind.; moved with parents to this county in 1838; md. May 3, 1860, to Emily J. Little of Fulton Co., Ill.; had 6 children: Mary A., Charles R., Athie E., Sam'l P., Addie, and J. Evert.

KEE: Samuel (1847-1929) b. in Cochocton Co., Ohio; son of Wm. & Mary (Fisher) Kee; Wm. b. in Md.; Mary, a native of Brownsville, Pa.; paternal grandfather, Andrew Kee, b. in Md.; maternal grandfather, Jacob Fisher, from Pa.; Wm. Kee & family moved to Fulton Co., Ill. then to this county in about 1854; lived in Eldorado Twp.; Sam'l the youngest of 7 children, md. Mar 28, 1876, to Edith E. Marshall; Sam'l then bought a farm across from his father's place in Eldorado Twp.

Edith E. (1853-1923), b. Vermont, Ill.; daughter of John S. & Harriet (Asher) Marshall; John, b. in Cadiz, Ohio; he d. in Vermont, Ill.; Harriet b. in Paducah, Ky., d. Feb 8, 1890; Edith's paternal grandparents were Wm. & Sarah Marshall. (Obit in part, from the Macomb Daily Journal, Apr 5, 1923): "Edith Ermine Marshall, second daughter of John & Harriett (Asher) Marshall, was born near Vermont Mar 21, 1853 and died at her home, four miles east of Industry, on Saturday, Mar 31, 1923, being 70 years and 10 days old. Death came as a result of a stroke of paralysis, suffered in March, 1920 married Samuel Kee on March 28, 1876 Of her father's family she is survived by one sister, Mrs. Helen McFadden, and one brother Robert Marshall. A sister, Theodosia Edie, died in 1911 their home was never blessed with children. For many years she was mother in fact though not in name, to Leta Easley, now Mrs. Liver Rauch, and Edith Easley, both now residents of Chicago..."

William (1806-1882), b. in Md.; wife, Mary, from Pa.; had 7

KEE (cont'd): children, all b. in Ohio; they included:
Eliza (1839); Martha (1843); Mary (1845); & Sam'l (1847).

LAWYER: Joseph F. (1858-1915), b. in this county; son of Thos. & Catherine (Comer) Lawyer; md. Mar 2, 1892, to Martha S. "Mattie" Vail; had 4 children: Gladys K., T. Dwight, Herbert C., and J. Meredith. Joseph's parents buried at Chockley Cem.

Mattie S. (1870-1922), b. in Industry Twp.; parents, Christopher and Sarah (Dace) Vail, buried at Vail Cem.

Michael (1832-1898)(Obit, in part, from The Macomb By-Stander, Aug 31, 1898): "Another of the few remaining pioneers of McDonough county passed away in the death of Michael Lawyer, which occurred Saturday, Aug 27, at his late home in Industry, after an illness of some time Michael Lawyer was born in Fayette Co., Ohio, Sep 22, 1832, and lived 66 years, less 25 days. He was a son of John & Massie (Cooper) Lawyer, the former a native of Virginia and latter of Ohio. In 1837, he came, with his parents to Industry township, where they lived two years and then moved to Eldorado township. He and Sarah E. Kee were married on Sep 27, 1857, and to them four children were born, the sole survivor being William K. Lawyer of Scotland township. This union was separated by death in 1865. In 1868, deceased was united in marriage with Manervia Downen, widow of David Downen, and to them were born four children, John W., and Katie M., being the survivors. The wife also survives ". Mr. Lawyer's first wife, Sarah, and some of his children are buried at Chockley Cem.

MATHEMY: Sarah (1859-1921)(Death notice, in part, from The Macomb Daily Journal, Nov 3, 1921): "Mrs. G. M. Matheny died at her home three miles southeast of Industry Tuesday evening at 9:00 o'clock, aged 62 years. Death was caused from anemia, with which she had been a suffered for many months.....".

MERRICK: John D. (1843-1903)(Obit, in part, from The Macomb Times, Jan 22, 1903): "John D. Merrick died at 12:30 o'clock last Friday night at the home of his daughter, Mrs. George Standard in Eldorado township, of general debility, aged 60 years; 7 months, and 10 days. Deceased was born June 6, 1842; in Oct., 1866, was united in marriage with Mary C. Leach. He served during the Civil War and was wounded in the battle at Kenesaw Mountain. His brother, Charles, was killed in battle at Bentonville, Ga. He is survived by four children, Mrs. Ednes Kimball of Casper, Wyo.; Mrs. Sallie Standard of Eldorado township; Morris Merrick of Vermont, Ill.; and Mrs. Blanche James of Rock Island."

Charles W. (1845-1865) enlisted in the army at Industry on May 24, 1861; served as a private with Co A 16th Ill Inf.

MILLER: Louisa A. (1839-1879), wife of John W.; maiden name was Russell; md. Mr. Miller Apr 7, 1859; had 5 children: James M.,

MILLER (cont'd): Mary E., Lewis R., Genaria M., and Amy Elizabeth. After Louisa died in 1879, John W. married Dilsey C. Fulton of Macomb township on Mar 3, 1881.

MOSSER: Albert L. (1861-1862) a son of Jacob F. & Mary (Cordell) Mosser. Jacob, an Industry merchant, was a son of John & Susan (Frankhouser) Mosser, natives of Virginia; Jacob & Mary had 2 other children: Chas. W. & Eva Leona.

RUSSELL: George (1853-1919), son of James & Eva Russell; Geo. b. in Ill. and a brother to Matthew, Mary, Joshua, Asel, Sidnor, and Lawrence. George's mother, Eve, and a brother, Matthew, are buried in Chockley Cem.

Malinda (1858-1940), wife of Geo.; a daughter of J. Barnett & Mary Jane (Allison) Standard.

SCHRODER: Margaret M. (1821-1887), wife of Carriston; b. in Tenn.; Mr. Schroder was a native of Hanover, Germany; they had the following children, all b. in Ill.: Andrew, William, Martha, James, Lucinda, and twins - Commodore & Theodore.

SHANNON: William (1804-1866), b. in Tenn., Sep 12, 1804; son of Chas. Shannon who d. in 1858; Wm. moved to this county in 1830 from Knox Co., Tenn.; md. here to Mary Miller on Jan 12, 1832; raised 9 children: Rachel A., Elizabeth A., Nellie E., Chas. R., John F., James P., William H., Harvil M., and George G.

STANDARD: Gideon (1800-1867). G. T. b. in N. C.; wife, Sina, b. in Tenn.; the following children b. in Ill.; Geo. (1841); Ellen (1844); Martha (1847); & Lucy (1848). Mr. Standard appears as # 486 on the 1840 county tax list. He owned 240A in sections 23 & 24, Industry Twp.; also had \$150.00 worth of horses, \$120.00 cattle, \$10.00 clocks & watches, \$50.00 wagons, and \$241.00 in other property; taxes were \$8.86; residence was in the SW $\frac{1}{2}$ of section 24, Industry Twp.

J. B. (1824-1889); John Barnett Standard b. in Ky., son of Gideon T. & Sina (Wyatt) Standard; moved to Morgan Co., Ill. in about 1832; to this county, 1836; lived in Industry Twp.; J. B. md. in 1849, to Jane Allison, daughter of John Allison; they had 9 children: Mary (Mrs. Jerome Jones of Scotland Twp.); Margaret (Mrs. Thomas Jones of Clay Co., Nebr.); Julia (Mrs. E. F. Wheeler of Kansas City); Malinda (Mrs. Geo. W. Russell of Bethel Twp.); Gideon; John; George; Matilda; & Andrew J. After the death of his wife, Mary Jane, in 1876, J. B. then married Martha Lucy (Merrick) Duncan, widow of Dr. B. A. Duncan; J. B. and his second wife had 2 children: Fannie & Ethel.

SULLIVAN: Sarah & William, children of Henry C. & Catharine M. (Vance) Sullivan. Henry, a son of Wm. & Sarah A. (Adkisson) Sullivan, b. Nov 10, 1841, in Industry Twp.; Henry & Catharine had 8 children: Rosa C.; Sarah E.; Wm. A. & Eliza A. (twins); Nellie; Forest H.; Florence C.; & Lena. Henry was a brother

SULLIVAN (cont'd): to Thos. D. Sullivan; they operated a hardware business in Industry till 1894.

VANCE: James (1764-1835), b. in Franklin Co., Tenn.; moved to S. Carolina, then to this county in 1826; lived on section 24, Industry Twp.; md. Margaret Ramsey, native of Tenn.; they had 12 children. Mr. Vance held several county offices during the early 1830's and was Commissioner of School Lands when he died in 1835; Mr. Vance was the first to be buried in this cemetery. On the 1827 Schuyler-McDonough county tax list, Jas. Vance is shown to own \$212.00 worth of real & personal property; his taxes were \$1.06. On the 1830 federal census for Industry Twp., the James Vance household was as follows: 1 male 20-30 years old; 1 male between 60-70 years old; 2 females between ages 30-40; and a female between 60 & 70 years old. On the 1840 county tax list, Margaret Vance, widow of James, Sr., is shown as # 478; she owned \$75.00 worth of horses, \$87.00 cattle, and \$51.00 in other property; taxes were \$1.06.

James, Jr. (1807-1872) appears on the 1840 county tax list as # 477; owned 120 acres in section 13 & 14, Industry Twp.; also \$100.00 worth of horses, \$80.00 cattle, \$10.00 clocks & watches, \$30.00 carriages, \$30.00 wagons, & \$212.00 in other property; taxes were \$5.31. Residence was in the south half of the NE $\frac{1}{2}$ of section 14, Industry Twp.

WILHELM: Andrew J. (1833-1909) b. in Ark.; moved to this county in 1854 from Schuyler Co.; farmed on section 11, Industry Twp. A son of Welcome & Mary Wilhelm. He & Sussana's children included: Florence (1857); John (1859); and twins - Douglas & Johnson (b. 1860).

Susanna (1837-1864), wife of Andrew; daughter of John & Martha (Vance) Wilson. Susanna was a sister to Elizabeth A., Mary V., Hugh, Sarah V., James V., W. V., Christopher, Lewis R., Rufus R., Martha R., and Margaret R. V.

WILSON: John (1806-1886) son of Hugh; b. in Jackson Co., Tenn., Nov 2, 1806; moved with the family to Christian Co., Ky.; then to Mo.; to Schuyler Co., Ill. in 1825; and to this county in about 1827. Md. Martha R. Vance, Oct 30, 1828; that was the first marriage recorded in this county. On the 1830 federal census of Industry Twp., the John Wilson family consisted of John, his wife, and a daughter, under 5 years old. On the 1840 county tax list, John appears as # 451. He owned 120 acres in the NW $\frac{1}{2}$ of section 13, Industry Twp.; also, \$100.00 worth of horses, \$112.00 cattle, \$80.00 wagons, and \$186.00 in other property; taxes were \$4.19. The children of John & Martha R. Wilson were: Elizabeth Ann (1829); Mary V. (1830); Hugh (1832); Sarah V. (1833); James Vance (1835); Susannah (1837); W. V. (1838); Christopher (1839); Lewis R. and Rufus R. (twins-1841); Margaret T. (1843); and Martha R. (1845). Lewis & Rufus served for 3 years during the Civil War.

WILSON (cont'd): Hugh, father of John Wilson, died in Iowa. He was considered to be a true pioneer and John's mother apparently enjoyed the frequent moves to unsettled areas. She was quoted as saying that "the food always tasted better when they were moving." Hugh and his family moved from Tenn. to Ind. in 1814; then to Ky., Mo., and Ark. in that order; then, back to Mo., and in 1825, to Schuyler Co., Ill.; in 1826, they moved to this county; son, James then went on his own and settled in Industry Twp.; Hugh, however, moved to Hire Twp. and erected a small cabin on section 9 in about 1826; he and his family stayed there thru one harvest season, then moved on to Des Moines rapids; the latter move was reportedly caused by Indian threats.

Hugh (1832-1912), son of John & Martha (Vance) Wilson; b. in this county; md. Harriet Hobart, Jan 14, 1855; Hugh & Harriet had the following children: Nancy Ann (Mrs. W. P. Skiles - moved to Nebr.); Milo; Traverse (moved to Nebr.); Marilla B. (Mrs. J. P. Young); Mortimer; Carr (moved to Calif.); Edward (moved to Colo.); Minnie (Mrs. C. E. Burnham); Carrie; Guy; Roy (moved to Alma, Nebr.); and William (moved to Hedrick, Okla.).

Harriet (1835-1910), wife of Hugh; daughter of Wm. & Achsah (Ingraham) Hobart; Wm. was b. in Ireland; his wife, in N. Y.; the Hobarts moved to this county in about 1850; then moved to Iowa in 1859, and both died there. Harriet was the third of a family of 11 children.

James Vance (1835-1921), b. Dec 11, 1835; son of John & Martha (Vance) Wilson; b. in this county; md. Jan 22, 1856, to Permillia Adkisson, native of this co.; had 2 children: Paris (1856-1858) and Thomas. Permillia d. Feb 10, 1858; on Oct 11, 1858, Jas. Wilson md. Clara S. Adkisson; they had 14 children: John A. (1861); Leroy (1863); Amaranth (1865); Price (1867); Veronia (1869); Marguerite (1872); Eva (1874); Bernice (1876); Alva (1879); Nova (1881); Calvin & Melvin (twins-1884); and Dottie (1887).

William V. (1838-1908), son of John & Martha Wilson; md. Elizabeth Wilhelm; had a daughter, Kate (Mrs. Arda Chipman).

Elizabeth (1840-1910), wife of Wm. V.; daughter of Welcome & Mary (Price) Wilhelm; parents buried in Wilhelm Cemetery.

YOUNG: Marilla B. (1861-1899), wife of J. P.; daughter of Hugh and Marriet (Hobart) Wilson.

Notes, Corrections, Additions, and Changes

Vance Cemetery (cont'd):

Notes, Corrections, Additions, and Changes

Faint, illegible text, possibly bleed-through from the reverse side of the page.

William V. (1837-1898), son of John & Mary (1800-1860)
born William V. & daughter Mary (1837-1898)
Mary (1837-1898) wife of William V. (1837-1898)
John V. (1837-1898) son of William V. (1837-1898)
Mary (1837-1898) daughter of William V. (1837-1898)
Dottie (1887-1967) daughter of William V. (1837-1898)

William V. (1837-1898), son of John & Mary (1800-1860)
born William V. & daughter Mary (1837-1898)
Mary (1837-1898) wife of William V. (1837-1898)
John V. (1837-1898) son of William V. (1837-1898)
Mary (1837-1898) daughter of William V. (1837-1898)
Dottie (1887-1967) daughter of William V. (1837-1898)
Lewis & Rufus (1845-1898) twins
born Lewis & Rufus (1845-1898)
Lewis & Rufus (1845-1898) twins
born Lewis & Rufus (1845-1898)
Lewis & Rufus (1845-1898) twins
born Lewis & Rufus (1845-1898)

Wilhelm Cemetery

Location: Industry Township, NW $\frac{1}{4}$, Section 23; about a half-mile south southeast of Industry.

Remarks: This cemetery is located on privately owned ground and is about $\frac{1}{2}$ mile from any public road. Present condition is poor due to heavy overgrowth of brush and weeds and years of general neglect. The majority of stones are badly weather-worn and many are broken into several pieces; several monuments were located under sod and dead leaves. This graveyard is situated just a few hundred feet east of the Peak Cemetery.

AGNEW:

Benjamin F., son of S. & M.; d. Jul 4, 1857; age 2y 11m 2d.

Mary Ellen, dau of S. & M.; d. Oct 7, 1859; age 1y 4m 1d.

Elmer E., son of S. & M.; d. Sep 22, 1862; age 1y 1m 22d.

Edgar S., son of S. & M.; d. May 7, 1865; age 2y 2m.

BAYMILLER:

"Our Little Charlie", son of M. & M.A.; d. Apr 9, 1872; age 3y 5m 9d.

Mahala U., wife of M.; d. Mar 11, 1865; age 22y 7m 14d.

BUTCHER:

Bersheba A., wife of P.; d. Nov 7, 1869; age ---.

COCKERHAM:

Mary C., wife of D.L., & dau of J. & E. Pennington; d. Oct 4, 1850; age 19y 4m 28d.

HANKINS:

Joel, son of A.J. & L.A.; d. Oct 6, 1850; age 1y 2m 16d.

HUGHS:

"Little Kate", dau of H.W. & L.; d. May 2, 1870; age 3y 3m 26d.

PENNINGTON:

Donia, dau of D.A. & E.A.; d. Mar 27, 1882; age 24y 9m 23d.

Manerva, dau of D.A. & E.A.; d. Oct 1, 1873; age 13y 3m 13d.

Jabena G., dau of D.A. & E.A.; d. Nov 21, 1868; age 5y 4m 29d.

Infant dau of D.A. & E.A.; (no dates).

Mary E., dau of D.A. & E.A.; d. Oct 3, 1868; age 1y 9m 9d.

Sylvia E., dau of J.W. & M.J.; d. Jan 11, 1887; age 22y 6m 27d.

Ruth, dau of J.W. & M.J.; d. Mar 18, 1887; age 9m 12d.

Sarah D., dau of J. & E.; d. Sep 23, 1855; age 24y 4m 13d.

Joel; d. May 7, 1865; age 62y 2m 20d.

Elizabeth, wife of Joel; d. Feb 14, 1861; age 61y 8m 3d.

Allen; d. Jan 29, 1867; age 52y 2m 16d.

Mary C. (See COCKERHAM).

PRICE:

Mary Alice; d. Nov 9, 1859; age 1y 2m 29d.

Hannah E.; d. Sep 1, 1853; age 29d.

Samuel A.; d. Sep 1, 1853; age 11m 22d.

Sarah Jane; d. May 11, 1857; age 11m 9d.

(Children of T. J. & E. Price)

WILHELMS:

Mora E., dau of P. & M.; d. Feb 23, 1863; age 5m 16d.

WILHELMS (cont'd):

Mary, wife of Welcom; d. Dec 31, 1881; age 74y 11m 5d.
Welcom; d. Nov 11, 1871; age 61y 4m.

Genealogical Notes - Wilhelm Cemetery

AGNEW: The Agnew children were those of Samuel and Mary (Wilson) Agnew, who came to this State in 1847; they lived near Rushville in Schuyler Co., and in Bethel Twp., this county. Sam'l was b. near Buffalo, N. Y., Jul 12, 1820; he d. at Macomb on Nov 7, 1879; Mr. Agnew was a stone mason by trade; he and Mary Wilson were md. Dec 16, 1849, at Industry; she was a native of Columbia Co., Ohio; Sam'l & Mary had 8 children; in addition to those listed in this cemetery there were: Milton P., Henry C., George T., and Josie A.

BUTCHER: Bersheba A. (d. 1869), wife of Preston; he came to this county in 1861 from Schuyler Co., Ill. Mr. Butcher was a native of Ohio; farmed in section 4, Industry Twp.

COCKERHAM: Mary C., wife of D. L., was a daughter of Joel & Elizabeth (Smith) Pennington; Mary was b. in Schuyler Co., Ill. in 1831.

HANKINS: Joel (1849-1850), son of A. J. & Lydia A. (Pennington) Hankins; A. J. was a son of Fielden Hankins, native of Tenn.; Fielden was b. in 1787, & came to this county from Coles Co., Ill. in 1834; he later moved to Hire Twp., this county, where he died in 1881; he was buried at Vermont, Ill. A. J.'s mother was killed by a runaway team of horses in this county. A. J. & Lydia A. were md. Aug 28, 1845; she was a daughter of Joel & Elizabeth (Smith) Pennington. Lydia A. (Pennington) Hankins d. in 1885, and was buried at Good Hope. A. J. later lived in Blandinsville, Ill. where he ran a harness business.

PENNINGTON: Joel (1803-1865), b. in Ky. and moved to Schuyler Co., Ill. in 1826, remaining there for 10 years; while in that county, Joel served as sheriff for 7 years; prior to coming to Schuyler, the Pennington's lived a short while in Franklin Co., Ill. The 1830 federal census for this county; indicates that the Joel Pennington household included 2 boys & 2 girls, all under the age of 10 years. Joel & Elizabeth Smith were married in Ky. on Mar 14, 1822.

*When the 1830 federal census was taken, McDonough County was still considered a part of Schuyler, for records purposes.

Donia, Manerva, Jabena, an infant, and Mary were children of David A. & Elizabeth A. (Sharman) Pennington; David was a son of Joel & Elizabeth (Smith) Pennington and was b. Oct 8, 1828, in Schuyler Co., Ill. David & Elizabeth were md. in 1853; she was a daughter of Wm. Sharman, an early settler of

PENNINGTON (cont'd): this county. David and his wife had 7 children; in addition to the 5 named above, they had: Ruan B. & Arthur H. This Pennington family lived on section 10, Industry Twp.

Allen (1814-1867), b. in Ky.; in 1860, he was farming in Eldorado Twp., this county; his household, at that time, consisted of the following members: Wife, Hannah (b. in Pa. in 1817); William (b. in Ill., 1839); Melissa (b. in Texas, 1841); John (b. in Ark., 1843); Thomas (b. Ark., 1844); Frances (b. Ark., 1846); Sarah (b. Ill., 1848); Joel (b. Ill., 1851); and Martha (b. Ill., 1853).

PRICE: Mary, Hannah, Samuel, and Sarah were children of Thos. J. and Eleanor (Wilson) Price; Thos. was a son of Sam'l & Bersheba (Atchley) Price; natives of Tenn. Thos. was b. in Meigs Co., Tenn., Feb 23, 1828; the family moved to Schuyler Co., Ill. in 1830; then to Washington Co., Ark. where Thos. mother d. in 1834; the remaining members of the family then returned to Ill.; Thos. md. Jul 6, 1848, to Eleanor Wilson, native of Ohio; they had 8 children; besides those named above, they had: William; George W.; John M.; and Edward E. This family moved to Industry Twp. in about 1850. Eleanor (Wilson) Price d. in 1869; Thos. then md., on May 18, 1876, Maggie Miller, nee Van Hoesen. Sam'l, father of Thos., later moved to Macomb, then to Rushville, where he died at age 91.

WILHELM(S): Welcome (1810-1871) was a son of James Wilhelm, Sr., a native of Tenn. Welcome b. in Meigs Co., Tenn.; moved to Washington Co., Ark. in 1830; to Schuyler Co., Ill. in 1833; on Jan 27, 1830, he md. Mary Price; they had 8 children, including: Andrew J. (b. 1833, in Ark.); Elizabeth (b. 1840 - md. Wm. Wilson); Barshebe (1843); Jane (1846); and Mary (b. 1848). Welcome Wilhelm had 3 brothers: James Jr.; Jacob (moved to Ark.); and George (moved to Mo. & was killed there by a stray bullet).

Mary (1807-1881), wife of Welcome; a daughter of Sam'l & Barbara (Atchley) Price; b. in Tenn. Jan 26, 1807.

Notes, Corrections, Additions, and Changes

Pennington Family Cem.
900 Post.

Peter Smith - Co. 7. 119 Ill. Inf.

Father and Mother.

May 28 1897-

Anna, his wife - age 56 yrs 4 mo.

James W. Pennington

May 22 1871 age 35 yrs 26 da.

Lemmin Pennington (son)

1872 22nd age 1 yr 22 da

Thomas J. Pennington

Sept 27 1875 age 65 - 6 mo 1 da

Mary J. Wife of Thomas J.

died Oct 1 1901 age 83 - 3 mo 3 da

Alonzo Pennington 1857 - 1937

(mother) died Oct 12 1869 age 9 yrs

mo 1 da.

Industry (46)
Sec. 17