

"Crossroads of  
West-central  
Illinois"

**McDONOUGH COUNTY  
HISTORICAL AND GENEALOGICAL  
MISCELLANY  
1826 - 1976**

RURAL CEMETERIES  
OF  
McDONOUGH COUNTY, ILLINOIS  
EMMET- MACOMB-SCOTLAND-CHALMERS  
TOWNSHIPS

**McDONOUGH COUNTY, ILLINOIS**

REF. 977.342 L567 V. 10  
Lester, Duane.  
Rural cemeteries of  
McDonough County, Illinois

MID-CONTINENT PUBLIC LIBRARY  
Midwest Genealogy Center  
3440 S. Lee's Summit Rd.  
Independence, MO 64055 **MGC**

RURAL  
CEMETERIES  
of  
MC DONOUGH COUNTY, ILLINOIS

Volume X  
Emmet-Macomb-Scotland-Chalmers

By Duane Lester  
Good Hope, Illinois

Printed by  
Schuyler - Brown  
Historical and Genealogical Society  
and  
The Schuyler Jail Museum

MID-CONTINENT PUBLIC LIBRARY  
Midwest Genealogy Center  
3440 S. Lee's Summit Rd.  
Independence, MO 64055 **MGC**

MID-CONTINENT PUBLIC LIBRARY  
  
3 0000 13101758 8

ILLINOIS

Volume X

Bauer-Macomb-Scotland-Chalmers

By Diane Lester  
Good Hope, Illinois

Printed by  
Schuyler - Brown  
Historical and Genealogical Society  
and  
The Schuyler Hall Museum

Volume X

Table of Contents

Preface . . . . .	i - ii
Maps and plats . . . . .	iii - x
Old Macomb Cemetery . . . . .	1 - 16
Old Catholic Cemetery . . . . .	17
Bailey Cemetery . . . . .	18 - 22
Simpson Cemetery . . . . .	23
Brooking Cemetery . . . . .	24 - 25
County Farm Cemetery . . . . .	26

"A monument is erected,  
not because a person died,  
but because a person lived."

## Preface

Within the boundaries of McDonough County, Illinois are more than a hundred cemeteries and gravesites ranging in size from a single burial site to the expansive Oakwood Cemetery at Macomb. Within these cemeteries are the remains of an estimated 40,000 individuals who have died since the first settler arrived here over 150 years ago. Graves of countless others are scattered over the countryside of McDonough County; but, exact sites of many of these resting places are no longer known for various reasons. During the early days of this county, there were obviously no central burial grounds; thus, a pioneer family having the misfortune of losing one of its members placed the deceased in a grave on a family homestead and erected a makeshift marker. A number of these family burial grounds later became public cemeteries, however, many of the grave sites soon became "lost". Crude wooden markers or a hand engraved stone soon succumbed to the elements and were never replaced; scores of families moved further west after staying in this area only a short time and the gravesites of their loved ones shortly became insignificant mounds of earth; a number of families passing through this vicinity suffered individual losses. A prime example of the latter is contained in a history of Bethel Township. In 1830, four children of an emigrant family died while enroute through McDonough County. They were buried near their places of death which occurred about two miles southwest of Fandon. All traces of those graves have long been gone. During the summer of 1834, a widow lady died at her home in northern Tennessee Township. Her coffin of dressed walnut lumber was built by a local cabinet maker and she was buried in the timber near her home. Within a few years, no evidence remained to indicate the presence of her final resting place. A family who created an excellent farm from the prairies a few miles north of Macomb, maintained a fenced family burial site for several years. This cemetery contained the graves of about 12 former family members. During the early 1900's, the farm changed ownership. Shortly thereafter, the new owner removed all the stones, took down the fence, and this graveyard became part of a cornfield. These are only three of the countless incidents involving the total disappearance of burial sites. At this time, it is impossible to determine the locations of hundreds of individual's graves in this county.

Vandalism is responsible for the destruction of many grave stones. Countless markers have been partially or totally destroyed. Inscriptions have been obliterated by shotgun blasts, stones have been broken into dozens of pieces, and some markers have been entirely removed from their original locations.

While weather-wear and vandalism accounts for most of the destruction of individual tombstones, neglect is directly responsible for the eventual deterioration of graveyards. Several local cemeteries have had no protective fencing for a number of years and the grounds have become grazing land for livestock. Groundhogs and other burrowing animals have undermined large portions of various cemeteries. Some areas are nearly invisible because of massive growths of weeds and brush. Stones have fallen, broken, and become completely covered with soil and debris.

The overall conditions of our county cemeteries is a pathetic case. While some grounds are well maintained, or at least partially kept-up by various families, many have been totally forgotten. This situation is appalling and should never have come about. Apparently, lack of time, expense, and most of all regard has brought about the present-day poor conditions of many of our rural cemeteries.

Genealogical notes accompanying the various cemetery listings were prepared from a wide variety of sources including: Local area history books and atlases; newspaper files; county, state, and federal archives; family histories. These notes were collected at random from readily available sources and little, or no attempts were made to search for material for more complete genealogies. These notes are presented only for the purposes of identification and/or clarification.

Every attempt has been made to present complete and accurate information. Readers will find errors and omissions. Others will not agree with portions of my findings; however, no information contained herein is based solely on assumption or guesswork. It must be remembered that this information has been prepared for use only as a tool for further research and that nothing must be taken as final and absolute.

The larger cemeteries contained in these volumes are accompanied by grave location charts. These charts in no way are intended to represent any professionally prepared plat or survey that may exist. Their preparation and presentation are solely for general location purposes.

When copying inscriptions from grave markers, it is sometimes impossible to read some portions of the engraving. Names, dates, ages, etc. that were found to be unclear or totally missing are indicated by the use of question marks or dashes, i.e., SPICER, James T., infant son of ?J.B. & S.J.?; d. -----; age -----. The letters or numbers enclosed in parenthesis following the inscription, indicate general location as indicated on the accompanying chart.

Abbreviations used are as follows:

b.	born	m.	months
Cav.	Cavalry	md.	married
Co.	County/Company	sec.	section
d.	died/days	twp.	township
dau.	daughter	y.	years
Inf.	Infantry		

Time and space prohibits proper recognition for all those individuals who gave assistance in preparing and publishing these volumes. Deep and sincere appreciation is extended to all concerned, especially to the following: My parents, Mr. and Mrs. Lloyd Lester, and my wife, Rose; and to Mrs. Lavina Walton and other members of the Schuyler County Historical and Genealogical Society for printing and binding the finished product. Thank you.

Duane Lester





Mc Donough County, Illinois

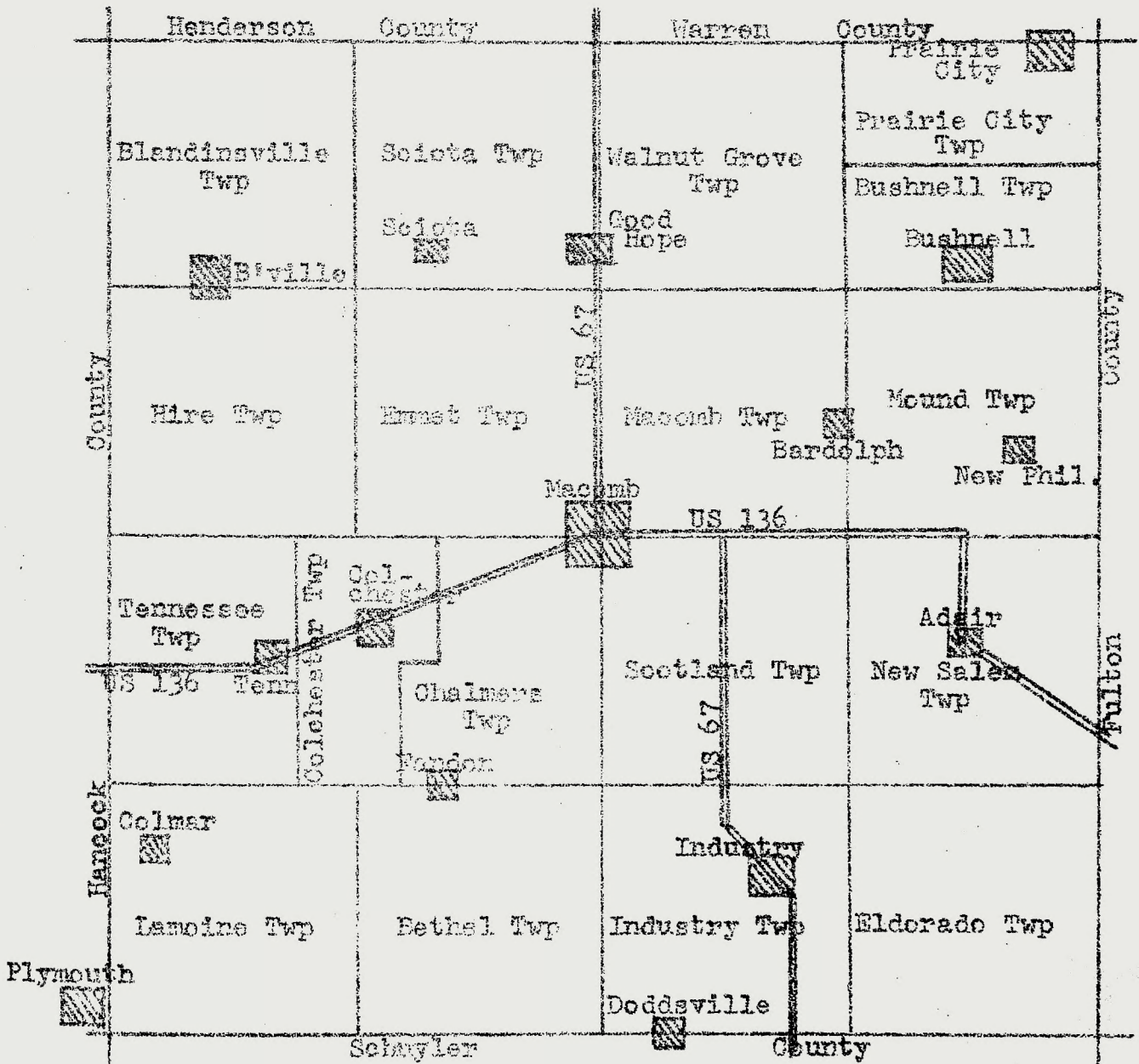

Areas covered by volumes I - XVII  
 "Cemeteries of McDonough County, Illinois"

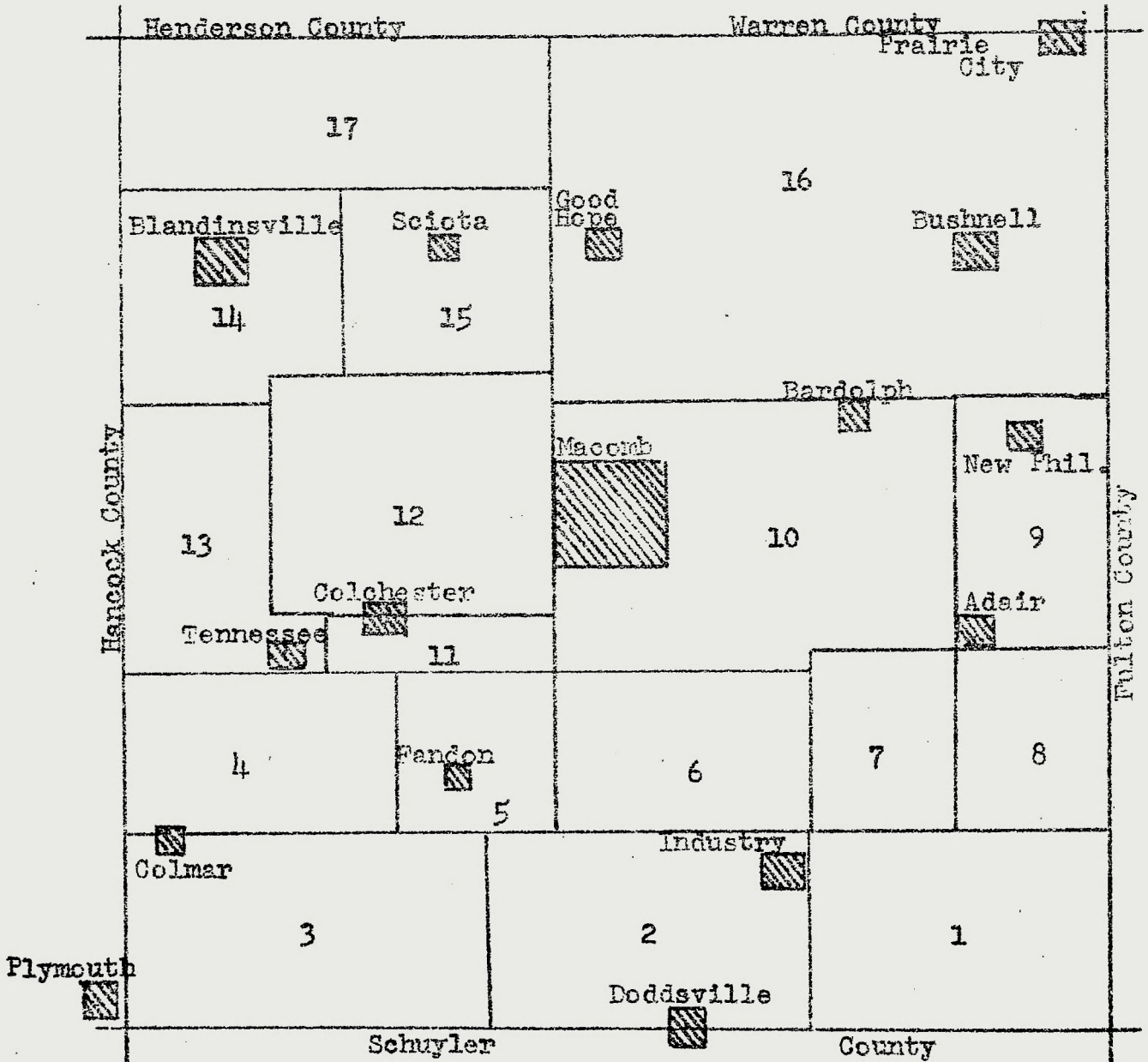

Section 35

Emmet Township, T6N R3W; 1871

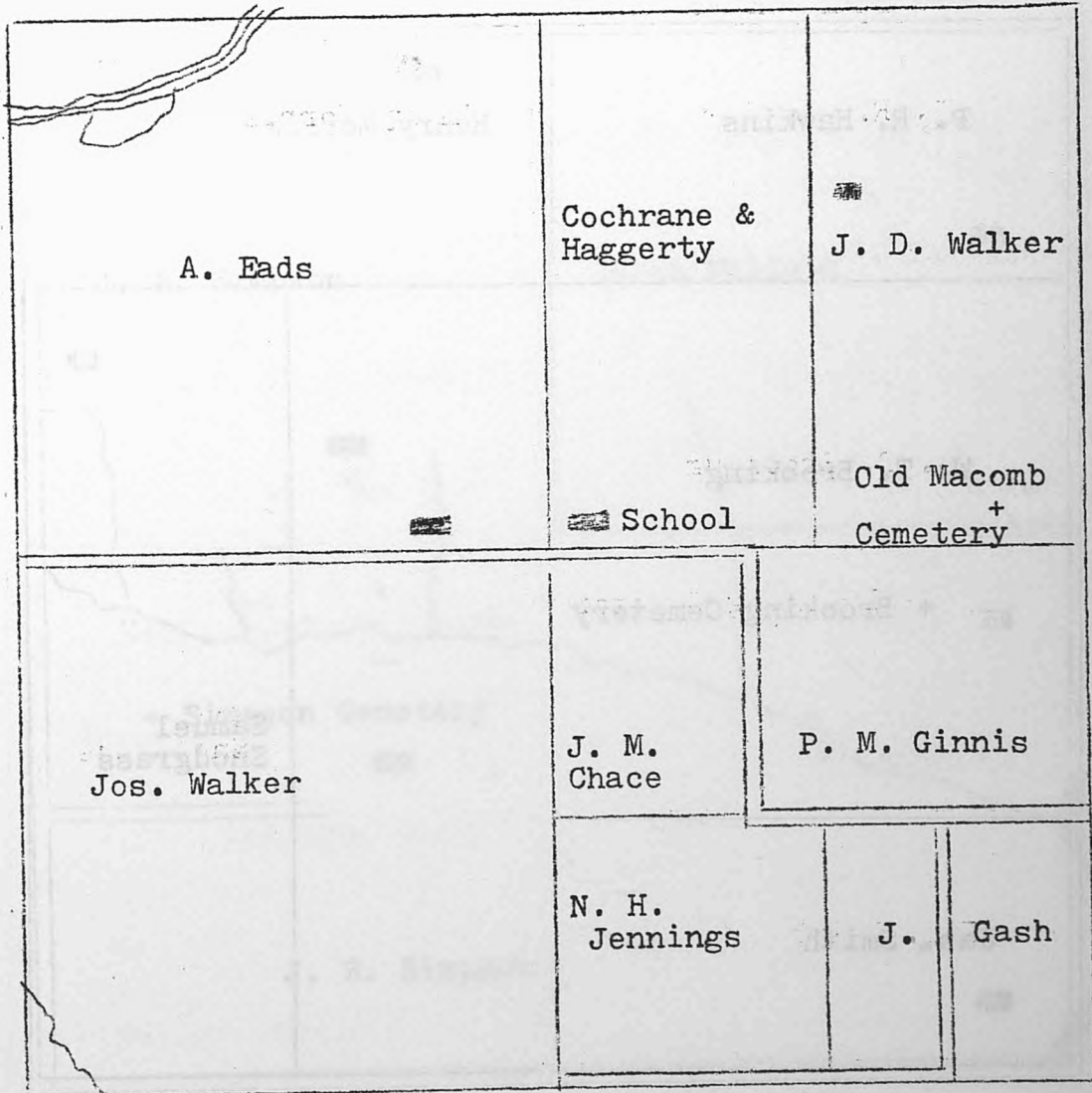

Section 7

Macomb Township, T6N R2W; 1871

P. R. Hawkins	Henry Morris
W. T. Brooking + Brooking Cemetery	Samuel Snodgrass
Jas. Smith	

Section 19

Macomb Township, T6N R2W; 1871

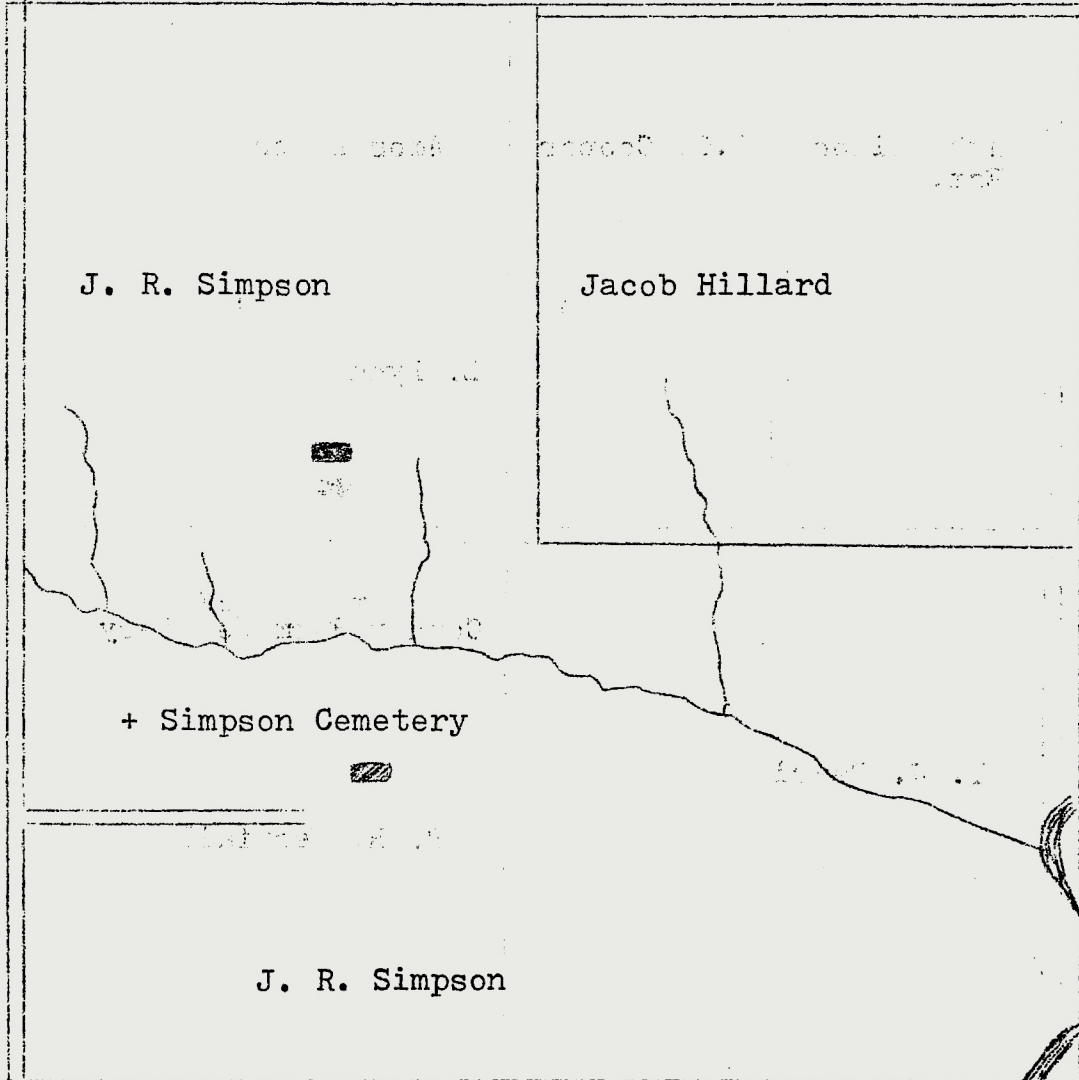

Section 7

Scotland Township, T5N R2W; 1871

<p>Ruth Wilson Est.</p>	<p>C.C. Cooper</p>	<p>Amos Dixon</p> <p>L. Lynn</p>
<p>T. J. Beard</p>	<p>+ County Farm Cemetery</p> <p>B. R. Westfall</p>	

Section 12

Chalmers Township, T5N R3W; 1871

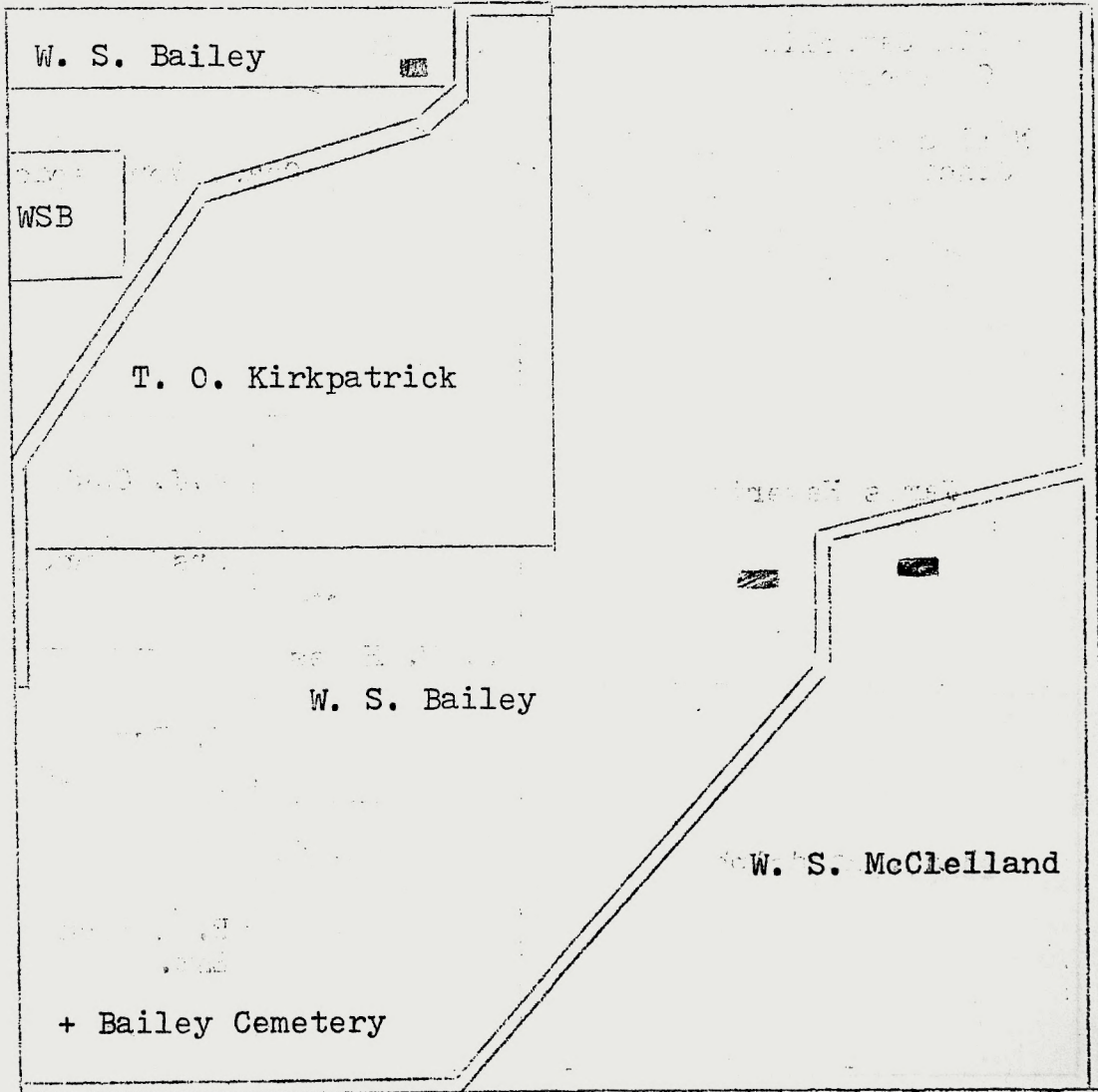

Section 2

Chalmers Township, T5N R3W; 1871

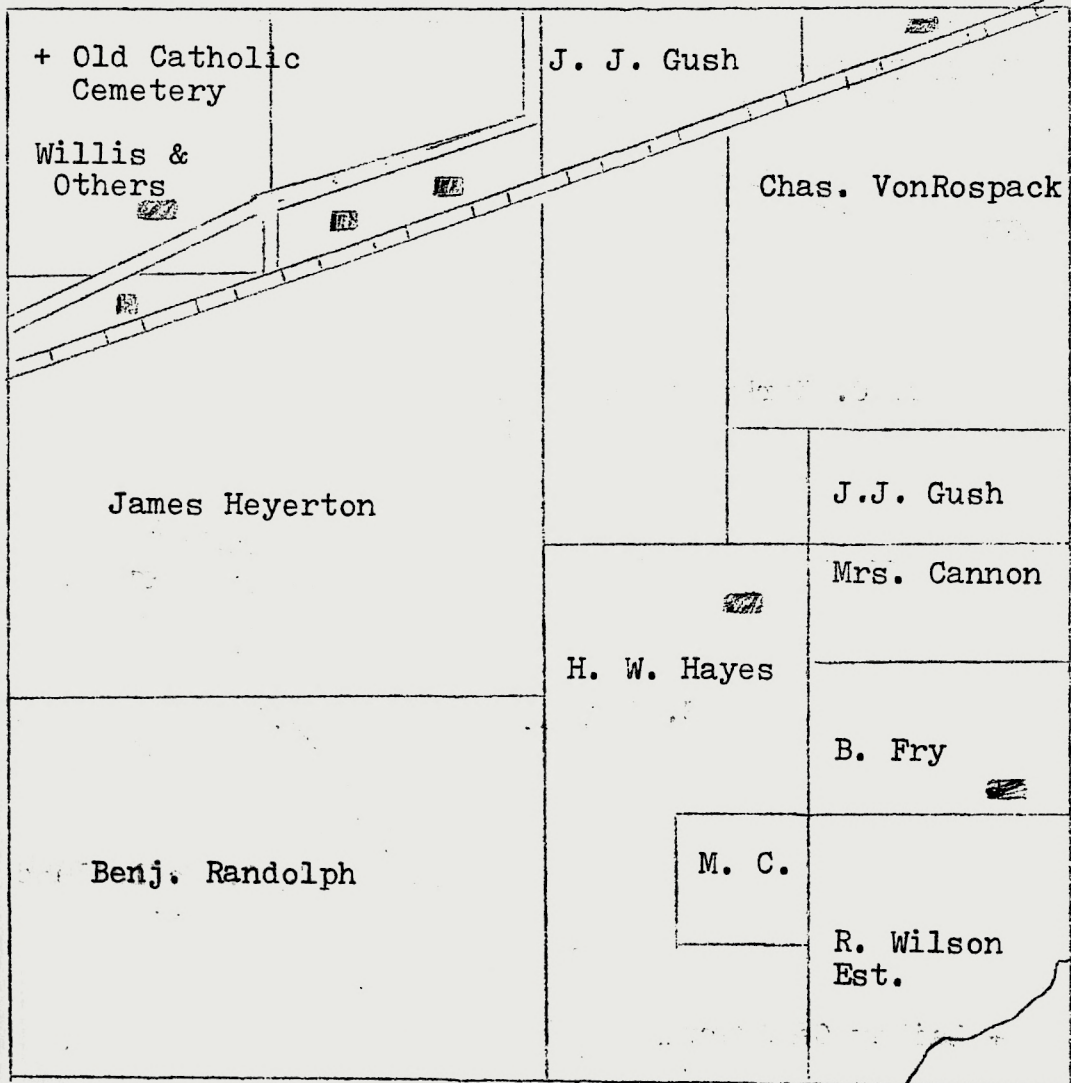



## Old Macomb Cemetery

Location: Emmet township; NE $\frac{1}{4}$ , Section 35; west edge of Macomb on Wigwam Hollow Road, just north of West Adams Road.

Remarks: This, the original Macomb City cemetery, was established in 1830. Histories of the county report that the first burial here was that of a daughter of Peter Hale -- who lived on the site of the cemetery; the second burial was in early 1831, when Truman Bowen died. Because of the absence of dressed lumber for a coffin, Mr. Bowen was buried in a casket built from parts of a wagon bed. The third person to be buried in this cemetery was reportedly a young girl who was burned by hot coals by her stepfather. Of the three first interments here, only the stone of Mr. Bowen could be located in 1975.

According to city officials, cemetery records were destroyed by a fire several years ago and, apparently, no other records are now available. Years of neglect, damage by vandalism, and normal wearing away of the stones by the weather has resulted in an overall poor condition at this cemetery at this time. A great number of the stones have been broken; piles of stones -- or portions of stones -- lie in the cemetery corners or against trees. The following listing of names is in two parts. Part one includes all names taken from the monuments found during this study, made in mid-1975. Part two lists information extracted from a survey made in 1935 and contains names of a number of individuals whose stones were not located in 1975.

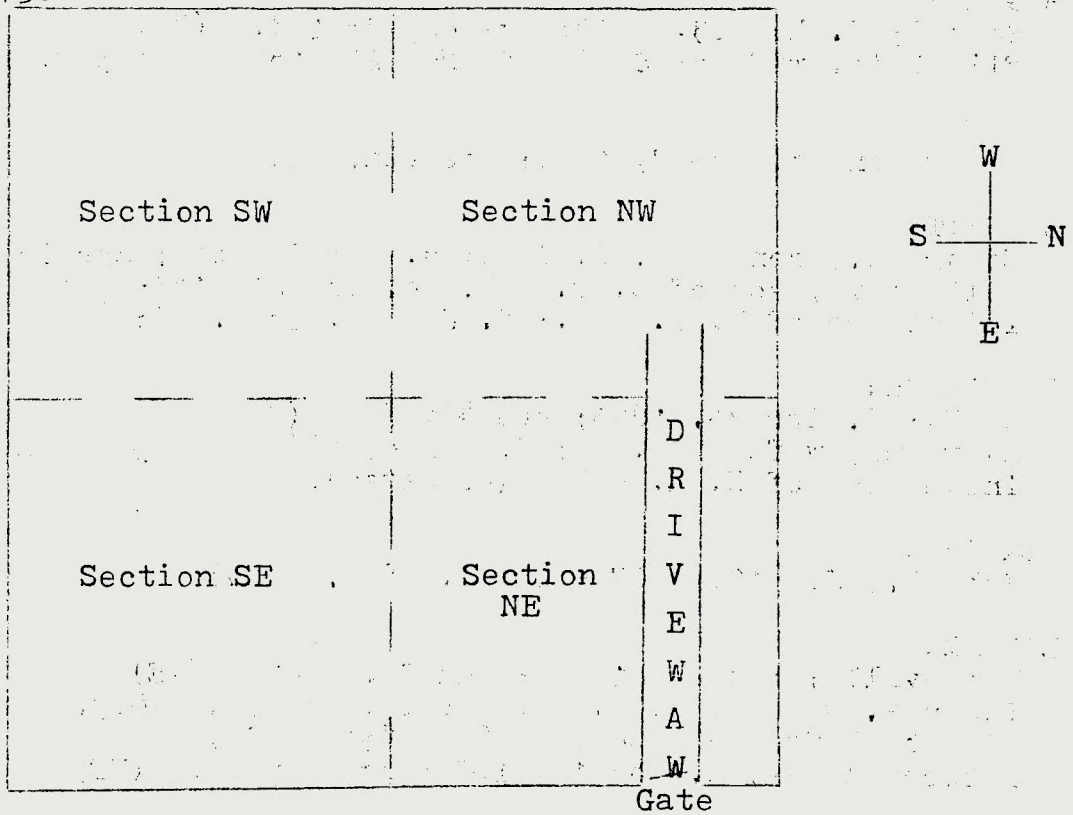

Wigwam Hollow Road

**ADCOCK:**

Henry; d. Aug 11, 184-; age 1m 3d. (NW)  
George; d. Aug 11, 1843; age 10m 6d. (NW)  
Ann, wife of Thomas; d. Jul 3, 1858; age 37y 3m 4d. (NW)  
Susan W.; d. Sep 9, 1857; age 16y 3m 20d. (NW)

**ALLISON:**

Josiah; d. Oct 13, 1843; age 34y. (SW)  
Ann; (See HENTON).

**ANDERSON:**

Emily Frances, wife of John L.; d. Feb 1, 1847; age 22y 9m 24d.  
(SE)  
Emily Isable, infant dau of J. L. & E. F.; d. Nov 4, 1846; age  
4m 12d. (SE)  
Frances J., dau of J. L. & E. F.; d. Jan 27, 1848; age 4y 1m 4d.  
(SE)  
Joseph; d. Oct 12, 1846; age 46y 1m 17d. (SE)  
Sarah E., dau of ---; d. Sep 5, 1850; age 13m 22d. (SE)  
?J.?; d. Nov 25, 18?46?; age 65y 7m 13d. (SE)

**ATWATER:**

Charles Leslie; Dec 17, 1884 - Dec 13, 1932. (NW)  
Weldon G.; Sep 10, 1911 - Jun 14, 1927. (NW)

**BAGLEY:**

Samuel; d. May 23, 1900; age 80y 2m 11d. (NW)  
Elizabeth, wife of Sam'l; d. May 26, 1876; age 55y. (NW)

**BAILEY:**

Betsy Ann; d. Oct 7, 1834; age 22m. (SW)

**BARRETT:**

Edward A., son of W. P. & M.; d. Sep 7, 1850; age 1y 1m 7d. (SE)  
William T., son of W. P. & M.; d. Jul 21, 185-; age 4y 1m --d. (SE)  
Infant son of W. P. & M.; d. Jan 30, 1853. (SE)

**BARTLESON:**

C. M.; d. Apr 25, 1845; age 49y 8m. (SE)  
Mary Ann, wife of C. M.; d. Mar 6, 1867; age 57y 10m 25d. (SE)  
Infant son of H. R. & K.; (no dates). (SE)

**BEAGLES:**

John H.; Jun 12, 1807 - Oct 3, 1845. (SW)

**BONHAM:**

Montevilla; Feb 27, 1846 - Jun 24, 1847. (NE)  
Lucinda, wife of R. M.; d. Mar 27, 1854; age 42y. (NE)  
Elizabeth Smith-Henton; 1818 - 1851. (NE)  
Rebecca Wiley; d. Nov 10, 1858; age 83y 2m. (NE)

**BOWEN:**

Truman; d. Mar 12, 1831; age 45y 15d. (SW)  
T. L.; 1832 - 1915. (SW)  
Emma; buried Phoenix, Ore., 1862. (SW)

BOWEN:

Liddie, wife of T. L.; 1834 - 1884. (SW)  
Nancy, wife of T.; d. Oct 1, 1852; age 58y 11m 20d. (SW)

BOYD:

Mary Jane; d. Apr 28, 1839; age 18y 8m 27d. (SW)

BRAZELTON:

Martha Ann; Aug 16, 1815 - Sep 28, 1839; age 24y. (NW)

BROWN:

Sarah, wife of Asa; d. Dec 20, 1854; age 65y 1m 20d. (NE)

BUNNELL:

Angeline, wife of ---, Jr.; Aug 7, 1835 - Dec 21, 1853. (SW)

CALKINS:

Ann M., dau of W. R. & M.; d. Dec 19, 1855; age 3m 15d. (SE)

CAMP:

Israel; Oct 27, 1793 - Mar 20, 1857. (SW)

CANNON:

Silas; d. Jun 16, 1845; age 3y 5m 6d. (SW)  
Obadiah G.; d. Jun 12, 1852; age 41y 10m 26d. (SW)

CAVENDER:

Mary, wife of Peter; d. Jun 18, 1871; age 67y --m. (SE)

CHASE:

Rebecca C.; Aug 4, 1798 - May 7, 1881. (NW)  
Rev. James M.; b. in Cornish N. H.; Apr 4, 1800 - Feb 10, 1865.  
(NW)

W. P.; (no dates); Co A 89th Ill Inf. (NW)

Newton; (no dates). (NW)

Harvey F.; d. Dec 9, 1878; age 81y 9m 4d. (NW)

Sarah, wife of Harvey; d. Sep 30, 1852; age 40y 6m 9d. (NW)

Moody; d. Apr 4, 1845; age 76y. (SW)

Newton W., son of Moody & Lucy; d. Oct 1, 1839; age 26y. (SW)

CHEATHAM:

Mrs. Martha, wife of S. G.; d. Feb 8, 1836; age 39y 1m 15d. (SW)

CHEESMAN:

David J.; 1896 - 1897. (NW)

CHESSMAN:

Nathaniel; 1825 - 1907. (SW)

Martha; 1831 - 1900. (SW)

CHURCHILL:

Richard H.; d. Oct 14, 1837; age 33y 6m 27d. (SW)

CONOLY:

Sarah, wife of Stephen; Sep 13, 1827 - Dec 15, 1892. (NE)

COVERT:

John; (no dates); Corp Co H 119th Ill Inf. (NE)

DAMRON:

Susan F.; d. Dec 2, 1837; age 25y 10m 5d. (SW)

DAVIS:

Isabella H.; (Partial stone; dates missing.) (SE)

DICKINSON:

L. W.; d. Jan 11, 1869; age 39y 5m 17d. (NW)

EMONS:

John; d. Sep 12, 1851; age 37y 7m 27d. (SW)

FELTGES:

Joseph H.; son of H. & F.; d. ---. (SE)

FLEMING:

Mary E.; (see QUIGLEY).

GALVIN:

John N.; Apr 1, 1824 - Mar 11, 1844. (NW)

Phebe; Nov 4, 1801 - Apr 3, 1841. (NW)

GAMAGE:

Ellen; (see SHUTE).

GARRETT:

Nancy J., consort of Loven; d. Jun 18, 1856; age 20y 3m 18d. (NW)

Robert; d. May 9, 1855; age 85y 1m 1d. (NW)

GORDON:

Sarah E., dau of H. M. & M. A.; d. Sep 17, 1876; age 11y 6m --d.  
(NW)

GRANTHAM:

Elizabeth, wife of Chas.; d. Nov 18, 1852; age 86y 8m 6d. (SE)

Charles; d. Apr 7, 1843; age 82y 7m 4d. (SE)

HALE:

Robert L.; Jun 22, 1892 - Jul 29, 1910. (NW)

HANAN:

Martin W.; (no dates). (NW)

HARRIS:

Sarah Margaret; Aug 13, 1833 - Sep 9, 1836. (SW)

HEAD:

Lucretia E., dau of B. & M.; d. Jan 16, 1855; age 18y 1m 10d. (SE)

James L.; son of B. & M.; d. Oct 9, 1856; age 16y 5m 24d. (SE)

John W. M., son of B. & M.; d. Mar 9, 1856; age 9m 15d. (SE)

James Douglas, son of W. T. & E. A.; d. ---. (SE)

HEAD:

Cornelia, dau of W. T. & E. A.; d. Jan 17, 1856; age 2m 22d. (SE)

John E., son of B. B. & S. A.; d. Jan 30, 1852; age 2y --m --d.  
(SE)

William Allen, son of W. T. & E. A.; d. Feb 23, 1852; age 1m 5d. (SE)

HANSON:

Nels; (no dates); Co H 2nd Ill Cav. (NE)

HENTON:

Rebecca; d. Sep 20, 1847; age 1y 3m 20d. (NE)

Sarah Virginia Ann; d. Apr 8, 1840; age 2y 1m 4d. (SW)

Ann, consort of Moses & dau of Wm. & Sarah Allison; d. --- ---,  
1839, in her 37th year. (SW)

Mary Virginia; d. Dec 16, 1834; age 2y. (SW)

Jacob, son of Evan & Ellen; d. Jan 24, 1837; age 24y 10m 19d. (SW)

HILL:

Robert; d. Nov 22, 1855; age 1y 7m. (SW)

George W.; d. Nov 15, 1855; age 24y. (SW)

KELLOUGH:

Sarah, wife of R.; d. May 10, 1868; age 60y 1m 1d. (NW)

KINKADE:

Eliza J., wife of Hugh M.; d. Mar 13, 1865; age 25y 3m 29d. (SE)

KRAUSER:

Francis, dau of F. & E.; d. Sep 16, 1861; age ---. (NE)

Frank, son of F. & E.; d. Jan 21, 1860; age 1y 11m 25d. (NE)

KRUSE:

Heir Ruht, Meine Liebe Gattin Rinne M. Kruse; Geb. Aug 27, 1831;  
Gest. Nov 19, 1867. (NW)

LONG:

Susan, wife of Daniel; d. --- ---, 1865; age ---. (SE)

LOWE:

Margaret, dau of --- & Eliza M.; d. Aug 27, 1848; age 10m. (SE)

LUSE:

Rebecca, wife of H. H.; d. May 13, 1852; age 41y 13d. (NW)

MAJOR:

Mary A., dau of J. M. & A.; d. Dec 30, 1852; age ---. (SE)

MARVEL:

Sarah G., wife of Wm.; d. ---; age ---. (SE)

MASON:

Vernon P.; d. Jul 6, 1864; age 46y. (SW)

MC DONALD:

Susanna; Dec 21, 1801 - Feb 15, 183-. (SW)

MC GINNIS:

Mrs. Ann, who was born Oct 12, A.D. 1798, and departed this life  
Sep 9th, A.D. 1835. (SW)  
Jesse; d. Aug 14, 1840; age 42y 11m. (SW)

MEAD:

Lydia; Sep 24, 1795 - Sep 8, 1844. (NW)

MILLER:

John M.; (no dates); Co H 83rd Pa. Inf. (NE)

MONTEE:

Abram; d. Feb 11, 1877; age 76y 9m 22d. (NW)  
Hester Ann, wife of Abram; d. Nov 3, 1882; age 76y 8m 2d. (NW)

MONTGOMERY:

Nathan; d. Apr 19, 1834; age 65y 5m 19d. (SW)

MOORE:

George L.; d. Sep 23, 1841; age 13y 11m 25d. (SW)  
John G., son of J. & E.; d. Sep 22, 1853; age 8y 3d. (SE)

NAYLOR:

Adaline, wife of B. T.; d. Jun 25, 1880; age 75y 5m 1d. (NE)  
B. T.; d. Dec 8, 1883; age 82y 8m 23d. (NE)

PALMER:

Mary J.; Aug 14, 1837 - Apr 1, 1917. (NE)  
William; (no dates). (NE)

PERKINS:

Evan Earl, son of Otto & Linda; May 8, 1897 - May 22, 1917. (SW)

POTTER:

Annie, dau of W. H. & H. E.; 1862 - Jan 5, 1863. (SW)  
William Henry, son of W. H. & H. E.; 1860 - Aug 20, 1861. (SW)  
William H.; 1832 - 1901. (SW)  
Mary L., wife of Wm.; 1830 - 1858. (SW)  
Mary L.; 1855 - 1878. (SW)  
Emma; 1856 - 1873. (SW)  
Elizabeth, wife of Wm. H.; 1840 - 1917. (SW)  
Sarah E.; 1864 - 1872. (SW)  
Jesse W.; 1880 - 1891. (SW)

PRINGLE:

Mary, wife of Wm.; d. Mar 16, 1856; age 72y 1m 3d. (SW)

QUIGLEY:

Mary E. Fleming, wife of John; d. Jul 16, 1876; age 33y 4m 2d. (SE)

RALL:

John W., son of D. D. & H.; d. Mar 25, 1847; age 3m 2d. (SE)  
Grace I., dau of D. D. & H.; d. Mar 27, 1848; age 2m 2d. (SE)  
Bianca P., dau of D. D. & H.; d. Aug 5, 1850; age 1y 1m 5d. (SE)

RALL:

Twins, son & dau of D. D. & H.; d. Jun 7, 1850. (SE)  
Twins, son & dau of D. D. & H.; d. Mar 18, 1851. (SE)  
Infant dau of D. D. & H.; d. Sep 18, 1853. (SE)

ROBBINS:

Albert F., son of H. J. & P. A.; d. Sep 3, 1855; age 7m 2d. (SE)  
H. J.; d. Sep 21, 1855; age 26y 9m 8d. (SE)

ROBERTS:

Thomas A., son of T. R. & Ann; d. Aug 2, 1841; age 10m 2d. (SE)

ROBERTSON:

John H.; May 15, 1815 - Jan 21, 1890. (SE)  
Joicey Ann, wife of J. H.; Jul 26, 1819 - Dec 18, 1903. (SE)  
Sherod S.; Dec 22, 1822 - Feb 23, 1891. (SE)  
Eliza, wife of S. S.; --- --, 1825 - Aug 20, 1890. (SE)

ROGERS:

Joseph M., Marshall & Ruth; (no dates). (NW)

ROWE:

Abram; (no dates); Capt Co C 16th Ill Inf. (SW)  
Hattie, Alice & ----; children of A. & M.; (no dates). (SW)

RUDISILL:

Jonas C.; d. Mar 27, 1854; age 53y 8m 1d. (SE)

RUSSELL:

John L.; Dec 8, 1808 - Aug 17, 1894; Pvt Butler's Co Ill Mtd  
Rangers Black Hawk War. (NE)

SHUTE:

John; Nov 4, 1861 - Oct 10, 1883. (NE)  
Ellen Gamage, wife of John; Jan 3, 1837 - Nov 7, 1887. (NE)

SILER:

George; 1850 - 1908. (NW)  
Louisa; 1867 - 1937. (NW)

SLOAN:

Mary; Jan 1, 1838 - Dec 1, 1840. (SW)  
John M.; Apr 12, 1814 - May 23, 1840. (SW)

SMITH:

Garrett; d. Jul 15, 1841; age 1y 5m 25d. (NE)

SMITHERS:

Nancy, wife of T. S.; d. Nov 6, 1838; age 40y 3m 6d. (SW)  
Thomas; (no dates); Va Mil War of 1812. (SE)  
Sarah E., dau of T. & S.; d. Oct 13, 1867; age 21y 4d. (SE)

STEPHENS:

Francis; 1850 - 1919. (NW)  
Elizabeth; 1866 - 1917. (NW)

STEPHENSON:

Martha E., dau of J. B. & M. A.; d. Jan 6, 1857; age 6m 13d. (SE)

STEWART:

Olive P., wife of Rev. Wm. K.; d. Aug 17, 1874; age 85y. (SE)

STOKES:

W. S.; (no dates); Co B 10th Mo Inf. (NW)

Sally Ann, wife of Robert F.; d. Feb 18, 1855; age 40y 3m 17d. (NW)

TAYLOR:

Charles, son of J. & E.; d. ---; age ---. (SW)

William; d. Apr 6, 1864; age 49y. (SW)

THOMPSON:

Maria Louisa, dau of Herod & Louisa D. of Andover N. H.; d. Nov 27, 1851; age 22y 2m. (NW)

UNKNOWNNS:

-----; d. Oct 2, 1851; age 7m 17d. NE)

-----; d. -----; age 47y 8m 29d. (SW)

-----; d. Oct 1, 1857; age 41y 16d. (SE)

UPDEGRAFF:

Eliza M., wife of James H.; Dec 28, 1813 - Oct 27, 1847. (NW)

UPP:

Amos, son of J. & M.; d. Jan 1, 1852; age ---. (NW)

VICKERS:

Mary M., dau of G. & C.; d. Oct 8, 1856; age 3m 18d. (SE)

WALKER:

Jane (or June), wife of J. D.; Jan 8, 1804 - Oct 4, 1859; age 55y. (NE)

James; d. Mar 7, 1838, in his 74th year. (SW)

Cyrus; d. Jan 1, 1844; age 10y 7m 13d. "Afflicted soul he long has been; all human skill in vain; till God did please to give him ease, and freed him from his pain." (SW)

Rebecca, wife of J. B.; d. Aug 13, 1855; age 31y 4m 16d. (SW)

WATERS:

?Gerry?; d. ?Apr 1, 1860?. (SW)

WELCH:

James L.; d. Sep 24, 1839; age 24y 1m. (SW)

WESTFALL:

C. L. (no dates). (SE)

Charles W.; d. Feb 10, 1846; age 2y 3d. (SE)

Mary; d. Aug 14, 1841; age 4y 4m 5d. (SE)

WHITTEN:

Whitfield; (no dates). (NE)

Emmaline; (no dates). (NE)



WHITTEN:

Elizabeth; d. Dec 19, 1891; age 48y 7m 1d. (NE)  
James; (no dates); Co H 2nd Ill L Arty. (NE)  
Jeremiah; (no dates); Pvt Berry's Co 15th Ky Mil War of 1812. (NE)

WILEY:

C. Joseph; 1843 - 1895; Co D 64th Ill Inf. (SE)  
Angeline; 1847 - 1917. (SE)  
Maria H., wife of A. C.; d. Aug 1, 1883; age 66y 11m 2d. (SE)  
Aldrich C.; d. May 13, 1873; age 58y 4m 15d. (SE)

WILLIS:

Martha, wife of Wm.; d. Mar 20, 1861; age 67y 10d. (NE)  
William; Nov 8, 1774 - Jul 14, 1844. (NE)

WILSON:

Cintha; Jan 10, 1784 - Oct 26, 1846; age 62y 9m 16d. (NE)

WOODWORTH:

Mamie, dau of A. & D.; d. Aug 20, 1887; age ---. (NW)  
Amanda, wife of J.; d. Jul 3, 185-; age ---. (NW)  
John; 1829 - 1898; Co K 5th Ind Vol Inf, Mexican War. (NE)  
Catherine, wife of John; 1839 - 1904. (NE)

WORDELL:

Robert; d. Sep 13, 1851; age 35y. (NE)

WYNE:

Mary Ann; d. Apr 1, 1842; age ?19?y 3m 11d. (SW)  
Charles W.; d. Jul 24, 1855; in his 29th year. (SE)

WYNES:

Infant son of Joseph Evermont & Mary Ann; b. & d. Mar 7, 1842. (SW)  
Mary E., dau of J. & M.; d. ---; age ---. (SW)

ZORNES:

Thomas, son of Wm. & M.; d. Sep 1, 1855; age 9m. (SE)

In 1935, a similar registration of information was made on this cemetery by Mrs. Aimee Christy Gumbart of Macomb. Her list contained eighty-four individuals which represented only a portion of those buried in the Old Macomb Cemetery. On that list are twenty-eight names of persons buried here for whom no stones were located during this 1975 survey. The following information is extracted from that 1935 listing. Locations of these person's graves is not known at this time.

ANDERSON:

Sarah, wife of John; d. Jul 9, 1850; age 65y.

BELL:

William P.; d. Sep 5, 1841; age 40y.

BUZAN:

William P.; d. Apr 1, 1836; age 77y.

CAMP:

Ann, wife of Israel; May 2, 1796 - Feb 21, 1847.

CAMPBELL:

Clarissa, wife of James M.; dau of Stephen & Maria Lewis; b. Belfontaine, Mo., Nov 27, 1813; d. Sep 26, 1842. Infant son born Sep 23, 1842.

CHASE:

Lucy; d. Sep 18, 1843; age 70y.  
Salina A., consort of Rev. James M.; d. Sep 30, 1851; age 42y.

CONNER:

Abadiah G.; d. Jun 12, 1852; age 41y.

DAMRON:

Mary; d. Jul 8, 1846; age 65y.

FLEMING:

Isaac; d. Jun 7, 1860; age 57y.

GRANTHAM:

George R.; d. Feb 9, 1836; age 40y.  
Isaac; d. Mar 26, 1859; age 69y.

GRAVES:

Sarah J., wife of Lewis; d. Apr 4, 1848; age 48y.

GATES:

German Hamilton, son of Joseph D. & Isabella H.; d. Jul 4, 1841; age 3y.

HARRIS:

John; Feb 22, 1798 - Aug 23, 1833.

HEAD:

Sarah; Mar 3, 1795 - Aug 29, 1846.

HENTON:

George Macomb, son of Moses & Mary Virginia; d. Dec 16, 1834; age 2y.

IRWIN:

James; d. Apr 1, 1857; age 58y 3m.

KELLOUGH:

Richard; d. Sep 23, 1884; age 85y.

LEWIS:

Clarissa; (see CAMPBELL).

LOWE:

Richard; d. Jul 7, 1851; age 47y.

MAURY:

Butler B.; d. Aug 25, 1841; age 14y 10m.

MC BRIDE:

George; d. Oct 12, 1846; age 42y.

MONTGOMERY:--

Cynthia Ann, wife of Nelson; dau of Cyrus & Flora Walker; b. in Adair Co., Ky.; d. ----; age 24y 8m.

Walker; d. Feb 18, 1842.

Nelson; d. Dec 18, 1847; age 35y

STAPP:

Elijah; d. May 27, 1835; age 43y.

STEWART:

Rev. William K.; d. Apr 29, 1852; age 62y.

WALKER:

Cynthia Ann; (see MONTGOMERY).

WILSON:

Mary, infant dau of J. M. & M.; d. 1851.

Genealogical Notes - Old Macomb Cemetery

ANDERSON: John L. & Emily F. Smith were married in this county on February 23, 1843.

\*

BARTLESON: 1850 census; Mary A., 50, England; Franklin, 14, Penn.; Maria S., 13, Ill.; U. R., 10, (male) Ill.; M. A. (male), 8, Ill.; C. J. (male), 6, Ill.; Mary S. SMITH, 20, Penn.

BONHAM: From 1850 census; Robert M., 43, farmer, Ky.; Lucinda, 33, Ky.; Nelson, 17, farmer, Ky.; Theodore, 13, Ill.; F. H. (male), 10, Ill.; Wm. H., 24, laborer, Ill.; Wm. TOMMERSON, 24, laborer, Tenn.; Rebecca BONHAM, 76, N. C.

BRAZELTON: Martha Ann; maiden name was Wilson; married Robert A. Brazelton in this county on January 25, 1838.

\*

BARRETT: 1850 census list family members as; William P., 29, Teamster, England; Margaret, 22, Wales; William T., 3, Ill.; Edward, 1, Ill.

CAMPBELL: 1850 census lists persons living in the James M. Campbell household as: James M., 46, farmer, Ky.; L. G. (female), 36, Vt.; William H., 15, Ill.; Permelia H., 13, Ill.; Clarinda, 11, Ill.; John J., 5, Ill.; Thompson B., 3, Ill.; CAMPBELL, Lafayette, 1, Ill.; MILLER, Benj., 63, farmer, Ky.; Miller, Mag???, 57, (female) Ky.; HINNEY, John, 25, farmer, Ireland.

CANNON: Obadiah G. Cannon and Sarah Noel were married in this county on January 25, 1838. 1850 census lists persons living

CANNON: (Cont'd.)

in this household as: Obidiah C., 40, laborer, Ky.; Sarah A., 33, Va.; Melvina, 9, Ill.; Mariah, 5, Ill.; Jane, 3, Ill.; John W., 1, Ky.

CHASE: W. P. (William P. Chase died while in service according to list of soldiers buried at the Old Macomb Cemetery.—From The Macomb Journal, May 26, 1881.)

Rebecca C. (Obit, in part, from The Macomb Journal, May 12, 1881): "Miss Rebecca C. Chase died in this city at the residence of W. E. Withrow on the 17th, aged 83 years. Born 1798 in Cornith, Sullivan Co., N. Hampshire; sister of the late Harvey F. Chase and to Rev. Rev. Morris Chase, Sr. of this county, both deceased; and of Mrs. W. E. Withrow of this city, and Rev. Moody Chase of Parkensbury, Indiana. She came west in 1856."

1850 census lists persons living in the Harvey H. Chase household as: Harvey H., 53, farmer, b. N.H.; Sarah B., 35, b. N.H.; James P., 11, b. N.H.; George M., 8, b. Ill.; and Sarah S., 6, b. Ill.

CHEATHAM: After the death of his first wife, in 1836, Samuel G. Cheatham married Mary Hendrickson in this county on November 8, 1840.

CHEESMAN: Fredrick Melvin; d. Mar 10, 1922; age 35y 7m 26d; b. July 14, 1886 in Chalmers township; son of Douglas & Josephine (Porter) Cheesman; F. M. Cheesman worked as a laborer and died in Macomb of pneumonia.

CHURCH: Ottis DeLoss; d. Jan 30, 1922; age 25y 28d; b. Jan 2, 1897 in Astoria, Ill. (Fulton Co.); son of Oscar and Amanda (Thompson) Church; O. D. Church was single and worked as a laborer; he died in Macomb of Pneumonia.

DAMRON: George, age 62, farmer, b. N.C.; (living with the Lawson H. ROBERTSON family in 1850).

EMONS: (Appears on census as EMMINS) John, 34, teamster, b. N.Y.; Sarah A., 35, b. Ky.; Mary A., 1, b. Ill.; WELSH, Frances, 14, (female) b. Ill.

FRAKES: Infant dau of Melvin and Corrine (Maladd) Frakes; d. Oct 30, 1921; b. & d. in Macomb.

GARRETT: 1850 census lists Robert, 80, b. Va.; Cintha, 67, b. Va.; ?Jerusha?, 15, b. Ky., blind.

GRANTHAM: 1850 lists Elizabeth, 84, b. Penn., living with Isaac, age 58 and ?? E., age 60, also of Penn.

GRAVES: Lewis, 45, carpenter, b. Ky.; living with George & Nancy RILEY, 1850 census. George, 29; Nancy, 28. George, a tanner, b. Ky.; Nancy b. Ky. Also in the household was James GRAVES, 15, b. Ky.

HEAD: James D., Cornelia and Wm. A. were children of Wm. Thomas and Elizabeth Ann (Clarke) Head who were married in this county on May 22, 1845. 1850 census: William T., 33, assessor, b. Ky.; Elizabeth, 21, b. Ky.; Mary C., 4, b. Ill.; James D., 1, b. Ill.; BURNS, Mary, 14, b. Ireland.

Next household (1850 census) Head, Benjamin B., 39, farmer, b. Ky.; Sarah A., 26, b. Ky.; Masiah, 11, female, b. Ill.; Eveline, 8, b. Ill.; Isabell, 6, b. Ill.; ?Inhu?, female, 3, b. Ill.; John E., 1, b. Ill.

KELLOUGH: Richard (Obit, in part, from The Macomb Journal, Sep 25, 1884): "Richard Kellough died in Macomb on Sep 23rd, aged 86 years. He was born Mar 20, 1799 in Lancaster Co., Pa. where he grew to manhood and at the age of 30 years married Miss Sarah Maxwell, who died in 1868. Seven years after their marriage, Mr. and Mrs. Kellough came to Schuyler Co., Ill. where they lived for 2 years after which they moved to Chalmers township in this county. They had 13 children, 9 of whom are now living—R. Kellough is the baggage master of the C.B. & Q. station here; Mrs. Henry Miller of this place; Mrs. Nathan Nichols of this county. One son and 2 daughters reside in Warren county; one son is in Nebr.; one in Kansas and one in the Dekota Terr. Three sons served in the Civil War and one was killed on May 8, 1862 at Corinth. He was also grandfather to 48 and had 4 great-grandchildren. He was buried in the old cemetery beside his wife....."

LOWE: 1850 census lists Richard L., 46, carpenter, b. Va.; Eliza A., 42, b. Ky.; John W., 15, b. Ill.; George E., 12, b. Ill.; Robert L., 7, b. Ill.; HUNTER, Julia Ann, 7, b. Ill.; LOWE, Joseph, 5, b. Ill.

MC GINNIS: Jesse McGinnis married Maria McLaughlin in this county on October 14, 1837.

MONTGOMERY: Nelson Montgomery married Nancy H. Stewart in this county on September 3, 1844. 1850 census list the following: Nancy H., 24, b. Ky.; John L., 4, b. Ill.; Nelson, 2, b. Ill.; PHELPS, Ellen, 22, b. N.Y.; HIGHLAND, Catherine, 17, b. Ky.

MURPHY: Infant son of Ray & Chella (Williams) Murphy; d. Dec 14, 1922; b. & d. in Macomb.

NAYLOR: B. T. (Obit, in part, from The Macomb Journal, Dec 13, 1883): "Benjamin T. Naylor of Emmet twp., died last Friday at the residence of his grandson Sam'l Naylor, aged 82 years. He was born in Adair Co., Ky. in 1801 and grew to manhood in that vicinity. He married in 1831 to Miss Adaline Bailey, an aunt of Wm. and Geo. Bailey of this place. In 1833, he moved to Macomb and in 1840 to Emmet twp. He was a member of the Christian Church. He was the father of 6 children--5 sons and 1 daughter, the latter dying when 2 years old. Of the sons, 3 are living--Wm. and Albert of Emmet twp. and Geo. of Canton, Dakota Terr. He was buried Sunday at the old cemetery west of town beside his wife who died in 1880."

NAYLOR: (Cont'd)

Benjamin; d. Dec 8, 1882; age 82y 7m 23d; b. Adair Co., Ky.; farmer; widower; in Illinois 50 years; d. in Hire township.

Adaline; d. Jun 25, 1880; age 75y 1d; b. Rockbridge Co., Va.; in Illinois 47 years; d. at Emmet township.

1850 census lists: Benjamin, 49, farmer, b. Ky.; Adaline, 43, b. Va.; John, 18, farm laborer; b. Ky.; William, 15, b. Ill.; George, 13, b. Ill.; Albert, 5, b. Ill.; HUNTER, Sharlot, 14, b. N. Y.

Benjamin Naylor moved to Macomb in 1833 and bought the SW $\frac{1}{4}$  of section 29 and the NW $\frac{1}{4}$  of section 32; he built a cabin on the SW $\frac{1}{4}$ , section 29. Benjamin T. Naylor was the son of Benjamin Naylor, of English descent. He began learning the carpenters trade at age 19 and his first piece of work was a railing for a flight of stairs in the State Pen. at Lexington, Ky.; he received \$600 for that work; he later helped built the first McDonough County courthouse and built a frame house in Macomb, the first of it's kind here; he abandoned the trade in 1842 and began farming in Emmet twp. In 1831, he married Adeline Bailey, a native of Virginia; they had 6 children--John J., Wm. B., George W., Sibian, Martha C. and Albert. Four sons served in the civil war; Sibian, John, and Martha C. died prior to 1885. His wife died in June 1880 and was buried along with her children in the Old Macomb Cemetery. George moved to Dakota; Benjamin T. died Dec 8, 1883 in Hire twp. and his death was caused by a runaway team of horses.

Wm. B. Naylor, 2nd son of Benj T., was born July 11, 1835 in Macomb; he married Aug 9, 1855 to Melinda L. McCord, a daughter of Wm. McCord. They lived with his parents for a year after marriage then moved to a farm on section 20, Emmet twp. William living there in 1885; owned about 166A there. His wife died Mar 24, 1865; their children were George J., Samuel L., Ida, and Louisa. William remarried Oct 11, 1866 to Priscilla James, a daughter of Joseph James, who moved to this county in 1861 from Ohio. His second marriage resulted in one child--Charles, who was born July 17, 1867 and died Sep 1, 1867. Wm. B. served in the army and was taken prisoner and was confined to Libby Prison.

POWELL: John Powell, of Macomb, died from effects of burns on Apr 20, 1898 at the home of his step-son, George Johns, of the first ward. Mr. Powell was 44 years old and was survived by his wife and his step-son. Funeral on Apr 21, and burial in the Old Cemetery.

ROBERTS: 1850 census lists Thomas, 46, plasterer, b. Wales; Ann, 46, b. Md.; Edward, 20, b. Pa.; Robert, 17, farmer, b. Ill.; Mary A., 15, b. Ill.; Ann W., 13, b. Ill.; Sarah J., 9, b. Ill.

ROBERTSON: Sherod (also spelled Sherwood) and Mrs. Eliza Moore were married in this county on May 7, 1850.

ROWE: Abram (Obit, in part, from The Macomb Journal, July 3, 1884): "Capt. Abram Rowe died at his home in Chicago on June 26, 1884. He was born in Burlington, Vt. on August 16, 1822. When he was a boy, he learned the trade of a spinner and for years was employed

- ROWE: Abram (cont'd)  
 in various large factories in the East. He was married on Jan 17, 1849 to Maria Walker who with 4 children survive--2 sons and 2 daughters. In Nov, 1852, he came with his family from Cohoes, N.Y. to Macomb where he resided until 3 years ago. He was a member of Co B 16th Ill Inf during the Civil War. He was a member of the Baptist Church. He was buried in the Old Macomb Cemetery beside 3 children who preceded him in death. His survivors are: his wife, daughter Addie, daughter Mrs. Cora McLean, and sons Willie and Edward....."
- RUSSELL: John Letman Russell died at his home on West Jackson Street in Macomb on the morning of August 17, 1894. He was 86 and was the oldest resident of Macomb. Funeral at his home and burial at Old Macomb Cemetery. Born in Green Co., Ky. on January 8, 1808; raised in Ky. and moved to Illinois and settled in Macomb in 1833. Lived here entire life; married in Macomb to Mary Willis; had no children but adopted a child, Mattie Underhill, whom they raised. She married P. S. McBride of Macomb. John Russell was the son of Samuel and Rebecca (Letman) Russell; brother of Eliza S. Clarke, Augustine Cannon, Robert Russell, Merritt Russell, Hiram Russell and Margaret M. Phelps. John was a vet of the Black Hawk War.  
 1850 census lists John L., 41, farmer, b. Ky. and Mary, 33, b. Ky.
- SHUTE: John (Death notice, in part, from The Macomb Journal, Oct 11, 1883): "John Shute died last night, aged 21 years, 11 months and 6 days. For the past 4-5 years he had been in the employ of Jos. Gamage and was almost the sole support of his father's family."
- STEWART: 1850 census lists William K., 59, minister, b. N. C.; Olive, 59, b. N. H.; GILMORE, Thomas, 19, student, b. Penn.
- STOKES: W. S. (Notice appearing in the Macomb Journal, May 26, 1881, on veterans buried in the Old Macomb Cemetery.) W. S. Stokes killed at the battle of Corinth in September, 1862.
- WALKER: 1850 census lists John D., 46, farmer, b. Ohio; Jane, 45, b. Ireland; Caroline, 13, b. Ill.; Sarah, 11, b. Ill.; Ellen, 8, b. Ill.; ?Leah? (female), 6, b. Ill.; Martha, 4, b. Ill.
- WELCH: James L. Welch married Sarah Ann Pringle in this county on November 25, 1835.
- WHITTEN: 1850 census lists Jeremiah, 52, hatter, b. Ky.; Elizabeth, 48, b. Ky.; Emeline, 24, b. Ky.; James, 19, farmer, b. Ky.; Wm. W., 16, farmer, b. Ky.
- WILEY: Jennie Rush; d. Mar 11, 1881; age 1y 6m; b. & d. Chalmers Township.
- WOODWORTH: 1850 census lists John Woodworth, 21, wagon maker, b. Ohio. (Living in the home of Wm. & Malinda PENROSE; Wm. also a wagon maker, b. in Penn.)

WYNE: Mary Ann Walker married Joseph E. Wyne in this county on April 15, 1841. After her death, Mr. Wyne remarried on June 5, 1845 to Clarinda Hays.

1850 census lists Joseph E., 30, merchant, b. Ky.; Clarinda, 21, b. Ill.; Mary E., 4, b. Ill.; Elizabeth, 2, b. Ill.; Joseph W., 6 mos., b. Ill.; Chas. W., 25, clerk, b. Ky.

Notes, Corrections, Additions, and Changes



## Old Catholic Cemetery

Location: Chalmers Township, NW $\frac{1}{4}$ , Section 2; the extreme northwest corner of the McDonough County 4-H grounds, west of Macomb.

Remarks: Very little remains of this, the original Catholic cemetery for the Macomb area. The site is located on the east side of a roadway that has been closed to through traffic for a number of years. Apparently, the majority of those originally buried here were removed to St. Paul's cemetery in Macomb when that area was set aside as a catholic cemetery. The following is quoted from an early history of McDonough County: "The Catholics buried their dead west of Macomb, but through negligence had no road to their grave yard, and when they tried to get a road, the men they put in office did as they always had done--only when they asked a ticket to vote--looked on them as unreasonable and left them to help themselves. A lot therefore was bought of Joseph Burton, opposite the city grave yard, and the Catholic dead removed."

Stones for the following named individuals were located in the original cemetery in April, 1975.

### HARDY:

John W.; d. Mar 8, 1868; age 5m 15d.

Henry F.; d. Jul 17, 1867; age 2y 3m 18d.

(Children of James & S. A. Hardy.)

### LANE:

J. L., son of Michael & Mary; (no dates).

### MC DONOUGH:

Eliza, dau of John & Mary; d. Jun --, 1864; age 19y; a native of Kilronan, County of Roscommon, Ireland.

### MC GINNIS:

Susan, wife of Patrick; d. Dec 22, 1877; age 57y 8m 10d.

Patrick; d. Jan 22, 1869; age 49y 8m.

Notes, Corrections, Additions, and Changes

# Bailey Cemetery

Location: Chalmers township; SW $\frac{1}{4}$ , Section 12. One and one-half miles southwest of Macomb.

Remarks: The grounds are completely fenced; however, only a small portion of the cemetery appears to have any maintenance on a regular basis; the entire area north of the section designated "S" on the chart below, is covered by a heavy growth of weeds and brush. Many stones are broken and badly weather-worn. This study was made in April, 1975.

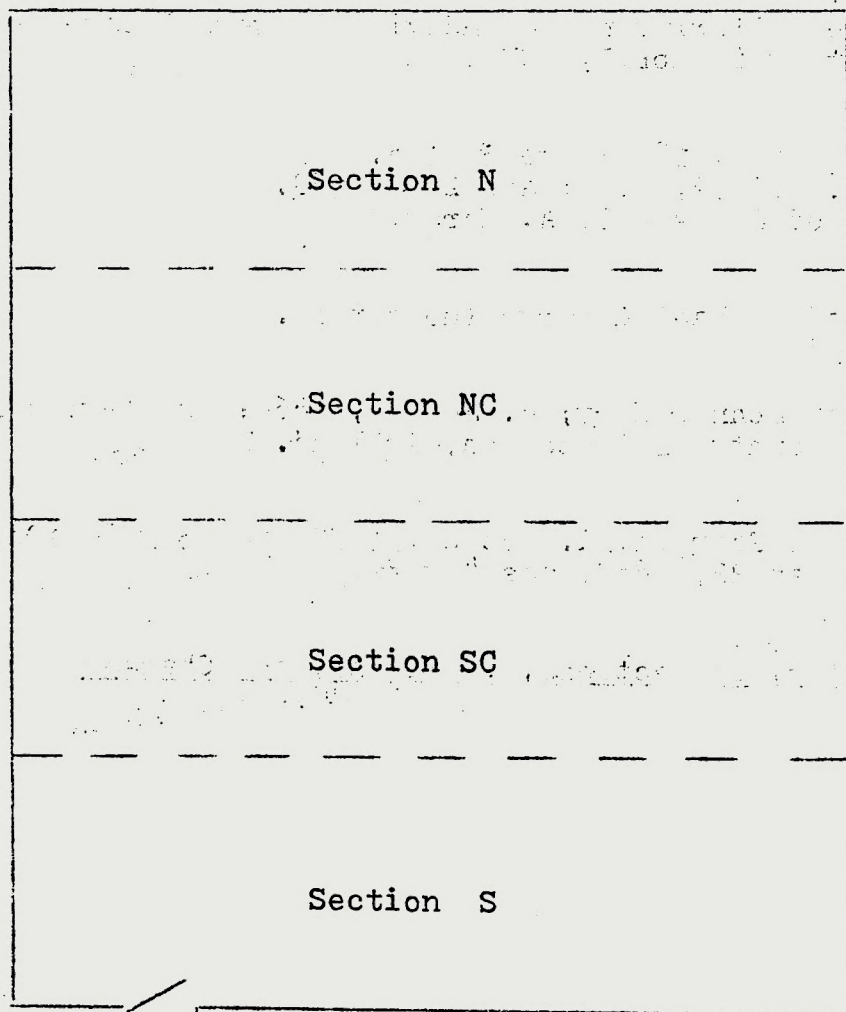
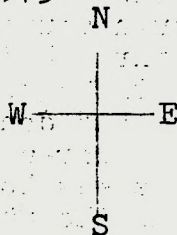

R o a d

BALDOCK:

James H., son of ?J? P. & P.; d. Aug 26, 1853; age 8m 27d. (SC)  
Richard; d. Jun 21, 1885; age 36y 1m 9d. (SC)

BALDWIN:

Charles; d. Jun 14, 1860; age 68y. (SC)

BIRDSELL:

Lucy R., dau of J. & E.; d. Nov 4, 1881; age 3y 6m 24d. (SC)  
Elizabeth; 1833 - 1917. (SC)

BOGSWELL:

Ethel Irene; 1890 - 1891. (S)

BONN:

Barbara Cuba, wife of John; d. Dec 9, 1907; age 69y 2m 2d. (S)  
John; d. Nov 11, 1871; age 45y. (S)  
George, son of John & Barbara; d. Jul 5, 1882; age 22y 5m 4d. (S)

BUCK:

Barbara M.; d. Sep 11, 1881; age 84y. (SC)

BUTTERFIELD:

William W.; d. Mar 11, 1873; age 45y 7m 17d. (SC)  
Ellen E.; d. Mar 5, 1873; age 13y 11m 24d. (SC)  
Lewis M.; d. Mar 5, 1873; age 1y 1m 3d. (SC)  
Franklin C.; d. Mar 3, 1873; age 11y 9m 3d. (SC)  
Anna; d. May 10, 1917; age 80y 1m 29d. (SC)

CALE:

Maudie; 1885 - 1886. (S)  
Ross; 1898 - 1900. (S)

CLUGSTON:

Ann Eliza, wife of Warren; d. Sep --, ----; age 24y 11m 18d. (S)

CUBA:

Barbara; (See BONN).

ELLIS:

James; d. Sep 20, 18?83?; age ---. (S)  
Margaret; d. Mar 9, 1897; age 77y. (S)  
Fannie; (no dates). (S)  
William; (no dates). (S)

GILL:

Mathew C.; Aug 13, 1808 - May 4, 1896. (S)  
Mary; May 22, 1814 - Jan 26, 1903. (S)

HALL:

William R., son of R. & H. J.; d. Sep 8, 1856; age 4y 1m 6d. (N)

IRICK:

Martha F.; 1862 - 1928.

**JOHNSON:**

John C.; 1830 - 1906. (S)  
Malinda A., wife of John; 1829 - 1887. (S)  
Aneliza; 1866 - 1881. (S)  
Sarah Jane; 1869 - 1891. (S)

**KAISER:**

Jacob; d. Jul 8, 1878; age 59y 6m 3d. (N)  
Catherine, wife of Jacob; d. Sep 13, 1898; age 74y 1m 10d. (N)

**LEWIS:**

Mary E.; (See PARKINS).

**LITCHFIELD:**

Lucy C., wife of Joseph; 1821 - 1908. (SC)  
Joseph; d. Mar 30, 1891; age 69y. (SC)  
Frances E., dau of J. & L. C.; d. Feb 5, 1873; age 18y 2m 4d. (SC)  
Velma O.; d. Dec 17, 1885; age 1y 2m 5d. (SC)  
Frank; Jun 7, 1856 - Aug 24, 1895. (SC)

**LOGAN:**

Benjamin R.; 1828 - 1894; Co A 10th Mo Inf. (N)  
Rebecca, wife of Benj.; 1840 - 1917. (N)  
James H.; 1875 - 1875. (N)  
Nancy C.; 1876 - 1894. (N)

**MC NELLY:**

John S.; d. Mar 21, 1873; age 34y 6m 21d. (NC)  
Mary, wife of Joseph K.; Nov 11, 1819 - July 6, 1870. (NC)

**MILLER:**

W. H.; d. 1903; age 82y. (SC)

**MOSS:**

Sarah J.; d. Aug 11, 1875; age 21y 8d; A departed daughter of  
J. I. & M. Saffell. (NC)

**PARKINS:**

Ben L.; 1895 - Sep 22, 1934; South Dakota; Pvt 1 CL 326 BN Tank  
Corps. (S)  
Rachel J.; 1867 - 1935. (S)  
Henry C.; 1859 - 1922. (S)  
Effie M.; 1890 - 1930. (S)  
Harley C.; 1893 - 1960. (S)  
Ivan H.; 1904 - ----. (S)  
Forrest N.; July 27, 1885 - Aug 9, 1961. (S)  
Lewis J.; Aug 4, 1887 - Sep 22, 1951. (S)  
Mary E. Lewis, wife of J. W.; 1840 - 1909. (S)  
Mamie, dau of J. W. & M. E.; 1867 - 1874. (S)

**PENROSE:**

Infant; d. Jan, 1857. (SC)  
Alva; Jan 29, 1862 - Sep 29, 1862. (SC)  
Elida M.; Feb 18, 1864 - Jun 29, 1867. (SC)

PENROSE:

Elijah; Apr 12, 1826 - Apr 22, 1898. (SC)  
Martha, wife of Elijah; Jul 8, 1831 - Nov 20, 1896. (SC)

REID:

Infant of G. W. & E. R.; (no dates). (SC)

RITTER:

Christiann; d. Jan 13, 1877; age 74y 7m. (N)  
Samuel; 1822 - 1908. (N)  
Sarah, wife of Samuel; 1838 - 1922. (N)  
Emma E.; (See VERGEASON).

SAFFELL:

John I.; d. Aug 8, 1876; age 65y 1m 29d. (NC)  
Sarah J.; (See MOSS).

SHRYACK:

James M., son of J. A. & I.; d. Nov 1, 1861; age 4y 2m 21d. (S)  
John C., son of J. A. & I.; d. Oct 19, 1861; age 7y 5m 16d. (S)

STERKEL:

Sarah J., wife of J. F.; d. Sep 27, 1872; age ?32?y 5m 25d. (NC)

THORNBURGH:

R. J.; May 19, 1828 - Jun 18, 1902. (SC)  
Elizabeth, wife of R. J.; Jul 14, 1831 - Jun 18, 1901. (SC)

VERGEASON:

Emma R. Ritter, wife of William; dau of Sam'l Ritter; May 8, 1860;  
(no age or other date). (N)

WALKER:

Dollie, dau of E. & Ellen; d. Jan 28, 1894; age 12d. (SC)

UNKNOWN:

-----; d. Jun 16, 1872; age 21y 9m 18d.. (N) (Stone broken &  
majority not located).

Genealogical Notes - Bailey Cemetery

BONN: George (Death notice, in part, from The Macomb Journal, Jul 6, 1882): "G. E. Bonn was killed by a train yesterday; he lived with his widowed mother and sister near the residence of Geo. W. Kruse in Chalmers township. His father died several years ago."

BUTTERFIELD: Elizabeth (NOTE: No stone located for this individual) (Obit, in part, from The Macomb Journal, May 24, 1883): "Mrs. Elizabeth Butterfield died in this city on May 22, aged 74 years, 1 month. She was born in the Hocking Valley, Pa. Her maiden name was Avery. At an early age with her parents she came to near Columbus, Ohio where she grew to womanhood and was married to Greene Butterfield. In 1834, with her husband and family, she came to Illinois and lived in Schuyler Co. until 1845 when they went to Galesburg, Knox Co. In 1861, she moved to Macomb and since then

**BUTTERFIELD:** (Cont'd)

her husband has died. Of a family of 10 children, only 2 are living--Mrs. Geo. Gloyd and G. G. Butterfield, with whom she was living. Burial was in the Bailey Cemetery, southwest of Macomb where her husband and children are buried...."

William W., Ellen E., Lewis M. and Franklin C.; (Article appearing in a March, 1873, Macomb Journal): "William Butterfield and 3 of his 5 children all died of spotted fever at their home a few miles southwest of Macomb. Another son, aged 18 years, also had the disease, but recovered."

**CLUGSTON:** Ann Eliza (Obit, in part, from The Macomb Journal, Sep 8, 1881): "Ann Eliza Clugston died in Chalmers township on Sep 3, 1881 aged 24y 11m and 13d. She was a daughter of John Johnson of Chalmers township. Born in 1856 in this county; married Warren Clugston 4 years ago and moved to Kansas. She is survived by her husband and 2 children..."

**ELLIS:** James (Obit, in part, from The Macomb Journal, Sep 27, 1883): "James Ellis died at his residence in Chalmers township on Sep 20, 1883 aged 67 years. He was born in Denegal, Ireland and came to this country 33 years ago settling in the State of New York where he remained for 5 years. From there he moved with his family to Illinois. He married Margaret Walker and they had 4 sons and 3 daughters, all now living....."

**HALL:** William R., was a son of Richard & Hannah Jane (Sloan) Hall who were married in this county on August 30, 1849.

**PARKINS:** Henry Clay; d. May 12, 1922; aged 62y 10m 10d; b. Jul 2, 1859, in Schuyler county, Illinois; son of John & Mary (Lewis) Parkins; married Rachel Johnson; worked as blacksmith; died at 725 E. Jefferson Street, Macomb, Illinois.

**PENROSE:** Elijah and Martha Sullivan were married in this county on September 28, 1848..

**SNYDER:** Elijah (NOTE: No stone was found for this individual.) Elijah Snyder died on Jan 8, 1898 at the poor farm where he worked as a cook. He was about 72 years old and unmarried. Death was caused by congestive chill. Born at Canton, N. J. and was a baker by trade. Traveled twice around the world spending 3 years in China and sometime in Africa. A veteran of the Mexican war, serving on the American side and drew a pension. Survived by a sister, who lives in N. J. Member of the Masons at one time. Funeral on Jan 10th and burial in Bailey Cemetery south of Macomb.

**WAGNER:** Jacob (NOTE: No stone was located for this individual.) From Veterans Records: Army, US Vol Inf.

Notes, Corrections, Additions, and Changes

## Simpson Cemetery

Location: Macomb Township; SW $\frac{1}{4}$ , Section 19; about  $\frac{1}{4}$  mile south of U. S. Highway 67 - Tower Road intersection, and about  $\frac{1}{2}$  mile east on a privately owned lane.

Remarks: Completely fenced area in dense timber; heavy growth of weeds and trees. Stones in relatively good condition.

### MC CARTNEY:

George H., son of J. B. & E. L.; died Sep 9, 1842; age 3m 8d.

### NEEL:

William; died Jul 10, 1849; age 42y 3m.

### SHANNON:

Ann G.; died Jun 4, 1869; age 1y 4m 24d.

Lucia O.; died Jun 20, 1862; age 2m 19d.

Minnie E.; died Jan 25, 1877; age 6y 8m 4d.

(Above children are on a single stone; inscribed on the stone is, "Children of J. F. & M. L. Shannon").

### SIMPSON:

Martha E.; 1862 - 1908.

Isaac L.; 1896 - (No date of death shown).

Mary E., dau of L. G. & M. B.; died Jul 26, 1887; age 4y 11m 28d.

William M.; 1888 - 1918. Co "C", 123rd M. G. Btn, 33rd Div., Pvt., Oct 10, 1918.

John W., son of J. R. & M. A.; died (no date shown); age 2y 1m 15d.

James W., son of J. R. & M. A.; (dates unreadable).

Sarah A., wife of -----; died Feb 3, 1863; age 31y 2m 2d.

William T.; died Sep 18, 1878; age 51y 6m 27d. Government headstone.

James R., died Feb 21, 1879; age 76y 1m 15d.

Mary Ann, wife of James R.; died Feb 2, 1880; age 69y 10m 15d.

### Genealogical Notes - Simpson Cemetery

SIMPSON: James R.; d. Apr 21, 1879; age 76y 3m 15d; farmer; b. Granger Co., E. Tenn.; resident of Ill. 44 years; d. Macomb Twp.

1850 census: Simpson, James, 47, farmer, Tenn; Mary A., 40, Tenn; William I., 23, Tenn; Sarah A., 18, Ohio; Mary E., 11, Ohio; Margaret J., 10, Ill; Frances M. (female), 7, Ill; Isaac, 1, Ill.

Mary Ann; d. Feb 12, 1880; age 70y; b. Washington County, Tenn.; resident of Ill. 43 years; d. Macomb Twp. (Death notice, in part, from The Macomb Eagle, Feb 14, 1880): "Mrs. Simpson, the relict of the late J. R. Simpson residing 2 miles north of the city, died Thursday, aged about 70 years. She was an old citizen of this county.

Notes, Corrections, Additions, and Changes

## Brooking Cemetery

This family burial plot was located about  $\frac{1}{2}$  mile due east of a farm house now owned by the Mansir family. The Brooking family owned this property for several years; in about 1911 the farm was sold to the Bruninga family. Neighborhood sources who remember this area, recall the location of the cemetery and state that there were about a dozen stones here for several years. At the present time, there is no trace of this cemetery; no one can furnish any information as to the circumstances surrounding the closing of this cemetery, nor the present whereabouts of the stones and markers.

### Genealogical Notes - Brooking Cemetery

Thomas A. Brooking moved to Macomb in 1834 and was the 2nd son of a family of 11 children—8 daughters and 3 sons. He was born in Nottaway county, Va. near Richmond on Jan 20, 1795. His parents were Thomas Vivian and Elizabeth Sherwin Brooking; Elizabeth was the daughter of Col. Samuel Sherwin of the Rev. War. Thomas A. studied law and later moved to Ky.; he was admitted to the bar in Va.; he abandoned the law profession a short time later for unknown reasons. He and his family settled in the Versailles, Ky. area and were in the mercantile trade there. He married Mary Louisa Threshly there on Jan 25, 1816. Mr. Brooking died in 1858 and he and Mary had 13 children. Seven were living in 1885. Edward died while in the service with the 137th Ill Vol (died at Memphis—see Hamilton Cemetery). Wm. farmed north of Macomb; A. V. farmed and was a stock dealer near Macomb. R. S., was a trader. Mrs. Jane Randolph lived in Macomb and she was the widow of Wm. H. Randolph; Mrs. Augusta Palmer moved to Palestine, Texas. Mrs. Lucy Snyder moved to Carrollton, Mo. Mrs. Julia Randolph, wife of J. H. Randolph lived at Ft. Scott, Kan.; after his marriage, Brooking returned to Richmond and lived there 3 years. Then to Union county, Ky. and ran a sulphur springs for 5 years; then moved to Princeton, Ky. and there till the fall of 1834. Moved to this county and taught school here 2 seasons. He then was engaged in the making of brick north of town (Macomb) at the site of Oakwood Cemetery. He later moved to a farm, later woned by his son, Wm. T. Lived there till spring of 1850 and bought a hotel on the west side of Macomb square and was there for a few years. He died Feb 25, 1858 and was buried on the old homestead. Another daughter, Elizabeth, who married Joseph P. Updegraff on Sep 16, 1835, died in Oct of 1872. They had 2 daughters—Imogene who married J. A. Gates of Oswego, Kan. and Joseph Atherton, also of Oswego.

Thomas Brooking moved to the Macomb area in 1835 (the above paragraph says 1834) and during the spring of that year built a double log-cabin on Section 30, Macomb township, on the present site of Oakwood Cemetery. He taught the first school classes in the township and held those classes in the original county courthouse, which was located on the NE corner of the square. Mr. Brooking and his family, at that time, lived in a small house located across the street from the courthouse—the present location of the Union Nat'l Bank.



Alexander Vivian Brooking was born Feb 25, 1829 at Sulphur Springs, Ky.; son of Thomas and grandson of Thomas Vivian Brooking. Father was a native of Richmond, Va.; mother, Mary Threshley Brooking was born in Lexington, Ky. In 1834, A. V. moved with his parents to Macomb; his father was a school teacher and lawyer. Thomas bought 150A claim and worked this while teaching during the winter. A. V. was the 9th in a family of 12 children; lived at home till age 22 and with his father, bought total of 550A in this county. Took over half of the farm, and in 1854 took over (bought) entire farm from his father; lived there 11 years. Moved to Macomb in 1865 and took over Randolph Hotel (there in 1907). Sold the homestead and bought another farm; engaged in stock-raising and feeding horses. Retired from that business in 1904; farm known as Chickamauga Stock Farm - 2½ miles north of Macomb. A. V. married Aug 27, 1851 to Elizabeth H. Randolph; she was a native of Ohio; schooling in Ill.; she died in Aug, 1865; left 3 children—Thomas A., Melvina R., and Anna Louisa. On May 1, 1865, Brooking married Mary E. Butler, a native of this state. Had following children: Frederick V., Ethelin, Estella V., Brainerd B., and Winnie Viola. A. V. was a member of the Masonic Order (Macomb Lodge #17 and Morse Chapter #19); was living in Macomb in 1907.

Wm. T. Brooking (age 83 years in 1907) was born May 6, 1824 in Union Co., Ky.; son of Thomas A.; mother was a daughter of William and Lucy Upshaw Thresley, natives of Ky. and England, respectively. Both Thomas A. and his father were vets of the War of 1812. Thomas established a brick factory north of Macomb on the present site of the Catholic Cemetery. Thomas died in Feb 1858; he had 4 sons and 7 daughters. Wm. T. lived at home till age 26 and then married to Louisiana Walker on Mar 7, 1850; she a native of Indiana, born in 1833. Wm. T. veteran of the Mormon War in 1845. He and his wife established a home and a 160A farm across the road from the family homestead (the old Applegate place); sold it in 1864 and then bought 270A of the home place and moved there in 1866. Sold out in 1885 and opened a grocery store in Macomb; returned to the farm in 1893 and bought 80A; retired and moved to Macomb in 1898. School board member for 20 years; assessor in Macomb township in 1870; member of the Masonic fraternity. Mrs. Brooking died on Jan 5, 1902; had 6 children—W. A., Lucian Threshly, Dolly (married W. M. Winslow), and 2 children who died in infancy, and another who who died at age 12 years.

Notes, Corrections, Additions, and Changes

MID-CONTINENT PUBLIC LIBRARY

## County Farm Cemetery

All that remains of this cemetery is a lone government headstone of a civil war veteran. The inscription reads: "Michael Nolan, Pvt., Co "A", 84th Ill. Inf."

Before it's closure several years ago, the McDonough County Farm was located about a mile south of Macomb in Scotland Township (SE $\frac{1}{4}$ , Section 7). The main building was razed in the late 1850's after the property was sold. The cemetery grounds were located east of the former building about one quarter of a mile; the site was near the top and on the northwest side of a small hill. At this time, it is impossible to determine the number or names of those buried at this location as it appears that all but the single remaining stone have been removed from their original locations.

There has been no fencing around the grounds for several years and the only evidence of it's being a cemetery is the government stone of Private Nolan and a number of slight depressions in the ground—apparently, the locations of other graves.

### Genealogical Notes - County Farm Cemetery

NAVERT: William Paul; d. Sep 1, 1921; aged about 70 years; occupation, painter; Mr. Navert was married and was born in Illinois.

SHORT: Charles Thomas; d. Nov 30, 1923; age 64y 4m 4d; b. in Ky. July 26, 1859, son of Joseph and Mary (Wade) Short, both natives of Ky.; Mr. Short was a farm laborer and died in Macomb; he was single.

WETHERBY: John; d. July 26, 1883; age 42 years; laborer; born in Ohio; he was single.

### Notes, Corrections, Additions, and Changes