

"Crossroads of
West-central
Illinois"

**McDONOUGH COUNTY
HISTORICAL AND GENEALOGICAL
MISCELLANY
1826 - 1976**

RURAL CEMETERIES
OF
McDONOUGH COUNTY, ILLINOIS
VOLUME XIII
TENNESSEE & HIRE TOWNSHIPS

McDONOUGH COUNTY, ILLINOIS

REF. 977.342 L567 V. 13
Lester, Duane.
Rural cemeteries of
McDonough County, Illinois

MID-CONTINENT PUBLIC LIBRARY
Midwest Genealogy Center
3440 S. Lee's Summit Rd.
Independence, MO 64055 **MGC**

RURAL
CEMETERIES
of
MC DONOUGH COUNTY, ILLINOIS

Volume XIII
Tennessee - Hire

By Duane Lester
Good Hope, Illinois

Printed by
Schuyler - Brown
Historical and Genealogical Society
and
The Schuyler Jail Museum

MID-CONTINENT PUBLIC LIBRARY
Midwest Genealogy Center
3440 S. Lee's Summit Rd.
Independence, MO 64055 **MGC**

MID-CONTINENT PUBLIC LIBRARY



3 0000 13101768 7

THE HISTORY OF TENNESSEE

Volume XIII

Tennessee - Hire

By Duane Lester
Good Hope, Illinois

Printed by
Schuyler - Brown
Historical and Genealogical Society
and
The Schuyler Jail Museum

CONTENTS

Introduction	1 - 11
General Description	111 - 1x
Friendship Cemetery	1 - 18
Mounting Cemetery	19 - 20
Supplement to Friendship Cemetery	
White Cemetery	21 - 23
"A monument is erected,	
Pope Cemetery	24 - 25
not because a person died,	
Catholic Cemetery	26 - 31
but because a person lived."	
Central Cemetery	32 - 34

Volume XIII

Table of Contents

Preface i - ii

Maps and plats iii - ix

Friendship Cemetery 1 - 18

Mourning Cemetery 19 - 20
(Supplement to Friendship Cemetery)

White Cemetery 21 - 23

Pope Cemetery 24 - 25

Catholic Cemetery 26 - 31

Central Cemetery 32 - 34

Vandalism is responsible for the destruction of many grave stones. Countless markers have been completely or partially destroyed. Inscriptions have been obliterated by shotgun blasts, stones have been broken into shreds of glass, and some markers have been entirely removed from their original locations.

While weather-wear and the effects of weather are part of the destruction of individual markers, they are directly responsible for the eventual obliteration of graveyards. Several local cemeteries have had no maintenance for a number of years and the grounds have become overgrown with livestock. Groundhogs and other burrowing animals have obliterated large portions of various cemeteries. Many grave markers are nearly invisible because of massive growths of weeds and brush. Stones have fallen, broken, and become completely buried with soil and debris.

Preface

Within the boundaries of McDonough County, Illinois are more than a hundred cemeteries and gravesites ranging in size from a single burial site to the expansive Oakwood Cemetery at Macomb. Within these cemeteries are the remains of an estimated 40,000 individuals who have died since the first settler arrived here over 150 years ago. Graves of countless others are scattered over the countryside of McDonough County; but, exact sites of many of these resting places are no longer known for various reasons. During the early days of this county, there were obviously no central burial grounds; thus, a pioneer family having the misfortune of losing one of its members placed the deceased in a grave on a family homestead and erected a makeshift marker. A number of these family burial grounds later became public cemeteries, however, many of the grave sites soon became "lost". Crude wooden markers or a hand engraved stone soon succumbed to the elements and were never replaced; scores of families moved further west after staying in this area only a short time and the gravesites of their loved ones shortly became insignificant mounds of earth; a number of families passing through this vicinity suffered individual losses. A prime example of the latter is contained in a history of Bethel Township. In 1830, four children of an emigrant family died while enroute through McDonough County. They were buried near their places of death which occurred about two miles southwest of Fandon. All traces of those graves have long been gone. During the summer of 1834, a widow lady died at her home in northern Tennessee Township. Her coffin of dressed walnut lumber was built by a local cabinet maker and she was buried in the timber near her home. Within a few years, no evidence remained to indicate the presence of her final resting place. A family who created an excellent farm from the prairies a few miles north of Macomb, maintained a fenced family burial site for several years. This cemetery contained the graves of about 12 former family members. During the early 1900's, the farm changed ownership. Shortly thereafter, the new owner removed all the stones, took down the fence, and this graveyard became part of a cornfield. These are only three of the countless incidents involving the total disappearance of burial sites. At this time, it is impossible to determine the locations of hundreds of individual's graves in this county.

Vandalism is responsible for the destruction of many grave stones. Countless markers have been partially or totally destroyed. Inscriptions have been obliterated by shotgun blasts, stones have been broken into dozens of pieces, and some markers have been entirely removed from their original locations.

While weather-wear and vandalism accounts for most of the destruction of individual tombstones, neglect is directly responsible for the eventual deterioration of graveyards. Several local cemeteries have had no protective fencing for a number of years and the grounds have become grazing land for livestock. Groundhogs and other burrowing animals have undermined large portions of various cemeteries. Some areas are nearly invisible because of massive growths of weeds and brush. Stones have fallen, broken, and become completely covered with soil and debris.

The overall conditions of our county cemeteries is a pathetic case. While some grounds are well maintained, or at least partially kept-up by various families, many have been totally forgotten. This situation is appalling and should never have come about. Apparently, lack of time, expense, and most of all regard has brought about the present-day poor conditions of many of our rural cemeteries.

Genealogical notes accompanying the various cemetery listings were prepared from a wide variety of sources including: Local area history books and atlases; newspaper files; county, state, and federal archives; family histories. These notes were collected at random from readily available sources and little, or no attempts were made to search for material for more complete genealogies. These notes are presented only for the purposes of identification and/or clarification.

Every attempt has been made to present complete and accurate information. Readers will find errors and omissions. Others will not agree with portions of my findings; however, no information contained herein is based solely on assumption or guesswork. It must be remembered that this information has been prepared for use only as a tool for further research and that nothing must be taken as final and absolute.

The larger cemeteries contained in these volumes are accompanied by grave location charts. These charts in no way are intended to represent any professionally prepared plat or survey that may exist. Their preparation and presentation are solely for general location purposes.

When copying inscriptions from grave markers, it is sometimes impossible to read some portions of the engraving. Names, dates, ages, etc. that were found to be unclear or totally missing are indicated by the use of question marks or dashes, i.e., SPICER, James T., infant son of ?J.B. & S.J.?.; d. -----; age -----. The letters or numbers enclosed in parenthesis following the inscription, indicate general location as indicated on the accompanying chart.

Abbreviations used are as follows:

b.	born	m.	months
Cav.	Cavalry	md.	married
Co.	County/Company	sec.	section
d.	died/days	twp.	township
dau.	daughter	y.	years
Inf.	Infantry		

Time and space prohibits proper recognition for all those individuals who gave assistance in preparing and publishing these volumes. Deep and sincere appreciation is extended to all concerned, especially to the following: My parents, Mr. and Mrs. Lloyd Lester, and my wife, Rose; and to Mrs. Lavina Walton and other members of the Schuyler County Historical and Genealogical Society for printing and binding the finished product. Thank you.

Duane Lester



Mc Donough County, Illinois

1921

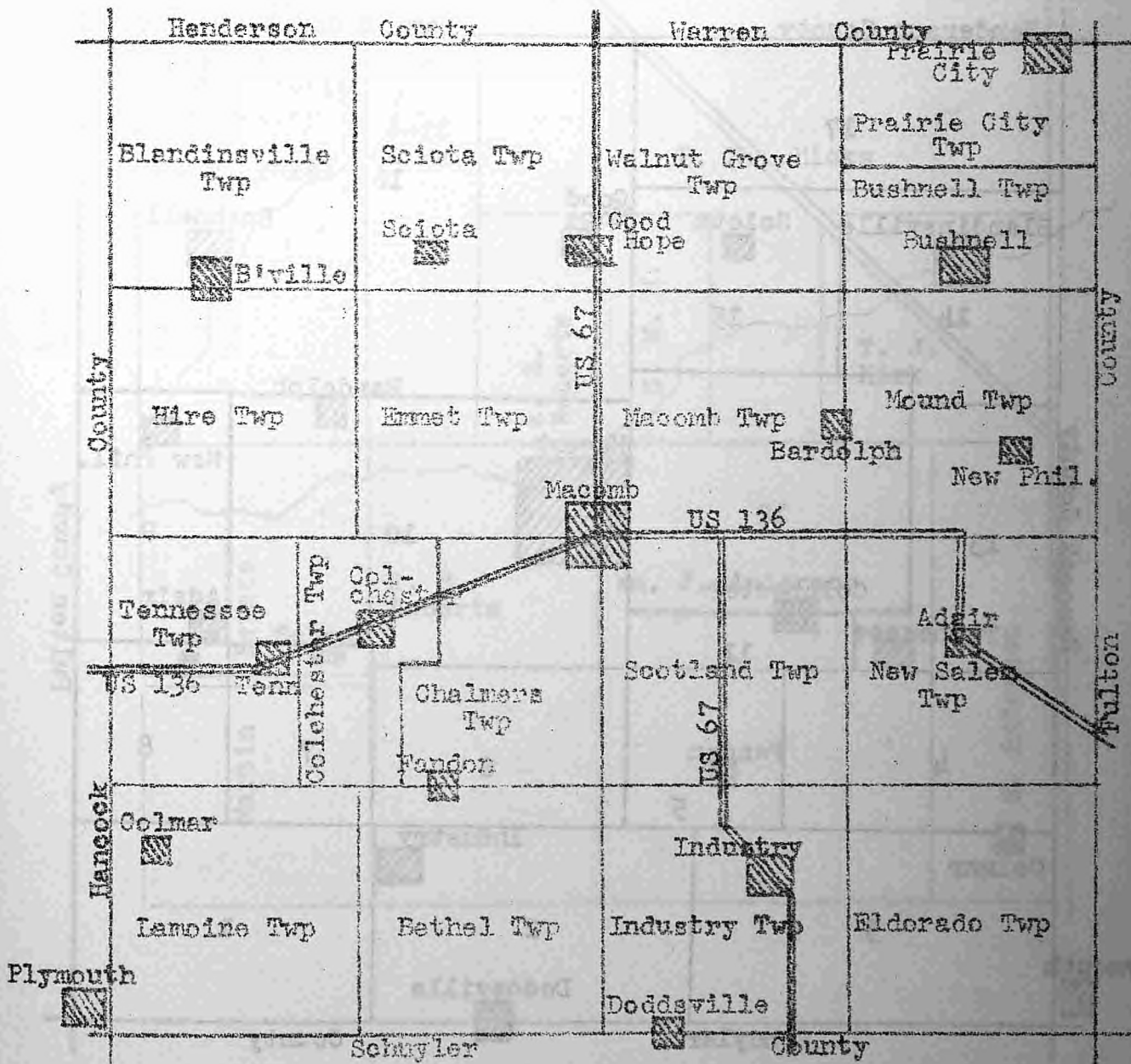

Areas covered by volumes I - XVII
 "Cemeteries of McDonough County, Illinois"

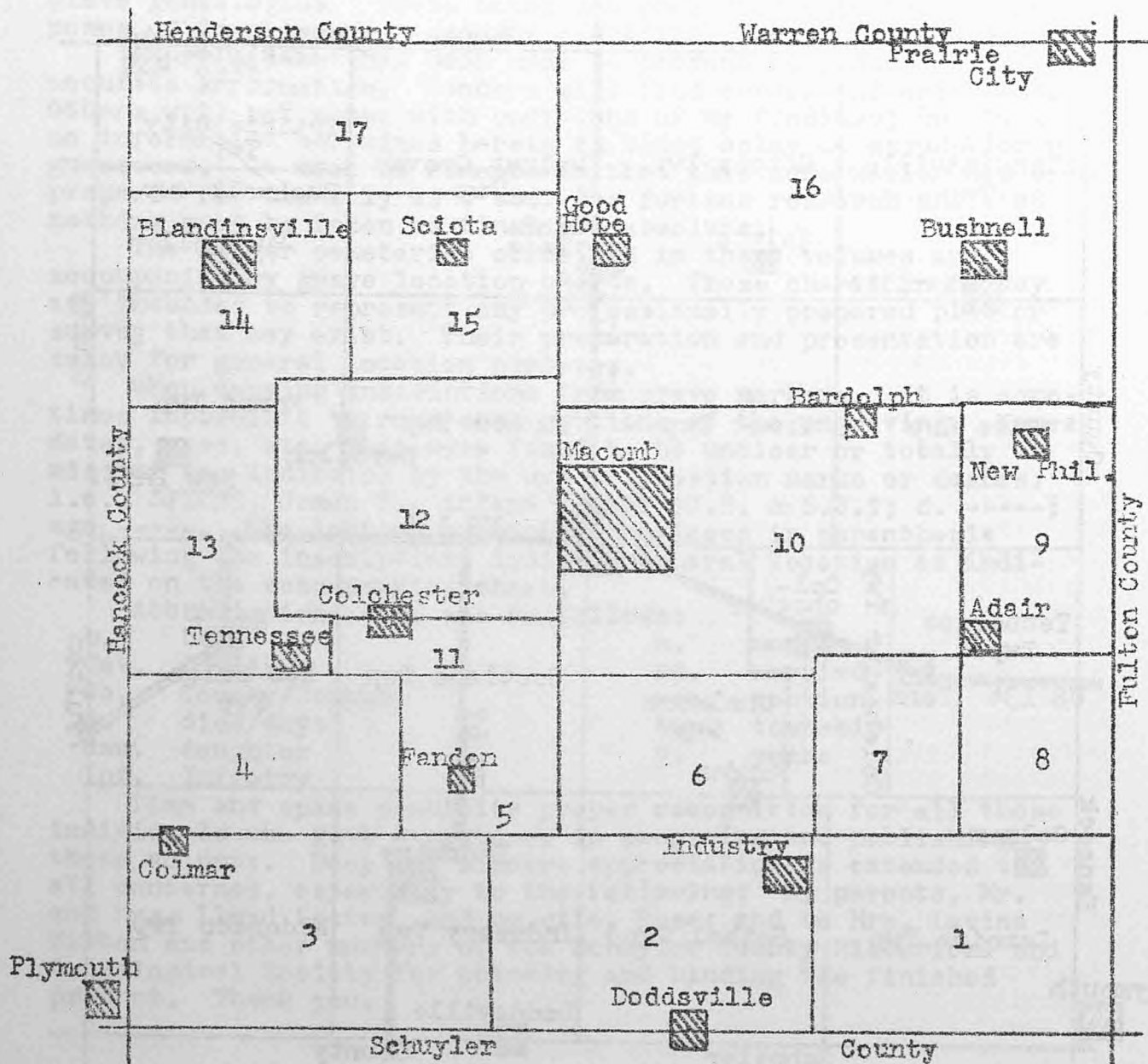

Section 5
Tennessee Township, T5N R4W; 1871

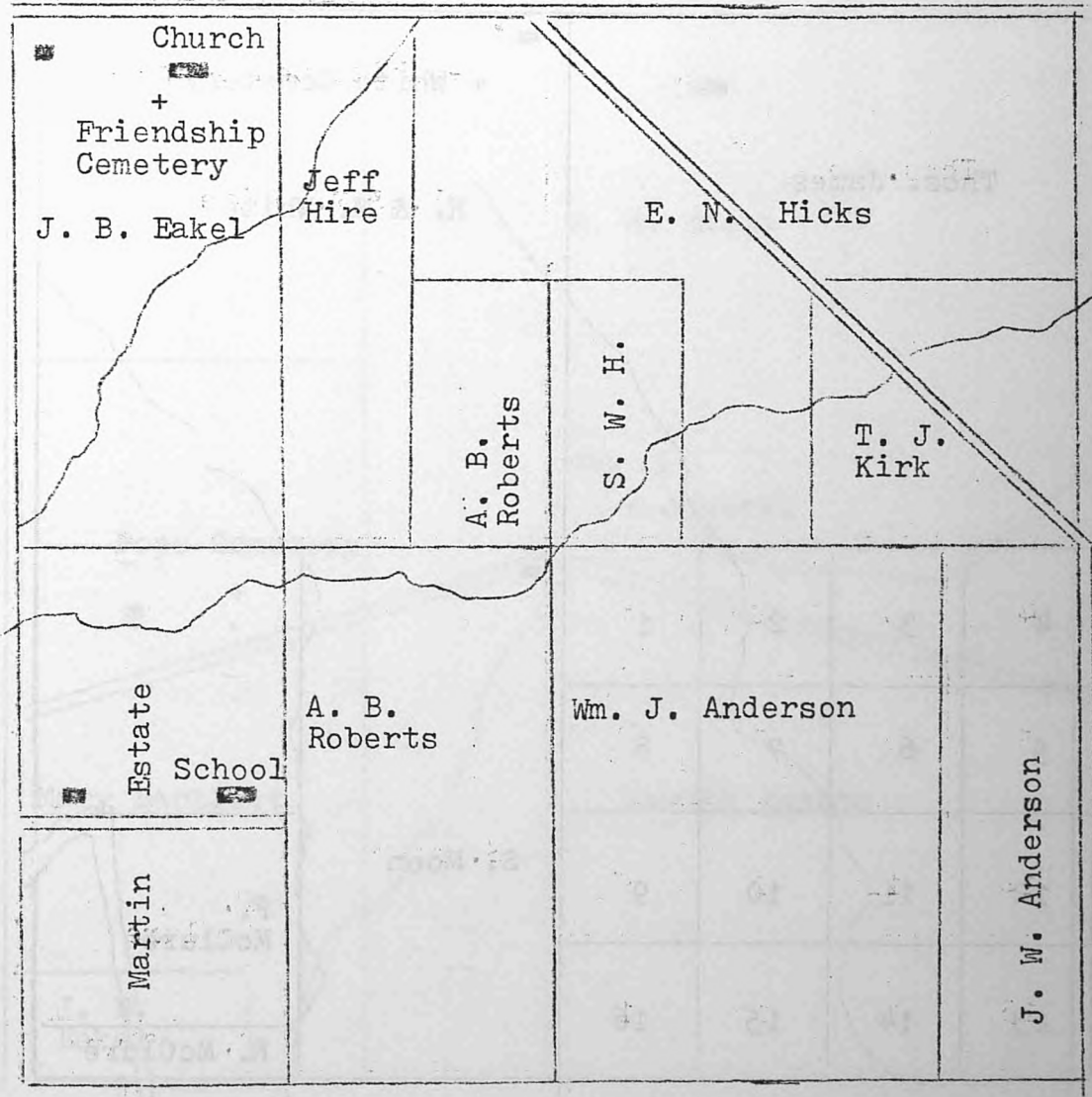

Section 9
 Tennessee Township, T5N R4W; 1871

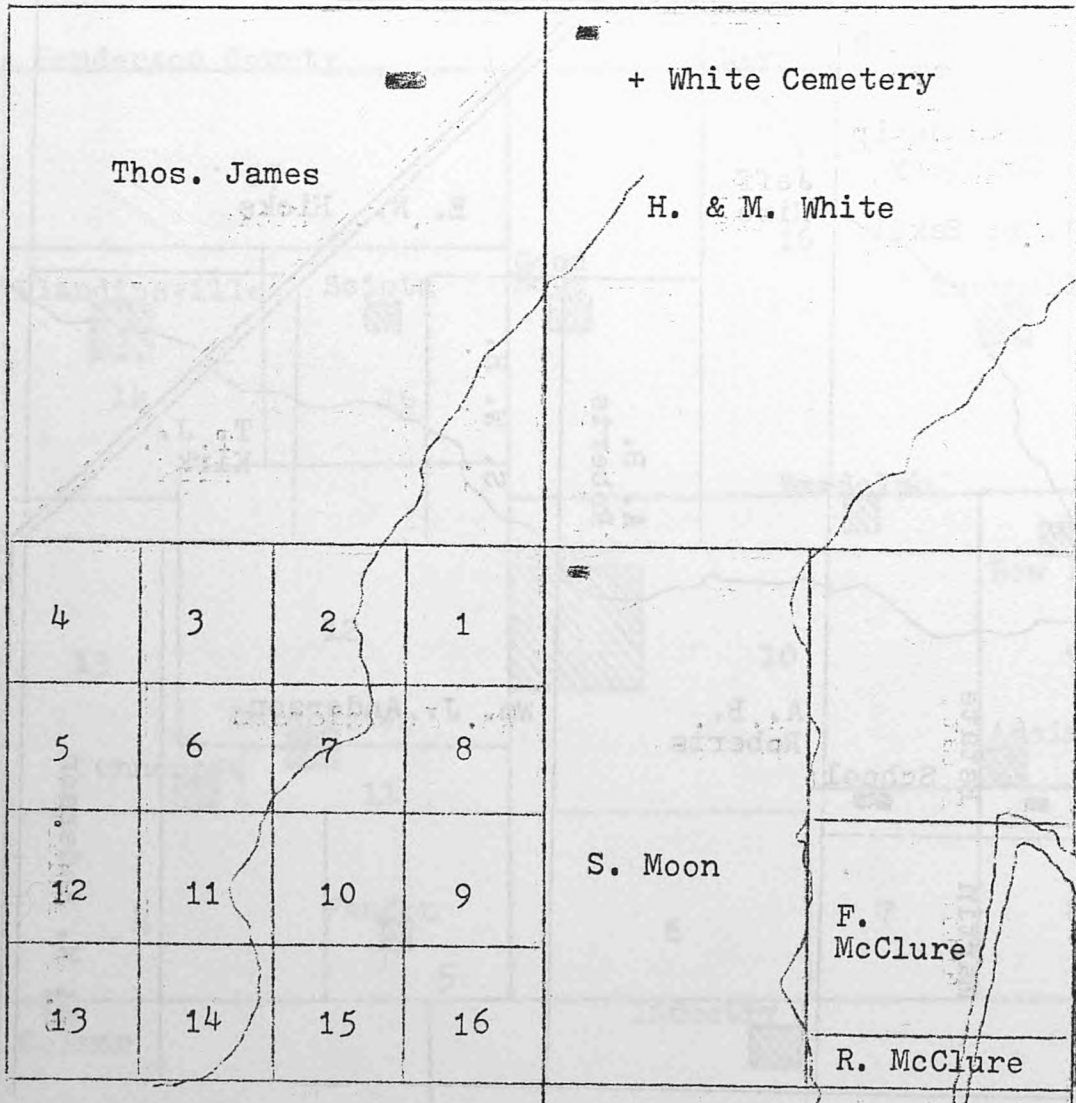

Section 6
Tennessee Township, T5N R4W; 1871

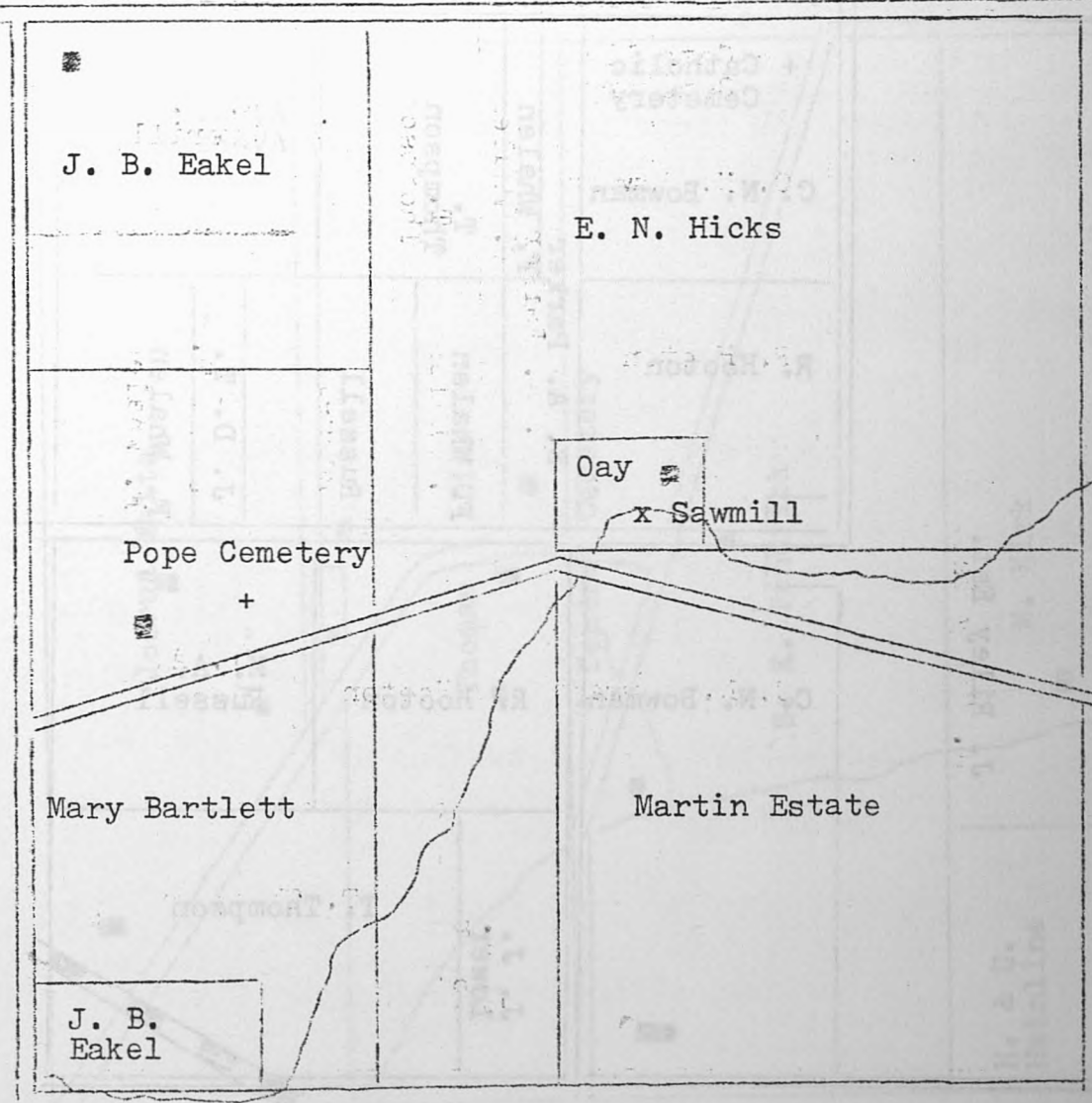

Section 15
 Tennessee Township, T5N R4W; 1871

J. Riley Est.	+ Catholic Cemetery C. N. Bowman	S. A. Parker F. Whalen	T. Thompson	A. W. Averill
	R. Hooton	F. Whalen	Russell	J. D. T. F. Whalen
	C. N. Bowman		R. Hooton	M. A. Russell
		J. J. Lower	T. Thompson	

Section 19
Hire Township, T6N R4W; 1871

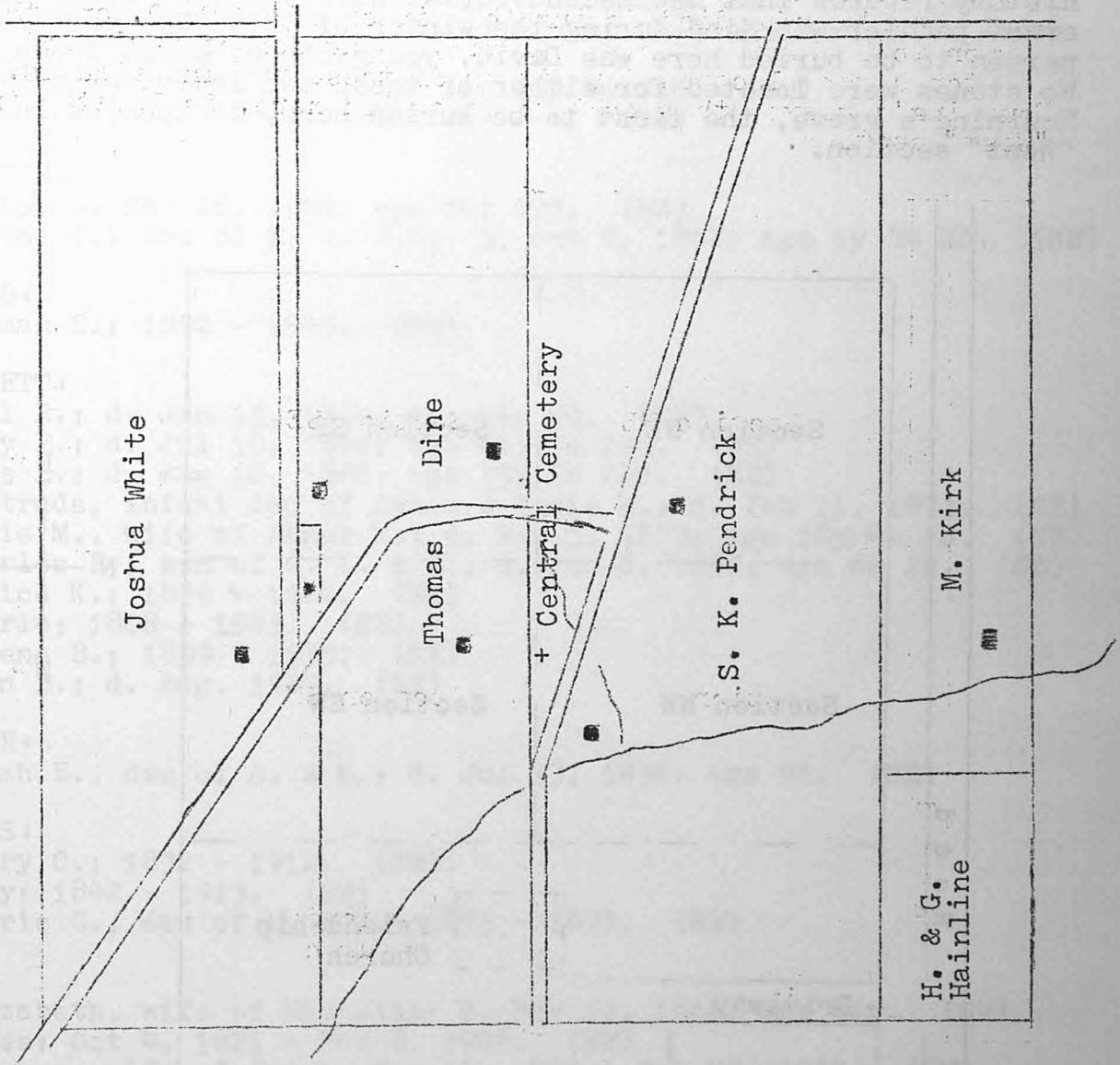

Friendship Cemetery

Location: Tennessee Township; NW $\frac{1}{4}$, Section 5; four miles west of Argyle State Park.

Remarks: This cemetery is well cared for and is fenced on all sides except the road frontage. The first burial here was in 1838 and the area has been used as a cemetery since that time. Friendship M. E. Church was organized in 1833 and meetings were held in private homes, groves, etc., until a frame structure was built near the site of the present building in 1851. The cemetery grounds were surveyed and platted in the 1870's. Local history records that the second burial here was that of an itinerant peddler who died during the winter of 1839-40, and the third person to be buried here was David, young son of David Brown, Sr. No stones were located for either of these two individuals. Mrs. Mourning's grave, the first to be buried here, is located in the "West" section.

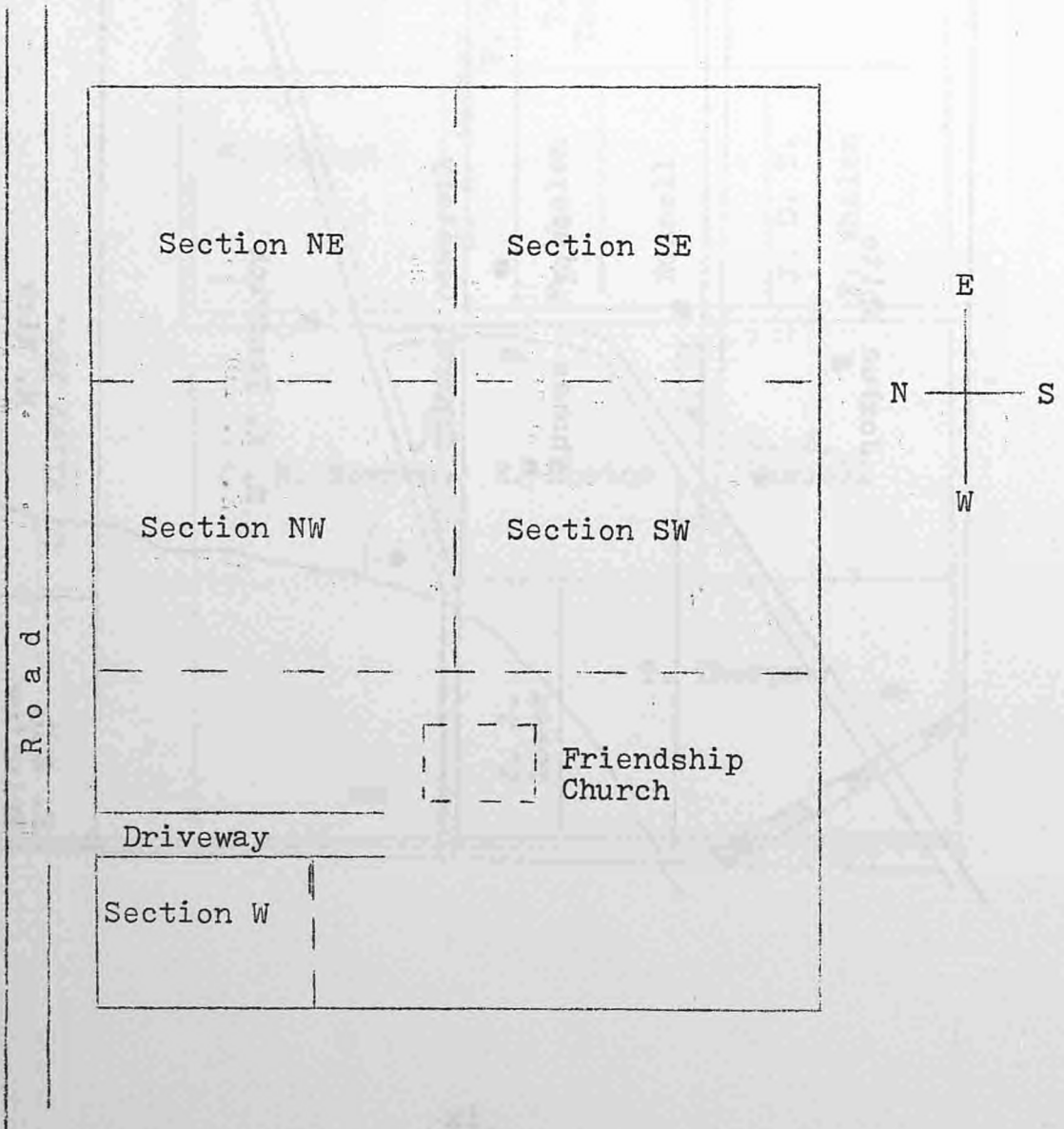

ADES:

John E., son of S.; d. Dec 12, 1872; age ---. (NW)
Rebecca J., dau of C. & L.; d. Jan 20, 1865; age 8y --m --d. (NW)

ALLISON:

James W.; d. Feb 16, 1857; age 24y 11m 7d. (SW)
William; Jun 25, 1805 - Aug 14, 1878. (SW)
Margaret Eakle, wife of Wm.; Dec 27, 1808 - Oct 17, 1856. (SW)
Also inscribed on above stone: "William Allison and Margaret Eakle, born in Augusta Co., Va.; married Oct 30, 1828; moved to Ross Co., Ohio, 1834; and to McDonough Co., Ill., 1852."
Thomas P.; Nov 10, 1841 - Jun 7, 1864; died and buried at Portland, Oregon. (SW)
Alexander; d. Feb 19, 1853; age 22y 8m 25d. (SW)
Elizabeth; d. Nov 23, 1852; age ---. (SW)

ANDERSON:

James; d. Mar 26, 1864; age 64y 23d. (NW)
Martha J., dau of W. J. & A.; d. Oct 8, 1862; age 1y 8m 2d. (NW)

ARNOLD:

Thomas E.; 1892 - 1945. (NW)

BARTLETT:

Joel R.; d. Jan 15, 1864; age 44y 9d. (NE)
Mary E.; d. Jul 10, 1886; age 64y 1m 29d. (NE)
Ross L.; d. Aug 10, 1888; age 35y 9m 24d. (NE)
Gertrude, infant dau of Abner & Addie M.; d. Feb 11, 1873. (NE)
Addie M., wife of Abner M.; d. Feb 5, 1873; age 18y 8m 1d. (NE)
Charles F., son of C. L. & E.; d. Jun 6, 1890; age 8m 2d. (SE)
Eunice K.; 1899 - 1922. (SE)
Carrie; 1868 - 1945. (SE)
Eugene B.; 1859 - 1933. (SE)
Glen B.; d. Aug, 1929. (SE)

BEAVER:

Sarah E., dau of A. & M.; d. Jul 13, 1856; age 4d. (NE)

BERGES:

Henry C.; 1832 - 1912. (SW)
Mary; 1842 - 1913. (SW)
Carrie C., dau of H. & M.; 1875 - 1893. (SW)

BICE:

Elizabeth, wife of Nicholas; d. Nov 17, 1862; age 61y. (SW)
James; Oct 4, 1821 - Feb 8, 1906. (SW)
Frances, wife of James; Nov 18, 1822 - Oct 29, 1904. (SW)
Elizabeth A., dau of J. & F.; d. Jul 1, 1859; age 12y 10m 8d. (SW)
Amanda, dau of J. & F.; d. Sep 24, 1868; age ---. (SW)

BOTSFORD:

Mary K.; 1856 - Oct 11, 1953. (SE)

BUTLER:

Margaret; d. Feb 1, 1864; age 67y. (NW)
E. B.; d. Jan 3, 1873; age ?89?y 6m 8d. (NW)

CAMPBELL:

Willie F.; Apr 12, 1871 - Mar 18, 1905; age 33y 11m 6d. (NW)
Williamson F., son of W. & S. L.; d. Sep 19, 1864; age 1y 9m 3d.
(SW)
Samuel D.; d. Feb 26, 1861; age 6m 20d. (SW)
Ellen T.; d. May 5, 1859; age 7m 17d. (SW)
(W., S., & E. were all children of W. & S. L. Campbell.)
Sallie L., wife of Williamson; d. Oct 11, 1867; age 47y 6m 17d.
(SW)

CARMACK:

Jackie Niel; Sep 11 - 24, 1936. (NE)

CONGDON:

John; Feb 14, 1861 - Jul 1, 1913. (SW)
Mary Elizabeth Hoff, wife of John; Jun 24, 1859 - Oct 29, 1902.
(SW)

CREASEY:

-----; d. Jul 25, 1860; age 46y. (NW)
John F., son of B. S. & N. C.; d. Aug 25, 1865; age 22y; Co I
124th Ill Vol Inf. (NW)

CUBA (KUBA):

George; son of Philip & Elizabeth; 1843 - 1924. (SW)

CUNNINGHAM:

Lotta Bel, wife of H. G.; dau of Nesburt & Ida C. Ruggles; d.
Dec 17, 1903; age 20y 8m 2d. (NE)

DICKENSON:

Charles; d. Aug 4, 1840; age about 43y. (W)

DIXON:

Joseph H.; d. Apr 17, 1893; age 45y 6m 14d. (NW)

DUKE:

Dora Bell, dau of N. & J.; d. Jul 26, 1878; age 3y 2m. (NW)

DUNNING:

Mary; May 19, 1816 - Dec 16, 1877. (NE)

EAKLE:

Vernon O.; 1891 - 1953. (SW)
Annie E.; 1899 - 1963. (SW)
Harvey; 1854 - 1937. (SW)
Gertrude Owen, wife of Harvey; d. 1904; interred in King Cem. (SW)
George; 1840 - 1910. (SW)
John B.; Feb 11, 1815 - May 29, 1892. (SW)
Henry, son of J. B. & M. A.; Dec 28, 1851 - Sep 29, 185-. (SW)
Mary A., wife of J. B.; Apr 10, 1815 - Dec 28, 1890. (SW)
Margaret; (See ALLISON).

EASTWOOD:

Elizabeth Jane, wife of J. G. and dau of J. & M. Welch; d. Jan 30, 1857; age 17y. (SE)

EBERT:

Fannie, wife of Dan'l; d. Jun 2, 1877; age 28y 10m 12d. (NE)
Infant sons of D. & F.; (no names or dates). (NE)

ELLISON:

Harold T.; 1915 - 1944. (NE)

EVANS:

James; d. Nov 26, 1856; age 35y 9m 16d. (SE)

FISHER:

Katherine; Sep 17, 1864 - May 29, 1906; age 41y 8m 12d. (NW)
Wilbur R.; Oct 13, 1894 - Dec 22, 1958; Pvt Co A 112th Inf. (SE)
Frederick; 1876 - 1959. (SE)

FOLTS:

Mary A., wife of R.; d. Dec 18, 1863; age 56y 10m 3d. (NE)
Reuben; 1800 - 1878. (NE)

FOX:

Talma C.; 1868 - 1934. (NE)
Pearl J.; Apr 11, 1878 - Aug 8, 1948. (NE)

FRAZELL:

Lucretia A., wife of Rev. W. B.; d. Jun 23, 1867; age 35y. (NE)

GAYER:

Elizabeth; b. in Germany, 1787; d. Jan 13, 1875. (NE)
Wilhelmine; (See SEELINGER).

GEORGE:

Christina, wife of Jacob; Oct 9, 1828 - Jul 21, 1898. (NW)
Jacob; Sep 30, 1829 - Jan 21, 1909. (NW)
Clarence W.; Apr 4, 1883 - Jan 18, 1903. (NW)
Ida L., wife of J. H.; d. Jun 2, 1884; age 27y 7m 29d. (NW)
Lucretia, dau of J. H. & I. L.; d. Jan 28, 1882; age 26d. (NW)
Louisa, dau of J. & C.; Sep 27, 1855 - Mar 25, 1878. (NW)
Lewis F., son of J. & C.; d. May 22, 1863; age ---. (NW)
Milton C., son of J. & C.; Dec 23, 1861 - Sep 20, 1880. (NW)
John; d. Jan 23, 1865; age 37y 7m 28d. (NW)
Eliza D., wife of Henry; d. Jan 8, 1869; age 66y 11m. (NW)
Henry; d. Sep 30, 1869; age 76y 2m 5d. (NW)
Henry F., son of P. W. & H. J.; b. Jul 24, 1874 (no other date. (NW)
Barbary, dau of J. & C.; d. Dec 17, 1860; age 15y 1m 14d. (SW)
Rosetta; May 6, 1863 - Aug 14, 1883. (SW)
John W.; b. May 19, 1864 (no other date). (SW)
Jacob; May 16, 1863 - Jul 17, 1869. (SW)
Lewis A.; Aug 7, 1870 - Aug 21, 1870. (SW)
John; Nov 29, 1804 - Dec 21, 1882. (NE)

GEORGE:

Catherine, wife of John; Feb 8, 1802 - Dec 15, 1882. (NE)
Joseph T.; 1891 - 1970. (NE)
Lillian B., wife of C. E.; 1892 - 1969. (NE)
Clifton E.; 1893 - 1963. (NE)
Mabel F., dau of Wm. P. & A. M.; Dec 10, 1886 - Feb 9, 1910. (NE)
William P.; 1857 - 1936. (NE)
Anna M. Green, wife of Wm.; 1866 - 1932. (NE)
John W., son of W. & A.; Jul 21, 1903 - Oct 2, 1914. (NE)
Gwendolyn M., dau of C. E. & L. B.; May 22, 1912 - Sep 23, 1921.
(NE)
Elbert H.; Mar 27, 1901 - Sep 21, 1901. (NE)
Elmer F., son of W. R. & A. M.; d. Sep 22, 1884; age ---. (NE)
Cecil E.; 1900 - 1960. (NE)
Mary E.; 1871 - 1942. (NE)
John H.; 1853 - 1918. (NE)
Mary E.; (See MORGAN).
Elizabeth; (See SCHWERER).

GESLER:

John G.; d. Aug 24, 1856; age 65y 11m 10d. (NE)
Elizabeth, wife of J. G.; d. Jan 10, 1877; age 84y 11m 29d. (NE)
Abigail M., wife of John; d. Dec 21, 1862; age 31y 6m 29d. (NE)
John S., son of J. & J. A.; d. Jan 1, 1866; age 1m 5d. (NE)

GORHAM:

Infant son of J. & M.; d. Oct 15, 1852. (SE)

GRAHAM:

Infant son of J. H. & E. C.; b. & d. Feb 9, 1879. (NE)
Infant son of J. H. & E. C.; b. & d. Feb 19, 1878. (NE)

GRAY:

Lyman Wesley, son of J. M. & H.; d. ---; age ---. (SW)

GREEN:

Anna M.; (See GEORGE).

GREMM:

Mary Schwerer, wife of C.; d. Jul 5, 1892; age 38y 1m 4d. (NW)

HADSELL:

Electtia E., dau of D. M. & L.; d. Feb 10, 1866; age 5y 5m 9d. (NW)

HARRIS:

Maria Martin; Jun 2, 1823 - Nov 1, 1913. (NW)

HARRISON:

Josiah; d. Sep 5, 1852; age 46y 1m 17d. (SE)
Josiah D.; d. Dec 27, 1861; age 23y 11m. (SE)
John S.; d. Jun 7, 1865; age 3y 4m 26d. (SE)

HART:

Maranda; (See SIMMONS).

HICKS:

Eliza J., dau of E. N. & J. E.; d. Feb 4, 1857; age 2y 9d. (NE)
John W.; son of E. N. & J. E.; d. Sep 25, 1864; age 19y 2m 20d.
(NE)
Hattie A.; Sep 25, 1856 - Jan 30, 1896. (NE)
Maud M.; Jul 10, 1877 - Sep 1, 1903. (NE)
Newton Delos; Mar 24, 1881 - Apr 24, 1882; age 2y 1m. (NE)
Ebenezer; Mar 10, 1816 - Jun 13, 1886. (NE)
Jane C.; May 22, 1816 - Apr 28, 1888. (NE)
Marilyn Kay, dau of H. E. & B. J.; d. Jan 8, 1950. (NE)
Darius; May 5, 1850 - Jun 15, 1908. (NE)
Hellen E.; 1901 - 1960. (NE)
Reon D.; 1898 - 1974. (NE)

HILLMAN:

Horrace W.; 1840 - 1915. (NW)
Harriet L., wife of H. W.; 1848 - 1931. (NW)
William E., son of H. & H.; d. Sep 25, 1900; age 20y 6m 16d. (NW)

HILMES:

Elizabeth; (See KUBA).

HIRE:

Margaret; (See KIOUS).
Amanda; (See WILSON).
Jesse; Mar 9, 1817 - Jan 22, 1877. (SW)
Elizabeth, wife of Jesse; Aug 5, 1819 - Jul 25, 1898. (SW)
Jefferson; Oct 27, 1818 - Apr 1, 1903. (NE)
Mary, wife of Jefferson; Apr 7, 1820 - Jan 31, 1883. (NE)
Infant son of Milton & Mary; d. ---; age ---. (NE)
Mary M., wife of M.; d. Aug 16, 1873; age 17y 6m 1d. (NE)
Amanda B., wife of Franklin; d. Mar 19, 18--; age 24y 6m 18d. (NE)
Hellen V., wife of A.; d. Dec 21, 1870; age 21y 5m 11d. (SE)
L. B., dau of A. & H.; d. Sep 20, 1870; age 10m 10d. (SE)
James C., son of A. & H.; d. Apr 23, 1867; age 5m 16d. (SE)
Catharine, wife of George; d. Feb 8, 1861; age 65y. (SE)
George; (no dates); Ohio Mil War of 1812. (SE)
Elizabeth, dau of J. & M.; d. Jan 14, 1852; age 1y 9m 1d. (SE)
Albert, son of J. & M.; d. Jan 27, 1853; age 5y 4m 13d. (SE)
Anderson, son of J. & M.; d. Jan 12, 1853; age 3y 8m 4d. (SE)
Martha, dau of J. & M.; d. Jan 4, 1853; age 9y 8m 15d. (SE)
Rebecca, dau of J. & M.; d. Dec 10, 1852; age 8y 4m 3d. (SE)

HOFF:

Mary E.; (See CONGDON).

HUFFMAN:

Jacob; b. in Pa., Aug 18, 1790; d. in Ill., Mar 17, 1858. (SE)
Casander B., wife of C.; d. Mar 5, 1855; age 51y 11m. (SE)
Nancy C., dau of E. & C.; d. Jan 29, 1864; age 5y 4d. (SE)

IRISH:

Grover L.; 1887 - 1912. (NE)
Benjamin F.; Jul 10, 1833 - May 16, 1910. (NE)
Mary F., wife of B. F.; Aug 31, 1847 - Jun 20, 1898. (NE)

IRISH:

Darius H.; 1884 - 1902. (NE)
 Thomas Scott; 1945 - 1966. (NE)
 John W.; 1880 - 1945. (NE)
 Anna B.; 1881 - 1957. (NE)
 Charles H.; 1881 - 1969. (NE)
 Myrtle A.; 1885 - 1964. (NE)
 Lloyd W.; Oct 10, 1917 - Aug 2, 1935. (NE)
 Anna Allene, dau of Mr. & Mrs. Chas. Irish; Dec 30, 1915 - Jan
 3, 1916. (NE)
 Charles Clair; 1907 - 1971. (NE)
 Rial C.; 1883 - 1958. (NE)
 Minnie F.; (See PECK).

JAMES:

Henry H.; d. Apr 30, 1859; age 12y 2m 25d. (SE)

JOHNSON:

Freddie S., son of J. & H. D.; d. Oct 16, 1878; age 1y 1m --d. (NW)
 Albert J.; 1891 - 1961. (SW)

JONES:

Pamelia L., wife of S. W.; Aug 13, 1839 - May 27, 1902. (NW)
 Stephen W.; d. Jul 10, 1881. (NW)
 Maria, wife of Francis D.; d. Aug 25, 1849; age 18y 2m 18d. (SW)
 Florence A.; 1877 - 1956. (NE)
 J. Gilbert; 1867 - 1957. (NE)

KEITHLEY:

George W.; 1831 - 1910. (NW)
 Abigail R., wife of George; 1835 - 1898. (NW)
 (Inscribed on her stone: "For many long years with sightless
 eyes, I patiently trod the way of light; and now, from out the
 rending skies, I wait the command, receive thy sight.")
 Clara D.; d. Nov 21, 1891; age 24y 5m 3d. (NW)

KENNEDY:

Fletcher, son of R. B. & B. P.; d. Feb 20, 1860; age 4m 2d. (NE)

KENT:

Sarah E.; Apr 23, 1858 - Nov 12, 1909. (NE)

KEYSER:

Linnie, dau of J. H. & E.; d. Aug 8, 18--; age 2y 8m 12d. (SE)
 Georgie, son of J. H. & E. L.; d. Apr 18, 1863; age 2y 6m 29d. (SE)

KIMBROUGH:

Albert E., son of E. W. & E. B.; Nov 10, 1913 - Mar 8, 1917. (SW)
 Edward M.; 1872 - 1958. (SE)

KIOUS:

H. Clay; 1851 - 1892. (NE)
 Maggie L., dau of S. & M.; d. Dec 3, 1875; age 29y 2m 11d. (NE)
 Jacob J., son of S. & Marg.; d. a prisoner of war at Macon, Ga.,
 Jan., 1865; age 21y.

KIOUS:

George W., son of S. & M.; d. ---; age ---. (NE)
Willington; 1865 - 1931. (SE)
Solomon; 1817 - 1890. (SE)
Margaret Hire, wife of S.; 1821 - 1894. (SE)
Lois; (See PECK).

KIRK:

Johnnie, son of John J. & Amanda; d. Mar 6, 1893; age 26y 10m 21.
(SW)
Amanda, wife of J. J.; d. Mar 27, 1889; age 52y 11m 2d. (SW)
Margaret Ann, wife of John J.; d. Jan 21, 1861; age 26y 11m 11d.
(SW)
John; d. Nov 11, 1856; age 64y 11m 18d. (NE)
Nancy, wife of John; Jun 19, 1797 - Aug 1, 1863. (NE)
Nancy A., dau of T. & M. M.; d. Sep 5, 1870; age 22y 5m 24d. (SE)
Harrison P., son of T. & M. M.; d. Mar 14, 1865; age 21y 9m 11d.
(SE)
Travis; d. Jun 10, 1854; age 56y 10m. (SE)

KNOEDLER:

Caroline R.; d. Nov 24, 1897; age 28y 10m 4d. (SW)
Mary K.; Jan 30, 1860 - Oct 15, 1888. (SW)
Gracie L.; d. Feb 2, 1897; age 4m 11d. (SW)
Elvan C.; d. Feb 4, 1895; age 3m 11d. (SW)
(Latter were 2 children of L. F. & Ida L.)
Catherine, wife of John; 1840 - 1916. (NE)
John; 1827 - 1888. (NE)
Cleon R.; 1943 - 1963. (SE)
Amanda (See SIEPEL).

KUBA (CUBA):

Philip; 1809 - Feb 5, 1897. (SW)
Elizabeth Hilmes, wife of Philip; 1806; d. Nov 8, 1862. (SW)
Eliza E., wife of Philip; Nov 6, 1825 - Feb 4, 1896. (SW)

LAMBERT:

Ansel Glen; 1905 - 1954. (SE)

LYON:

Nancy E., dau of J. & M.; d. Jul 27, 1842; age 1y 2m 2d. (W)
Margaret M., wife of John; Nov 8, 1803 - Nov 9, 1877. (NE)
R. W.; Dec 1, 1826 - Jan 20, 1887. (SE)
J. T.; Feb 15, 1861 - Apr 1, 1883. (SE)
W. S.; Mar 20, 1867 - Apr 21, 1888. (SE)
Anna; Jul 31, 1840 - Aug 15, 1912. (SE)

MARSH:

Eddie, son of N. & A.; d. Sep 12, 1869; age ---. (NW)
Samuel T.; d. Aug --, ----; age 50y 7m. (SW)

MART:

Charles M.; 1855 - 1929. (SW)
Mary E.; 1858 - 1931. (SW)

MARTIN:

Angie; 1864 - 1914. (NW)
Lucy; 1857 - 1917. (NW)
Narrotha S.; Apr 4, 1819 - Sep 30, 1914. (NW)
Andrew J.; d. Jan 25, 1888; age 28y 6m 15d. (NW)
John R.; 1854 (no other date). (NW)
Adison; 1871 - 1872. (NW)
Thomas H.; 1872 - 1873. (NW)
Susan, wife of Evan; d. May 4, 1878; age 76y 8m 3d. (NW)
Evan; Dec 22, 1842 - May 20, 1886. (NW)
Evan; Mar 7, 1796 - Mar 26, 1886; age 90y 19d. (NW)
Luella, dau of H. J. & M.; d. Apr 7, 1856; age ---. (NW)
Henry J.; d. Jul 20, 1866; age 43y 4m 13d. (NW)
James, son of E. & S.; d. Jul 5, 1859; age 19y 1m 1d. (NW)
Scott, son of E. & S.; d. Jun 5, 1859; age 25y 7m 3d. (NW)
Reuben; Jun 16, 1801 - Jun 8, 1864. (SE)
Delilah, wife of Reuben; Sep 2, 1784? - Jul 4, 1851. (SE)
Ettie Gertrude, dau of C. W. M. & S. J.; d. Feb 26, 1866; age 8m 25d. (SE)
Joseph D., son of G. & S.; d. Oct 5, 1865; age 1y 5d. (SE)
Maria; (See HARRIS).
Levica; (See MORRIS).

MC ELROY:

Achсах, wife of Rev. J.; d. May 14, 1872; in her 72nd year. (NE)
Achсах, dau of J. A. & Lizzie K.; d. Jun 10, 1867. (NE)
Veleno, dau of James A. & Lizzie K.; d. Nov 5, 1865; age 5d. (NE)

MC ELVAIN:

Charles Curtis; Apr 2, 1873 - Jun 16, 1904. (NW)
Eugene P., son of H. H. & M. A.; d. Sep 22, 1851; age 1y 4m 10d. (SE)

MESSERSMITH:

Margaret M., wife of Joel; d. Dec 15, 1873; age 17y 5m 1d. (NE)
Don C., son of J. & M. M.; d. Feb 21, 1875; age 1y 8m 17d. (NE)

MILLER:

Edah; d. Jul 1, 1857; age 64y 4d. (SW)
Mary E., wife of M.; d. May 27, 1855; age 85y 2m. (SE)

MILLSAPS:

Elizabeth, wife of Wm. L.; d. Oct 18, 1851; age 40y 9m 18d. (SE)

MONARCH:

D. W., son of H. H. & E. S.; d. Feb 1, 1863; age 14y 11m 15d. (SW)

MORGAN:

Joseph H.; 1847 - 1897. (NW)
Mary E. George, wife of J. H.; 1851 - 1922. (NW)
Infant dau of J. & M.; d. Feb 7, 1886. (NW)

MORRIS:

Samuel A.; 1861 - 1919. (NW)
Levica Martin, wife of Sam'l; 1861 - 1916. (NW)

MOURNING:

Elizabeth, wife of Wm.; d. Sep 21, 1847; age 39y 5m 16d. (W)
 Robert O., son of W. & E.; d. Sep 9, 1846; age 13y 22d. (W)
 William; d. Apr 16, 1870; age 65y 15d. (W)
 Hannah; d. Jul 25, 1838; age 59y. (W)
 -----; child of Wm. & Elizabeth; d. Dec 12, 1866; age 19y 6m (W)
 David F., son of Wm. & E.; d. Jan 28, 1875; age 31y 16d. (W)
 Clara I., dau of J. M. & A.; d. Feb 5, 186-; age 6y 29d. (W)
 Adeline, wife of J. M.; 1837 - 1864. (W)
 James A., son of L. B. & L.; d. Oct 6, 1856; age 7m 28d. (W)
 Mary, wife of J. L.; d. Sep 23, 1889; age 22y 11m. (NW)
 Elias, son of B. & N.; d. Dec 23, 1862; age 1y 7m. (NE)
 Sallie, dau of Sam'l & Caroline; d. Oct 14, 1880; age 16y 11m 6d.
 (NE)
 Leeah; 1904 - 1906. (SE)
 Jesse; 1875 - 1953. (SE)
 Mary C.; 1848 - 1917. (SE)
 John W.; 1838 - 1902. (SE)

NELSON:

Enos; d. Mar 24, 1894; age 71y. (NW)
 Mary Ann, wife of E.; d. Oct 28, 1919; age 93y. (NW)
 Frances A., wife of John; d. Mar 27, 1873; age 44y 11m 24d. (SE)
 Isabell, wife of John; d. Jan 30, 1855; age 42y 2m 12d. (SE)

NORMANDIN:

Arthur; 1903 - 1971. (NE)
 Flora; 1888 - 1916. (NE)
 Joseph; 1885 - Nov 8, 1956. (NE)
 Infant dau of Joseph & Flora; (no dates). (NE)
 Richard Allen; 1941 - 1942. (NE)

NORRIS:

Albertha M., dau of F. M. & C.; d. Dec 13, 1897; age 10y 8m 12d.
 (NW)
 Francis M.; 1837 - 1912. (NW)
 Clementine; 1854 - 1916. (NW)
 Ira C.; 1881 - 1966. (NW)

OAKES:

Berthena; d. Dec 26, 1883; age 87y 11m 1d. (NE)
 Laban; d. Dec 1, 1888; age 86y 9m. (NE)
 (Erected by Mrs. Mary A. Nelson, in memory of her father and
 mother.)

OKMAN:

Jacob Harold; 1907 - 1908. (SW)
 Ann; Jun 22, 1792 - Feb 3, 1872; age 79y 7m 11d. (NE)

OSBORNE:

Mary J., wife of A. J.; 1855 - 1899. (NW)

OWEN:

Gertrude; (See EAKLE).

PARKER:

Susan L.; d. Mar 12, 1864; age 4y 9m 3d. (SW)
Olive J.; d. Mar 4, 1864; age 8y. (SW)
(Children of E. B. & R. J.)

PECK:

Infant son of J. E. & L. K.; d. Jun 9, 1879. (NE)
Minnie F. Irish; 1889 - 1935. (NE)
Charlie K.; 1883 - 1968. (NE)
Infant dau of J. E. & L. H.; Dec 20 - 27, 1892. (SE)
Lois Murle, dau of Frank & Pearl; Oct 28, 1915 - May 12, 1916. (SE)
Joseph Edgar; Jul 23, 1854 - Feb 7, 1904. (SE)
Lois Kiou, wife of J. E.; Feb 7, 1859 - Dec 19, 1912. (SE)
J. B.; d. Dec 9, 1895; age 76y 11m 2d. (SE)
Eliza, wife of J. B.; d. Jan 10, 1892; age 58y 1m 14d. (SE)

PEDRICK:

Levi; Dec 29, 1792 - Nov 6, 1854. (SE)
Elizabeth, wife of Levi; Feb 17, 1804 - Aug 27, 1886. (SE)

QUINBY:

Nancy; d. Feb 23, 1874; age 68y 5m 22d. (NE)

RENSHAW:

James M.; d. May 22, 1855; age 51y 7m 22d. (NE)
Elizabeth; d. Sep 27, 1854; age 23y. (NE)
Martha; d. Mar 7, 1855; age 26y. (NE)

RILEY:

William H.; 1840 - Jan 26, 1870. (NE)
Martha, dau of W. H. & E.; d. Apr 22, 1869; age ---. (NE)
Alice, dau of G. & S.; d. Oct 14, 1875; age 24y 18d. (NE)
George W.; d. Sep 13, 1876; age 72y 6m 20d. (NE)
Sarah F., wife of Geo.; d. Apr 8, 1880; age 70y 2m 26d. (NE)

RISER:

Charles L.; 1866 - 1944. (NE)
Melvin W., son of W. & K.; Apr 9 - May 24, 1924. (NE)
Dora B.; 1869 - 1935. (NE)
Willis E.; 1897 - 1973. (NE)

ROBERTS:

Nellie A.; 1887 - 1940. (NW)
H. Claude; 1882 - 1967. (NW)
Justus Lee; Jan 7, 1917 - Apr 25, 1969; SK3 USNR WWII. (NW)
Laura A.; 1872 - 1921. (NW)
Oliver J.; Aug 21, 1876 - Dec 1, 1901. (NW)
Mary E., wife of B. H.; 1842 - 1921. (NW)
Bainbridge H.; 1839 - 1919. (NW)

RUGGLES:

Lotta Bel; (See CUNNINGHAM).

SCHWERER:

Charles W.; Jan 25, 1875 - Oct 8, 1918. (NW)

SCHWERER:

Rosetta A.; Oct 24, 1863 - Jan 24, 1954. (NW)
 Anna M.; d. Jun 1, 1895; age 23y 8m 20d. (NW)
 Louis; Sep 2, 1826 - Dec 30, 1911. (NW)
 Elizabeth D. George, wife of L.; Apr 27, 1831 - Apr 14, 1903. (NW)
 Louisa F., dau of L. & E.; d. Jun 16, 1861; age 2y 9m --d. (NW)
 Mary; (See GREMM)

SEELINGER:

John; b. in Germany, Jun 22, 1825; d. Dec 12, 1876. (NE)
 Wilhelmine Gayer, wife of John; b. in Germany, Nov 27, 1828; d.
 Apr 6, 1898. (NE)

SIBERT:

Fanny, dau of J. & C.; d. Jun 19, 1857; age 1y 1m 8d. (NE)

SIEPEL:

John P.; Sep 3, 1887 - Mar 12, 1901. (SW)
 Morris; Jul 28, 1890 - Jun 9, 1891. (SW)
 Amanda Knoedler; Aug 1, 1874 - Dec 11, 1954. (SE)
 Fannie; May 27, 1858 - May 5, 1945. (SE)
 Nathaniel A.; Feb 25, 1856 - Jul 20, 1926. (SE)

SIMMONS:

Miranda; Nov 23, 1882 - Aug 23, 1886. (NE)
 Clara L.; Sep 22, 1873 - Apr 3, 1875. (NE)
 (Children of N. E. & M.)
 Calvin D.; 1808 - 1877. (SE)
 Maranda Hart, wife of C. D.; 1812 - 1897. (SE)
 (Inscribed beneath these two names: Burials in Pope Cemetery)
 Ruth; d. Jan 3, 1847; age 68y 1m 27d. (SE)
 Marvin S., son of C. D. & M.; d. May 9, 1842; age 1y 1m 18d. (SE)
 Pinckney D., son of C. D. & M.; d. Mar 22, 1858; age 25y 10m 5d.
 (SE)
 Matilda Jane, dau of C. D. & M.; d. Feb 5, 1866; age 29y 3m 26d.
 (SE)
 James Eads; 1845 - 1915; Mus Co A 64th Ill Vols; Yate's Sharp-
 shooters. (SE)
 Kittie L., wife of J. E.; 1849 - 1927. (SE)
 Margaret J.; 1877 - 1944. (SE)
 Calvin W.; 1876 - 1962. (SE)

SMITH:

William L.; (no dates); Co G 62nd Ill Inf. (NW)
 Samuel; d. Sep 14, 1889; age 76y 6m. (NW)
 Sarah, wife of Sam'l; 1821 - 1902. (NW)
 William F.; Dec 26, 1867 - Dec 31, 1876. (NW)
 Infant son of M. H. & M. E.; b. & d. May 15, 1898. (SW)
 Luther H.; Feb 15 - Mar 23, 1879. (SW)
 John H.; Feb 15, 1829 - (no date). (SW)
 Albert J.; d. Nov 29, 1876; age 26y 1m. (NE)
 Sarah C.; Apr 14, 1857 - Sep 29, 1857. (NE)
 Jacob W.; Jan 6, 1862 - May 6, 1863. (NE)

SPARROW:

Dennis C.; Aug 27, 1864 - Mar 26, 1890. (NW)

Albert, son of D. C. & K. E.; Jun 15, 1889 - Oct 4, 1890. (NW)

SUTER:

Michael Lane; Jul 19, 1943 - Oct 11, 1960. (NW)

SWEASEY:

Lucy A., dau of W. H. & N. L.; d. Sep 17, 1865; age 1y 10m 20d. (SW)

Mary S., dau of W. H. & N. L.; d. Feb 13, 1862; age 2y 2m. (SW)

SYMPSON:

---, son of L. & M.; d. Jan 16, 1890; age 3m 7d. (NW)

TOLMAN:

Samuel S., son of O. & E.; d. Dec 21, 1853; age 5m 20d. (SE)

WALTERS:

Thomas B.; Aug 13, 1859 - Feb 14, 1896. (SW)

WELCH:

Mary M., dau of B. J. & M.; d. Jan 18, 1858; age 10y 4m 10d. (NE)

Lucy, wife of John H.; d. Jul 7, 1857; age 45y. (SE)

Solomon; d. Sep --, 1858; age 73y. (SE)

---; twins b. Apr 15, 1837; one d. Apr 15, the other, May 2, 1837.
(SE)

Jesse H., son of J. W. & M.; d. Aug 9, 1840; age 2y 4m. (SE)

Sarah C., dau of J. W. & M.; d. Apr 15, 1845; age 11m 15d. (SE)

(The latter 4 children were born in Mell Co., Ky.)

Citty F., dau of J. W. & M.; d. Oct 26, 1851; age 1y 1m. (SE)

William H., son of J. W. & M.; d. Sep 14, 1853; age 11m 11d. (SE)

Manda, dau of J. W. & M.; d. Mar 7, 1856; age 2y 10m 18d. (SE)

Mary, wife of James W.; Nov 30, 1812 - Mar 28, 1857; age 44y 3m
28d. (SE)

Mary Eliza, dau of J. W. & M.; d. Jan 2, 1859; age 17y 9m 12d.
(SE)

Elizabeth J.; (See EASTWOOD).

WERTZ:

John R.; 1854 - (no other date). (NW)

Henrietta, wife of John; Mar 30, 1862 - Feb 3, 1914. (NW)

WHITE:

William Marion; Feb 4, 1842 - Mar 26, 1914. (NW)

Ellenora, wife of Wm.; Feb 9, 1852 - Sep 9, 1922. (NW)

Henry A., son of M. & E.; d. Feb 14, 1879; age 7y. (NW)

Lizzie, dau of M. & E.; d. Oct 15, 1870; age ---. (NW)

Charles O., son of Marion & Ellen; Sep 20, 1885 - Dec 6, 1897;
age 12y 2m 16d. (NW)

Elizabeth, wife of Wm. S.; Nov 17, 1805 - Jan 11, 1900; age 94y
5m 20d. (SW)

William S.; d. Sep 29, 1859; age 68y 5m 20d. (SW)

John, son of W. S. & E.; d. Jan 13, 1853; age 19y. (SW)

John L., son of Thomas & Margaret; husband of Florence; d. Aug
19, 1889; age 21y 3m 2d. (SE)

WHITE:

Infant; stillborn Feb 28, 188-. (SE)
 Ella; d. Jan 24, 1875; age 1m 24d. (SE)
 Babe, a son of Thomas & M. J.; d. Mar 24, 1871; age 4 hrs. (SE)
 Griffith, son of J. & M.; d. Sep 27, 1851; age 2y 3m. (SE)
 Nancy, wife of J.; d. Feb 17, 1858; age 42y 8m 9d. (SE)
 Joshua; d. Jul 19, 1878; age 75y 5m 26d. (SE)
 James Morris, son of James & Elizabeth; d. Nov 16, 1884; age 17y
 10m 11d. (SE)
 Francis O., son of J. & N.; d. Sep 22, 1852; age 1y 2m 21d. (SE)

WILKS:

Polly; d. Nov 7, 18--; age 82y. (NW)

WILLIAMS:

Jerusha Ann, wife of A. L.; Sep 10, 1866 - Nov 14, 1892. (NW)

WILSON:

Charles E., son of T. B. & S. A.; Jul 11, 1863 - Apr 18, 1906.
 (SW)
 Burtres, son of C. G. & M. J.; d. Apr 13, 1878; age ---. (NE)
 Mary J., wife of C. G.; d. Nov 12, 1877; age 21y 4m 20d. (NE)
 Infant son of C. G. & M. J.; d. ---. (NE)
 Luly, dau of A. J. & Amanda; d. Sep 9, 18--; age --m 1d. (NE)
 Amanda Hire, wife of A. J.; d. Nov 28, 1884; age 29y 5m 6d. (NE)

WOLLEY:

Permelia E., wife of M. F.; d. Feb 20, 1862; age 33y 10m 16d. (SE)
 Smith, son of M.H. & P. E.; d. Aug 13, 1874; age 20y 10m 18d. (SE)

YETTER:

Earl; 1885 - 1966. (NE)

YOUNG:

Frank; 1862 - 1904. (NW)
 Emma, wife of Frank; 1867 - 1955. (NW)
 Rebecca, wife of C. A.; d. Oct 20, 1888; age 58y 4m 1d. (SW)
 O. A.; Aug 30, 1829 - Nov 13, 1915. (SW)
 T. P.; d. Nov 2, 1890; age 75y 5m 9d; Co C 85th Ill Inf. (SW)
 Martha A., dau of C.A. & R.; d. Jul 25, 1859; age 3y 2m 1d. (SW)
 Stephen A., son of O. A. & R.; d. Jan 5, 1858; age 6y 5m 1d. (SW)

ZIMMERMAN:

Ralph E.; Apr 2, 1884 - Jan 4, 1967. (SW)
 Claire E.; Feb 28, 1889 - Mar 4, 1967. (SW)

Genealogical Notes - Friendship Cemetery

BARTLETT: Mary E. (Obit, in part, from The Macomb Journal, Jul 15, 1886): "Mary E. Nichols was born in Louden Co., Va. on May 11, 1882 and died at her home about 6 miles west of Tennessee on Jul 10, 1886. When she was about 5 years old, she moved with her widowed mother to Ohio, near Mt. Gilead. She was a member of the Methodist Church. She married Joel R. Bartlett on Apr 13, 1843, and

BARTLETT:

they had 8 children - 6 sons and 2 daughters. One son died in infancy, and was buried near their Ohio home. With her husband and family, she came to Ill. in the spring of 1863 and settled where she died. Two and a half months after reaching their new home, her husband died, leaving her with 7 children-----All the children were present at the funeral, except a son from Kansas."

DICKENSON: Charles; will dated Aug 30, 1838. Names wife, Mary; four oldest children; Anne Jones; Nancy; John; and Wm. Dickenson. Mr. Dickenson indicates that he had money due him in the State of Va. His widow, Mary, remarried to Schuyler Moore. Both she and second husband are buried at Moore cemetery near Colchester. (NOTE: For more info on the children of Geo. and on Mary, see the Moore Cemetery, Volume XI.)

GEORGE: Ida L. (Death notice, in part, from The Macomb Journal, Jun 12, 1884): "Mrs. John George of Hire township, died last Monday. She was a daughter of Benj. Boyd."

Lucreta; b. Hire township; d. Hire township, Jan 28, 1882; age 26d.

Gwendoline; b. at Colchester; dau of Cliff & Lillian (Phoenix) George; d. at her home at Tennessee, Ill., Sep 23, 1921; age 9y 4m 1d.

GORHAM: 1850 census NC# 496; John, 28, farmer, Ohio (md. within year); Mary J., 18, Ky.

HICKS: Ebenezer (Obit, in part, from The Macomb Journal, Jun 17, 1886): "Ebenezer Hicks died last Saturday in Jacksonville, Morgan County. His late residence was in Hire township; burial was in a neighboring cemetery in Hire at the first part of the week. He was born Mar 10, 1816 in Union Twp., Ross County, Ohio. His father was a Marylander of German extraction. Eben lived in Ross County until 1842 when he came to Ill. and purchased the SE quarter of section 33, Hire Twp. He made his money entirely by farming. He owned over 4000 acres of land in McDonough Co. He is survived by his wife and a daughter, Mrs. B. F. Irish, and 2 sons."

Hicks, 1850 census NO# 482; Ebenezer N., 34, farmer, Ohio; Jane, 34, Ohio; John W., 5, Ill.; Nancy F., 3, Ill.; Darius, 6 mos, Ill.

HIRE: George (Death notice, in part, from The Macomb Journal, Jan 13, 1881): "George Hire, who was one of the oldest citizens in Hire Twp., died Tuesday aged 96 years (Jan 11, 1881). He was born in Va. in 1789 and as a young man moved to Ross Co., Ohio. From there he moved to McDonough Co. and settled in Hire Twp., which was named for him. He was a soldier in the War of 1812."

Jesse Hire, 1850 census NO# 486: Jesse, 32, farmer, Ohio; Elizabeth 30, Va.; Isaac, 13, Ohio; William, 9, Ohio; Christine, 7, Ind.; Adam, 6, Ohio; Mary E., 2, Ill.; Andrew, 1, Ill.; George, 60, Va., Catherine, 58, Va.

HIRE: 1850 census NO# 523; Jefferson, 31, farmer, Ohio; Mary, 29, Ohio; Franklin, 9, Ohio; Martha, 7, Ohio; Minerva, 5, Ohio; Albert, 4, Ohio; Anderson, 2, Ill.

1850 census NO# 525; TOLMAN, O. L., 43, farmer, Ohio; Elizabeth, 39, Va.; James, 20, farmer, Ohio; William, 17, Ohio; Elisa, 12, Ohio; Nathaniel, 8, Iowa; John, 5, Ill; Nancy E., 2, Ill.; HIRE; Rebecca, 6, Ohio.

LYON: R. W.; (Ovit, in part, from The Macomb Journal, Jan 27, 1887): "Robert Lyon of Tennessee Twp., died at his home last week. He was born in Adair Co., Ky. in 1829 and came to Ill. with his parents when aged 6 years, settled in Tennessee Twp. where he spent the remainder of his life. He was married in 1860 to Annie Sigars of Carroll Co., Ind. and was the father of 7 children, 6 of whom survive, along with his wife. Mrs. Gorham of Iowa is his sister. He died at his residence near Friendship Church."

1850 census NO# 506: LYON, Margaret, 46, Ky.; Anderson, 23, farmer, Ky.; Robert, 21, Ky.; A. R., 15, Ill.; J. P., 12, Ill.

MARSH: 1850 census NO# 475; Samuel, 44, farmer, NY; Feebe, 44, NY; Gilbert, 6, Ill.; Newton, 4, Ill.; ARNELL, Lydia, 14, NY.

MARTIN: Andrew J. (Death notice, in part, from The Macomb Journal, Feb 2, 1888): "A. J. Martin, son of Widow Martin, residing near Friendship Church in Hire township, died last Wednesday....."

1850 census NO# 474; Martin, Evan, 54, farmer, Ky.; Susan, 49, Pa.; Mary, 29, Ind.; Henry, 27, farmer, Ill.; Sarah, 25, Ill.; David, 22, farmer, Ill.; George, 19, farmer, Ill.; Scott, 17, farmer, Ill.; Martha, 15, Ill.; Charles, 12, Ill.; James, 10, Ill.; Evan, 8, Ill.; Henry C., 7, Ill.; Elizabeth J., 5, Ill.

1850 census NO# 526; Martin, Rueben, 49, farmer, Va.; Delila, 60, Va.; Jose, 17, farmer, Ky.; Lina, 18, Ky.

MC ELVAIN: 1850 census NO# 480; Henry H., 24, farmer, Ohio; md. within the year; Maticia, 24, Ky.; Eugene, 6 mos., Ill.

MILLSAPS: 1850 census NO# 470; William L., 47, farmer, Tenn.; Elizabeth, 39, Ky.; Joseph, 21, farmer, Ind.; Moses, 19, Ind.; Nancy, 17, Ind.; Sarah, 15, Ind.; Elizabeth, 15, Ind.; Margaret, 11, Ill.; Jason, 9, Ill.; Eliza, 6, Ill.; Susan, 4, Ill.; Adaline, 1, Ill.; BEEBE, Sarah, 22, NY.

MONARCH: 1850 census NO# 471; Henry, 33, farmer, Ind.; Elizabeth, 24, NC; Marilla R., 6, Ill.; Dennis W., 4, Ill.; E. J., 6 mos, Female, Ill.

MORGAN: Mary Elizabeth; b. at Greenfield, Ohio, dau of Jacob and Christina George, natives of Germany; Mrs. Morgan died at her home in Colchester, where she had lived for about 19 years; d. Sep 17, 1922; age 71y 8m 4d; widow of Joseph Morgan.

MOURNING: 1850 census NO# 527; William, 45, farmer, Ky.; Julia, 32, Ky.; John, 15, Ky.; Nancy, 12, Ill.; Martha, 10, Ill.; David A., 6, Ill.; Mary E., 3, Ill.

NELSON: Mary Ann, wife of Enos. She was a daughter of Laban and Berthena Oakes.

1850 census NO# 500; Nelson, John, 38, farmer, Ky.; Isabel, 38, Tenn.; Eldridge, 15, Ky.; James, 13, Ky.; Dorca, 9, Ill.; Mary, 7, Ill.; Matilda, 4, Ill.; W.L.L., 2, Ill.

OAKES: Berthena (Obit, in part, from The Macomb Journal, Jan 3, 1884): "Mrs. Berthena Oakes died Dec 26th, 1883, at the residence of her daughter, Mary A. Nelson, in Hire township aged 87 years 11 months and 14 days. She was born in N. Carolina on Jan 9, 1796. She and her husband had resided with her daughter for the past 4 years. She is survived by her husband and 1 daughter, 10 children having preceded her in death."

PEDRICK: 1850 census NO#451; Levi, 57, farmer, N.J.; Elizabeth, 40, Pa.; Samuel H., 25, farmer, Ohio; William, 23, Ohio; Elizabeth, 17, Ohio; TOLAND, Samuel, 16, Ohio.

ROBERTS: Mary Evaline (1842-1921), wife of Bainbridge H.; daughter of John Wesley & Laura Matilda (Justus) Williams; Mary was born in Brooklyn Twp., Schuyler Co., Ill., Apr 17, 1842; md. Feb 9, 1858, in McDonough Co., to Mr. Roberts; Mary (Williams) Roberts had 3 brothers; Moses Justus Williams, Franklyn Christopher Williams, and Cornelius Williams; Mary died on Jul 20, 1921.

SIMMONS: Miranda (Death notice from The Macomb Journal, Sep 2, 1886): "The daughter of N. E. Simmons of Hancock Co., died Monday."

WELCH: (sp. WELSH) 1850 census NO# 489; James, 37, farmer, Ky.; Mary, 37, Ky.; Margaret E., 17, Ky.; Nancy, 16, Ky.; Harriett, 14, Ky.; Barbara A., 11, Ky.; Mary E., 9, Ky.; John L., 8, Ky.; James H., 5, Ky.; Martha L., 3, Ill.; Susan E., 1, Ill.; Elizabeth, 10, Ky.; Barbara A., 67, Pa.

WHITE: 1850 census # 449; Joshua, 47, farmer, Del.; Lucy, 40, Ohio; Elisa, 16, Ohio; Thomas, 14, Ohio; James, 12, Ohio; Ellen, 9, Ill.; Lavina, 6, Ill.; Gilbreth, 1, Ill.

WOOLLEY: 1850 census NO# 507; Moses H., 25, farmer NY; Elizabeth, 21, Ky.; Emma, 9 mos., Ill.

YOUNG: Thomas P.; d. Nov 2, 1880; age 75y 6m 10d; laborer; widower; b. N. C.; resident of Ill. 25 years; d. at the home of his son, O. A. Young.

(From VA Records)

CREAREY, John; civil; pvt; army; Co I 124th Ill Inf; Feb 25, 1865.

HARRISON, Joseph D. -----; Dec 27, 1864.

HIRE, Geo.; 1812; pvt; army; Goldsberry's Capt Humphills; Jan 7, 1881.

KIOUS, Jacob J.; civil; pvt; army; Co C 137th Ill Inf; d. Jan 7, 1865.
 MARTIN, Henry; civil; pvt; army; 118th Ill Inf; d. Jul 20, 1866.
 RILEY, William; civil; pvt; army; Ohio Inf; 1870.
 SIMMONS, James E.; civil; Musician; army; Co A 64th Ill Inf; 1915.
 SMITH, William L.; civil; pvt; army; Co C 62nd Ill Inf; Dec 27, 1864.
 WHITE, Marian; civil; pvt; army; Ill Inf; Mar 26, 1914.
 YOUNG, T. P.; civil; pvt; army; Co C 84th Ill Inf; Nov 2, 1888.

Notes, Corrections, Additions, and Changes

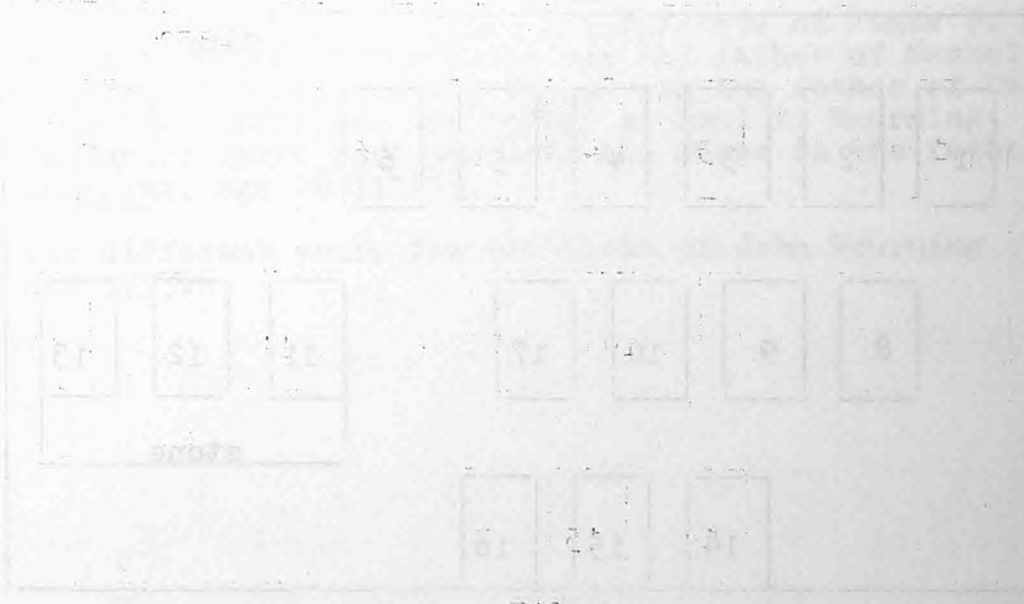

Mourning Cemetery
(A supplement to the Friendship Cemetery)

The "West" section of the Friendship Cemetery is also known as the Mourning Cemetery. These notes on the Mourning Cemetery were made in 1925 by a granddaughter of William and Elizabeth (Lyon) Mourning and supplied by Mr. James Paul Mourning of Rushville, Ill., for use in this volume.

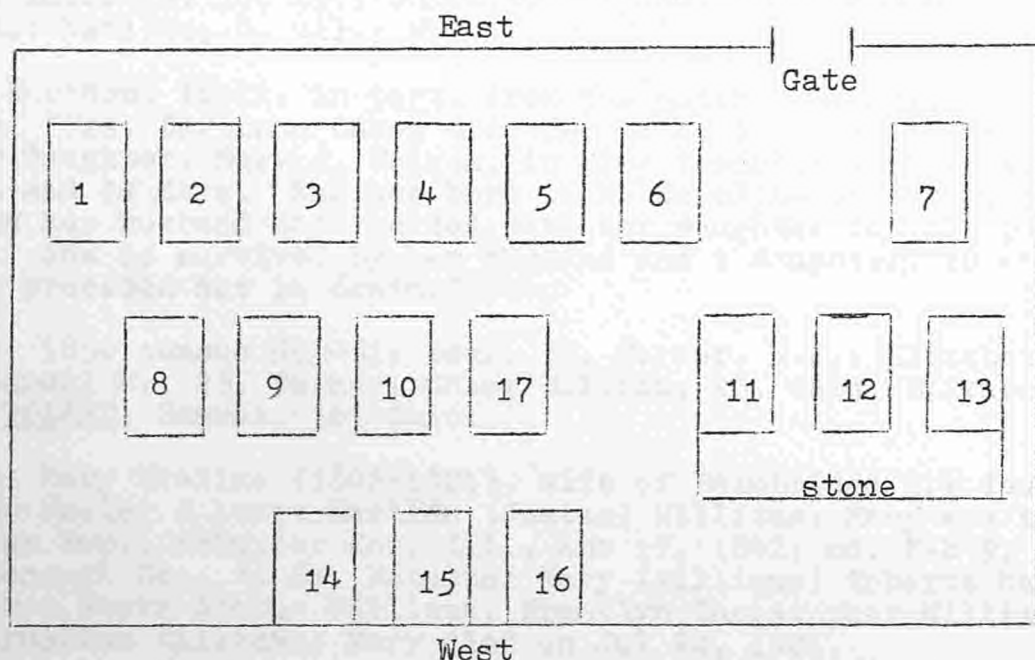

1. - Adaline Enfield Roberts Mourning, 1st wife of John M. Mourning.
(Inscribed on her stone):
"A loving wife, a Mother dear,
A faithful friend, is buried here."
2. - Infant son of John M. and Adaline Mourning; b. & d. 1862.
3. - Clara Isadore Mourning, dau of John M. and Adaline Mourning;
b. & d. 1864.
4. - Rosie Mourning, dau of John M. and Mary Mourning; b. & d. 1871.
(Daughter by John's 2nd marriage.)
5. - James A. Mourning, son of Lewis Ball Mourning; d. 1859; age 3y.
6. - Nancy E. Lyon, dau of Margaret Lyon.
7. - Charles Dickenson; d. 1840. (Not related)
8. - David Franklin Mourning, son of Wm. & E. Mourning.
9. - Mary Elizabeth Mourning, dau of Wm. & E. Mourning.
10. - Hannah Ball Mourning; d. 1838. (Hannah's tombstone made and
engraved by her husband, reads):
"Remember friends as you passby,
As you are now so once was I
As I am now so you will be
Prepare for death and follow me."
11. - Robert C. Mourning, son of Wm. & E. Mourning.
12. - Elizabeth Lyon Mourning, wife of William Mourning.
13. - William Mourning.

14. - Mary Mourning, dau of Geo. and Rebecca Mourning.
15. - Sarah Mourning, dau of Geo. and Rebecca Mourning.
16. - Rebecca Birdsell Mourning, 1st wife of Geo. D. Mourning.
17. - John Mourning; b. 1775. (Husband of Hannah Ball Mourning.)

Genealogical Notes - Mourning Cemetery

There is no stones at NO# 2, 3, 14 or 16.

NO# 10 & 17 are the great great grandparents of James P. Mourning.-----John Mourning (1774*-1846) was the father of Samuel Mourning (GAR buried at Basco, Ill.); Samuel was the father of David (D. L.) Mourning; David was the father of Paul W. Mourning; Paul was the father of James Paul Mourning and James is the father of Paul W. Mourning, age 24 (1979).

*Note: Two different years for the birth of John Mourning, 1774 and 1775.

White Cemetery

Location: Tennessee township; NE $\frac{1}{4}$, Section 9; two miles north,
one mile west of Tennessee.

Remarks: The White Cemetery, as with most rural graveyards, is located on privately-owned property and is an estimated quarter mile from a public road. The grounds are completely fenced and the area is in reasonably good condition, although a few of the older stones are broken, overturned, and/or weather-worn. This cemetery contains the grave of one of the three known Revolutionary War veterans to be buried in this county--Thomas White.

BEAN:

Catherine, wife of John C.; d. Oct 28, 1859; age 24y 10m 13d.

BURFORD:

Dennis L.; Feb 15, 1839 - Jan 26, 1903.

INMAN:

M----, wife of B. H.; d. Oct 4, 1860; age ?18?y --m --d.

Edgar W., son of R. & M.; d. Aug 26, 1859; age 5m 17d.

IRISH:

Alva May, dau of Frank & Lizzie; d. Jun 5, 1885; age 7m 22d.

Mary, wife of B. F.; d. Aug 24, 1873; age 34y 6m.

Harley J., son of B. F. & Mary; d. Feb 10, 1864; age 5d.

LOWDERMAN:

Dollie Z., wife of Jesse A.; 1876 - 1907.

MC CLURE:

Daisy D.; dau of John & Lucy; Jan 28, 1873 - Aug 7, 1898.

Lucy M.; Feb 14, 1853 - Apr 11, 1899.

John P.; Nov 19, 1848 - Dec 27, 1881.

U. F., son of John & Susannah; d. Apr 18, 1887; age 69y 5m 11d.

Rutherford; Sep 26, 1819 - Nov 26, 1894.

Sarah, wife of Rutherford; Jun 7, 1822 - Dec 13, 1901.

Thomas, son of R. & S.; d. Oct 1, 1851; age 1y 11d.

John; d. May 14, 1853; age about 82 years.

Clara B., dau of R. & S.; d. Jul 31, 1863; age 2y 1m 12d.

MC GEE:

Amelia Emeline, wife of Elijah; d. Jul 7, 1847, in the 22nd year of her age.

MOON:

Charles, son of C. & S.; d. Oct 5, 1870; age 1y 6m 15d.

John Ough; Sep 20, 1802 - Feb 1, 1880.

Charlotte D., wife of Wm.; Oct 3, 1825 - Apr 29, 1888.

(A large stone containing the latter 2 names was located outside the perimeter fence on the east side of the cemetery.)

WHITE:

Ina F., dau of S. M. & Mary F.; Oct 20, 1894 - Nov 29, 1906.

WHITE:

Samuel M.; Jul 19, 1850 - (no date).
 Mary F., wife of S. M.; Nov 7, 1860 - (no date).
 Stephen A.; Apr 29, 1821 - Jan 1, 1896.
 Elizabeth McGee, wife of Stephen; Sep 16, 1825 - Aug 12, 1887.
 Marion; d. Sep 4, 1875; age 32y 5m 25d.
 Susan F., wife of S. M.; May 5, 1850 - Aug 2, 1881.
 Newton H.; Feb 25, 1877 - Jan 16, 1879.
 Rolley; Feb 23, 1880 - Jul 26, 1881.
 Claudy; d. Aug 21, 1875; age 4y 11m 19d.
 Stephen A.; d. Aug 11, 1875; age 1y 8m 5d.
 (Latter 4 were children of S. M. & S. F.)
 Susan Elizabeth, wife of John H.; d. Jun 5, 1875; age 37y 10m 7d.
 Barton, son of J. H. & S. E.; d. Jul 8, 1874; age 3m.
 Norval Jefferson, son of J. H. & S. E.; was killed in the Chicago yards by an engine while in the employ of the C.B.&Q. R.R. Co.; d. Nov 24, 1891; age 30y 1m.
 Mary, dau of C. S. & S.; d. Feb 24, 1864; age 7y 6m 18d.
 Arabella, dau of G. B. & S.; d. Jul 16, 1859; age 4y 5m 26d.
 Clara, dau of J. & S.; d. Sep 2, 1858; age 1y 10m 22d.
 James, son of S. A. & E.; d. Dec 27, 1863; age 1y 11m 15d.
 Ann, dau of G. B. & S.; d. Dec 13, 1860; age 3m 22d.
 Sina B., dau of T. & M.; d. Mar 11, 1857; age 19y 11m 13d.
 Mary, wife of Thomas; Oct 24, 1801 - Jul 18, 1880.
 Thomas; d. Dec 23, 1851; age 57y 7m 25d.
 Thomas; d. Dec 7, 1843; age 79y 11m 11d; Pvt 7th Md Regt Rev. War.
 Maria, wife of Joseph; d. Oct 6, 1876?; age 39y 19m 21d.
 Joseph; d. Apr 12, 1860; age 67y 4m 18d.
 Sarah, wife of Thomas; d. Jul 14, 1845; age 76y 16d.

Genealogical Notes - White Cemetery

MC CLURE: Rutherford & Sarah White were married in this county on Nov 9, 1841. 1850 census no# 513--Rutherford, 30, farmer, Ohio; Sarah, 26, Ohio; Martha, 6, Ill.; Susan, 3, Ill.; John, 2, Ill.; Felicia RAY, 14, Ohio.

John P. (Death notice from The Macomb Journal, Sep 29, 1881):
 "John McClure of Tennessee township, died on Tuesday aged 35 years. He was a son of R. F. McClure."

U. F. (Obit, in part, from The Macomb Journal, Apr 21, 1887):
 "Fullerton McClure, an old citizen of Tennessee township, died last week at the residence of Geo. Moon aged 69 years. He was a native of Ohio and came to Ill. in 1846. He was a brother of Rutherford McClure of Tennessee township. He never married."

MC GEE: Elijah McGee married Amelia Ruddel in this county on Feb 5, 1842. Mr. McGee died in 1857; buried at Argyle Cemetery.

WHITE: Stephen A. White (1821-1896) married Elizabeth McGee in this county on Nov 18, 1841. 1850 census no# 642--Stephen A., 29, farmer, Ohio; Elizabeth, 26, Ind.; Maria, 7, Ill.; Henry, 5, Ill.; Joseph, 3, Ill.

WHITE: Elizabeth (Obit, in part, from The Macomb Journal, Aug 25, 1887): "Elizabeth, wife of Stephen A. White, died in Colchester on Aug 12, aged 61 years 11 months and 6 days. She was born Elizabeth McGee in Orange Co., Ind. but moved to Tennessee Twp., this county, when she was 4 years old, where she lived until moving to Colchester 2 years ago. She was married to Stephen A. White on Nov 18, 1841; he survives along with 7 of their 12 children, 8 of whom grew to adulthood. She was buried in the family burying ground on the old homestead in Tennessee township....."

Susan F. (Death notice from The Macomb Journal, Aug 4, 1881): "Mrs. Sam'l White, living between Tennessee and Blandinsville, died on Tuesday. She is survived by a husband and 2 children. Frank White is a brother of Mr. White; both are sons of Stephen White. Mrs. White was formerly Miss Berford."

Thomas White--1850 census no# 550--Thomas, 53, farmer, Del.; Mary, 49, Md.; Thomas, 25, farmer, Ohio; Clement, 21, farmer, Ohio; Permelia, 18, Ohio; John, 17, farmer, Ohio; Catherine, 15, Ohio; Cinia, 13, Ill.; Mary, 11, Ohio; Harrison, 10, Ill.; Maria, 8, Ill.; Milton BOYD, 11, Ill.

Notes, Corrections, Additions, and Changes

Pope Cemetery

Location: Tennessee township; SW $\frac{1}{4}$, Section 6; five miles north-west of Tennessee.

Remarks: This family graveyard is located on privately owned property and is about a quarter mile from a public road. The grounds are unfenced and are situated within an area presently used as pasture land. Livestock have broken many of the stones; others have been overturned and broken by vandals. Stones and portions thereof are scattered over a small area near a south fence line. A few monuments were located on the south side of this fence, which separates two separate farms -- local residents reported that several years ago, when the original farm was divided and became the property of more than a single owner, a fence was erected thru the cemetery.

The graves of at least four persons, not included in the following listing, are located in this cemetery -- however, no stones are to be found at this time. James Dye, his first wife, Barbara, and at least two of their children were buried here during the 1800's. Dye was murdered in May, 1854, at his farm home which was located just north of this graveyard. His second wife, Rebecca, along with a male accomplice were later convicted of murder. Mrs. Dye was sentenced to five years in prison, was later pardoned, returned to this area and died in Macomb in 1874. During the mid-1960's, out-of-State descendents of the Dye family removed the monuments of Mr. and Mrs. Dye from this location. The stones were then taken to a cemetery in Missouri and embedded in concrete on a family lot.

During this grave registration, made in early-1975, the following information was obtained. A number of portions of stones were also noted, however, many were damaged to the point of total unreadability.

GARRISON:

Mattie M., dau of W. H. & P. C.; d. Mar 23, 1873; age 1m 12d.
William H.; Feb 17, 1846 - Apr 13, 1881.

MC GEE:

Rebecca M., wife of James; d. Dec 11, 1861; age 26y 5m 4d.
Elbetta C., wife of James; d. Feb 21, 1865; age 21y 5m 27d.

POPE:

Malissa J., dau of E. & L.; d. 1855; age 9m.
Pilgrim; d. Nov 23, 1858; age 36y 2m 26d.
Jane; d. Jan 9, 18?69?; age ?68?y 10m 11d.
Elijah; d. Dec 14, 1874; age 76y 1m.
Leuartha, dau of I. & J.; d. --.

WILLIAMS:

Milton S.; d. Dec 12, 1854; age 2y 10m 11d.
Matilda A.; d. Feb 11, 1845; age 2y 11m 21d.
(Above 2 were children of M. & P. Williams)

WILLIAMS:

Nancy E.; d. Mar 16, 1859; age --y 3m 17d.
Malissa; d. Oct 23, 18--; age 1y 8m 13d.

NOTE: Footstones, containing the following initials, were also located: "M.E.", "L.P.W.", "C.C.P.", "L.E.P."

A large stone located in Friendship Cemetery, a short ways north-east of the Pope Graveyard, indicates members of a Simmons family were also buried at this site; however, no monuments were located here to indicate this.

Genealogical Notes - Pope Cemetery

DYE: 1850 census no# 477--James, 63, farmer, Pa.; Rebecca, 27, Pa.; Jane, 2, Ill.

No# 478--Peter, 25, farmer, Ohio; Lorna, 24, Ohio; Elizabeth, 2, Iowa; George W., 6 months, Ill.

No# 547--James, 42, farmer, Ohio; Casey, 37, Tenn.; Joshua, 19, farmer, Ohio; James, 18, Ohio; Samuel, 13, Ill.; Ellen, 10, Ill.; Catherine, 8, Ill.; Mary E., 1, Ill.; Harrison, 25, farmer, Ohio.

POPE: 1850 census no# 548-- Sarah, 27, Ind.; Ettesy, 8, Ill.; Barbara, 5, Ill.; Jasper N., 3, Iowa; Margaret A., 2, Iowa.

Notes, Corrections, Additions, and Changes

Catholic Cemetery

Location: Tennessee Township; NW $\frac{1}{4}$, Section 15. One mile northwest of the Village of Tennessee.

Remarks: The Catholic church in Tennessee was originally established in Fountain Green (Hancock County) in about 1839, known then as St. Simon's. In about 1857, St. Mary's church was erected in Tennessee and the original membership numbered about 30, including those individuals from the old Fountain Green congregation. The cemetery, located about a mile northwest of the church building, was established in the 1850's; it's present condition is relatively good, however, loose fencing has allowed various animals to roam the grounds and a number of stones have been broken as a result. The cemetery grounds to be regularly maintained and most stones are in good condition. The unimproved road leading to this cemetery is not considered to be passable after moderate rains or snow.

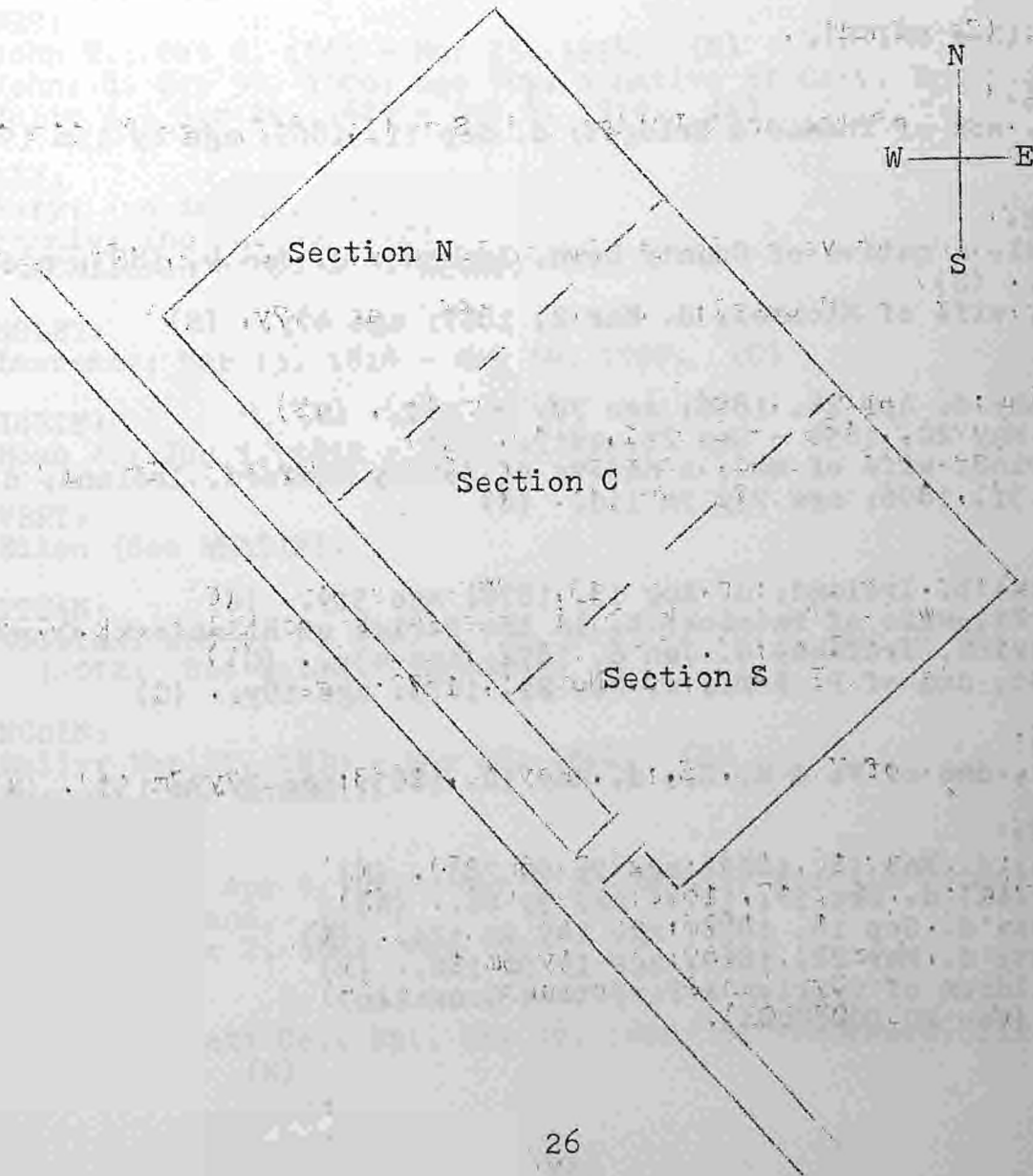

BOOZ:

M. Dale, son of J. L. & C. P.; d. Aug 8, 1896; age 4m 3d. (N)

BOWMAN:

Rowena Lincoln, wife of C. Newton Bowman; 1826 - 1919. (S)

Charles Newton; 1818 - 1904. (S)

Emily N., dau of C. N. & M. R.; d. Dec 20, 1870; age 2y 5m 3d. (S)

Charles N., son of C. N. & M. R.; d. Jan 24, 1870; age 23d. (S)

Rosa M., dau of C. N. & M. R.; d. Feb 17, 1867; age 1m 1d. (S)

Robert L., son of C. N. & M. R.; born May 7, 1864; d. age 18y 2m 25d. (S)

BUSSELMIER:

George; b. in Baden, Germany Apr 12, 1792; d. in Colchester, Ill., Aug 10, 1869. (N)

CAMBRON:

Maud; 1878 - 1898. (N)

Thomas R.; b. Grayson Co., Ky.; d. May 21, 1871; age 71y 6m 11d. (N)

Mary; (See SMITH).

CAMPBELL:

David, son of Thomas & Bridget; d. Sep 11, 1869; age 8y 11m 19d. (S)

COSGROVE:

Michael, a native of County Down, Ireland; d. Jan 4, 1883; age 74y. (S)

-----, wife of Michael; d. Mar 2, 1867; age 47y. (S)

DORAN:

William; d. Apr 24, 1886; age 78y 3m 16d. (S)

Mary; May 20, 1854 - Dec 21, 1919. (C)

Catharine, wife of Wm.; a native of County Wexford, Ireland; d. Jan 31, 1896; age 75y 7m 11d. (C)

ERWIN:

Patrick; b. Ireland; d. Aug 13, 1878; age 51y. (C)

Margaret, wife of Patrick; b. in the Parish of Kilmalock, County Limerick, Ireland; d. Jun 6, 1872; age 43y. (C)

Bridget, dau of P. & M.; d. Nov 21, 1873; age 19y. (C)

GOOCHEY:

Ida M., dau of V. & M. E.; d. May 10, 1883; age 7y 7m 15d. (N)

GOSSELIN:

Salina; d. Mar 18, 1865; age 7y 6m 28d. (N)

Frederick; d. Sep 17, 1878; age 3y 6d. (N)

Charles; d. Sep 16, 1878; age 14y 9m 12d. (N)

Baptist; d. Mar 22, 1869; age 1y 5m 18d. (N)

(Children of Cyprien & Perpetuos Gosselin)

Mary; (See MC DONOUGH).

GRAMMONT:

Maggie, dau of J. & R.; d. Dec 8, 1881; age 7y 1m 8d. (N)
Rosalee, wife of John; d. Nov 30, 1884; age 54y 8m 4d. (N)

HARDEY:

William M.; 1831 - 1907. (C)
Maria Tallis, wife of Wm.; 1849 - 1903. (C)
Joseph I.; 1875 - 1949. (C)
Blanche K.; 1878 - 1950. (C)

HEIKES:

Emma J.; 1873 - 1950. (C)
Martin E.; 1878 - 1943. (C)
Charles M.; Jul 24, 1904 - Aug 28, 1904. (C)

HIIGEN:

Phillipp; Mar 1, 1819 - Aug 27, 1895. (N)
Margaret, wife of P.; Feb 2, 1822 - May 19, 1895. (N)

JONES:

John T.; Oct 8, 1865 - Mar 25, 1914. (N)
John; d. Sep 30, 1906; age 70y; a native of Cork, Ireland. (N)
Julia A.; Apr 24, 1829 - Oct 2, 1910. (N)

KELLY:

Mary; (no dates). (C)
Fannie; (no dates). (C)
(Children of J. & C. KELLY)

KINSLEY:

Lawrence; Mar 15, 1814 - Aug 14, 1907. (C)

KNIGELY:

Rosa A.; Jun 1, 1812 - Sep 15, 1850. (C)

LAVERY:

Ellen (See WHALIN).

LETTMAN:

William, son of P. & A. E.; d. Nov 24, 1873; age 7m 8d. (S)
(NOTE: See Below, ----mann).

LINCOLN:

Emily; Mar 21, 1830 - May 20, 1902. (S)
Rowena; (See BOWMAN).

MALONE:

Michael; d. Apr 9, 1874; age 25y 10m 22d; born in County Tipperary, Ireland. (S)
John; d. Mar 2, 1884; age 76y.

MC DONOUGH:

John; b. Scott Co., Ky., Nov 20, 1828; d. Tennessee, Ill., July 19, 1894. (N)

MC DONOUGH:

Mary Gosselein, wife; (no dates). (N)
Mary Mourning; Jun 22, 1850 - Mar 20, 1874. (N)
John; 1874 - 1938. (N)

MC HUGH:

Neil, native of County Donegal, Ireland; d. Feb 25, 1880; age 60y. (N)

MC KONE:

Margaret F.; 1871 - 1950. (C)
Sarah E.; 1881 - 1912. (C)
Elizabeth; Aug 24, 1896 - Apr 23, 1911. (C)
Patrick; 1833 - 1906. (C)
Elizabeth, wife of Patrick; 1839 - 1882. (C)
Patrick; 1870 - 1895. (S)
Thomas; 1868 - 1934. (S)
Ann Tracy; 1840 - 1914. (S)
Timothy; 1840 - 1873. (S)

MORTON:

William W., son of Ellen; d. Aug 16, 1875; age 21y 4m 26d. (N)

MOSSEY:

Andrew; Nov 25, 1818 - Jan 2, 1914. (S)
Hannah, wife of A.; d. Feb 21, 1873; age 50y. (S)

MOURNING:

Mary; (See MC DONOUGH).

NESTER:

Mary, dau of T. & S.; d. Apr 20, 1891; age 22y 5m 17d. (C)
Catharine, dau of T. & Sarah; May 12, 1869 - Mar 12, 1884. (C)
John; 1862 - 1925. (C)
William; 1877 - 1942. (C)

O'NEIL:

Mary; b. Nov 21, 1800; d. 1850. (N)

PULLIAM:

Elizabeth, wife of S. D.; d. Mar 17, 1870; age 51y 4m 5d. (N)
William H., son of S. D. & E.; d. Sep 28, 1861; age 18y 9m 26d. (N)
Martha L., dau of S. D. & E.; d. Sep 12, 1873; age 16y 5m 26d. (N)
Susan E., dau of S. D. & E.; d. Dec 9, 1880; age 39y 8m 5d. (N)
Samuel D.; d. Aug 17, 1885; age 69y 7m 29d. (N)

RILEY:

Ellen L., dau of J. & M.; d. Jun 10, 1871; age 39y. (N)
Raphael J.; d. Jan 29, 1869; age 69y. (N)
Margaret, wife of R. J.; d. Sep 12, 1870; age 62y. (N)
Elizabeth Wybrant; d. May 26, 1908; age 62y. (C)

RUTLEDGE:

Thomas; d. Jun 27, 1884; age 78y 10d. (N)

SAMMONS:

Catharine, wife of John; d. Oct 4, 1867; age 34y 10m. (S)

SCHEIFLEY:

Eliza; 1862 - 1943. (S)

George; 1867 - 1943. (S)

SENNETT:

John; d. Jul 14, 1896; age 60y; a native of County Wexford, Ireland. (N)

Anna, wife of John; (no dates); age 75y. (N)

SMITH:

Mary Cambron; 1873 - 1900. (N)

John; Nov 15, 1863 - Apr 10, 1912. (N)

Mary; Sep 23, 1857 - Aug 24, 1943. (N)

(John & Mary, son & dau of John & Catherine Smith)

Cathrine, wife of John; d. Jul 25, 1898; age 64y. (N)

John; d. Jul 7, 1897; age 67y. (N)

Emma, dau of J. & C.; d. Jan 21, 1897; age 25y 4m 4d. (N)

Nellie; (See VALENTINE).

TALLIS:

Joseph H.; Feb 13, 1858 - Oct 21, 1900. (N)

William; native of County Kilkenny, Ireland; Oct 12, 1819 - Nov 17, 1890. (C)

Catharine, wife of Wm.; Mar 8, 1825 - Oct 22, 1898. (C)

Maria; (See HARDEY).

TRACY:

Ann; (See MC KONE).

VALENTINE:

Nellie Smith; dau of J. & C. Smith; 1870 - 1910. (N)

WHALIN:

Annie; 1875 - 1964. (N)

Pete; 1877 - ----. (N)

Ellen Lavery; 1842 - 1924. (N)

Fergus; 1824 - 1916. (N)

Nappie; b. County Galway, Ireland Mar 14, 1838; d. May 28, 1886. (N)

WYBRANT:

Mary A., wife of Andrew W.; Oct 15, 1820 - Jul 13, 1887. (C)

Margaret J.; 1847 - 1923. (C)

Elizabeth; (See RILEY).

YAGER:

Teresa E., dau of N. & M. F.; d. Oct 24, 1874; age 7y 9d. (N)

Elizabeth M., wife of C. J.; d. Sep 9, 1873; age 25y 13d. (N)

YAGER:

Chiles M., son of J. & S., J.; d. Dec 10, 1874; age 1y 4m 20d. (N)

ZIMMERMAN:

John; d. Dec 6, 1874; age 64y 8m 12d. (C)

Christina, wife of John; d. Jan 18, 1888; age 78y 1m 2d. (C)

----mann:

Pet----; d. Jan 29, 1876; age 37y 5m 15d. (S)

(Stone broken & part missing; possibility Peter Lettmann.)

Genealogical Notes - Catholic Cemetery

DORAN: William; (Death notice, in part, from The Macomb Journal, Apr 29, 1886): "Mr. Doran, an aged citizen of Tennessee, died last Saturday. He is survived by a wife and several children. He was born in Ireland in Jan., 1808 and had been a resident of Tennessee since 1865."

NESTER: Catharine (Death notice from The Macomb Journal, Mar 20, 1884): "Miss Kate Nester died March 12th. She was the first of a large family to die."

PULLIAM: Samuel D.; (Death notice, in part, from The Macomb Journal, Aug 27, 1885): "Sam'l Pulliam died at his home in Hire township last Monday aged about 70 years. He was born in Ky. and settled on Ceder Creek in Hire township 40 years age."

1850 census no#466--Samuel, 34, farmer, Ky.; Elizabeth, 33, Ky.; Nancy H., 12, Ky.; Susan G., 9, Ky.; William H., 7, Ky.; John L., 5, Ky.; Elizabeth, 2, Ky.

RUTLEDGE: Thomas; (Death notice from The Macomb Journal, Jul 3, 1884): "Thomas Rutledge of Tennessee township died in the northern part of Tennessee township on Jun 27th. He is survived by a wife and three children. He has been a long resident of this place."

WYBRANT: 1850 census no#602--Andrew, 30, farmer, Ireland; Mary, 30, Ireland; Susan, 8, Ireland; Elizabeth, 6, Ill.; Martha, 4, Ill.; Mary E., 7, Ill.; Andrew, 60, Ireland.

Notes, Corrections, Additions, and Changes

Central Cemetery

Location: Hire Township; SE $\frac{1}{4}$, Section 19; 4 miles south-southwest of Blandinsville.

Remarks: This cemetery is located adjacent to a public road. The grounds are well fenced and the area is regularly maintained.

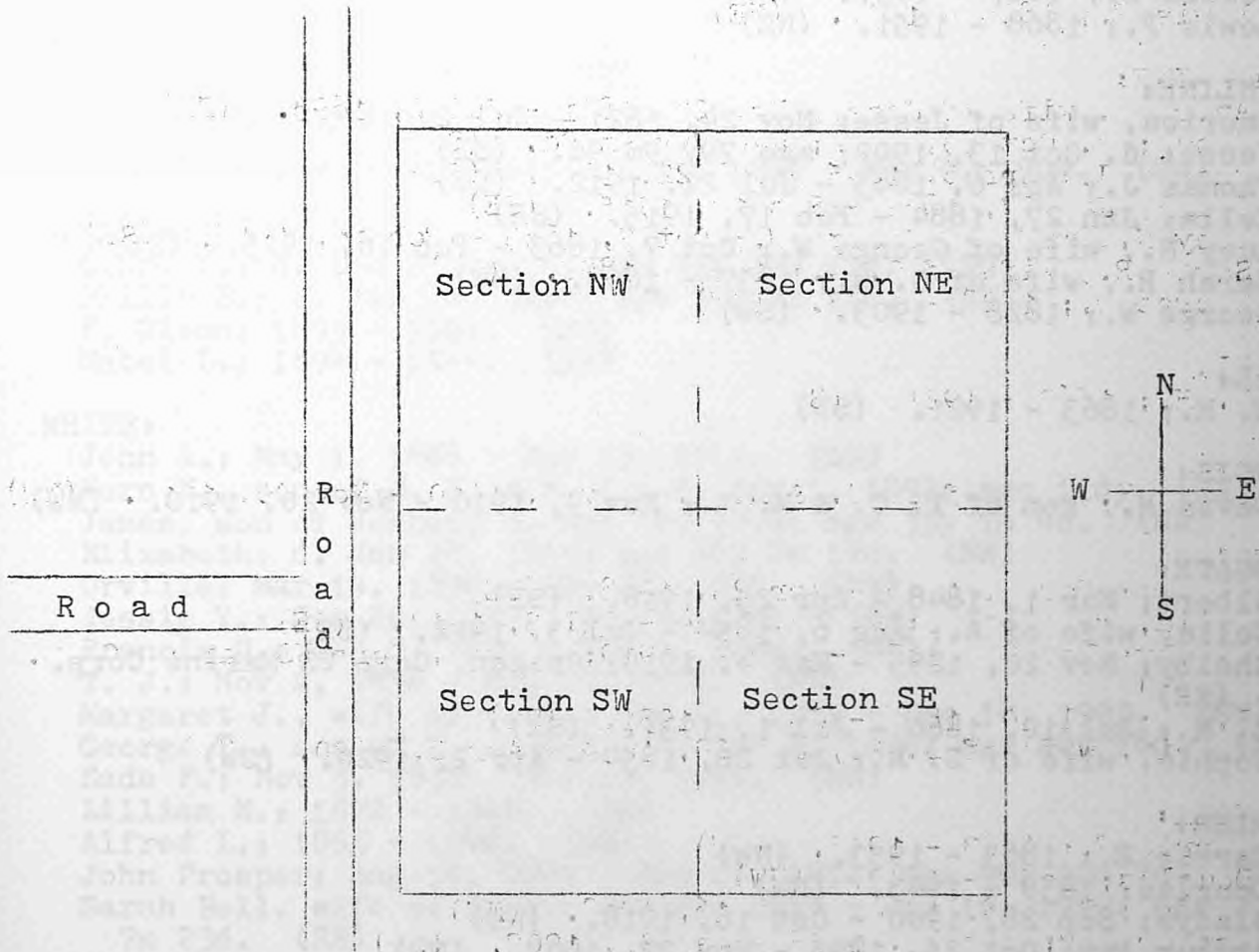

BROWN:

Eathel N., son of S. & A.; d. May 10, 1899; age 4y 1m 29d. (NE)

CAIN:

John; Jul 22, 1817 - Oct 11, 1897. (SE)
Rebecca; Jan 31, 1822 - Jan 28, 1900. (SE)

DILL:

Reuben; Mar 23, 1863 - Mar 12, 1895. (SE)
America; Mar 3, 1867 - Jul 29, 1895. (SE)
Beulah; Dec 1, 1891 - Dec 25, 1895. (SE)
Reuben S. Jr.; Feb 22, 1894 - Jun 7, 1895. (SE)
Garnet; Jun 5, 1887 - Apr 7, 1891. (SE)

DOROTHY:

Nathan S.; Feb 2, 1882 - Jul 26, 1894. (NE)

Harry A., son of P. H. & E. R.; Apr 7, 1889 - Sep 10, 1890. (NW)

GEORGE:

Philip Earl; Dec 8, 1898 - Mar 26, 1966. (NW)

Henry; Jun 24, 1825 - Mar 14, 1899. (NW)

Martha J., wife of Henry; Jun 22, 1821 - Feb 26, 1904. (NW)

Nellie B.; 1867 - 1937. (NW)

Lewis F.; 1868 - 1951. (NE)

HAINLINE:

America, wife of Jesse; Nov 24, 1821 - Jul 2, 1893. (SE)

Jesse; d. Oct 13, 1902; age 79y 9m 9d. (SE)

Thomas J.; Apr 6, 1845 - Jul 22, 1912. (SE)

Zella; Jan 27, 1884 - Feb 17, 1915. (SE)

Lucy N., wife of George W.; Oct 7, 1863 - Feb 16, 1915. (SE)

Sarah R., wife of G. W.; 1837 - 1898. (SW)

George W.; 1828 - 1903. (SW)

HALL:

W. H.; 1863 - 1921. (SW)

HARGIS:

Davis H., son of T. C. & M. M.; Nov 9, 1910 - Nov 20, 1910. (NW)

HUNGATE:

Albert; Mar 1, 1848 - Apr 25, 1918. (SE)

Celia, wife of A.; Aug 6, 1854 - Jul 3, 1912. (SE)

Shelby; Nov 20, 1895 - Mar 4, 1919; Oregon, Corp US Marine Corp.
(SE)

S. M.; Jul 10, 1866 - Jul 1, 1931. (SW)

Sophia, wife of S. M.; Jul 20, 1854 - Apr 2, 1920. (SW)

KIMLER:

Carrie E.; 1863 - 1953. (NW)

Douglas; 1859 - 1943. (NW)

Gladys; Sep 28, 1900 - Oct 16, 1918. (NW)

Arthur Ray; Oct 25, 1895 - May 27, 1907. (NW)

LEFLER:

Walter; d. Feb 17, 1965; age 57y 1m 25d. (NE)

Phronia; 1869 - 1945. (NE)

Marritt; 1849 - 1939. (NE)

Infant dau of M. & P.; b. & d. Jul 17, 1905. (NE)

Johnnie; 1901 - 1924. (NE)

MANN:

Samuel H.; 1871 - 1955. (NW)

M. Pearl, wife of Sam'l; 1878 - 19--. (NW)

MECUM:

John A.; 1861 - 1913. (NW)

Marietta, wife of John; 1859 - 1935. (NW)

OAKMAN:

Edwin B.; 1880 - 1895. (NW)

PARKER:

Martha D. Pope, wife of John H.; Sep 29, 1833 - May 3, 1903. (SW)
John H.; Sep 18, 1834 - (no date). (SW)

POPE:

Martha D.; (See PARKER).

REED:

Sidney W.; 1892 - 1929. (SE)

ROBINSON:

Lura Pearl, wife of Fred; Jul 29, 1881 - May 8, 1904. (SW)

SPARROW:

Clara V.; d. Dec 25, 1912; age 45y 10m 21d. (SW)
Philip E.; d. Jan 24, 1896; age 33y 7m 12d. (SW)
F. Glenn; 1895 - 1961. (SW)
Mabel L.; 1894 - 19--. (SW)

WHITE:

John A.; May 1, 1864 - Mar 19, 1911. (SW)
Vern H., son of M. L. & M. A.; d. Nov 1, 1892; age 11d. (NW)
James, son of Joshua; d. Apr 17, 1894; age 55y 1m 4d. (NW)
Elizabeth; d. Jan 28, 1925; age 86y 7m 17d. (NW)
Orville; Mar 14, 1890 - Mar 22, 1891. (NW)
Jessie V.; Sep 28, 1877 - Oct 9, 1890. (NW)
Francis G.; Dec 7, 1856 - Sep 6, 1890. (NW)
T. J.; Nov 2, 1836 - May 20, 1908. (NW)
Margaret J., wife of T. J.; Jan 11, 1839 - Dec 18, 1903. (NW)
George T., son of T. J. & M.; d. Apr 7, 1894; age 28y 18d. (NW)
Sada F.; Nov 5, 1858 - Dec 17, 1941. (NW)
Lillian M.; 1872 - 1948. (SE)
Alfred L.; 1865 - 1946. (SE)
John Prosper; Aug 10, 1871 - Jun 17, 1912; age 40y 10m 7d. (SE)
Sarah Bell, wife of J. P.; Nov 24, 1873 - Jul 16, 1947; age 73y
7m 23d. (SE)

Genealogical Notes - Central Cemetery

HUNGATE: 1850 census no#288--William, 27, farmer, Ky.; Ellen, 27,
Va.; Calvin H., 5, Ill.; Nancy E., 4, Ill.; Albert, 2, Ill.;
Elvira, 10 mos., Ill.

WHITE: 1850 census no# 449--Joshua, 47, farmer, Del.; Lucy, 40,
Ohio; Elisa, 16, Ohio; Thomas, 14, Ohio; James, 12, Ohio; Ellen,
9, Ill.; Lavina, 6, Ill.; Gilbreth, 1, Ill.

Notes, Corrections, Additions, and Changes