



"Crossroads of  
West-central  
Illinois"

**McDONOUGH COUNTY  
HISTORICAL AND GENEALOGICAL  
MISCELLANY  
1826 - 1976**

RURAL CEMETERIES  
OF  
McDONOUGH COUNTY, ILLINOIS  
VOLUME III  
BETHEL & LAMOINE TOWNSHIPS

**McDONOUGH COUNTY, ILLINOIS**

REF. 977.342 L567 V. 3  
Lester, Duane.  
Rural cemeteries of  
McDonough County, Illinois

MID-CONTINENT PUBLIC LIBRARY  
Midwest Genealogy Center  
3440 S. Lee's Summit Rd.  
Independence, MO 64055 **MGC**

RURAL  
CEMETERIES  
of  
MC DONOUGH COUNTY, ILLINOIS

Table of Contents

Preface . . . . .	1 - 11
Map and Index . . . . .	12 - 111
West Cemetery . Bethel-Lamoine . . . . .	1 - 31
Bankard Cemetery . . . . .	32 - 37
Old Plymouth Cemetery . . . . .	38 - 40
Friend Grave . . . . .	41 - 42

By Duane Lester  
Good Hope, Illinois

Printed by  
Schuyler - Brown  
Historical and Genealogical Society  
and  
The Schuyler Jail Museum

MID-CONTINENT PUBLIC LIBRARY  
Midwest Genealogy Center  
3440 S. Lee's Summit Rd.  
Independence, MO 64055

**MGC**

MID-CONTINENT PUBLIC LIBRARY



3 0000 13101753 9

THE HISTORY OF  
THE STATE OF ILLINOIS

By Duane Lester  
Good Hope, Illinois

Printed by  
Schuyler - Brown  
Historical and Genealogical Society  
and  
The Schuyler Jail Museum

Volume III

Table of Contents

Preface . . . . .	i - ii
Maps and plats . . . . .	iii - viii
Scott Cemetery . . . . .	1 - 31
Dunkard Cemetery . . . . .	32 - 37
Old Plymouth Cemetery . . . . .	38 - 40
Friend Grave . . . . .	41 - 42

Faint, illegible text at the top of the page, possibly bleed-through from the reverse side.

"A monument is erected,  
not because a person died,  
but because a person lived."

Faint, illegible text at the bottom of the page, possibly bleed-through from the reverse side.

## Preface

Within the boundaries of McDonough County, Illinois are more than a hundred cemeteries and gravesites ranging in size from a single burial site to the expansive Oakwood Cemetery at Macomb. Within these cemeteries are the remains of an estimated 40,000 individuals who have died since the first settler arrived here over 150 years ago. Graves of countless others are scattered over the countryside of McDonough County; but, exact sites of many of these resting places are no longer known for various reasons. During the early days of this county, there were obviously no central burial grounds; thus, a pioneer family having the misfortune of losing one of its members placed the deceased in a grave on a family homestead and erected a makeshift marker. A number of these family burial grounds later became public cemeteries, however, many of the grave sites soon became "lost". Crude wooden markers or a hand engraved stone soon succumbed to the elements and were never replaced; scores of families moved further west after staying in this area only a short time and the gravesites of their loved ones shortly became insignificant mounds of earth; a number of families passing through this vicinity suffered individual losses. A prime example of the latter is contained in a history of Bethel Township. In 1830, four children of an emigrant family died while enroute through McDonough County. They were buried near their places of death which occurred about two miles southwest of Fandon. All traces of those graves have long been gone. During the summer of 1834, a widow lady died at her home in northern Tennessee Township. Her coffin of dressed walnut lumber was built by a local cabinet maker and she was buried in the timber near her home. Within a few years, no evidence remained to indicate the presence of her final resting place. A family who created an excellent farm from the prairies a few miles north of Macomb, maintained a fenced family burial site for several years. This cemetery contained the graves of about 12 former family members. During the early 1900's, the farm changed ownership. Shortly thereafter, the new owner removed all the stones, took down the fence, and this graveyard became part of a cornfield. These are only three of the countless incidents involving the total disappearance of burial sites. At this time, it is impossible to determine the locations of hundreds of individual's graves in this county.

Vandalism is responsible for the destruction of many grave stones. Countless markers have been partially or totally destroyed. Inscriptions have been obliterated by shotgun blasts, stones have been broken into dozens of pieces, and some markers have been entirely removed from their original locations.

While weather-wear and vandalism accounts for most of the destruction of individual tombstones, neglect is directly responsible for the eventual deterioration of graveyards. Several local cemeteries have had no protective fencing for a number of years and the grounds have become grazing land for livestock. Groundhogs and other burrowing animals have undermined large portions of various cemeteries. Some areas are nearly invisible because of massive growths of weeds and brush. Stones have fallen, broken, and become completely covered with soil and debris.

The overall conditions of our county cemeteries is a pathetic case. While some grounds are well maintained, or at least partially kept-up by various families, many have been totally forgotten. This situation is appalling and should never have come about. Apparently, lack of time, expense, and most of all regard has brought about the present-day poor conditions of many of our rural cemeteries.

Genealogical notes accompanying the various cemetery listings were prepared from a wide variety of sources including: Local area history books and atlases; newspaper files; county, state, and federal archives; family histories. These notes were collected at random from readily available sources and little, or no attempts were made to search for material for more complete genealogies. These notes are presented only for the purposes of identification and/or clarification.

Every attempt has been made to present complete and accurate information. Readers will find errors and omissions. Others will not agree with portions of my findings; however, no information contained herein is based solely on assumption or guesswork. It must be remembered that this information has been prepared for use only as a tool for further research and that nothing must be taken as final and absolute.

The larger cemeteries contained in these volumes are accompanied by grave location charts. These charts in no way are intended to represent any professionally prepared plat or survey that may exist. Their preparation and presentation are solely for general location purposes.

When copying inscriptions from grave markers, it is sometimes impossible to read some portions of the engraving. Names, dates, ages, etc. that were found to be unclear or totally missing are indicated by the use of question marks or dashes, i.e., SPICER, James T., infant son of ?J.B. & S.J.??; d. -----; age -----. The letters or numbers enclosed in parenthesis following the inscription, indicate general location as indicated on the accompanying chart.

Abbreviations used are as follows:

b.	born	m.	months
Cav.	Cavalry	md.	married
Co.	County/Company	sec.	section
d.	died/days	twp.	township
dau.	daughter	y.	years
Inf.	Infantry		

Time and space prohibits proper recognition for all those individuals who gave assistance in preparing and publishing these volumes. Deep and sincere appreciation is extended to all concerned, especially to the following: My parents, Mr. and Mrs. Lloyd Lester, and my wife, Rose; and to Mrs. Lavina Walton and other members of the Schuyler County Historical and Genealogical Society for printing and binding the finished product. Thank you.

Duane Lester





Mac Donough County, Illinois

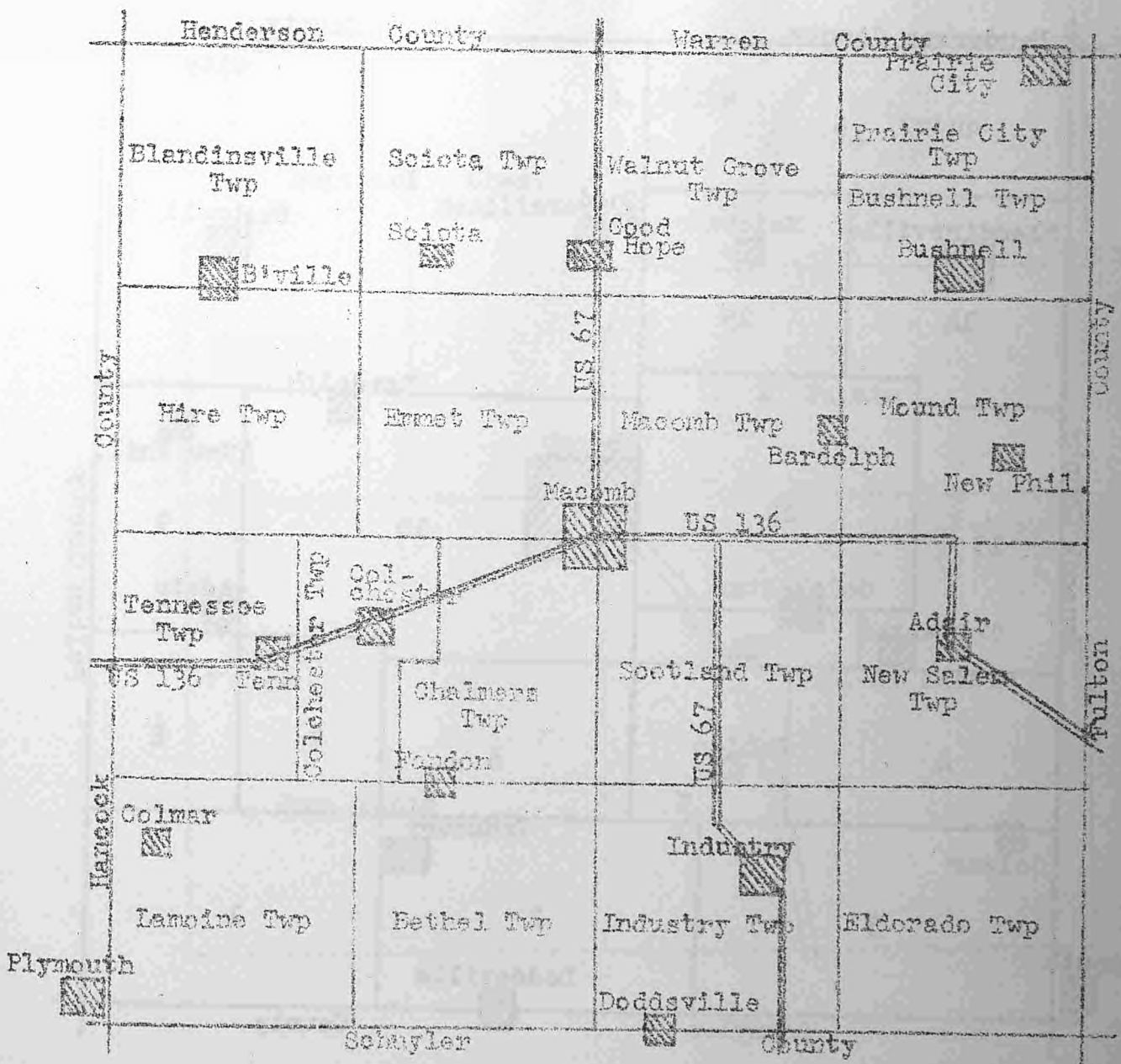

Areas covered by volumes I - XVII  
 "Cemeteries of McDonough County, Illinois"

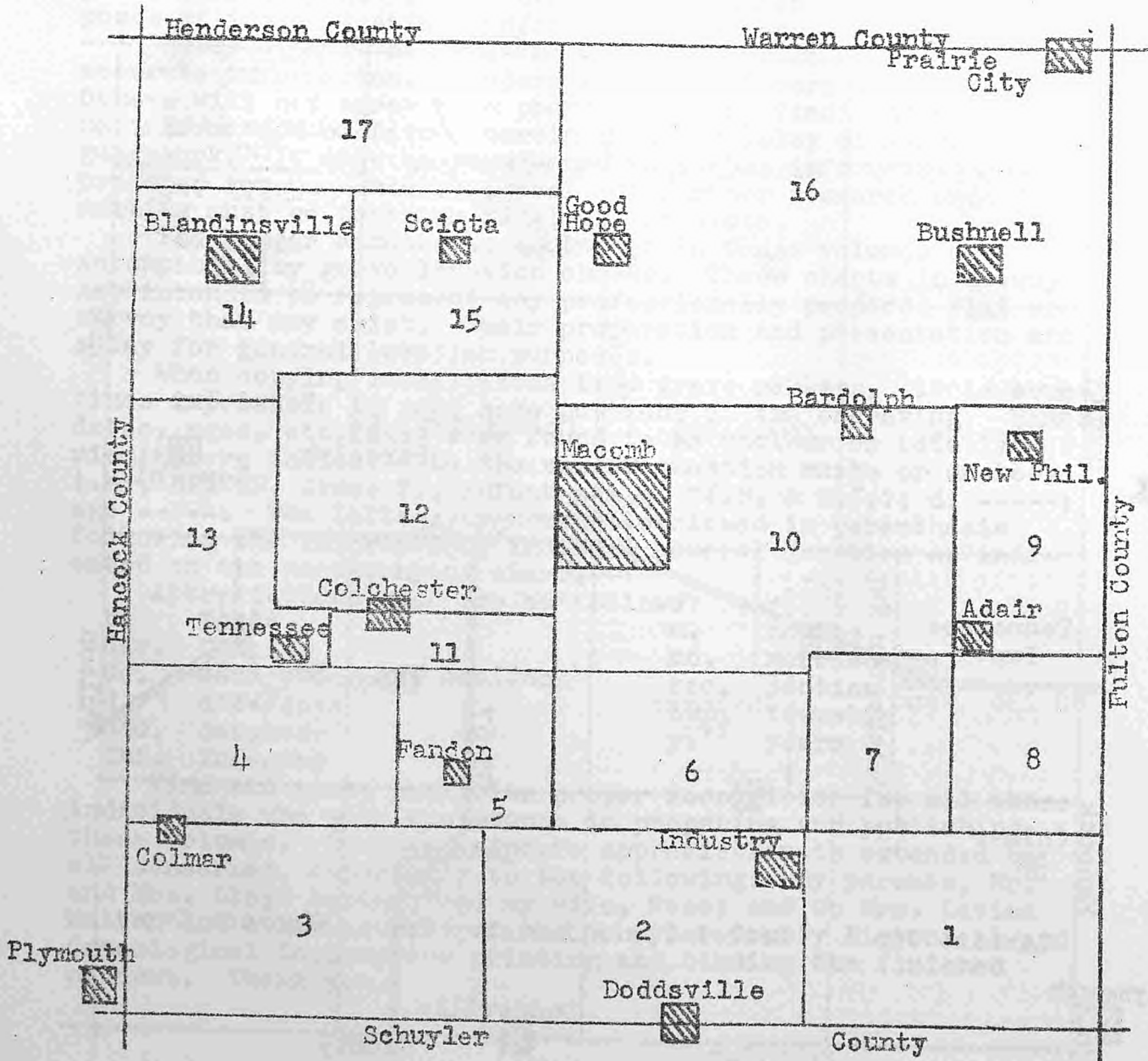

Section 30

Bethel Township, T4N R3W; 1871

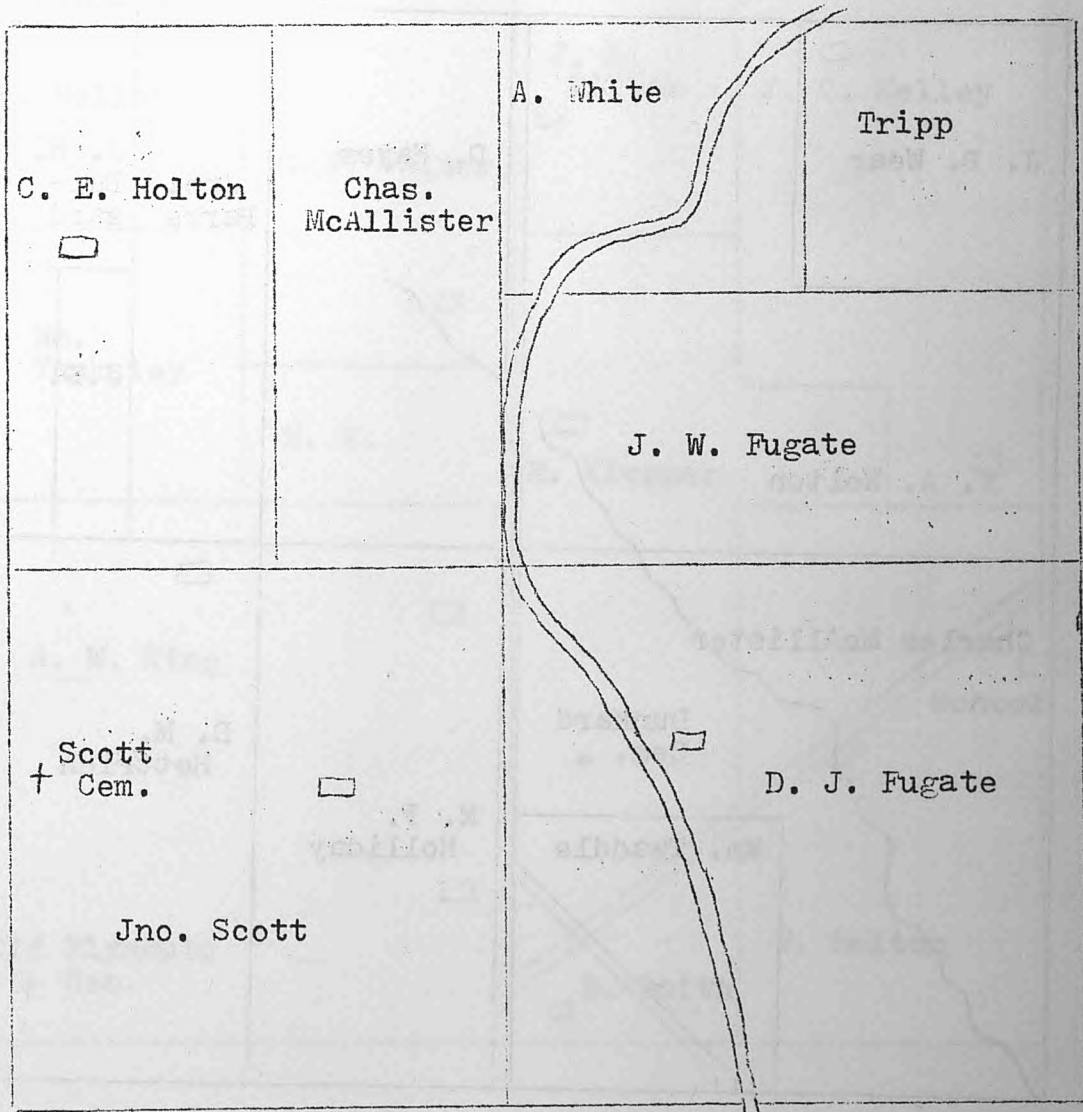

Section 18

Bethel Township, T4N R3W; 1871

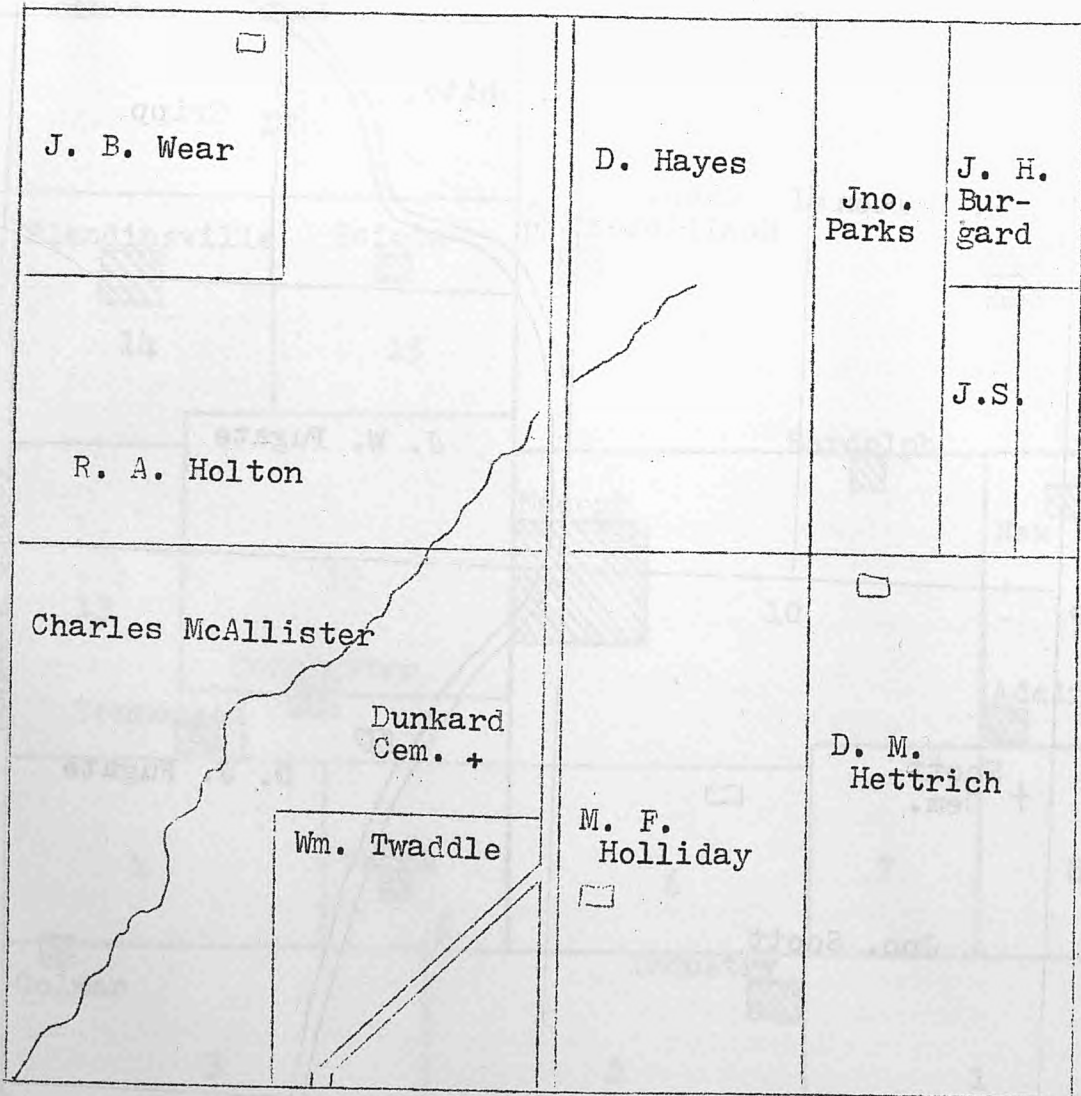

Section 30

Lamoine Township, T4N R4W; 1871

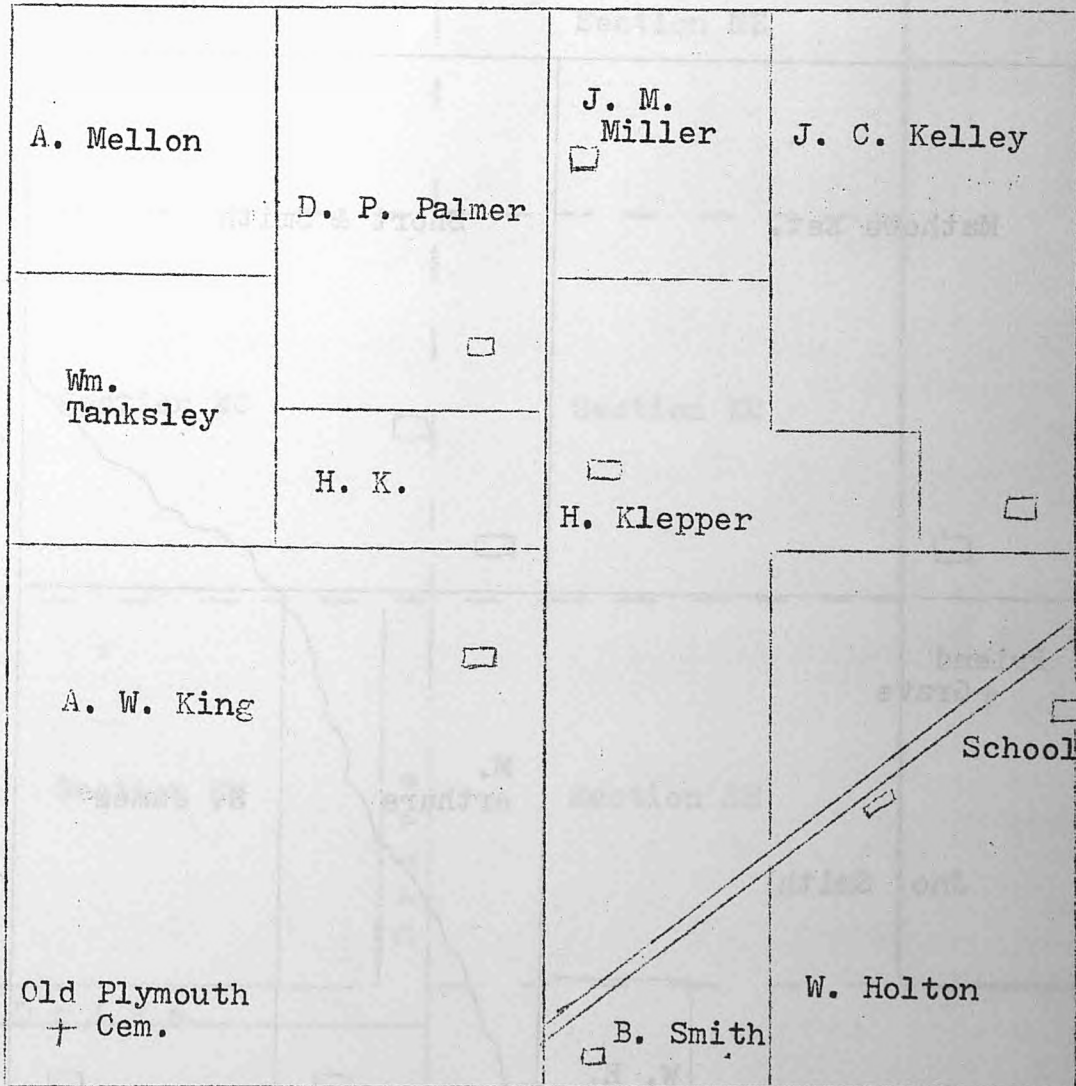

Section 20

Lamoine Township, T4N R4W; 1871

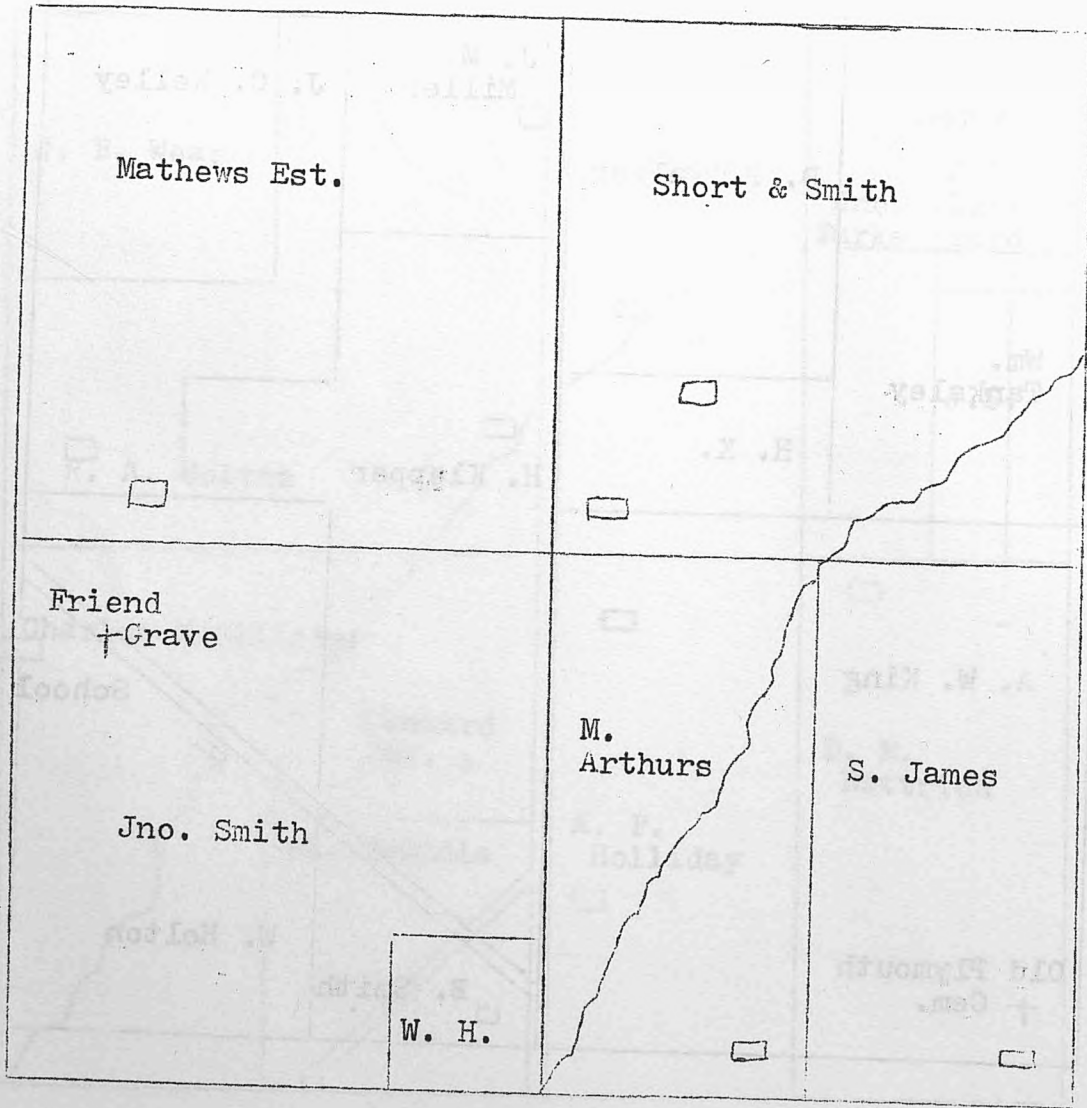

SCOTT CEMETERY  
Bethel Township  
SW $\frac{1}{4}$ , Section 30

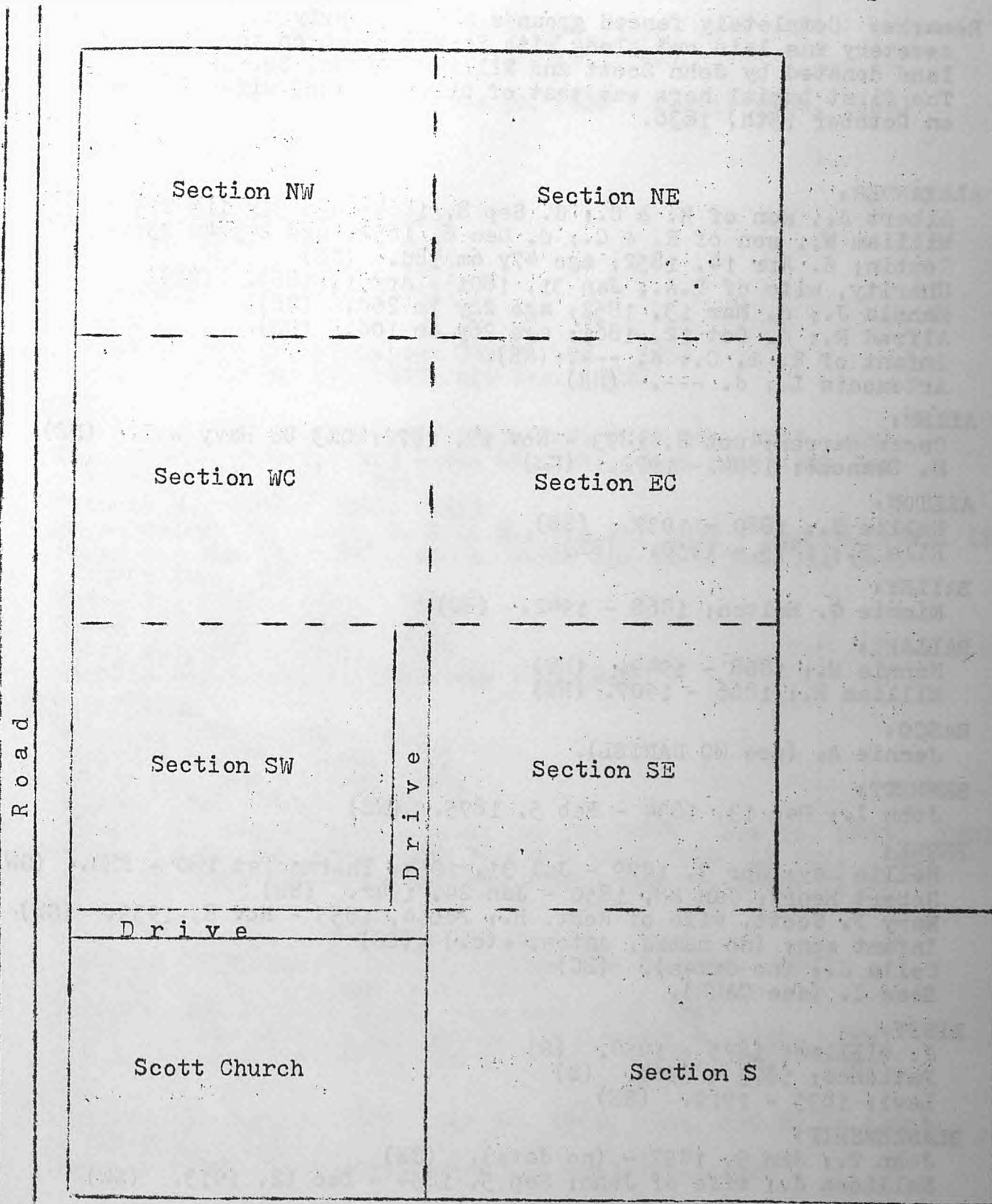

Scott Cemetery

Location: Bethel Township, SW $\frac{1}{4}$  Section 30; 2 miles west, 5 miles south of Fandon.

Remarks: Completely fenced grounds and regularly maintained. This cemetery was laid out along with Scott Church on three acres of land donated by John Scott and William Holton, Sr. in the 1830's. The first burial here was that of Olive Holton, wife of Wm. Holton, on October 15th, 1836.

ALEXANDER:

Albert A., son of R. & C.; d. Sep 8, 1864; age 31y 11m 21d. (NE)  
William W., son of R. & C.; d. Dec 6, 1852; age 24y 4m 23d. (NE)  
Reubin; d. Apr 14, 1852; age 47y 6m 18d. (NE)  
Charity, wife of R.A.; Jan 31, 1801 - Apr 1, 1863. (NE)  
Mahala J.; d. Mar 13, 1852; age 22y 7m 26d. (NE)  
Alfred M.; d. Oct 12, 1861; age 26y 4m 10d. (NE)  
Infant of R. & C.; d. ---. (NE)  
Artemecia L.; d. ---. (NE)

ALLEN:

Oscar Warren; Oct 8, 1893 - Nov 19, 1972; QM3 US Navy WWI. (NE)  
M. Blanche; 1894 - 1972. (NE)

ALLTON:

Nellie T.; 1880 - 1937. (SE)  
Rile S.; 1875 - 1950. (SE)

BAILEY:

Minnie G. Holton; 1868 - 1942. (EC)

BALLARD:

Nannie E.; 1868 - 1949. (NW)  
William H.; 1866 - 1907. (NW)

BASCO:

Jennie A. (see MC DANIEL).

BENNETT:

John L.; Dec 13, 1834 - Feb 5, 1895. (NE)

BERRY:

Nellie May; Apr 3, 1879 - Jul 31, 1954; Pharmacist PHG - PHD. (SW)  
Robert Henry; Jan 28, 1850 - Jan 24, 1942. (SW)  
Mary F. Scott, wife of Robt. H.; Feb 4, 1855 - Nov 8, 1939. (SW)  
Infant son; (no names, dates, etc.) (EC)  
Della M.; (no dates). (EC)  
Bess I. (see CARR).

BISBY:

J. William; 1875 - 1958. (S)  
Patience; 1875 - 1964. (S)  
Levi; 1835 - 1919. (SE)

BLANKENSHIP:

John T.; Jan 9, 1857 - (no date). (SW)  
Mellissa J.; wife of John; Sep 5, 1854 - Dec 12, 1913. (SW)



(Scott Cem)

**BLODGETT:**

Orphy L., son of E. J. & S. C.; 1894 - 1907. (NE)

**BODENHAEGER:**

Catharine, wife of A.; Jan 14, 1892; age 68y 10m. (SE)

David L.; 1855 - 1945. (SE)

Catherine, wife of David; 1859 - 1920. (SE)

Andrew C.; Dec 4, 1844 - Sep 11, 1916. (SE)

---; 1864 - 1922. (EC)

Amy L.; dau of D. L. & K.; Dec 10, 1884 - Mar 1, 1904. (NE)

**BOYLES:**

Della M.; 1900 - 1969. (S)

**BROWN:**

Lela M.; 1895 - 1952. (SE)

Clyde E.; 1892 - 1957. (SE)

Glenn E.; 1912 - 1916. (SE)

H. Maude; 1893 - 1973. (SW)

**BURRESS:**

Frank; d. Apr 12, 1891; age 34y 3m 10d. (SE)

Joseph T.; d. Mar 19, 1885; age 23y. (SE)

**BURTON:**

Robert A.; 1912 - 1951; PFC 134th Inf. 35th Div. WWII. (S)

Lawrence M.; Nov 9, 1913 - Mar 28, 1945; Tech Sgt 317th Inf  
80th Inf Div WWII. (S)

Russell E.; 1889 - 1940. (SW)

Mary Louise, dau of R. E. & E. M.; Sep 28, 1922 - Sep 18, 1923. (SW)

James E.; Jan 10, 1848 - Jan 4, 1937; Cpl Co H 34th Ill Inf;  
Civil War. (EC)

Eliza M.; 1848 - 1889. (EC)

Homer W.; 1874 - 1879. (EC)

Pearl L.; 1883 - 1893. (EC)

Rasalia M.; d. Jul 1, 1849; age ---. (NW)

**BUTTERFIELD:**

Dale O.; 1874 - 1949. (S)

Bessie M.; 1879 - 1964. (S)

Sylvia E.; 1884 - 1928. (SE)

Eugene; 1879 - 1958. (SE)

Charles E.; son of C.W. & E.A.; Dec 16, 1876 - Apr 11, 1883. (NE)

Caleb W.; Sep 10, 1839 - Apr 7, 1902; Co I 11th Ill Cav. (NE)

Eliza A., wife of C. W.; May 24, 1846 - Aug 16, 1928. (NE)

**BUYHER:**

Jacob; d. --- 21, 1862; age 50y 4m 29d. (NW)

Isophena Valentine; d. --- ---, 1884; age 66y 23d. (NW)

William T.; d. ---; age ---. (NW)

Minerva, dau of J. & I.; d. ---; age ---. (NW)

Sarah J., dau of J. & I.; Aug 22, 1846 - Oct 6, 1851. (NW)

Florence, dau of J. & I.; Feb 6, 1850 - Oct 4, 1851. (NW)

**CARR:**

Charles V.; Jun 16, 1887 - Jan 12, 1962; Minn. PFC HQ Co 139th  
Inf WWII. (SW)

Bess I. Berry; (no dates); musician & artist. (SW)

(Scott Cem)

CASE:

Addie, wife of Clarence; d. Feb 20, 1886; age 26y 6m 20d. (EC)

CAVETT:

Jerry L.; Jun 14, 1889 - Mar 25, 1973; Ill. Wagoner US Army  
WWI. (NW)

Rebecca; 1878 - 1957. (NW)

Nellie, sister of Rebecca; 1887 - 1906. (NW)

Thomas H.; d. Nov 3, 1898; age 22y 1m 18d. (NW)

Mary H.; 1853 - 1939. (NW)

John L.; 1843 - 1916; Co G 4th Mo SM Cav. (NW)

Belle (see MATTHEWS).

CHRISTIAN:

Kitty W.; 1879 - 1954. (EC)

Charles H.; 1875 - 1956. (EC)

COX:

Lorenzo, son of E. E. & S.; d. Sep 9, 1871; age 6m 13d. (EC)

Alpha O., wife of Eli; d. Aug 27, 1853; age 18y 3m 16d. (NE)

CREASEY:

Keith E.; 1924 - 1932. (EC)

Verna E.; 1899 - 1948. (EC)

DANIELS:

Harold; 1897 - 1932. (SE)

Dayne M.; 1907 - 1962. (EC)

Alta; 1874 - 1963. (EC)

Edwin; 1861 - 1940. (EC)

Myrtle; 1897 - 1973. (NE)

R. L.; 1893 - 1958. (NE)

DAVIDSON:

R. Clifford; 1884 - 1969. (SW)

John B.; May 15, 1838 - Feb 27, 1909. (SW)

Mary E. Kirk, wife of J. B.; Nov 10, 1844 - Oct 18, 1928. (SW)

Frances E. (see MASON).

DAVIS:

Frank; 1896 - 1969; Ill. PFC Co C 54th Armd Inf WWI. (S)

Lida; 1869 - 1943. (SE)

Arthur; 1867 - 1940. (SE)

Blanche, wife of Gary; 1891 - 1926. (SW)

Vincent, son of G. & B.; 1920 - 1924. (SW)

Thomas H.; 1862 - 1897. (EC)

Ethel M., dau of T.H. & Etta R.; Mar 2, 1897 - Jul 31, 1904. (EC)

Infant son of A. & L. M.; b. & d. Aug 24, 1888. (NE)

Scott, son of A. & L. M.; Sep 14, 1894 - May 18, 1895. (NE)

Nettie (see TOLAND).

DAVISON:

Nettie; 1883 - 1962. (SE)

George; 1881 - 1950. (SE)

Luella, dau of A. & M. E.; d. 1900; age 6m. (NW)

DAWSON:

Andrew; d. Apr 11, 1868; age 62y 2m 2d. (EC)

(Scott Cem)

DEGARMO:

Ira F.; 1878 - 1966. (S)  
Lillie B.; 1881 - 1956. (S)  
Otis E.; Jul 31, 1889 - Jul 15, 1968; Ill. Pvt US Army WWI. (S)  
Myra T.; 1894 - 1969. (SE)  
Elizabeth, wife of Thos.; d. Feb 28, 1872; age 20y 11m 2d. (WC)  
Ermal; 1905. (NE)  
Vearl; 1914. (NE)  
Elizabeth; 1853 - 1924. (NE)  
Thomas; 1850 - 1934. (NE)

DEVOLLD:

Mary A.; 1875 - 1906. (NE)  
Archie M.; 1883 - 1905. (NE)  
Phebe C.; 1904 - 1905. (NE)

DIXON:

Edmund M., son of Z. & C.; d. Jan 30, 1858; age 9m 26d. (NE)  
Adin, son of Z. & C.; d. Jun 12, 1845; age 2y 5m. (NE)  
Martha, dau of Z. & C.; d. Jul 5, 1867; age ---. (NE)  
Zachariah; d. Mar 17, 1859; age 50y 11m 24d. (NE)  
Nancy J., dau of Z. & C.; d. Jan 11, 1865; age 13y 5m 10d. (NE)

DUNCAN:

Amelia; Oct 18, 1839 - Nov 4, 1915. (SW)  
Sarah B., dau of J. & M.; d. Sep 12, 1860; age ---. (WC)  
Infant son of J. & M.; d. Sep 5, 1858. (WC)  
Sarah J., wife of J. M.; d. Jan 3, 1864; age 39y 11m 20d. (WC)  
James M.; Feb 11, 1822 - Jul 8, 1912. (WC)  
Martin; d. Apr 8, 1866; age 79y 11m 3d. (WC)  
Nancy B., wife of Martin; d. Nov 28, 1883; age 89y 9m 11d. (WC)  
Nancy Ann, wife of D. J.; d. Mar 20, 1871; age 30y 11m 23d. (WC)  
Anna, wife of Andrew; d. May 18, 1856; age 58y. (WC)  
Joseph; 1828 - 1915; Co D. 33rd Ill Inf. (EC)  
Martha, wife of J.; 1837 - 1886. (EC)  
Emma J.; 1857 - 1879. (EC)  
Luella; 1873 - 1873. (EC)  
Arthur E., son of Joseph & Martha; d. Jun 18, 1888; age 21y 8m 2d. (EC)  
William; (no dates); Co B 91st Ill Inf. (EC)  
Lena; (see TOLAND)

DUNN:

Tena H.; 1898 - 1964. (SW)  
Emma J.; 1885 - 1964. (SW)  
Ethel F.; 1890 - 1972. (SW)  
Charles E.; 1854 - 1920. (SW)  
Patience A.; 1888 - 1930. (SW)  
Blanchy, dau of C.E. & P.A.; d. Feb 27, 1882; age 2m 19d. (SW)  
Infant dau of C. & P.; d. Jul 4, 1898. (SW)

ELLIS:

Etta Luvada, wife of G. H.; Dec 5, 1875--Dec 28, 1898. (NE)

FOLSOM:

Lavinia, wife of James; d. Jul 16, 1864; age 66y 8m 29d. (WC)  
James; d. Sep 13, 1861; age 70y 6m 17d. (WC)  
Abram M.; son of J. & L.; d. Feb 27, 1860; age 16y 7m 9d. (WC)

(Scott Cem)

FOSTER:

Hazel S., dau of S.M. & K.P.; d. Jan 4, 1897; age 2y 8m 29. (SE)  
Burrow M.; 1845 - 1920. (SE)  
Mary R., wife of B.; 1845 - 1920. (SE)  
Ralph; 1906 - 1968. (SE)  
Olin F.; 1892 - 1938. (SE)  
Samuel M.; 1866 - 1943. (SE)  
Kate P., wife of Sam'l; 1870 - 1950. (SE)  
Norris; 1916 - 1962. (SE)  
John J.; Sep 12, 1793 - Oct 8, 1861; War of 1812, Jackson's Army.  
(WC)  
Frances H.; Sep 27, 1800 - Jan 21, 1858. (WC)

FRISBIE:

William W.; 1874 - 1951. (S)  
J. Louis; 1876 - 1961. (S)

FUNGATE:

William A., son of J.M. & S.J.; d. Oct 19, 1857; age ---. (WC)  
Nancy, dau of M. & N.; d. Nov 5, 1858; age ---. (WC)  
Nancy, wife of J. W.; Dec 8, 1838 - Nov 21, 1895. (WC)  
George W.; 1850 - 1925. (EC)  
Elmira; 1854 - 1900. (EC)  
Rollie E., son of G. & E.; 1896 - 1897. (EC)  
John W.; Apr 13, 1817 - Jul 6, 1898. (NE)  
Orphelia C. Monk, wife of John; Jul 21, 1822 - Mar 4, 1847. (NE)

H----

Elizabeth, "Our Sister"; 1859 - 1898. (NE)

HALE:

Addie, wife of G. E.; Feb 16, 1869 - Nov 16, 1890. (SE)

HALL:

Richard; d. Jan 24, 1880; age 58y; Co A 64th Ill Inf. (WC)  
Mary Patton, wife of Robert; d. Oct 26, 1880; age 67y 1m 6d. (EC)

HARRISON:

George; d. Oct 19, 1894; age 68y 8m 23d. (EC)  
Mary Ann, wife of Geo.; Nov 30, 1827 - Mar 26, 1902. (EC)

HATTERY:

Margaret S., dau of A. J. & S.; d. Apr 17, 1865; age ---. (WC)  
A. J.; (no dates); Co H 12th Ill Inf. (WC)

HENDRICKSON:

Solomon; d. ---; age ---. (EC)  
Elizabeth; d. Oct 23, 1865; age 80y 9m 13d. (EC)  
Catharine, dau of S. & E.; d. Oct 30, 1851; age 27y 6m. (EC)

HENDRICKSON:

Elmer D. 1882 - 1960. (S)  
Ida E.; 1881 - 1959. (S)  
Hattie; 1883 - 1964. (S)  
Bert; 1887 - 1973. (S)  
James E.; 1943 - 1972. (S)  
Fred E.; 1872 - 1953. (SE)  
Sarah D.; wife of Fred; 1871 - 1918. (SE)  
Infant son of M. F. & Z. V.; (no dates). (SE)

(Scott Cem)

HENDRICKSON:

Orville L., son of G. F. & N. M.; 1897 - 1913. (SW)  
Donald; 1915 - 1921. (SW)  
George; 1872 - 1952. (SW)  
Nellie; 1878 - 1961. (SW)  
Mary, dau of W. L. & J. A.; d. Sep 29, 1862; age 2y 1m 8d. (WC)  
Amos; d. May 30, 1853; age 32y 11m 16d. (WC)  
Sarah J., dau of J. & R.; d. Oct 3, 1852; age ---. (WC)  
Jesse; d. Mar --, 1851; age 60y 6m 25d. (WC)  
Sarah N.; 1852 - 1927. (EC)  
Hattie C.; 1878 - 1966. (EC)  
Thomas J.; 1870 - 1936. (EC)  
Nancy, wife of John; d. Mar 23, 1851; age 30y 24d. (EC)  
Elva E., dau of J. W. & S. R.; d. Jan 2, 1871; age 1m 14d. (EC)  
Mary E.; Aug 30, - Oct 1, 1902. (EC)  
Margaret E.; 1853 - 1883. (EC)  
Thomas J.; 1840 - 1877; Co F 99th Ill Inf. (EC)  
J. M.; (no dates); USNASS CD 99th Ill Inf. (EC)  
William L.; 1828 - 1876. (EC)  
Juliett A., wife of Wm.; 1838 - 1920. (EC)  
Mattie Rebecca A., dau of Wm. & J. A.; 1866 - 1878. (EC)  
C. P.; Oct 24, 1828 - Oct 25, 1886. (EC)  
Ann, wife of O. P.; (no dates). (EC)  
Minerva, dau of O. & A.; (no dates). (EC)  
Sevilla; wife of R. M.; d. Dec 10, 1854; age 21y 1m 5d. (NW)  
Sarah Ann, dau of R. M. & S.; d. ---; age ---. (NW)  
Luttia, wife of R. M.; d. Mar 18, 1858; age 19y 5m 1d. (NW)

HENRY:

William T.; 1854 - 1921. (SE)  
Margaret; 1851 - 1927. (SE)

HILLS:

James D.; Sep 24, 1859 Dec 6, 1910. (SE)  
James O., son of J. D. & A. E.; Jan 21, 1884 - Jul 28, 1885. (SE)

HINES:

George E.; 1888 - 1971. (S)  
Grace O.; 1890 - 1974. (S)  
Walter; 1879 - 1962. (SW)  
Georgia; 1884 - 1961. (SW)  
Infant son of W. & G.; d. Jan 25, 1908. (SW)  
Cora A.; 1874 - 1938. (SW)  
Perry; 1872 - 1963. (SW)  
Richard Earl; Jun 21, 1944 - Jun 27, 1944. (SW)  
Daniel; 1848 - 1927. (SW)  
Margaret E., wife of Dan'l; 1852 - 1917. (SW)

HOLLADAY:

Frances Bertie, dau of M. F. & S. C.; d. Aug 20, 1870;  
age 11m 26d. (NW)

HOLTON:

William B., son of H. & R.; d. Jan 21, 1852; age 30d. (EC)  
Henry A.; Mar 15, 1829 - Jan 24, 1913. (NW)  
Rebecca Scott, wife of Henry; Dec 3, 1826 - Apr 4, 1898. (NW)  
David; 1863 - 1915. (NW)  
Mary M. Metsker, wife of David; 1861 - 1904. (NW)

(Scott Cem)

HOLTON:

Harold A., son of D. & M.; d. Dec 10, 1886; age 11m 17d. (NW)  
Olive, wife of Wm. Sr.; d. Oct 15, 1836; age 64y 4m 24d; buried  
29 feet north of large stone. (NW)  
William; d. Apr 12, 1857; age 85y 5m 10d; buried 24 feet north  
of large stone. (NW)  
Cyrus H., son of Wm. & Dorcas F.; d. Dec 15, 1857; age 1y 10m 6d.  
(NW)  
Mary Ellen, dau of Wm. & Betsey; d. Oct 6, 1867; age 26y 11m 3d.  
(NW)  
William, Jr.; d. Nov 12, 1875; age 71y 12d. (NW)  
Betsey, wife of Wm.; d. May 21, 1841; age 40y 7m 10d. (NW)  
Mary; d. Nov 6, 1874; age 81y 5m 27d; buried 20 feet north of  
large stone. (NW)  
Dorcas, wife of Wm.; d. Mar 5, 1886; age 68y 8m 24d. (NW)  
Charles E.; d. Aug 20, 1887; age 56y 11m 14d. (NW)  
Etta M. McKinley, wife of C. E.; d. Oct 16, 1885; age 36y 9m 13d.  
(NW)  
Ruben; b. in Westminster, Vt., Jun 16, 1795; d. Ill, May 10,  
1883; age 88y.  
Margaret A., wife of R.; d. Mar 19, 1884; age 81y 1m 19d. (NW)  
Georgie, son of G. L. & A. M.; d. Mar 8, 1885; age 2m 4d. (NW)  
Charles W., son of John W. & Harriet A.; d. Aug 1, 1878; age  
8m 3d. (NW)  
Freddie; d. Aug ---, 187-; age 2y 3m 28d. (NW)  
John W.; Jan 12, 1844 - Feb 8, 1906; Co D 124th Ill Inf. (NW)  
Perry M., son of J. W. & H. A.; d. ---; age ---. (NW)  
Minnie G. (see BAILEY).

HOOK:

Nettie, wife of W. M.; d. May 6, 1888; age 21y 10m 29d. (EC)

HOOTON:

W. H.; d. Mar --, 1867; age ---. (WC)  
W. T.; d. Jan --; ---; age ---. (WC)  
Mary Elizabeth, dau of W. H. & N. J.; d. Apr 13, 1859; age 30d.  
(WC)  
William; d. Jan 14, 1846; age 59y 1m 29d. (WC)  
Ann, wife of Wm.; d. Apr 19, 18--; age; ---. (WC)  
Bowning; d. Apr 3, 1855; age ---. (NW)  
Isabel, wife of ---; d. ---; age ---. (NW)  
Minerva (see WELBORN).

HORNEY:

Lewis; Oct 9, 1898 - Mar 28, 1962. (S)

HOUSE:

Nancy L., dau of B. F. & S. J.; d. Jun 18, 1871; age 1y 3m 1d. (EC)  
William H., son of B. & S.; d. Sep 1, 1873; age 1y 3m 18d. (EC)

HUFF:

Elizabeth C.; 1852 - 1929. (SE)  
George P.; 1851 - 1917. (SE)  
Sarah L., dau of W. A. & B. A.; d. May 17, 1878; age 29y 2m 1d.  
(WC)  
Betsey; Mar 8, 1812 - Sep 26, 1903; age 91y 6m 18d. (WC)(Teaney)  
William A.; Mar 31, 1808 - Oct 3, 1868. (WC)

(Scott Cem)

HUFF:

Homer W.; 1852 - 1925. (WC)

Anna Grace, dau of P. P. & C.; d. Jun 7, 1898; age 4y 9m 22d. (WC)

Perry P.; Mar 24, 1855 - Mar 23, 1912. (WC)

HUFFMAN:

George; Sep 7, 1841 - Jan 22, 1882. (NW)

Ella L.; d. Aug 8, 1879; age ---. (NW)

Infant; d. Jan 6, 1880. (NW)

(Latter were 2 children of G. & S.C.)

HUSTED:

Infant child of M. & J.; (no dates). (NW)

INGRAM:

Permelia, wife of Uriah; Aug 24, 1813 - Apr 25, 1881. (NE)

JACKSON:

Ella (see MASON).

JARVIS:

Permelia D., dau of H. M. & S. A.; d. Mar 15, 1871; age 3m 12d. (SE)

Elmer E., son of L. E. & M. A.; d. Dec 14, 1875; age 2y 8m 29d. (EC)

Garret J. D.; d. Apr 9, 1865; age 30y 2m 12d; 2nd Lt Co D 50th USC Inf.; killed at Mobile, Ala., while charging the rebble works. (EC)

Philena, wife of G. J. D.; d. Oct 8, 1883; age 44y. (EC)

JONES:

Perry L.; Dec 22, 1895 - Feb 12, 1960; PFC HQ Co Permanent Det WWI. (SW)

Virginia Rosalie; 1928 - 1947. (SW)

Alva; 1898 - 1952. (SW)

Mary Lou, dau of A. D. & William S.; 1927 - 1945. (SW)

Boston I.; 1868 - 1932. (SW)

Ardelia; 1871 - 1955. (SW)

Ethel R., dau of B. & A.; 1901 - 1957. (SW)

Mary H. (see RAYMOND).

KENNEDAY:

Prudence, wife of P.; d. Dec 11, 1873; age ---. (WC)

Susannah, wife of J.; d. Nov 7, 1855; age 45y 7m 8d. (WC)

John; Feb 17, 1805 - Aug 23, 1871; age 66y 6m 6d. (WC)

Mary A., wife of John; Mar 12, 1822 - Dec 20, 1884; age 62y 7m 8d. (WC)

William H.; d. Mar 25, 1856; age ---. (WC)

Infant son of S. & M.; d. Dec 2, 1859; age 18d. (WC)

William Walker, son of S. & M.; d. ---; age ---. (WC)

Sara L.; 1830 - 1888. (WC)

William H.; 1829 - 1919. (WC)

Babes; (no names, dates). (WC)

George J.; d. Jun 21, 1877; age 20y 3m 26d. (WC)

Milinda, wife of S. M.; d. Jul 2, 1878; age 40y 10m 18d. (WC)

Simeon M.; Aug 4, 1835 - Aug 5, 1927. (WC)

Lucinda, wife of S. M.; Jun 22, 1842 - Nov 20, 1912. (WC)

(Scott Cem)

KNIGHT:

Arthur C.; 1875 - 1950. (EC)  
Frances C.; 1856 - 1932. (EC)

KIPLING:

Mary Ann; 1834 - 1912. (EC)

KIRK:

Emily; d. Sep 18, 1907; age 84y. (NW)  
Mary E. (see DAVIDSON).

LA PIERE:

Henrietta; 1868 - 1930. (SE)

LAWYER:

David J.; 1861 - 1929. (SE)  
Margaret, wife of David; 1860 - 1925. (SE)  
George W.; 1890 - 1933. (EC)  
Blanche; 1888 - 1969. (EC)  
Rolo; 1884 - 1959. (EC)  
William H.; 1857 - 1946. (EC)  
Eliza N.; 186- - 1936. (EC)  
Amanda C., wife of G. J.; 1832 - 1901. (NW)  
George J.; 1828 - 1913. (NW)

LITTLE:

Lamech D.; d. Oct 11, 1895; age 76y 8m 25d. (EC)  
James Randolph, son of L. & F.; d. in the service of his country  
at Franklin, Mo., Oct 4, 1861; age 18y 1m 27d; 9 mos. Inf, CSA.  
(EC)  
David, son of L. & F.; d. Jul 20, 1851; age 19m 23d. (EC)  
Frances, wife of L. D.; d. Jul 25, 1851; age 34y 14d. (EC)  
Cyrus; d. Dec 10, 1845; age 21d. (EC)  
Catharine J.; d. Feb 12, 1857; age 16y 1m. (EC)  
Eliza A.; d. Jul 5, 1851; age 4y 9m 18d. (EC)

MAJOR:

Forrest A. (see RAYMOND).

MARSHALL:

Mary Lou; 1933 - 1933. (SE)

MARTIN:

Clinton; 1879 - 1948. (SE)  
Thomas R.; Jan 4, 1844 - (no date). (SE)  
Rhoda E., wife of Thos.; Apr 6, 1844 - Sep 26, 1918. (SE)

MASON:

James; Feb 4, 1903 - Mar 25, 1973; Pvt US Army WWII. (SE)  
Anna L.; 1836 - 1946. (SE)  
Samuel P.; 1862 - 1934. (SE)  
Infant dau of Clara & Thomas; 1922. (SE)  
Jesse H.; 1853 - (no date). (SW)  
Ella Jackson, wife of J. H.; 1859 - (no date). (SW)  
Hattie Mabel, dau of J. & E.; 1893 - 1912. (SW)  
W. E.; Oct 29, 1858 - Feb 15, 1914. (SW)  
Frances E. Davidson, wife of W. E.; Jan 28, 1866 - (no date). (SW)  
J. E. "Johnnie"; 1887 - 1939. (SW)



(Scott Cem)

MASON:

Iona, dau of W. E. & F.E.; d. Aug 9, 1890; age 1y 4m 2d. (EC)  
Burow; d. Apr 14, 1888; age 3y 10m 8d. (EC)  
Evaline, wife of B.; d. Jul 25, 1892; age 67y 10m 28d. (EC)  
John J.; d. Jun 10, 1865; age 22m. (NW)  
Robert M., son of B. & E.; d. Sep 14, 1850; age 1y 17d. (NW)  
Ruth Ann, dau of B. & E.; d. Mar 24, 1851; age 3y 4m 4d. (NW)  
Mary M., wife of James; d. Oct 9, 1863; age 51y 9m 4d. (NE)  
James; d. Oct 5, 1863; age 51y 8m. (NE)  
Mary, wife of J. J.; d. Feb 4, 1890; age 50y 8m 7d. (NE)  
John J.; Sep 1, 1825 - Sep 15, 1891. (NE)  
Obadiah, son of J. J. & M.; d. Sep --, 186--; age ---. (NE)  
Rosila A., dau of J. J. & M.; d. Jun 22, 1862; age 11m 12d. (NE)  
Alleyne; 1919 - 1919. (NE)  
Lois Lee, dau of Norris & Sylvia; d. Dec 28, 191?3?. (NE)

MATTHEWS:

George N.; 1878 - 1962. (S)  
Belle Cavett; 1880 - 1955. (S)  
Herbert C.; Feb 19, 1912 - Jan 9, 1961; Pvt Svc Btry 28th FA Bn  
WWII. (S)  
Nancy E.; 1855 - 1936. (EC)  
James E.; 1844 - 1925. (EC)

MC DANIEL:

Eliza M.; 1879 - 1961. (SW)  
Jennie A. Basco; 1878 - 1960. (SW)  
G. W.; 1840 - 1918; Co G 72nd Ill Inf. (SW)  
Cora Etta, dau of G.W. & N.J.; d. Jan 16, 1873; age 2y 10m 21d.  
(WC)  
Perry W., son of G. W. & N. J.; d. Dec 22, 1872; age 1m 28d. (WC)  
Infant son of G. W. & N. J.; d. Feb 9, 1869. (WC)  
William H.; Jul 7, 1835 - Feb 8, 1928; Co G 72nd Ill Inf. (WC)  
Mary E., wife of Wm.; Apr 3, 1839 - Dec 30, 1885. (WC)  
George R., son of Wm. & M. E.; d. Dec 11, 185--; age 2m 11d. (WC)  
Marsena H.; d. Jan 10, 1877; age 18y 3m 10d. (WC)  
George R., twin son of W. H.; d. Dec 11, 1858. (WC)  
Infant dau of W. H. & M. E.; (no dates). (WC)  
---, dau of F. & L.; d. Aug 17, 1889; age 1y. (EC)  
Mahala A.; Oct 23, 1856 - Mar 19, 1908. (NW)  
Mary E. (see PEAK).

MC KELVEY:

Charles D.; Jan 24, 1857 - (no date). (SW)  
Ettie R. Mason, wife of Chas.; Oct 4, 1866 - Dec 5, 1914. (SW)

MC KINLEY:

Etta H. (see HOLTON).

METSKER:

Mary M. (see HOLTON).

MILLER (MULLEN):

Walter; 1882 - 1936. (SE)

MONK:

Mary; d. Jan 16, 1870; age 26y. (NE)  
Henry F.; d. Jan 19, 1870; age 19y 9m 5d. (NE)

(Scott Cem)

MONK:

Simon M.; d. Dec 28, 1869; age 25y 11m. (NE)  
John; d. Jul 3, 1885; age 77y 5m 27d. (NE)  
Mahala, wife of John; d. Jan 30, 1901; age 90y 5m 13d. (NE)  
Orphelia C. (see FUGATE).

MONTEE:

Ina Isabelle; 1874 - 1910. (SW)  
Dollie Isabelle; 1907. (SW)

MOON:

John; Feb 3, 1843 - Sep 2, 1893. (NE)  
Margaret, wife of John; Mar 7, 1838 - (no date). (NE)

MORRELL:

Edna; 1902 - 1947. (SE)

MORRIS:

Harmon; Jan 13, 1840 - Oct 9, 1862; Co G 72nd Ill Inf. (WC)  
Sarah, wife of Sam'l F.; Jan 8, 1815 - Oct 15, 1848. (WC)  
James M.; Oct 11, 1845 - Oct 11, 1846. (WC)  
William L.; Oct 8 - 21, 1848. (WC)  
Martha, wife of Simeon; d. Jan 25, 1862; age 80y. (WC)  
Simeon; d. May 14, 1862; age 72y 4m 14d. (WC)  
Mary, wife of Wm. G.; d. Oct 12, 1876; age 55y 6m 2d. (EC)  
Martha J., dau of Wm. G. & M.; d. Sep 18, 1846; age 2y. (NW)

MULLEN (MILLER):

Walter; 1882 - 1936. (SE)

MULLEN:

Charles J.; 1867 - 1945. (SW)  
Maber; 1873 - 1968. (SW)  
James A.; d. Oct 28, 1884; age 70y 11m 15d. (WC)  
Anna C., wife of M. P.; d. Oct 2, 1882; age 34y 18d. (EC)  
Infant son of M. P. & A. C.; d. Feb 1, 1879. (EC)  
Cora M., dau of M. P. & A. C.; d. May 3, 1873; age 5m 11d. (EC)  
Infant dau of C. V. & Maber; d. Oct 4, 1895. (NW)  
Martin P.; 1844 - 1919; CO A 78th Ill Inf. (NW)  
Mary E., wife of M. P.; Jun 1, 1861 - Oct 27, 1904. (NW)  
Anna L.; 1855 - 1933. (NE)  
James C.; 1853 - 1927. (NE)

MYERS:

Zelma Christian; 1898 - 1927. (EC)  
Dee A.; Oct 18, 1894 - Apr 10, 1947; Pvt WWI. (EC)  
James Lee, infant son of D. & Z.; (no dates). (EC)

OSBORN:

Isaac M.; Jan 24, 1873 - Aug 23, 1951. (S)  
Fred A.; Dec 23, 1900 - Nov 27, 1959; Tec 5 Med Ambulance Co  
WWII. (S)  
Edith L.; 1911 - 1952. (S)  
Susanah; (no dates); age 18y 9m. (NE)  
Joseph; (no dates); age 10y 9m 25d. (NE)  
Robert; (no dates); age 58y 6m 11d. (NE)  
Frank; (no dates); age 28y 12d. (NE)  
Essie; 1881 - 1952. (NE)  
Edd; 1874 - 1932. (NE)

(Scott Cemetery)

PATTON:

Mary (see HALL).

PAYNE:

Fannie L.; 1882 - 1972. (S)

Keith Edward; Feb 10 - 14, 1937. (SE)

Sarah M.; 1879 - 1939. (SE)

John L.; 1875 - 1964. (SE)

Elizabeth J.; 1852 - 1937. (SE)

Maud E.; 1882 - 1971. (SE)

Perry E.; 1878 - 1962. (SE)

Helen M.; 1910 - 1966. (SE)

Howard L.; 1911 - 1969. (SE)

Albert W.; d. Mar 31, 1883; age 32y. (WC)

Elmer, son of Albert; d. Mar 7, 1891; age 9y. (WC)

PEAK:

Mary E. McDaniel; May 19, 1867 - Jul 6, 1920; age 53y 1m 17d. (NW)

PHELPS:

David; 1899 - 1966. (S)

Charles D.; Jul 8, 1899 - Jul 7, 1966; Pvt Stu Army Tng Corps  
WWI. (S)

P. Ester; Oct 23, 1870 - May 11, 1943. (SE)

Ervin H.; Jun 21, 1869 - Apr 6, 1928. (SE)

Kenneth Ray; Feb 22, 1910 - Sep 19, 1921. (SE)

Jr. Vernon; Jun 13, 1926 - Dec 26, 1926. (SE)

Alice Mable; Mar 17, 1930 - Jul 30, 1930. (SE)

Infant dau of Mr. & Mrs. V. E. Phelps; Apr 19, 1932. (SE)

PHILLIPS:

Wyatt; 1883 - 1953. (SE)

Zella; 1902 - 1956. (SE)

Chester A.; 1895 - 1921. (SE)

Vera I., wife of C. A.; 1900 - 1921. (SE)

Vada I.; 1917 - 1921. (SE)

POMEROY:

Orlando; 1837 - 1895. (EC)

Mary; 1853 - 1917. (EC)

POST:

Ernest Earl, son of F. C. & M. E.; d. Mar 18, 1894; age 6y 2m  
15d. (NW)

POWELL:

Letha A., wife of Reuben; d. Feb 26, 1889; age 35y 1m 29d. (EC)

Etta, dau of Reuben & L. A.; d. Aug 25, 1888; age 1y 5m 8d. (EC)

PRICE:

Mary L.; d. Jan 13, 1862; age ---. (NW)

James; d. Sep 6, 18--; age 1y 7m 17d. (NW)

John B.; d. Feb 25, 1863; age ---. (NW)

Cordella A.; d. Jan 5, 1862; age ---. (NW)

PURDUM:

Hattie E.; 1866 - 1941. (SW)

Samuel; 1837 - 1918; 2 Lt Co C 59th Ill Inf. (SW)

Cornelia J., wife of Sam'l; 1839 - 1927. (SW)

(Scott Cem)

PURDUM:

Bertha M.; 1885 - 1920. (SW)  
Mary Ann, wife of Abraham; 1832 - 1868. (WC)  
Abraham; d. of wounds received in battle at Murfreesboro, Tenn.,  
Feb 15, 1863. (WC)  
Clara M., dau of ---; d. Oct 24, 1882; age ---. (WC)  
Olive D., dau of James & S. E.; d. Sep 6, 1865; age 6m --d. (WC)  
Harvey C., son of M. & L.; d. Dec 13, 1871; age 1y 7m 25d. (EC)  
Theodore W., son of S. & C. J.; d. Aug 25, 1862; age ---. (EC)  
Josie A., dau of S. & C. J.; d. Dec 31, 1879; age 1y 11m 12d. (EC)  
Samuel; 1801 - 1878. (NE)  
Rebecca; 1803 - 1842. (NE)

RAYMOND:

Clarence; Feb 7, 1891 - May 10, 1969; Pvt Co H 112th Inf 28th  
Div WWI. (S)  
Forrest A. Major, wife of Jesse; 1888 - 1917. (SE)  
Jesse; 1887 - 1966. (SE)  
Mary H. Jones, wife of Jesse; 1897 - 1965. (SE)  
Elvira E.; 1862 - 1937. (SE)  
David F.; 1881 - 1930. (SE)

REECE:

Hattie J., wife of F. W.; Nov 3, 1873 - Mar 16, 1899. (WC)

RIDER:

Charles; Apr 13, 1875 - Feb 8, 1929. (SW)  
Jennie; Apr 24, 1875 - Aug 25, 1964. (SW)

RIGSBEE:

Leannah; d. Apr 5, 1851; age 64y. (WC)  
Marion C., son of J. E. & M.; d. Jan 8, 1862; age 20y 8m 14d. (WC)  
George W., son of J. E. & M.; d. Oct 12, 1862; age 19y 9m 12d;  
Co A 78th Ill Inf. (WC)  
Martha, wife of J. E.; d. Dec 17, 1878; age 68y 5m 23d. (WC)  
John E.; d. Nov 2, 1880; age 70y 3m. (WC)  
L. T.; Nov 20, 1850 - Feb 5, 1927. (NE)  
Flora Ellen, wife of L. T.; 1855 - 1930. (NE)  
Infant son of L. T. & F. E.; b. & d. Jul 1, 1882. (NE)  
Infant dau of L. T. & F. E.; b. & d. Oct 27, 1883. (NE)  
Everett; 1893 - 1954. (NE)  
Erma (see STUMP).

ROBINSON:

Otho O.; 1870 - 1959. (S)  
Naomie E.; 1876 - 1935. (S)  
Eva D., dau of Q. & M.; 1917 - 1918. (SE)  
Jay Kay; d. Nov 9, 1941. (SE)  
Elmer G.; Jan 22, 1897 - Jul 8, 1916. (SE)  
Josephine; 1852 - 1932. (SE)  
Sylvester; 1852 - 1930. (SE)  
Arthur L., son of P. W. & J. M.; Jan 17, 1909 - Aug 29, 1910. (SW)

RUSSEL:

Christian; 1902 - 1935. (SE)

SAPP:

Donald H.; Apr 30, 1920 - Sep 5, 1955; WOJG 3704th Base Unite  
AAF WWII. (S)

(Scott Cem)

SAPP:

Myrtle Fern; d. Nov 8, 1974; age 73y 25d. (S)  
Anna; d. Jul 26, 1967; age 81y 2m 6d. (SE)  
James A.; 1854 - 1930. (SE)  
Martha, wife of J. A.; 1867 - 19--. (SE)  
Glenn, son of O. K. & Lou; d. Mar 6, 1890; age 1y 3m 21d. (NW)  
Florence, infant dau of O. K. & Lou; d. Jun 1, 1890; age 4m 21d.  
(NW)

SCOTT:

Alice L.; 1879 - 1971. (SE)  
Frank A.; 1866 - 1951. (SE)  
Wayne A.; 1920 - 1923. (SE)  
Walter G.; 1869 - 1924. (SE)  
Nettie, wife of W. G.; 1874 - 1954. (SE)  
Clarence W., son of W. & N.; 1906 - 1938. (SE)  
Amos N.; Nov 30, 1875 - Nov 17, 1952. (SE)  
Myrtle E.; Nov 11, 1879 - Aug 21, 1949. (SE)  
Lewis Glenn, son of A.N. & M.E.; Jul 14, 1900 - Sep 14, 1916. (SE)  
Albert Arthur, son of T. A. & N. F.; 1910 - 1927. (SE)  
T. Albert; 1878 - 1949. (SE)  
Nellie F.; 1879 - 1954. (SE)  
George M.; 1872 - 1944. (SW)  
Cora J.; 1878 - 1956. (SW)  
Cornelia, wife of F.; 1874 - 1891. (EC)  
A. C.; d. Nov 18, 1891; age 7m. (EC)  
Alice; (no dates). (EC)  
Amanda E., dau of John & Ellen; d. Jun 17, 1887; age 19y 10m 19d.  
(EC)  
Isabell; d. Sep 7, 1880; age 40y 10m 6d. (EC)  
John; d. Feb 1, 1875; age 70y 8m 19d. (EC)  
Richard, son of J. M.; killed and buried at the battle of  
Jonesborough, Ga., Sep 2, 1864; age 18y 5m 23d. (EC)  
Mary, wife of John; d. May 20, 1873; age 65y 9m 7d. (EC)  
William, son of J. & M.; d. May 19, 1851; age 22y 5m 12d. (EC)  
Infant son of S. H.; d. Sep 23, 1872; age ---. (EC)  
Infant son of S.; d. Dec 23, 1862; age 9d. (EC)  
Louis A., wife of Solomon; d. Dec 14, 1862. (EC)  
Solomon; 1836 - 1918. (EC)  
Harriet, wife of Solomon; 1847 - 1928. (EC)  
James Arthur, son of S. & H.; d. Jan 19, 1901; age 21y 1m 20d. (EC)  
Clement E., son of S. & H.; d. Sep 20, 1894; age 22y 27d. (EC)  
Maria; Jul 5, 1831 - Jan 4, 1921. (EC)  
David; Nov 4, 1830 - Dec 10, 1907. (EC)  
Sharlot Ann, dau of D. & M.; Apr 1, 1858 - Sep 7, 1866. (EC)  
Cyrus W., son of D. & M.; Dec 18, 1860 - Oct 12, 1866. (EC)  
Infant of J. H. & M. M.; Aug 6 - 20, 1879. (EC)  
Joseph D., son of J. H. & M. M.; Aug 26, 1877 - May 5, 1883. (EC)  
Charles T., son of J. M. & A. L.; d. Oct 11, 1895; age 14y 7m 14d.  
(NE)  
James M.; 1843 - 1920. (NE)  
Ann L., wife of J. M.; 1845 - 1925. (NE)  
Mamie; 1876 - 1949. (NE)  
James A.; 1868 - 1941. (NE)  
Mary F. (see BERRY).  
Rebecca (see HOLTON).

(Scott Cem)

SELL:

Laura (see TOLAND):

SERROT:

Mary; 1852 - 1932. (SE)

John; 1849 - 1931. (SE)

SHANKLE:

Ethel M.; Aug 3, 1888 - Nov 20, 1966. (SE)

J. Wm.; Aug 11, 1884 - Apr 26, 1941. (SE)

SHANKS:

Robert Dale; Dec 1, 1943 - Jun 18, 1967; Sp 4 5th Surgical Hosp. (S)

SHELTON:

Sarah, wife of J. A.; d. Nov 3, 1851; age 56y --m --d. (NE)

SHOOPMAN:

Patience; Mar 21, 1813 - Dec 13, 1864. (WC)

Thomas F.; Jan 15, 1811 - Mar 5, 1906. (WC)

Martha E.; dau of T. F. & P.; Jan 8, 1847 - Dec 6, 1896. (WC)

SHORT:

Elizabeth; 1832 - 1923. (NE)

SHULER:

Sarah E., dau of J.A. & S. L.; d. --- --, 186--; age --y -m 19d. (WC)

Sarah L., wife of J. A.; d. Jun 6, 1863; age 26y 3m 20d. (WC)

J. W., son of J. A. & S. L.; d. May 11, 1862; age 1y 7m 12d. (WC)

SLATER:

Ellsworth, son of E. & E.; d. Aug 31, 1864; age 11y 5m 21d. (WC)

SMITH:

William E., son of J. A. & E.; d. Jul 10, 1855; age ---. (NW)

SPIVA:

James A.; May 25, 1809 - Nov 19, 1889; Vet - Black Hawk War. (WC)

STUMP:

Erma Rigsbee; 1921 - 1972. (SE)

Michael Leon, son of Russell L. & Erma; Dec 5 - 11, 1950. (SE)

Ottie P.; 1881 - 1972. (SE)

Charles F.; 1878 - 1961. (SE)

SWITZER:

Raymond D.; Jul 21, 1928 - Apr 15, 1958; Amateur Radio W9ZJD. (S)

Jessie F.; 1888 - 1967. (SE)

TATMAN:

Jessie; 1879 - 1954. (NE)

Winslow; 1875 - 1946. (NE)

TIPTON:

Frances J.; 1854 - 1881. (WC)

TOLAND:

Isaac A.; d. Apr 1, 1883; age 27y 6m 11d. (SE)

Sarah R., wife of Wm.; d. Oct 15, 1886; age 44y 9m 14d. (SE)

(Scott Cem)

TOLAND:

S. Henry; Aug 4, 1869 - Jan 3, 1914. (SE)  
Minnie C., wife of S. H.; Dec 15, 1871 - Apr 17, 1934. (SE)  
Charles J.; Sep 6, 1858 - Jun 13, 1922. (SE)  
Marion; 1849 - 1925. (SE)  
Mary J.; 1858 - 1937. (SE)  
Francis M.; (no dates); Co I 12th Mich Inf. (SE)  
Lena Duncan; 1871 - 1967. (SE)  
Charles; 1872 - 1953. (SE)  
Laura Sell; 1871 - 1898. (SE)  
Bert; 1888 - 1968. (SE)  
James; d. Feb 28, 1882; age 60y 9d. (WC)  
Eliza J., wife of J.; d. Dec 12, 187-; age ---. (WC)  
Clara A., dau of J. & E. J.; d. Jan 9, 1868; age 75?y --m 15d. (WC)  
Genevieve Nell, dau of John E. & Lizzie; d. Jun 19, 1916. (WC)  
Sarah E.; 1869 - 1948. (WC)  
John F.; 1856 - 1948. (WC)  
---, dau of W. & J.; d. Oct 6, 1844; age ---. (WC)  
Sarah A., dau of S. & N. A.; d. Jan 8, 1866; age 1y 10m 29d. (WC)  
William, Sr.; d. Sep 30, 1865; age ---. (EC)  
Jane, wife of Wm.; d. Feb 8, 1873; age 62y 7m 5d. (EC)  
Alva C.; Mar 30, 1861 - Oct 16, 1929. (NW)  
Nattie Davis, wife of Alva; Jan 29, 1869 - Mar 15, 1921. (NW)  
Ortie Gilbert; d. Feb 6, 1903; age 2m 16d. (NW)  
Charles Ernest; d. Aug 23, 1893; age 9m 21d. (NW)  
(Latter 2 were children of A. C. & NETTIE)  
John H., son of A. C. & N.; 1890 - 1921. (NW)

TOMLINSON:

Henry; 1844 - 1904. (NE)  
Ellen; 1845 - 1917. (NE)

TUCKER:

Melissa J., wife of T. C.; d. Feb 3, 1876; age 33y 10m 6d. (WC)

TWADDLE:

Flora B.; 1872 - 1969. (SE)  
J. Lawson; 1861 - 1945. (SE)  
Infant son of L. & F.; (no dates). (SE)  
Colbert E.; 1870 - 1929. (SE)  
Maye, wife of C. E.; 1883 - 1944. (SE)  
Lena D.; 1852 - 1942. (NW)  
George W.; d. Sep 18, 1887; age 42y 21d. (NW)  
Clinton Earl, son of C. W. & P. D.; d. Oct 9, 1887; age 5m 4d. (NW)  
Cynthia A., wife of G. W.; d. Jan 1, 1869; age ---. (NW)  
Albert Ross; 1879 - 1945. (NW)  
M. A.; Aug 15, 1837 - ( --- ). (NW)  
Eliza L., dau of M. A. & E. J.; d. Oct 8, 1865; age 1y 11m 4d. (NW)  
Elizabeth J., wife of M. A.; d. Oct 8, 1882; age 40y 8m 3d. (NW)  
John W.; 1832 - 1908. (NW)  
Sarah E., wife of J. W.; 1834 - 1901. (NW)  
Emma G., dau of J. W. & S. E.; d. ---, age ---. (NW)  
Hannah J. & Sarah A.; (both names on a single stone - unreadable).  
(NW)  
James B., son of J. W. & S. E.; d. Oct 18, 1858; age 11m 22d. (NW)

(Scott Cem)

TWADDLE:

William A., son of J. W. & S. E.; d. Mar 22, 1855; age ---. (NW)  
William H.; Jun 2, 1833 - Sep 21, 1897. (NW)  
Mary; d. Sep 4, 1859; in her 90th year. (NW)  
William; d. Mar 31, 1879; age 70y 2m. (NW)  
Hannah, wife of Wm.; d. Aug 30, 1864; age 52y 1m 14d. (NW)  
Mahlon M.; d. May 5, 1849; age 7y 2m 1d. (NW)  
David L.; d. Dec 10, 1851; age 2y 5d. (NW)  
Jacob L.; d. Jun 13, 1855; age 2y 8d. (NW)  
(Latter 3 were children of Wm. & Hannah)

UTTER:

Monroe; Apr 25, 1924 - Jan 12, 1965. (S)

VAN WINKLE:

Thomas O.; 1875 - 1929. (NE)  
Hannah L.; 1850 - 1938. (NE)  
James M.; d. Feb 19, 1900; age 49y --m. (NE)

WAYMACK:

Glen A.; 1895 - 1951. (NE)  
Dollie; 1876 - 1934. (NE)  
Charles; 1871 - 1943. (NE)  
Gilbert, son of C. A. & D. D.; 1907 - 1926. (NE)

WEAR:

G. Eugene; 1890 - 1953. (S)  
Jake; 1862 - 1954. (SW)  
John W.; 1858 - 1928. (SW)  
Etta B.; 1869 - 1944. (SW)  
Alson; 1856 - 1919. (SW)  
Susan, wife of A.; 1859 - 1945. (SW)  
Mary E., wife of John; d. Jun 8, 1881; age 21y 6m 12d. (WC)  
---, dau of H. E. & L. C.; d. Jul 21, 1871; age 7m 9d. (EC)  
O. G., son of H. E. & L. C.; d. Aug 31, 1877; age 6m 28d. (EC)  
---, dau of H. E. & L. C.; d. Mar 11, 1884; age 4y 8m 13d. (EC)  
Lura Mae, dau of A. D. & E. A.; Nov 9, 1896 - Sep 21, 1898. (EC)  
Andrew N.; d. Dec 21, 1875; age 20y 7m 1d. (EC)  
Maria, dau of J. D. & M. B.; d. Oct 16, 1844; age 1y 6m 23d. (NW)  
Clarisa J., dau of J. D. & M. B.; d. Aug 18, 1849; age 1y 10m 3d. (NW)  
Cordelia, dau of J. D. & M. B.; d. Aug 27, 1854; age 1y 19d. (NW)  
Hugh, Sr.; May 13, 1790 - Jan 16, 1873; Ill., Allison's Regt East Tenn Militia, War of 1812. (NW)  
Sarah, wife of Hugh; d. Aug 17, 1859; age 65y. (NW)  
Hannah E.; d. Oct 9, 1871; age 8y. (NW)  
Cordelia Lorange; d. Feb 14, 1861; age 1m 1d. (NW)  
Nancy E.; d. Jan 3, 1863; age 20y 2m 13d. (NW)  
Sylvester, son of ---; d. ---; age ---. (NW)  
Hugh; d. Sep 2, 1870; age 30y. (NW)  
Elzadil J., dau of H. & M.; d. 1862; age 18y. (NW)  
Attie J., dau of J. D. & R. A.; d. Jul 30, 1885; age 1m 10d. (NE)

WELBORN:

Thomas J.; Oct 13, 1815 - Jul 27, 1893. (SE)  
Minerva Hooton, wife of Thos.; May 1, 1825 - Apr 18, 1900. (SE)  
Wisdom; 1855 - 1931.



(Scott Cem)

WELBORN:

Eliza; 1857 - 1956. (SE)  
Tommy, son of L. & F.; d. Mar 31, 1889; age 2m 13d. (WC)  
Infant son of M. W. & Eliza; d. Oct 6, 1889; age 16d. (WC)  
Mark, son of J. & M.; d. Jul 14, 1850; age 6m. (WC)  
Rolla; d. Sep 9, 1904; age 12y 29d. (WC)  
William F., son of T. J. & M.; d. May 14, 1855; age 8y 4m 24d. (WC)  
Infant dau of T. J. & Minerva; d. Jan 2, 1866; age 2d. (WC)  
Losson, son of T. J. & M.; d. ---; age ---. (WC)

WHEELER:

Lemuel; 1849 - 1918. (SW)  
Mary, wife of L.; 1846 - 1916. (SW)  
William R., son of C. M. & M. E.; d. Mar 22, 1884; age 2y 11m 6d. (EC)  
William L., son of L. D. & E. C.; d. Sep 24, 1896; age 1m 4d. (EC)  
Infant son of L. D. & E. C.; d. Aug 7, 1898. (EC)

WIER:

William; Corp 78th Ill Inf.; (no dates). (EC)  
Mary A., dau of B. & M. A.; d. May 19, 1871; age 20y 1m 27d. (EC)  
Alson G.; (no dates); Co C 9th Mo Inf. (NW)  
William H.; Mar 26, 1840 - (no date); Co A 78th Ill Inf. (NE)  
Nancy F., wife of Wm.; Jul 18, 1845 - Jan 15, 1906. (NE)  
Hugh Millard; Nov 10, 1905 - Dec 22, 1964; PFC Hq Co 11th Inf WWII. (NE)  
Nettie F.; 1877 - 1972. (NE)  
Millard F.; 1858 - 1937. (NE)

WILLEY:

Ida; 1876 - 1918. (NE)

WILLIAMS:

Hattie J.; 1885 - 1954. (NE)

WILSON:

Eliza C., wife of John V.; Dec 16, 1814 - Jan 21, 1895. (EC)  
John V.; Mar 27, 1812 - Sep 26, 1865. (EC)  
Freddie, son of P. T. & L. C.; d. Oct 8, 1878; age 11y 2m 10d. (EC)  
Robert B., son of C. & M.; d. Aug 20, 1841; age 10y 5m 2d. (NW)  
Charles; d. May 25, 1847; age 63y 2m 20d. (NW)

WOODS:

Nellie A.; 1872 - 1956. (SE)  
William J.; 1869 - 1961. (SE)  
Rollie; 1898 - 1921. (SE)

ZIMMERMAN:

Helen S.; 1912 - 1960. (NE)  
Edward C.; 1890 - 1971. (NE)

Genealogical Notes - Scott Cemetery

ALEXANDER: Ruebin (1804 - 1852); served from this county during the "Mormon War". Appears as #930 on the 1840 county tax list; owned \$80.00 worth of horses, \$40.00 cattle, and \$50.00 in other property; taxes were \$ .85.

(Scott Cem)

ALEXANDER: Charity (1801-1883); a county census, taken in 1880, indicates that Mrs. Alexander was living in Lamoine Twp.

BERRY: Robert Henry (1850-1942); b. in Va.; to this county in 1869; farmed on section 24 Lamoine Twp. Appears on an 1880 county census; his family, at that time, consisted of his wife, Mary S., and daughter, Nellie M., age 1 year. The family lived in Lamoine Twp.

BLANKENSHIP: John T. (b. 1857) appears on an 1880 county census living in Lamoine Twp.; the household included the following persons: Melissa (age 26); George A., 6; Arthur R., 3; and Mary A., 6 months.

Angie Ann; d. Sep 24, 1881; age 6m; b. & d. in Bethel Twp.

BLODGETT: Orphy L. (1894-1907); son of E. J. & S. Catharine (Purdum) Blodgett; maternal grandparents were Sam'l & Cornelia J. (Rigsby) Purdum.

BODENHAMER: Catherine (1859-1920), wife of David; daughter of Henry A. and Rebecca (Scott) Holton; b. in this county.

David (1855-1945); b. in N.C.; to this county in 1872; farmed on section 26, Lamoine Twp.

John Wesley; d. Nov 30, 1922; age 58y 4m 16d; b. Jul 14, 1864 in N. Carolina; son of Adam & Katherine (Tush) Bodenhamer; Mr. Bodenhamer farmed in Chalmers Twp.

BURRESS: Frank (Wm. Franklin) and Joseph T. were sons of Mrs. Jerusha Ann Burress; after the death of her first husband, Mrs. Burress married Thos. Shoopman in 1865. Joseph T. died on his 23rd birthday.

BUTTERFIELD: Caleb W. (1839-1902) b. Astabula Co., Ohio; moved to this county about 1850; enlisted Nov 20, 1861 at Middletown; re-enlisted and was mustered out Sep 30, 1865; died of heart failure in Birmingham Twp., Schuyler Co.

CASE: Addie (1859-1886), wife of Clarence; maiden name was Scott; b. in Lamoine Twp., this county; taught school in area rural schools; d. at her parents home in Lamoine Twp. of consumption. (Obit, in part, from The Macomb Journal, Feb 25, 1886): "Addie Scott Case died at the home of her father, Solomon Scott in Lamoine Twp., on February 20, aged 27 years. She was born in Lamoine Twp. on July 30, 1859 and married Clarence Case of Macomb on January 28, 1886. They lived 3 miles west of this city. She was a member of the M.E. Church."

CAVETT: Mary H. (1853-1939), daughter of Henry A. and Rebecca (Scott) Holton; b. in this county.

DAVIDSON: John B. (1838-1909) appears on an 1880 county census and was living in Lamoine Twp.; members of his household included: Hugh L., age 61; Mary E., age 35, wife of John B.; Mary E., 18, John A., 17; Frances, 14; Etta B., 10; Sarah A., 5; William S., 3; and Jesse M., 1.

(Scott Cem)

- DUNCAN: Joseph (1828-1915); b. in the state of Tenn.; moved to this county, 1851, from Louisa Co., Ia.; lived on section 11, Lamoine Twp.; enlisted on Feb 25, 1864 at Mocomb and served a short time with Co D 124th Ill Inf.; later transferred to the 33rd Ill Inf.; mustered out Nov 24, 1865. Appears on an 1880 county census and was living in Lamoine Twp.; members of the Duncan household included: Martha, age 46; George, 23; Eldridge, 17; Frank, 15; Arthur, 13; Etta A., 12; Eugene, 4.
- FOLSOM: James (1791-1861) appears on the 1850 federal census for Woodstock Twp., Schuyler Co., Ill. He was born in N.H.; owned \$1,000.00 worth of real estate; his wife, Lavina, was born in Pa. as were their 3 eldest children: Louisa, age 21; Mary J., 17; and Adaline, 13; the youngest child, Abraham M., age 6, was born in Ill.
- FOSTER: Burrow M. (1845-1920) appears on an 1880 county census and was living in Bethel Twp.; members of the household included: Mary R., age 34; and Samuel M., 14.
- FRISBIE: William W. and Joseph Louis appear on the 1880 county census and was living in the Wm. Frisbie household in Bethel Twp.; members of the family included: William, age 44; Margaret, 28; Phelemon, 9; William W., 5; Joseph L., 3; and Robert Ingersoll, 1.
- FUGATE: John W. (1817-1898), son of Martin and Nancy B. (Hobbs) Fugate; b. Russel Co., Va., Apr 13, 1817; moved with parents to Monroe Co., Indiana, thence to this county in 1832; bought a 160 acre farm in section 30, Bethel Twp.; married Sep 19, 1839, in this county, to Ophelia C. Monk; had 3 children: Samuel N., Martin V., and Mary R.; both sons were killed in battle during the Civil War; after his first wife's death in 1847, Mr. Fugate then married on Dec 28, 1865, to Nancy A. Toland, native of Ohio.
- John Fugate a veteran of the Mormon War; served from this county; Sam'l H., son of John, enlisted in Bethel Twp., on Aug 11, 1862; died of wounds at Resaco, Ga. on May 17, 1864. The other son of John's, Martin V., enlisted at the same time as his brother, Sam'l, and was killed at Chickamauga on Sep 20, 1863.
- John appears on the 1840 county tax list as #642; he owned \$100.00 worth of horses, \$12.00 cattle, and \$96.00 in other property; taxes were \$1.04. John W. appears on the 1880 county census report and was living in Bethel Twp.; members of the family included: John W., age 63; Nancy A., 42; Nancy B., 90; George W., 29; Elmyra, 26; Clara L., 7; Etta L., 4; and Bessie D., 2.
- Martin Fugate, father of John W., appears as #641, on the 1840 county tax list; he owned \$200.00 worth of horses, \$90.00 cattle, \$10.00 clocks & watches, and \$179.00 in other property; taxes were \$2.40.
- HALL: Richard (1821-1880); b. Lexington, Ky.; was a resident of Ill. for 44 years; enlisted as a private on Dec 13, 1861 at Tennessee, Ill.; mustered out on Jan 21, 1865; married Mary Patton in this county on Jun 30, 1842; died of pneumonia at age 58y 8m 14d, in Lamoine Twp.

(Scott Cem)

HARRISON: George (d. 1894) and wife, Mary Ann (1827-1902), appear on the 1880 county census report; they were living in Bethel Twp.

HENDRICKSON: The county census for 1850, indicates the following persons living in the Hendrickson household in the south part of the county: Jesse, age 57, farmer, b. Maryland; Mary A., 14, b. Ohio; Eliza, age 19, b. Ohio; Jesse L., 11, b. Ohio; and Benjamin, age 9, b. Ohio.

Amos (1821-1853) appears on the 1850 federal census for Eden Twp., Schuyler Co., Ill.; he was born in Ohio in 1821; his wife, Eliza A., born in 1822, in the state of Tenn.; their 3 children were born in Ill.; they were: Ann, age 7; Harriett, 5; and Abi, 1. Also living in the Amos Hendrickson household in 1850, was Otis P., a brother of Amos.

Amos married Eliza Ann Campbell in this county on Nov 24, 1842.

Otis P. (1828-1886); born in Ohio; in 1850 was living with a brother, Amos, in Schuyler County, Ill.; Otis was a blacksmith by trade, and in 1850, owned \$150.00 worth of real estate.

Sarah D. (1871-1918), wife of Fred. (Obit, in part, from The Macomb Journal, May 7, 1918): "Miss Sarah Oletha Serrot, daughter of Mr. and Mrs. J. T. Serrot, was born Dec 8, 1871, in Schuyler County, and departed this life May 3, 1918 at 6:30 p.m., in Lamoine township, being at the time of her death 46y 5m and 26d old..... united in marriage to Fred E. Hendrickson Oct 11, 1893, and to this union were born five children, Merle in training at Camp Dodge Iowa; Morris, Ruth, and Vera at home; Mary Elizabeth preceding her in death 15 years ago.....she leaves to mourn her loss, a father, mother, husband, four children, one brother, Charlie Serrot of Omaha, a sister Mrs. F. H. Hendrickson of Weldona, Colorado...."

HINES: The Daniel Hines (1848-1927) family appears on the 1880 county census report living in Bethel Twp.; members of the household included: Margaret E., 27; Perry, 7; Emma, 4; and Walter, 1.

HOLTON: William Sr. (1771-1857); b. in the state of Vt.; son of Joel and Bethiah (Farwell) Holton; Joel born in Northfield, Mass., Jul 10, 1738; Wm. came to this county about 1835.

William Sr. appears as #675 on the 1840 county tax list; owned \$15.00 worth of horses, \$36.00 cattle, \$10.00 clocks & watches, \$30.00 wagons, and \$50.00 in other property; taxes were \$ .71.

Olive (1772-1836); born in the state of Vt.; maiden name was Rockwell.

William Jr. (1804-1875); son of Wm. & Olive Holton; b. in Vermont; moved to this county, 1835; lived on section 30, Bethel Twp.; later lived in Lamoine Twp. Appears on the 1840 county tax list as #932; owned \$75.00 worth of horses, \$75.00 cattle, \$15.00 clocks and watches, \$79.00 in other property; taxes were \$1.22.

Betsey (1800-1841) wife of William Jr.; b. in the state of Vermont; maiden name was Mason; married in Vermont.

(Scott Cem)

HOLTON: William, Jr. (1804-1875); had 6 children by his first wife; Wm., after death of Betsey in 1841, then married Maria Sophia Widdill; they had 2 children: John Wesley and Elizabeth Rachel (Mrs. Jacob P. Myers).

Henry A. (1829-1913), son of Wm. Jr. & Betsey (Mason) Holton; to this county with parents in 1835; md. Rebecca Scott Feb 4, 1851; had the following children: Wm. B., d. in infancy; Mary (Mrs. John Cavett); John; Jeremiah; Catherine (Mrs. David Bodenhamer); Emma (Mrs. Wm. T. Price); David; Amos; Belle (Mrs. J. B. Ruffner). Henry and Rebecca also raised a nephew, James Allen Toland, b. Dec 6, 1871; he was a son of Henry's sister, who died shortly after James Toland was born. Henry A. and wife, Rebecca, appear on the 1880 county census and were living in Bethel Twp.; members of the household included the following children: Jeremiah, age 23; Catharine, 21; Emma, 19; David, 17; Amos, 15; and Isabel, 11.

Henry A. (Obit, in part, from The Macomb Journal, Jan 30, 1913): ".....one of the oldest settlers of McDonough county, died at his late home in Lamoine township Friday night of bronchial pneumonia, aged 83 years, 10 months and 9 days.....Deceased was born in Westminster, Vt., and came to this state in 1835, making the trip overland with his parents when but six years of age.....He located in Bethel township but soon after moved to the farm in Lamoine where he died...He was married in 1851 to Rebecca Scott, who died about 15 years ago.....He is survived by these children: James H., Kirksville, Mo.; Mrs. Mary Cavett, Colchester; Jeremiah, Colchester; Katherine Bodenhammer of Plymouth; Amos of Chicago; Belle Ruffner, Macomb; David of Lamoine. He leaves also two brothers--Reuben A. of Colchester and Lyman of Wiltonville, Nebr., and two sisters--Mrs. Elizabeth Myers of Colchester and Mrs. Bell Marvin of Norton, Kan."

William B. (1851-1852), son of Henry A. and Rebecca (Scott) Holton.

Charles E. (1830-1887), son of Wm. and Betsey (Mason) Holton; b. at Westminster, Vt., Sep 7, 1830; moved with parents to this co., 1835; md. Nov 12, 1867, to Etta McKinley; Chas. spent 11 years (1853-1864) in California; he and Etta had 2 children: Ida Blanche (1868) and Ada Ford (1872). Appears on the 1880 county census report; they were living in Bethel Twp.; members of household included: Charles, age 29; Etta M., 32; Ida B., 11; and Ada F., 9.

Charles E. (Obit, in part, from The Macomb Journal, Aug 25, 1887): "Charles Elijah Holton died at his residence in Bethel township on Aug 20th, aged 57 years. He was born in West Minster, Windham County, Vermont. When he was 5 years old, he came to Illinois, settling in Bethel township which has been his home since. In 1852, he went to California via the overland route where he worked in the mines for 12 years, before coming home in 1864. In 1867, he married Miss Etta McKinley of Schuyler County, who with 2 grown daughters survive.....Charles W. McKinley of Grangeville, Mo., is his brother-in-law....."

Ettie (1848-1885), wife of Chas. E.; b. in Ohio; moved with parents to this county in 1857, from Meigs Co., Ohio; Ettie was a school teacher in Schuyler county several years.

(Scott Cem)

HOLTON: Etta (1849-1885) (Death notice, in part, from The Macomb Journal, Oct 22, 1885): "Mrs. Etta Holton, wife of Charles Holton, died Oct 16th.....She leaves a husband and 2 daughters."

John W. (1844-1906) (Obit, in part, from The Macomb By-Stander, Feb 9, 1906): "John Wesley Holton died Friday evening at his home on the Jerry Hickey farm, a mile south of Colchester, aged about 70 years. He had been a resident of this county for many years, much of the time of Lamoine township. He was a veteran of the Civil War and well known in the southwest part of the county."

Reuben Rockwood Holton; d. May 8, 1883; age 87y 11m 10d; farmer; b. Westminster, Vt.; in Ill. 35 yrs; d. Lamoine Twp. Reuben R. (1795-1883) and wife, Margaret A. (1803-1884) appear on the 1880 county census; they were living in Bethel township.

Margaret (1803-1884) (Obit, in part, from The Macomb Journal, Apr 10, 1884): "Margaret A. Holton was born in Vermont in 1803. She joined the M.E. Church in 1818. In 1832 she married Wm. Albee; he died in 1842. She then married Reuben R. Holton in 1847 and in 1849 they came to McDonough County where he died in 1883....."

David W. Holton died Jun 14, 1882; age 9d; b. & d. in Lamoine Twp.

HOOK: Nettie, (1866-1888) wife of W. M.; dau. of Thos. & Jerusha Ann (Burrress) Shoopman.

HOOTEN: W. H. (d. 1867); native of Ohio; settled in this county, 1836; lived in Lamoine Twp.

HUFF: William A. (1808-1868) appears on the 1850 federal census for Brooklyn Twp., Schuyler County, Ill.; he was born in N.C.; farmed, and owned \$1,000.00 worth of real estate; his wife, Betsey A., was born in Va.; all their children (listed on the 1850 census) were born in Ill.; they were: Martha, age 16; John C., 14; Mary, 12; Amanda, 11; Melissa, 8; Maria, 7; Francis M., 5; and Sarah, 2.

??Wm. Huff and family moved from Indiana to Brooklyn Twp., Schuyler Co., Ill., in 1832; lived on section 7.??

JARVIS: Garret J. D. (1835-1865), son of James & Permelia (Driscoll) Jarvis; James, b. Madison Co., Ky. in 1812; Permelia, native of Mercer Co., Ky.; James & Permelia married in Edgar Co., Ill. in 1832; lived in Hire Twp. till 1845; moved to Tennessee Twp.; Garret was a brother to: John M. (moved to Crowley, Kan.); Henry M. (Tenn. Twp.); James E. (Winfield, Kan.); Samuel M. (Kansas City); Joseph M. (d. in infancy); Nancy A. (d. in infancy); Isaac S. (d. 1846); William H. (d. Perryville, Ky., 1863). Garret J. D. enlisted Aug 13, 1862, at Tennessee, Ill.; promoted to Lt.; killed at Ft. Blakley, Ala.

Philena (1839-1883) (Death notice, in part, from The Macomb Journal Oct 25, 1883): "Mrs. Phelina Jarvis died at her home in Lamoine Twp. on Oct 8th, aged 44 years. Her husband was Garret J. D. Jarvis and he was killed at Fort Blakely near Mobil on Apr 9, 1865. She remained a widow until her death....."

(Scott Cem)

KENNEDAY: John (1805-1871); b. in N.C.; moved to this county from Davison Co., N.C. in 1836; lived on section 26, Lamoine Twp.

Simeon M. (1835-1927); b. in N. C.; moved to this county at age 1 year with parents, John & Susannah Kenneday; md. in this county & farmed on section 35, Lamoine Twp.

Malinda (1837-1878), wife of Simeon M.; b. Adams Co., Ill.; d. of Bright's Disease in Lamoine Twp., this county.

George (1857-1877); died in Lamoine Twp.; cause of death was suicide.

LAWYER: George J. (1828-1913), son of William; George was born in Fayette Co., Ohio, Oct 24, 1828; Wm., native of Pa.; moved to Brown Co., Ill., in 1835; to this county in 1836; lived in Tennessee Twp.; Wm. moved to Appanoose Co., Iowa in 1856; then, to Wayne Co., Iowa where Mrs. Lawyer died; Wm. then moved to Union Co., Iowa and died there in 1883; George was a brother to: Elizabeth (Mrs. Hoagland, moved to Mo.); Dedmarius (Mrs. Wm. Breeden); Catharine (Mrs. Ethan Jarvis); John W. (moved to Washington Terr.); Sam'l; William, moved to Union Co., Iowa; and Susan. George married Nov, 1867, to Amanda C. Wear; they had 7 children: Sarah C. (Mrs. Geo. Huffman); Nancy E. (Mrs. James Mathews); William H.; David J.; Susan J.; Joseph E.; and George M.

Amanda C. (1832-1901), wife of George J.; daughter of Hugh and Sarah (Duncomb) Wear.

LITTLE: Lamech D. (1819-1895), son of Lamech & Elizabeth (Henderson) Little; b. in Md., Jan 16, 1819; moved with parents to Harrison Co. Ohio, 1825; Lamech, Jr. moved to this county in 1839; married either Dec 30, 1843 or Dec 31, 1840, to Francis Henderson; had 7 children: Catharine J., James, Eliza, Ann, Cyrus, and David. After the death of his first wife in 1851, Lamech married Margaret J. House; they adopted 2 children--Ellen and Lamech.

James Randolph (1843-1861), son of Lamech, Jr. & Francis (Henderson) Little; died of diphtheria.

MASON: Burow (1814-1888), born in Cook Co., East Tennessee, May 6, 1814; son of Adin & Mary (Warmact) Mason, natives of Va.; Burow moved to Bethel Twp., this county, 1836; married Dec 8, 1846, to Eveline Hendrickson; had 11 children: Adin P.; Jesse H.; Eliza J.; George W.; William B.; Benjamin B.; Samuel P.; Etta R.; Robert; Ruth Ann; and John.

Burow appears on the 1840 county tax list as #637; owned \$40.00 worth of horses, \$39.00 cattle, \$10.00 clocks and watches, \$15.00 cash loaned out, and \$62.00 in other property; taxes were \$.83.

Burow appears on the 1880 county census report; members of the household included: Evaline, age 52; George W., 23; Edmond W., 21; Benjamin B., 19; Samuel P., 17; and Etta, 13.

Jesse H. (b. 1853) appears on the 1880 county census as living with wife, Nancy E., age 21, in Bethel Twp.

Frances E. (b. 1866), wife of W. E.; daughter of John B. and Mary E. (Kirk) Davidson.

(Scott Cem)

MATTHEWS: James E. (1844-1925) appears on the 1880 county census as living with his wife and son in Bethel Twp.; the family consisted of: Nancy E., age 24; and George N., 1.

Nancy E. (1855-1936); wife of James; daughter of George and Amanda C. Wear Lawyer.

MILL: Phoebe; d. Sep 27, 1881; age 77y; single; d. in Bethel Twp.

MONK: John (1808-1885); son of Malachi and Jemima (Jones) Monk; b. Hardin Co., Ky., Jan 6, 1808; moved with parents to Ind., in 1812; then moved with parents to this county in 1832; lived in Bethel Twp.; Malachi died in April 1840, and was buried on his farm in section 7, Bethel Twp.; Jemima died in Feb. 1859, and buried in this cemetery (NOTE: No stone located for her); John married in Ind., Jan 28, 1829, to Mahala Stroud; had the following children: Hester A., Thomas W.; Sam'l; Emily J.; William; twins--Simon & Mary; and Henry F.

Mahala (1810-1901), wife of John Monk; daughter of Thomas and Jane (Moore) Stroud.

John appears on the 1840 county tax list as #677; owned \$80.00 worth of horses; \$46.00 cattle; \$10.00 clocks & watches, and \$132.00 in other property; taxes were \$1.34. John and Mahala appear on the 1880 county census and were living in Bethel Twp.

John; (Death notice, in part, from The Macomb Journal, Jul 9, 1885): "John Monk, one of the oldest inhabitants of McDonough County, died at his residence in Bethel township last Friday. He was born in Hardin County, Ky. in 1808. When he was 4 years old, he moved with his parents to Indiana where he grew to manhood and married in 1829, to Mahala Strode. She survives him. In 1832, he came to Illinois with his father's family. They settled in Bethel township, section 7. He had also lived at Plymouth, Hancock County, for a time. He raised a large family."

Jemima, mother of John and widow of Malachi, appears on that 1840 tax list as #676; she owned no real estate and a total of \$233.00 worth of personal property; taxes were \$1.17.

MONTEE: Ina Isabelle (1874-1910), was the wife of Dr. Chas. Finney Montee, a Colchester physician. Ina and Dr. Montee were married in this county on Nov 18, 1897. Dr. Montee was a son of Frank M. and Mary E. (Purdum) Montee and was born in this county in 1870.

MORRIS: Simeon (1790-1862); moved to this county from N. Carolina in about 1836; son, Sam'l F., born Sep 15, 1816, also came to this county and lived in Lamoine Twp. (Another reference says Simeon moved in 1834 from Va. to the north part of Birmingham Twp., Schuyler Co.) Simeon appears as #927 on the 1840 county tax list; owned \$100.00 worth of horses, \$108.00 cattle, \$30.00 carriages, \$75.00 wagons, \$100.00 cash loaned out, and \$200.00 in other property; taxes were \$3.07.

Sarah (1815-1848); wife of Sam'l F.; Sam'l appears as #926 on the 1840 county tax list; owned \$60.00 worth of horses, \$46.00 cattle, and \$40.00 in other property; taxes were \$ .73.



(Scott Cem)

MORRIS: Harmon (1840-1862); enlisted Aug 13, 1862; died at Paducah, Ky.

MULLEN: James C. (1853-1927) appears on the 1880 county census report and was living with his family in Bethel Twp.; the family consisted of his wife, Annie L., age 26; Homer A., 5; Nellie M., 3; and Emma F., 2.

James A. (1813-1884) appears on the federal census for Brooklyn Twp., Schuyler Co., Ill.; he was born in Tenn.; farmed, and owned \$500.00 worth of real estate; his wife, Unity, was born in Va. in 1814; all their children (Listed on the record) were born in Ill.; they were: Hannah, age 12; Nancy, 10; Elizabeth J., 8; Martin P., 6; Mary, 4; and John W., 2.

Mary E. (1861-1904), daughter of Solomon and Alpha (Baggett) Mullen; b. in this county; married Martin P. Mullen of Schuyler Co., Ill., Jan 8, 1884. Solomon died in Macomb in 1868; Alpha remarried, in about 1883, to James A. Logan, of Schuyler Co.

OSBORN: The Robert Osborn (d. at age 58y) family appears on the 1880 county census and was living in Bethel Twp.; members of the household included: Robert, age 32; Elizabeth J., 30; William E., 8; Isaac M., 7; Susannah, 4; Emmasiah F., 6; and Brice W., 1 month.

POMEROY: Orlando (1837-1895) and family appears on the 1880 county census report as living in Bethel Twp.; members of the household included: Orlando, age 39; Mary E., 27; Nellie L., 10; Cornelia, 6; William W., 3; and Homer F., 1 month.

PURDUM: (NOTE: Name also spelled as PURDHAM) Samuel (1801-1878), native of Md; moved to Ill., 1838/1840; lived in Schuyler Co., Ill. and Bethel Twp.; married Rebecca Brown, a native of Va. and Ohio. Appears as #679 on the 1840 county tax list; owned no real estate; \$120.00 worth of horses, \$35.00 cattle, \$60.00 wagons, and \$95.00 worth of other property; taxes were \$1.55.

Appears on the 1850 federal census for Brooklyn Twp., Schuyler Co., Ill.; he was born in Maryland; he was a merchant and owned \$1200.00 worth of real estate; his children, as listed on this report, were all born in Ohio; they were: Martha J., age 18; Abraham, 17; Miskieh, 13; Samuel, 12; and James, 10.

Rebecca (Brown) Purdum, wife of Samuel, died in 1842; Samuel then married Elizabeth Tullis, native of Ross Co., Ohio; she was a daughter of John Tullis of Ohio. Samuel was a son of Walter Purdum. Samuel moved to this county from Hamilton Co., Ind; operated a saw mill and lived on section 25, Lamoine.

Samuel (1837-1918) son of Sam'l and Rebecca (Brown) Purdum; b. at Hamilton Co., Ind, Oct 29, 1837; moved to this county with parents in 1838; mother died when he was 4 years old; raised by his father and step-mother; attended schools in this county and Schuyler Co.; worked as a carpenter; md. Feb 25, 1866, to Cornelia J. Rigsby, native of Schuyler Co.; they had the following children: Hattie; Ella (Mrs. Edward Hendrickson); Theodore (d. in infancy); Myrtle (Mrs. Anderson Ward); Catherine (Mrs. E. J. Blodgett); Josie Ann

(Scott Cem)

PURDUM: Samuel (1837-1918) -- cont'd.

(d. at age 2 yrs.); and Edith Kerma. Sam'l and Cornelia also raised a nephew, b. in 1889, a son of Mrs. Purdum's sister.

Olive D. (1865-1865), daughter of James & Sarah E. (Foster) Purdum; Sarah born in Schuyler Co., Ill.; md. Feb 19, 1860; lived on section 30, Bethel. James, a son of Sam'l and Rebecca Purdum, was a carpenter.

Abraham (d. 1863), son of Sam'l and Rebecca Purdum; enlisted in Scotland Twp., Aug 6, 1862; served as a private with Co C, 84th Ill Inf.; d. at a Nashville, Tenn. hospital.

Samuel (1837-1918), son of Sam'l and Rebecca Purdum; enlisted at Tenn. and commissioned 2nd Lt., Mar 28, 1865; mustered out Dec 8, 1865.

RIGSBEE: John E. (1810-1880) appears on the 1850 federal census for Brooklyn Twp., Schuyler Co., Ill.; he was born in N.C.; farmed and owned \$1,000.00 worth of real estate; his wife, Martha, was born in Va.; also living in household in 1850, was his mother, Leanna, born in N.C.; children shown in the Rigsbee household in 1850 were: Sarah, age 13; Cornelia, 11; Calvin, 9; George W., 7; Ann, 5; and Eliza, 2. All the children were born in Ill.

John E. Rigsbee and family came from Ind. with the Huff's ---- settled in north part of Brooklyn Twp.; named the area "Guinea Prairie."

ROBINSON: Arthur L. (1909-1910) (Obit, in part, from The Macomb Journal, Aug 31, 1910): "Arthur L. Robinson was born in Lamoine Twp. Jan 17, 1909, and died Aug 29, 1910, aged 1 year, 7 months, and 12 days. He was very patient during his illness until his death, which was caused by spinal meningitis. He leaves to mourn his departure, his father and mother, Mr. Perry W. and Mrs. Julia M. Robinson....."

SCOTT: John (1804-1875), b. in Ireland; moved to this country in about 1825; lived in Ohio and married there to Mary Hendrickson.

Richard (1846-1864), son of John & Mary (Hendrickson) Scott; enlisted in Bethel Twp., Feb 25, 1864; served as a private in Co A 78th Ill Inf.; died of wounds in Georgia.

The 1860 federal census for Bethel Twp. indicates the following individuals residing in the John Scott household: John (age 62, b. Ireland); Mary (age 51, b. Maryland); John (age 22, b. Ohio); Isabella (age 20, b. Ohio); Amos (age 18, b. Ill); James (age 16, b. Ill.); Richard (age 14, b. Ill.); Joshua (age 12, b. Ill.); and Mary C. Cavett (age 14, b. Ill.).

John Scott married Mary Duncan in this county on Nov 7, 1833.

Solomon (1836-1918); b. in Ohio; moved to this county in 1840 from Carroll Co., Ohio; farmed on section 36, Lamoine Twp.

(Scott Cem)

SCOTT: Joshua H. and Mahala M., parents of Joseph D. (1877-1883) and Amos (1875-1952), appear on the 1880 county census report and were living in Bethel Twp.; the Scott family consisted of the following person; Joshua H., age 32; Mahala M., 35; Mary E., 9; Philena C., 7; Amos, 4; and Joseph D., 2.

SERROT: John (1849-1931) and Mary (1852-1932); parents of Sarah D. Hendrickson; lived in Schuyler County, Ill.

SHELTON: Sarah (d. 1851), wife of John A.; John appears as #920 on the 1840 county tax list; owned \$150.00 worth of horses, \$100.00 cattle, \$10.00 clocks & watches, \$100.00 wagons, and \$140.00 in other property; taxes were \$2.50.

SHOOPMAN: Thomas F. (1811-1906); b. in E. Tennessee; son of Jacob and Polly (Owens) Shoopman, natives of Va.; moved with parents to Hopkinsville, Ky. in 1829; Jacob died there in December, 1829; remainder of the family moved to Morgan Co., Ill. and stayed there till 1833, when they moved to this county; Polly died in this co., 1840; Thomas married Patience Smedly, native of Tenn., and they had 10 children: Elizabeth, Nancy J., Jacob, John S., Mary, Susan, Sarah, Catherine, Martha and Hannah. After the death of Patience in 1864, Thos. married Mrs. Jerusha Ann Burress in 1865; Thos. and Jerusha had two children: Nettie Caroline (Mrs. W. M. Hook; she died at age 21 years) and Albert. Jerusha had by her first husband, 5 children: Edna J., Elmira A., William F., Toliver D., and Joseph T.

Thomas F. appears on the 1840 county tax list as #640; he owned no real estate; had \$30.00 worth of horses, \$54.00 cattle, and \$60.00 in other property; taxes were \$ .72. Also appearing on this list, as #646, was Jacob Shoopman; and as #626, was George W. Shoopman. (NOTE: All surnames appeared as "SHOCTMAN" on this list.)

Thomas F. appears on the 1880 county census; he and other members of the Shoopman family were living in Bethel Twp.; the household included: Thomas, age 68; Ruth A., 47; Genetta C., 12; and Albert, 11.

SPIVA: The James Spiva family appears on the 1850 county census as follows: James, age 40, farmer, b. Tenn.; Rebecca, age 39, b. Ky.; children, as follows, all b. in Ill.: Amanda, 16; Louisa, 14; Mary, 11; Able, 8; Ann M., 7; Cynthia, 3; Sarah, 10 mos. Also in the family was a Mr. Combs, age 19, farmer, b. Ill.

STUMP: Charles F. (1878-1961) was a son of Isaac and Sarah E. and a brother to John E. Other members of this family are buried at the Dunkard Cemetery.

TOLAND: William, Sr. (d. 1865); b. in Pa.; married Jane Hendrickson in Ohio; moved to this county, 1840; lived in Bethel Twp.

Sarah E. (1842-1886), wife of Wm., Jr.; b. in Ill.; maiden name was Welborn; married Wm. Toland, Jun 25, 1868; dau. Nellie, b. Feb 25, 1880; William served 2 years with the 78th & 148th Ill Inf. during the Civil war; mustered out in Sep., 1865.

(Scott Cem)

**TOLAND:** The William Toland family appears on the 1880 county census report; they were living in Bethel Twp.; members of the household included: William, age 38; Sarah R., 38; Nellie, 3 months; Martha, 13; and Isaac A., age 24 years.

(Death notice, in part, for Sarah, from The Macomb Journal, Oct 21, 1886): "Mrs. Wm. Toland of Bethel Twp. died last Saturday and was buried Sunday in the Scott burial ground. She had at one time lived in Macomb and was a sister of Mrs. Amos Scott....."

Nettie Davis (1869-1921) (Obit, in part, from The Macomb Journal, Mar 17, 1921): "Nettie Davis, daughter of John and Sarah Davis, was born in Brooklyn township, Schuyler county, Jan 29, 1869, where she grew to womanhood. Nov 27, 1889, she was united in marriage to Alva C. Toland, and to this union five sons were born, three of which are deceased.....greater part of her life was spent in Brooklyn and Birmingham townships, the past twelve years being spent in Macomb and vicinity.....Sunday afternoon she became seriously ill and was at once removed to the Marietta Phelps hospital. Monday morning she underwent a operation, but few hopes were entertained for her recovery. She grew steadily weaker until at 9:10 Tuesday evening she passed away.....Death was due to strangulated hernia. She leaves to mourn her passing, two brothers, Arthur of Birmingham, Ill., and Oliver of Macomb, her husband and sons, Teslie, at home, and Otha and wife and granddaughter, also of Macomb. Three sons, Gilbert, Ernest, and John having gone before her.....services held at the home, 433 North Monroe St....."

Alva C. (1861-1929) was a son of James and Juliett A. Toland; James was born in 1828; Juliett, in 1838; Alva was a brother to Solomon H. (b. 1870).

**TWADDLE:** William (1809-1879), b. in Ohio; from a family of 15 children, 5 of whom were born blind; moved to this county from Jefferson Co., Ohio in 1844; served as justice of peace for over 30 years; married Hannah Hooten and had the following children: John W., William H., Marsena A., James, Mary Ann (Mrs. W. W. Huff), Mahlon, George, Minerva E. (Mrs. Wm. Lawyer), David, Jacob, and a daughter that died in infancy in Ohio.

George W. (1845-1887) (Obit, in part, from The Macomb Journal, Sep 22, 1887): "George W. Twaddle died Sunday in Bethel township. He was born on the farm where he died on Aug 28, 1845, the son of Wm. and Hannah (Hooten) Twaddle, early residents of this county who had come here from Ohio. When his parents died, George became the owner of the homestead. He was married the first time on Jul 19, 1868, to Cynthia, daughter of Alonzo and Minerva Hatch. She died the following January and he then married Miss Philema Stookey, who with five children, survives. His last marriage was on Sep 28, 1872. He was a justice of the peace in his township and was the brother of Wm. H. Twaddle, a Macomb attorney...." George and Philema has the following children: Clinton Earl, Maber, Perry, Ottie P. and Otto B. George appears on the 1880 county census and was living in Bethel Twp. with his family as follows: Philena D., age 27; Maber, 7; and Perry, 3.

(Scott Cem)

TWADDLE: Cynthia A.; first wife of George Twaddle; daughter of Alonzo and Minerva Hatch; married Mr. Twaddle in 1868.

John W. (1832-1908); b. Ohio, Apr 18, 1832; moved with parents to this county in 1844; member of the county Pioneer's Club in 1906.

Marcena A. (b. 1837) appears on the 1880 county census report; he and his family were living in Bethel Twp.; members of the household included: Marcena A., age 42; Elizabeth J., 38; James L., 18; William N., 14; Marcena C., 12; Colbert E., 10; Alice U., 8; George O., 6; Lycurgus W., 3; and Albert R., 8 months.

VAN WINKLE: James M. (d. 1900) appears on the 1880 county census as living with his family in Bethel Twp.; members of the household included: James, age 33; Hannah L., 31; Elizabeth F., 11; Drewlilla, 8; Thomas O., 4; and Patience M., 4.

WEAR: Hugh, Sr. (1790-1873); b. in Washington Co., Tenn.; moved to Lamoine Twp., this county, in 1835 from Monroe Co., Tenn.; wife was the former Sarah Duncombe. Appears as #696 on the 1840 county tax list; owned \$50.00 worth of horses, \$98.00 cattle, \$10.00 clocks and watches, \$5.00 carts, \$40.00 cash on loan, and \$205.00 in other property; total taxes were \$2.04.

Maria, Clarissa J., and Cordelia were daughters of Joseph D. and Mary B. (Downs) Wear; Joseph, a son of Hugh and Sarah (Duncombe) Wear; moved with his parents to this county in about 1835; J. D. and Mary Wear had 10 children; lived in Lamoine Twp.

WELBORN: Thomas J. (1815-1893) and family appear on the 1880 county census; they were living in Bethel Twp.; members of the household included: Thomas J., age 65; Minerva, 54; Elizabeth C., 27; Marcena W., 24; Isaac J., 22; Linzy, 20; and Charles, 17.

WILSON: Charles (1784-1847) appears as #672 on the 1840 county tax list; he owned \$25.00 worth of horses, \$105.00 cattle, \$10.00 clocks and watches, \$50.00 carriages, and \$100.00 in other property; taxes were \$1.45.

Notes, Corrections, Additions, and Changes

## Dunkard Cemetery

Location: Bethel township; SE $\frac{1}{4}$ , Section 18. Three miles southwest of Fandon.

Remarks: This cemetery was established in connection with the Dunkard church which was located nearby for a number of years. In 1883, the German Baptist Brethren organized in this vicinity and built a church near the southeast corner of section 18 Bethel township. As far as is known at this time, the only other Dunkard, or German Baptist church in the county was located in Mound township. The current condition of the cemetery is good; when surveyed for this report in 1975, the grounds were completely fenced and the area indicated regular and dedicated maintenance. All stones were standing upright; most were completely readable. Several small, metal markers (supplied by mortuaries) marked individual graves.

### ALLEY:

Charles C.; 1874 - 1954.  
Laura E.; 1880 - 1950.

### BARRETT:

Enos; Oct 6, 1850 - Aug 14, 1936.  
Sophia E.; Apr 26, 1855 - Jan 6, 1942.

### BECK:

Sarah; 1867 - 1896.  
Samuel; 1863 - 1953.  
Ethel; (no dates).  
Infant; (no dates).  
Luther; Jan 25, 1892 - Sep 14, 1969. Ill. Pvt. Btry F 53ed  
Arty, WWI.  
Joseph L.; 1861 - 1900.  
Dora (see BOYD)

### BOYD:

Dora Beck; 1864 - 1930.

### BURGARD:

Catharine, wife of Daniel; d. Sep 14, 1885; age 40y 6m 26d.

### CARSON:

Pious E.; Mar 2, 1830 - Aug 4, 1911.  
Katharine, wife of Pious; Sep 28, 1836 - Mar 8, 1911.

### CAVETT:

Raymond; 1907 - 1915.  
Edith; 1905 - 1915.

### CLARK:

Ella (see WALTY)

### COON:

James L.; 1861 - 1926.  
Mary C.; 1862 - 1956.  
Lillie Ann, dau of L. & M. C.; d. Oct 15, 1900; age 7y 8m 14d.

(Dunkard Cem)

CROUCH:

Eliza; 1848 - 1924.

DULANEY:

Lydia, wife of Walter; Jul 28, 1887 - Jan 31, 1919.

Walter P.; 1884 - 1943.

Oda A.; 1909 - 1931.

DUNSWORTH:

Susan; Jul 11, 1873 - Oct 1, 1934.

FERNOW:

Howard B., son of James & Nellie; May 2, 1907 - Jul 4, 1921.

James L.; Dec 20, 1867 - Sep 10, 1925.

Minnie, wife of J. L.; d. Aug 6, 1899; age 30y 10d.

GREENWALT:

Caroline (see HUMMER).

HARLACHER:

Sherman H., son of W. & S.; d. Jun 14, 1893; age 2m 12d.

Birdie C., son of Wm. M. & S. B.; d. Sep 28, 1887; age 24d.

HARMAN:

James M.; Apr 2, 1869 - Jun 30, 1959.

Elizabeth; Sep 11, 1872 - Apr 25, 1952.

Donald E.; 1930 (no other dates or age).

HAYS:

Esty M., dau of G. H. & S. A.; d. Jan 11, 1885; age 4y 3m 14d.

Eliza, wife of Daniel; Nov 25, 1810 - Jan 21, 1884; age 73y 1m 26d.

Daniel; Oct 19, 1807 - Feb 14, 1883; age 75y 3m 25d.

HARTSOOK:

Martin L.; May 26, 1844 - Jun 16, 1926.

Anna R., wife of Martin; Sep 25, 1841 - Mar 23, 1914.

George M.; d. Nov 17, 1889; age ? 2m 7d ?.

HUMMER:

Caroline Greenwalt, wife of Samuel; Jun 25, 1831 - May 7, 1899.

Samuel L. or V.; Nov 27, 1830 - Aug 19, 1907.

Caroline; 1870 - 1957.

Elizabeth; 1860 - 1951.

KING:

Azaiah; Dec 25, 1816 - Jul 23, 1892.

Sarah Jane, wife of A.; Dec 11, 1823 - Nov 13, 1888.

Clara M., wife of John T.; d. Jan 11, 1892; age 39y 6m 16d.

Infant of M. K. & C. B.; b. & d. Sep 30, 1893.

KLINE:

Uriah C.; Oct 28, 1820 - Aug 2, 1895.

Susan, wife of Uriah; Mar 11, 1828 - Feb 2, 1905.

MAHAN:

Jacob; Apr 20, 1831 - Aug 6, 1885.

MYERS:

Elder Joseph; d. Sep 5, 1885; age 82y 7m 23d.

John L.; d. Oct 28, 1888; age 49y 3m 23d.

(Dunkard Cem)

MYERS:

Samuel; b. in Baltimore Co., Md., Mar 3, 1837; d. Nov 15, 1900.  
Anna M., wife of Sam'l; b. in Adams Co., Pa., Mar 20, 1839; d.  
Mar 21, 1926.

PARKS:

Lovina, wife of Benner; Dec 20, 1834 - Mar 14, 1882.  
Benner; d. Feb 2, 1889; age 72y 10m 28d.  
W. E.; Nov 29, 1863 - Aug 23, 1914.  
Mary C. "Callie"; 1863 - 1921.  
John M.; Mar 11, 1837 - Aug 29, 1904.  
Susan, wife of John; Jan 29, 1842. (No other date.)

PHILLIPS:

Lena Mable (see RUNTE)

REED:

Martha L.; 1884 - 1959.  
Creed T.; 1874 - 1940.  
Mary E.; 1884 - 1952.  
Gordon C.; 1877 - 1967.  
Seigler; 1872 - 1957.  
Matilda; 1875 - 1926.  
George B.; Sep 20, 1842 - Mar 21, 1920.  
Malinda, wife of Geo.; Jun 19, 1847 - Jun 5, 1920

RUNTE:

Charles F.; 1886 - 1964.  
Lena Mable Phillips, wife of Chas.; 1893 - 1951.  
Mary Pearl (see STUMP)

STUMP:

Jennie; 1869 - 1935.  
Perry Dale; 1881 - 1964.  
Mary Pearl Runte; 1888 - 1948.  
Dean, son of P. D. & M. P.; 1909 - 1918.  
Daniel; Aug 25, 1853 - Oct 6, 1916.  
Susanna, wife of Dan'l; Feb 24, 1853 - Feb 14, 1917.  
Isaac; Mar 27, 1851 - Apr 29, 1930.  
Sarah E., wife of Isaac; Nov 25, 1855 - Mar 13, 1895.  
Betty Maxine; 1922 - 1923.

STUMPF:

Oral Dale; 1906 - 1908.

SWITZER:

Minnie, wife of A. R.; d. Jun 26, 1905; age 20y 8m 27d.  
Albert R.; (no dates); age 30y 1m.  
Cloah Pearl, wife of J. M.; d. Nov 14, 1901; age 20y 6m 1d.  
Malinda F.; 1847 - 1926.  
William H.; 1851 - 1932.  
Elizabeth A., dau of W. H. & M. F.; Feb 27, 1871 - Nov 6, ----.  
-----; d. --- --, 1951; age 69y. (Temporary marker)

TRIMMER:

Eveline, wife of Solomon; Feb 26, 1839 - Feb 4, 1900.  
Solomon H.; Oct 14, 1825 - Feb 24, 1895.



(Dunkard Cem)

WALTY:

Ella Clark; 1866 - 1946.

WETZEL:

Harry A.; 1896 - 1974.

Genealogical Notes - Dunkard Cemetery

BARRETT: Enos (1850-1936) born in Astoria, Ill.; son of Arthur and Hannah (Sears) Barrett, natives of Ohio.

Sophia Elizabeth (1855-1942), wife of Enos; born in Maryland; a daughter of Louis and Lydia (Lauden) Hess, natives of Md.

BURGARD: The Daniel Burgard family appears on the 1880 county census report; they were living in Bethel Twp.; members of the household included: Daniel, Catharine, Elizabeth, John, Susan, Mary E., Daniel W., Isaac, and Catharine. (NOTE: Ages for each individual were missing on that 1880 census report.)

Catherine (1845-1885), wife of Daniel; daughters included: Mrs. Henry Oakman of near Colchester; Mary D., who died of consumption in Nov., 1895; and another who also died of consumption in Jul., 1894.

CARSON: Pious E. (1830-1911); lived on section 7, Bethel Twp.; b. in Pa. and came to this county in 1868, from Fulton Co., Ill. Pious E. and family appear on the 1880 county census report; they were living in Bethel Twp.; members of the household included: Pius, age 50; Catharine, 53; John A., 21; Joseph E., 18; Andrew H., 15; Elizabeth E., 13; Jacob L., 10; and William I., 6.

Katharine (1836-1911), wife of Pious E.; born in Pa.; maiden name was Burgard. (NOTE: County court records, including her death certificate, indicate Mrs. Carson's correct name to be Catherine (Burgard) Corison.

CAVETT: Raymond (1907-1915); born at Colchester, Ill. Feb 19, 1907; a son of Arthur and Nora (Stump) Cavett; died in Macomb on Dec 19, 1915.

COON: James Lafayette (1861-1926); according to family history, Mr. Coon was nicknamed "Gen" due to the fact that he had a brother that had been a General during the Civil War; James L. was a son of Jacob Coon who lived in Chalmers Twp., this county; James and Mary C. Raymond were married in 1881.

Mary Catherine (1862-1956), wife of James L.; daughter of Gabriel Franklin and Sarah Ann (McMurtry) Raymond; Mary C. was a sister to John Uriah and Gabriel James Raymond; and to Sarah A. Downey and Margaret A. Wilson/Clark. Mary's parents are buried at the Pioneer Cemetery.

FERNOW: Howard B. (1907-1921); born in Lamoine Twp., Ill.; a son of James L. and Nellie Fernow; died in this county of a brain tumor.

(Dunkard Cem)

- FERNOW: James L. (1867-1925) was a son of Frederick P. and Ann Fernow; the family appears on the 1880 county census report and were living in Bethel Twp.; the household consisted of the following: Frederick P., 48; Ann, 48; Daniel D., 19; John W., 17; Joseph M., 15; James L., 12; and Virginia F., 7.
- HARLACHER: The William Harlacher family appears on the 1880 county census report; they were living in Bethel Twp.; members of the family included: William M., 29; Susan, 25; and Pius E., 1.
- HAPTSOOK: Martin L. (1844-1926); b. in Maryland.
- HAYS: Daniel (1807-1883) and Eliza (1810-1884) appear on the 1880 county census report; they were living in Bethel Twp., section 7. Daniel was born in Ohio and came to this county in 1849, from Ross Co., Ohio.
- HUMMER: Samuel L. (1830-1907); born in Pa.; died at Colchester, Ill.
- KLINE: Uriah C. (1820-1895) born in Pa., lived in Mifflin Co., Pa. prior to moving to this county in 1866; bought 200A south of Macomb and farmed remainder of his life. Mrs. Kline was the former Susan Rubel, native of Pa.; son, Hebern C., later lived in Hire Twp.
- Uriah and various members of his family are shown on the 1880 county census; they were living in Bethel Twp.; the household included: Uriah, age 63; Susanna, 52; Sylvester, 22; George W., 21; Alice C., 19; Barbara E., 16; Laura M., 15; Henry, 10; Charles E., 8; and Arthur B., 6.
- PARKS: The 1850 McDonough County census lists the following: John Parks, age 42, farmer; Heby, age 38, female; Joseph, 15; John, 13; Robert, 10; Elizabeth, 6; Heby, 2; and Bener, 35, farmer. All were born in Ohio.
- John, Jr. married Susannah King, in this county; he died in this county at age 68y 10m 13d; had been a resident of Ill. for about 42 years.
- Bener or Benner (d. 1889) appears on the 1880 county census report and was living with his family in Bethel Twp.; members of the household included: Mr. Parks, age 64; Lovina, age 45; Ellen J., 19; Mary B., 14; Annettie, 10; and Dorah V., 6.
- John M. (1837-1904); born in Ohio; died in Lamoine Twp., Ill.
- Mary Caroline "Callie" (1863-1921), wife of William E., born Apr 27, 1863; a daughter of Thomas & Susan (McCoy) Clark, natives of Ohio & Indiana, respectively. (Obit, in part, from The Macomb Journal, Dec 6, 1921): "Mrs. Calley Parks died at her late residence in Lamoine township Monday Dec 5, aged about 60 years..... interment in the Dunkard cemetery.....Deceased's maiden name was Calley Clark, and she was born near Fandon, living in this county all of her life. Some 30 years ago, she was united in marriage to William Parks, who died in 1914.....She leaves one son,

(Cont'd)

(Dunkard Cem)

PARKS: (Cont'd)

Everett, who resides at home; four brothers; Thomas, Sam, Luther, of Lamoine; Clay of Colchester, and two sisters--Mrs. Ella Walty of Colchester, and Mrs. Ethel Twaddle of Macomb."

REED: Matilda E. (1875-1926); born Jun 14, 1875, in Virginia; a daughter of A. C. and Cordella (Reed) Duncan, natives of Va.

Malinda (1847-1920), wife of George B.; born in Virginia; a daughter of Humprey and Lucy (Booth) Duncan, natives of Va.

STUMP: Dean (1909-1918) (Obit, in part, from The Macomb Journal, Jul 16, 1918): "Dean, the 9 year old son of Mr. and Mrs. Perry Stump who resides 9 miles south of Colchester, died yesterday afternoon.....of sarcoma of the leg.....funeral services..... at the United Brethren Church, three-quarters of a mile north of the residence; burial in the church yard.....Besides the parents....he is survived by one brother, Dale."

Daniel (1853-1916); born in Pa.; son of John and Sarah (Stine) Stump, natives of Pa.; died in this county. Daniel appears on the 1880 county census and was living with his parents and other brothers and sisters in Bethel Twp. Members of the family included: John, age 53; Sarah, 50; Amanda, 30; Daniel, 25; Franklin, 20; and Sarah, 11.

Susanna (1853-1917), wife of Daniel; born in Pa.; a daughter of Isreal and Sarah (Stump) Seitz, natives of Pa.; died in this county.

Isaac (1851-1930); born in York, Pa.; a son of Frank & Sarah Stump, natives of Pa.; first married to Sarah E., who died in 1895; second married to Jennie Raymond; she died in 1935. Isaac and family appear on the 1880 county census report; they were living in Bethel Twp.; members of the household included: Isaac, age 28; Sarah E., 24; John E., 4; and Charles F., 1. Charles and members of his family are buried at Scott Cemetery.

Jennie (1869-1935); maiden name was Raymond; second wife of Isaac Stump.

SWITZER: Minnie (1884-1905), wife of Albert R.; born in Illinois.

Malinda F. (1847-1926), wife of William H.; born in Ky., May 4, 1847; a daughter of Wilson and Mahalia (Turner) Lewis, natives of Ky.; died in this county on Apr 1, 1926.

William Harve (1851-1932); born in Fulton Co., Ill., Nov 10, 1851; son of Jacob S. Switzer, a native of Va.; died in this county on Dec 21, 1932.

WALTY: Ella (1866-1946); maiden name was Clark; a sister to Mary "Calley" (Clark) Parks.

Notes, Corrections, Additions, and Changes

## Old Plymouth Cemetery

Location: Lamoine township; SW $\frac{1}{4}$ , Section 30; about 2 miles north-east of Plymouth.

Remarks: This old cemetery, unused since the 1860's, lies about a half-mile west of Illinois Route 61 on privately owned property. Due to the many years of neglect, nearly all traces of this graveyard are now gone. The information listed below, obtained during a survey made in March of 1975, is far from complete because of the difficulties encountered in locating stones and/or their original locations. There are a number of field-stones, which at one time contained names, dates, etc. but are now totally unreadable. An estimated two dozen bases for stones were located (in addition to the ones listed below), however, no markers were found for the bases. The probability exists that some of those originally interred here were later moved to other cemeteries, but no records are known to prove or disprove that idea. Nearly all the memorials found during this registration were located under several inches of leaves and sod. A History of McDonough County, printed in 1885, makes mention of this graveyard as follows (pg. 662): "A burying ground is also located on section 30, on the farm of Dr. King, and contains about one acre. The first burial was a small child of Isaac Smith, about the year 1841. For a number of years it was used for interment purposes by the town of Plymouth. It is not in use at all, at present."

### CLINGENPEEL:

Ella Bell, dau of H. H. & S. M.; d. Jan 2, 1861; age 2y 9m 19d.

### CONVERSE:

Harriet E., dau of N. B. & C.; d. Aug 8, 1855; age 1y 11m 11d.

### DENNY:

Lydia M., dau of J. H. & E.; d. Nov 10, 1865; age 7y 9m 10d.

### ELLIOTT:

Joseph, son of J. & S. J.; d. Feb 8, 1855; age 2m 11d.

Anna, dau of J. & S. J.; d. May 12, 1863; age 1y 6m 19d.

### ? FRIEND ?:

Eliza E.; b. Apr --, ----; d. Apr --, ----. (Large, older-type stone nearly unreadable; accompanied with grave marker, "E E F")

### HOWELL:

William, son of B. & Mary; d. Feb 7, 1861; age ?1?y 11m 21d.

B. T.; d. Dec 23, 1849; age 9m.

### KING:

Edgar, son of W. M. & E. C. B.; d. Aug 17, 1855; age 10m 17d.

### MADISON:

Mary M., dau of E. W. & M. M.; d. Jan 26, 1867; age 6y.

-----, (unreadable).

?Nancy J.?.; d. Feb 23, 1864; age 61y.

### MC GUFFEY:

Nancy, wife of Doct.; Apr 9, ---- - Dec 3, 1863.

George B., son of ?P. Lyel? & Sarah; d. Jan 18, 1867; age 1y 28d.

(Old Plymouth Cem)

ROBERTS:

William Jackson, son of J. R. & E. J.; d. Sep 29, 1855; age 11m 9d.  
Juniattia, wife of S. E.; d. Dec 16, 1858; age 22y 1m 15d.  
Mary Jane, dau of S. E. & J.; d. Jan 10, 1858; age 7m 21d.

SINK:

Fliza Ann, dau of T. W. & L.; d. Feb 17, 1863; age 5y 6m 21.  
John William, son of Thomas W. & Luzena; d. Aug 9, 1855; age  
1y 1m 24d.

SMITH:

Leroy, son of J. & E.; d. Jul 3, 1847; age 4m 5d.  
Jane, wife of I. G.; d. Mar 21, 1866; age 53y.  
Isaac G.; d. Feb 23, 1853 in his 45th year.

SWISEGOOD:

Sarah E. J., dau of W. H. & M. E.; d. Dec 13, 1855; age 1y 1m 17d.

TENNEY:

Samuel, son of E. A. & C.; d. Mar 25, 1851; age 6d.

WIER:

-----ett; d. May 29, 1862; age 61y.

WHITTINGTON:

James E., son of R. A. & M. J.; d. Dec 21, 1856; age 2y 2m 5d.  
Emily A., dau of J. & A.; d. May 24, 1856; age 1y 26d.  
Eva, dau of J. A. & Angeline; d. Dec 10, 1866; age 5y 6m 9d.  
Emma, dau of J. A. & Angeline; d. Dec 13, 1866; age 2y 1m 21d.

UNKNOWNNS:

---ARSH; Isabella?, dau of J. & L.; d. Apr --, 1866; age 2y 4m 10d.

Grave markers containing following initials: "A E", "- B R", "M W".

Genealogical Notes - Old Plymouth Cemetery

CONVERSE: Harriet E.; daughter of N. B. & Catherine; N. B. was born in Ohio in about 1827; Catherine, in Pa. in about 1828. Harriet had a brother, Sanford, who was born in Mo. in about 1847. This family farmed in Lamoine Twp.

SMITH: NOTE: Local history accounts state that the first burial in this cemetery was that of a child of Isaac Smith's in 1841; no stone was located for this individual.

Leroy (1847-1847), a son of John H. and Emeline (Davenport) Smith. John, b. Jul 26, 1819, in Hopkins Co., Ky.; son of John, native of Va.; John, St. d. in 1825; John Jr. moved with his widowed mother to Va. in 1825; then to Sangamon Co., Ill., 1829; to this county, 1832; lived with a brother in Industry Twp. for a short time; in 1834, moved to Lamoine Twp. and started farming on section 30; then moved to section 20 in 1854; md. Mar 28, 1839, to Miss Davenport, a native of N. Y.; they had 10 children: Harriet, Morris C., Caroline, Henry, Paris, Leroy, Isaac G., Albert M., Romine, and John W.

(Old Plymouth Cem)

SMITH: (Cont'd)

John was accompanied to Lamoine Twp. with a brother, Byrd Smith; Byrd d. in 1880, in Plymouth, Ill.

John, father of Leroy, appears on the 1840 tax list as #885; he owned 40 acres in the SE $\frac{1}{4}$  of section 30; also \$18.00 worth of cattle, and \$10.00 in other property; taxes were \$ .94.

Byrd, brother of John, owned 80 acres in the NE $\frac{1}{4}$  of section 31, Lamoine Twp.; also \$140.00 worth of personal property.

Isaac G. (1807-1853); b. in Va., a son of John & Nancy (Garret) Smith; moved with parents to Ky. in about 1814; moved to Springfield, Ill., 1829; to this county, 1834, and settled on section 31, Lamoine Twp.; md. in 1834, to Jane Garret; cause of Mr. Smith's death was described as "a white swelling". I. G. Smith served as county commissioner during the 1840's and was a justice of the peace for several years.

Isaac G. appears on the 1840 county tax list as #883; he owned 120 acres in sections 30 and 31, Lamoine Twp.; also \$100.00 worth horses, \$43.00 cattle, \$10.00 clocks & watches, \$30.00 carriages, and \$110.00 in other property; residence was located in the west  $\frac{1}{2}$  of the NE $\frac{1}{4}$  of section 31, Lamoine Twp.

Isaac G. Smith appears on the 1850 county census as follows: Isaac G., age 42, farmer, b. Va.; Jane, age 37, b. Va.; all the following children b. in Ill.; Samuel R., 16; Jonetta, 14; Nancy, 12; Lensey, 13; John H., 2; and an infant, aged 6 mos.

SWISEGOOD: Sarah E. J.; daughter of Wm. & Margaret; both parents were natives of N.C.; Sarah was a sister to Mary (b. 1853), Bell (b. 1856), & George (b. 1859). All the children were born in Ill. The family lived in Lamoine township in the 1860's.

WHITTINGTON: James A., father of Emily, Eva, and Emma, was born in Ill. in about 1831; his wife, Angeline, was a native of Ohio, b. there in about 1835. Another daughter, Sarah J., was born in Ill. in 1858.

James E. was a son of Robt. & Mary Jane (Friend) Whittington who were married in this county on Apr 2, 1850. Mary Jane (Friend) Whittington was a daughter of Abel & Elizabeth (Wallace) Friend who were married in Springfield, Ill., on Dec 4, 1827.

Notes, Corrections, Additions, and Changes

## Friend Grave

Located in the SW $\frac{1}{4}$  of section 20, Lamoine township.

### FRIEND:

Elizabeth, first wife of Abel Friend; d. about 1848.

### Genealogical Notes

Abel and Elizabeth (Wallace) Friend were married in Springfield, Sangamon county, Illinois, December 4, 1827. Abel and Elizabeth moved to Lamoine Twp. around 1832 and settled on section 30; a year later he moved to section 20; his wife died there and is buried on the farm. In 1848, Abel sold this farm and moved to Iowa; he died there. Mr. Friend was a native of Tennessee. His father and other family members moved here in 1832 with Abel and some of them settling in section 28, Lamoine township. A brother of Abel, Charles, also lived on section 28, Lamoine township.

Children of Abel (b. 1803) and Elizabeth were: Catherine Ann; Mary Jane; Elias Andrew; James; Maria; George H. Children of Abel and his second wife, Nancy Combs were: Malinda Ellen; Cynthia Maggie; Elijah Allen; Edgar C. and Emma L.

### FRIEND MARRIAGES:

#### Sangamon Co., Ill. (early)

Abel Friend & Elizabeth Wallace - Dec 4, 1827

Matilda Friend & William Backinstoe - 1836

#### McDonough Co. Ill.

Mary Jane Friend & Robert Whittington - Apr 2, 1850

Maria Jane Friend & John S. White - Jul 26, 1857

John Friend & Rosanna Cave - Apr 10, 1837--had children:

Thomas J. and Hollie C.

Mary Friend & Jefferson Chitwood - Nov 15, 1836

Mary E. Friend & Wm. R. Sullivan - Oct 24, 1861

Thomas Friend & Malissa J. Stilwell - Feb 4, 1864

Hollie C. Friend & George Decker - Feb 20, 1872

Thomas J. Friend & Mrs. Mary A. McCoy - Oct 9, 1885

#### Schuyler Co., Ill.

Charles Friend & Nelly Tucker - Nov 26, 1830

James W. Friend & Sarah A. Martin - Dec 3, 1838

John Friend & Elizabeth Johnson - Apr 3, 1839

Rheumy Friend & James H. Spiva - Oct 6, 1831; divorced in

McDonough Co., Ill. in Sep 1859 term of court (Box 91).

Spiva children listed in case: Ellen 25; Amanda 23; Eliza

21; Mary 19; Abel 16; Anna Maria 14; Cynthia 11; Columbia

7; Charles 3. (NOTE: Not certain as to when these ages

apply, but assume 1859; the Spivas separated in 1855

according to testimony.)

Friend Grave

Schuyler Co., Ill. (Cont'd)

Polly Friend & Noah Jones - Jul 4, 1832

Ludica Friend & Peyton Herring - date uncertain, probably about 1833

Also in Schuyler County .....John and James Friend owned land together apparently as single men in the early 1830's (Sec 23 T 2 - R 3). Joseph and Elender Friend also owned land in this same section. Abel Friend owned land in section 15 T 2 - R 2... ..earliest date 1829.

The estate settlement of Strangeman Friend is in Schuyler county; he died Aug 23, 1834. Cornelius Swain, a relative, was the administrator. The relationship was not stated, just that he was related and the widow chose not to serve. In other information learned... there was a terrible cholera epidemic in July and August 1834 in Schuyler County so this may have been the cause of his death. In the 1830 Census of Morgan Co., Ill., Strangeman Friend is a young man with small children.

John Friend ran on Democratic ticket in 1854 for McDonough County Coroner.....defeated.

John Friend served as a Private, from McDonough County, during the "Mormon War" in 1846.

(NOTE: See Gibson Cemetery, Vol. V, for other Friend and Spiva burials.)

Notes, Corrections, Additions, and Changes