

"Crossroads of  
West-central  
Illinois"

**McDONOUGH COUNTY  
HISTORICAL AND GENEALOGICAL  
MISCELLANY  
1826 - 1976**

RURAL CEMETERIES  
OF  
McDONOUGH COUNTY, ILLINOIS  
VOLUME V  
BETHEL & CHALMERS TOWNSHIPS

**McDONOUGH COUNTY, ILLINOIS**

REF. 977.342 L567 V. 5  
Lester, Duane.  
Rural cemeteries of  
McDonough County, Illinois

MID-CONTINENT PUBLIC LIBRARY  
Midwest Genealogy Center  
3440 S. Lee's Summit Rd.  
Independence, MO 64055 **MGC**

MID-CONTINENT PUBLIC LIBRARY

RURAL  
CEMETERIES  
of  
MC DONOUGH COUNTY, ILLINOIS

Volume V

By Duane Lester  
Good Hope, Illinois

Printed by  
Schuyler - Brown  
Historical and Genealogical Society  
and  
The Schuyler Jail Museum

Faint, illegible text at the top of the page, possibly a header or introductory paragraph.

They were...  
two miles...  
long...  
at her...  
dressed...  
she was...  
no evidence...  
ing place...  
praised...  
ily burial...  
craves...  
1900's...  
new owner...  
graveyard...  
the court...  
burial...  
locations...  
Vandalism...  
stones...  
destroyed...  
stones...  
have been...  
While...  
destruction...  
responsible...  
at local...  
of years...  
Groundhogs...  
portions...  
ible because...  
have fallen...  
and debris.

"A monument is erected,  
not because a person died,  
but because a person lived."

## Preface

Within the boundaries of McDonough County, Illinois are more than a hundred cemeteries and gravesites ranging in size from a single burial site to the expansive Oakwood Cemetery at Macomb. Within these cemeteries are the remains of an estimated 40,000 individuals who have died since the first settler arrived here over 150 years ago. Graves of countless others are scattered over the countryside of McDonough County; but, exact sites of many of these resting places are no longer known for various reasons. During the early days of this county, there were obviously no central burial grounds; thus, a pioneer family having the misfortune of losing one of its members placed the deceased in a grave on a family homestead and erected a makeshift marker. A number of these family burial grounds later became public cemeteries, however, many of the grave sites soon became "lost". Crude wooden markers or a hand engraved stone soon succumbed to the elements and were never replaced; scores of families moved further west after staying in this area only a short time and the gravesites of their loved ones shortly became insignificant mounds of earth; a number of families passing through this vicinity suffered individual losses. A prime example of the latter is contained in a history of Bethel Township. In 1830, four children of an emigrant family died while enroute through McDonough County. They were buried near their places of death which occurred about two miles southwest of Fandon. All traces of those graves have long been gone. During the summer of 1834, a widow lady died at her home in northern Tennessee Township. Her coffin of dressed walnut lumber was built by a local cabinet maker and she was buried in the timber near her home. Within a few years, no evidence remained to indicate the presence of her final resting place. A family who created an excellent farm from the prairies a few miles north of Macomb, maintained a fenced family burial site for several years. This cemetery contained the graves of about 12 former family members. During the early 1900's, the farm changed ownership. Shortly thereafter, the new owner removed all the stones, took down the fence, and this graveyard became part of a cornfield. These are only three of the countless incidents involving the total disappearance of burial sites. At this time, it is impossible to determine the locations of hundreds of individual's graves in this county.

Vandalism is responsible for the destruction of many grave stones. Countless markers have been partially or totally destroyed. Inscriptions have been obliterated by shotgun blasts, stones have been broken into dozens of pieces, and some markers have been entirely removed from their original locations.

While weather-wear and vandalism accounts for most of the destruction of individual tombstones, neglect is directly responsible for the eventual deterioration of graveyards. Several local cemeteries have had no protective fencing for a number of years and the grounds have become grazing land for livestock. Groundhogs and other burrowing animals have undermined large portions of various cemeteries. Some areas are nearly invisible because of massive growths of weeds and brush. Stones have fallen, broken, and become completely covered with soil and debris.

The overall conditions of our county cemeteries is a pathetic case. While some grounds are well maintained, or at least partially kept-up by various families, many have been totally forgotten. This situation is appalling and should never have come about. Apparently, lack of time, expense, and most of all regard has brought about the present-day poor conditions of many of our rural cemeteries.

Genealogical notes accompanying the various cemetery listings were prepared from a wide variety of sources including: Local area history books and atlases; newspaper files; county, state, and federal archives; family histories. These notes were collected at random from readily available sources and little, or no attempts were made to search for material for more complete genealogies. These notes are presented only for the purposes of identification and/or clarification.

Every attempt has been made to present complete and accurate information. Readers will find errors and omissions. Others will not agree with portions of my findings; however, no information contained herein is based solely on assumption or guesswork. It must be remembered that this information has been prepared for use only as a tool for further research and that nothing must be taken as final and absolute.

The larger cemeteries contained in these volumes are accompanied by grave location charts. These charts in no way are intended to represent any professionally prepared plat or survey that may exist. Their preparation and presentation are solely for general location purposes.

When copying inscriptions from grave markers, it is sometimes impossible to read some portions of the engraving. Names, dates, ages, etc. that were found to be unclear or totally missing are indicated by the use of question marks or dashes, i.e., SPICER, James T., infant son of ?J.B. & S.J.?; d. -----; age -----. The letters or numbers enclosed in parenthesis following the inscription, indicate general location as indicated on the accompanying chart.

Abbreviations used are as follows:

b.	born	m.	months
Cav.	Cavalry	md.	married
Co.	County/Company	sec.	section
d.	died/days	twp.	township
dau.	daughter	y.	years
Inf.	Infantry		

Time and space prohibits proper recognition for all those individuals who gave assistance in preparing and publishing these volumes. Deep and sincere appreciation is extended to all concerned, especially to the following: My parents, Mr. and Mrs. Lloyd Lester, and my wife, Rose; and to Mrs. Lavina Walton and other members of the Schuyler County Historical and Genealogical Society for printing and binding the finished product. Thank you.

Duane Lester



Mc Donough County, Illinois

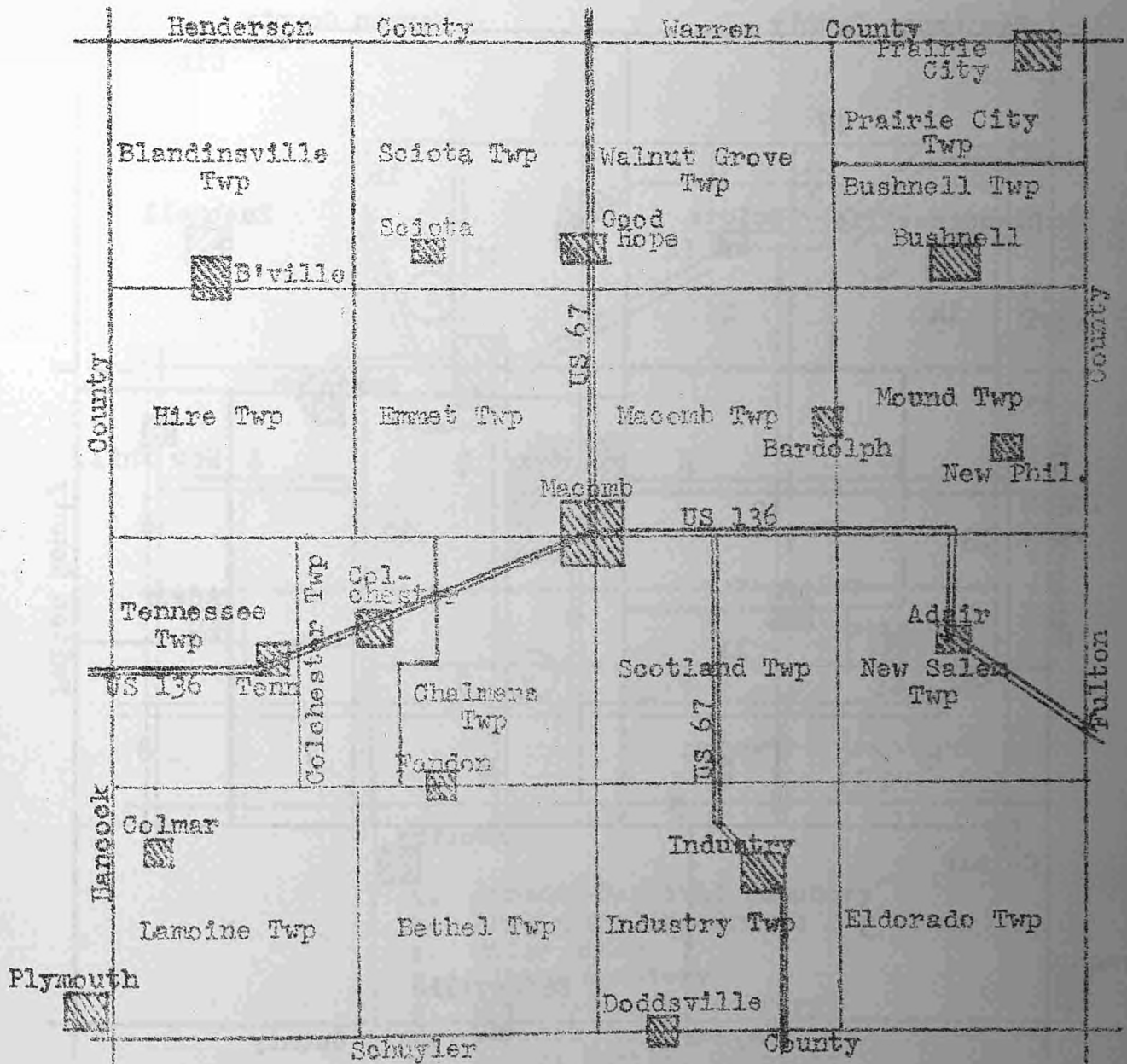

Areas covered by volumes I - XVII  
 "Cemeteries of McDonough County, Illinois"

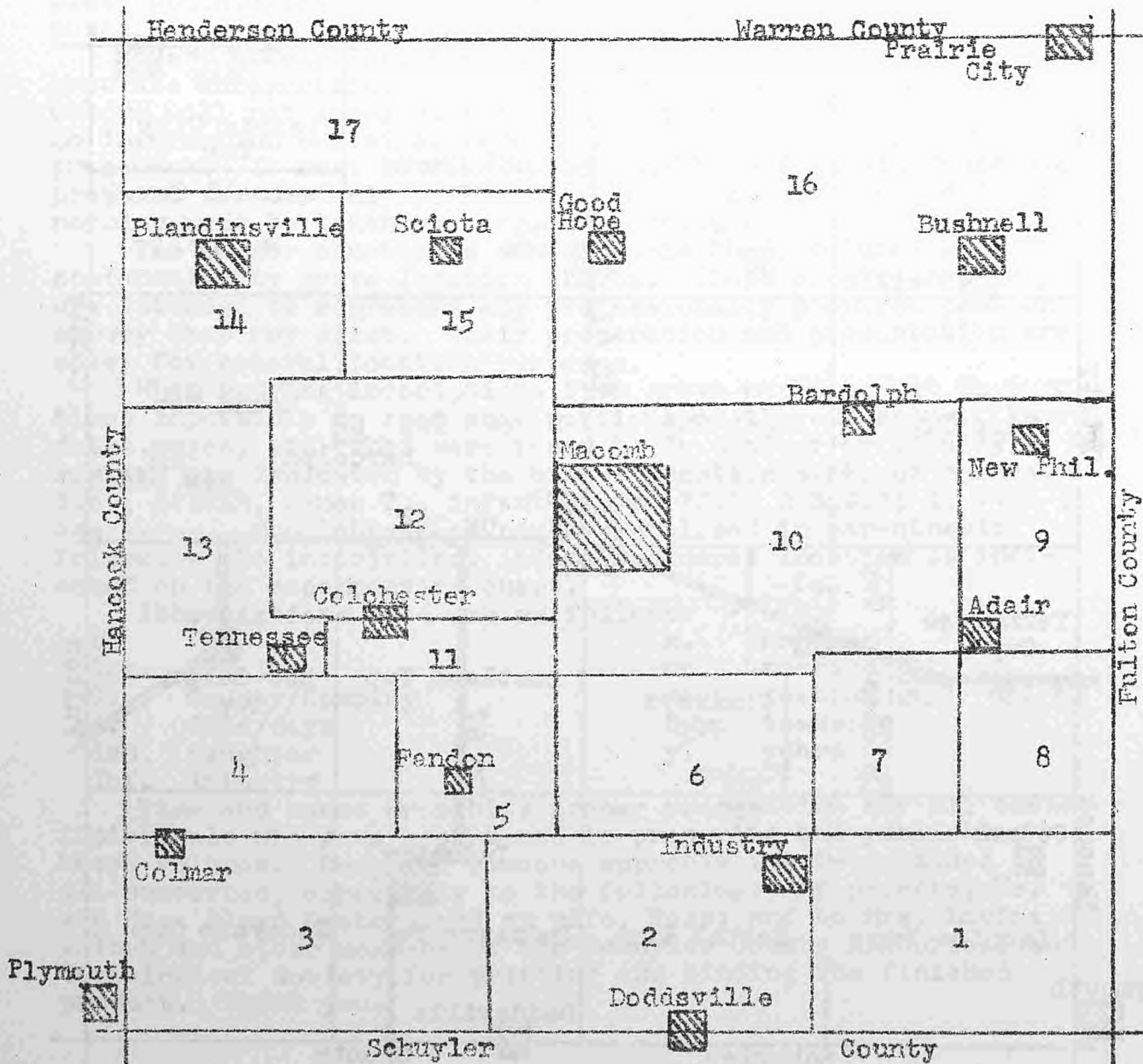



Portions of Bethel and Chalmers Townships

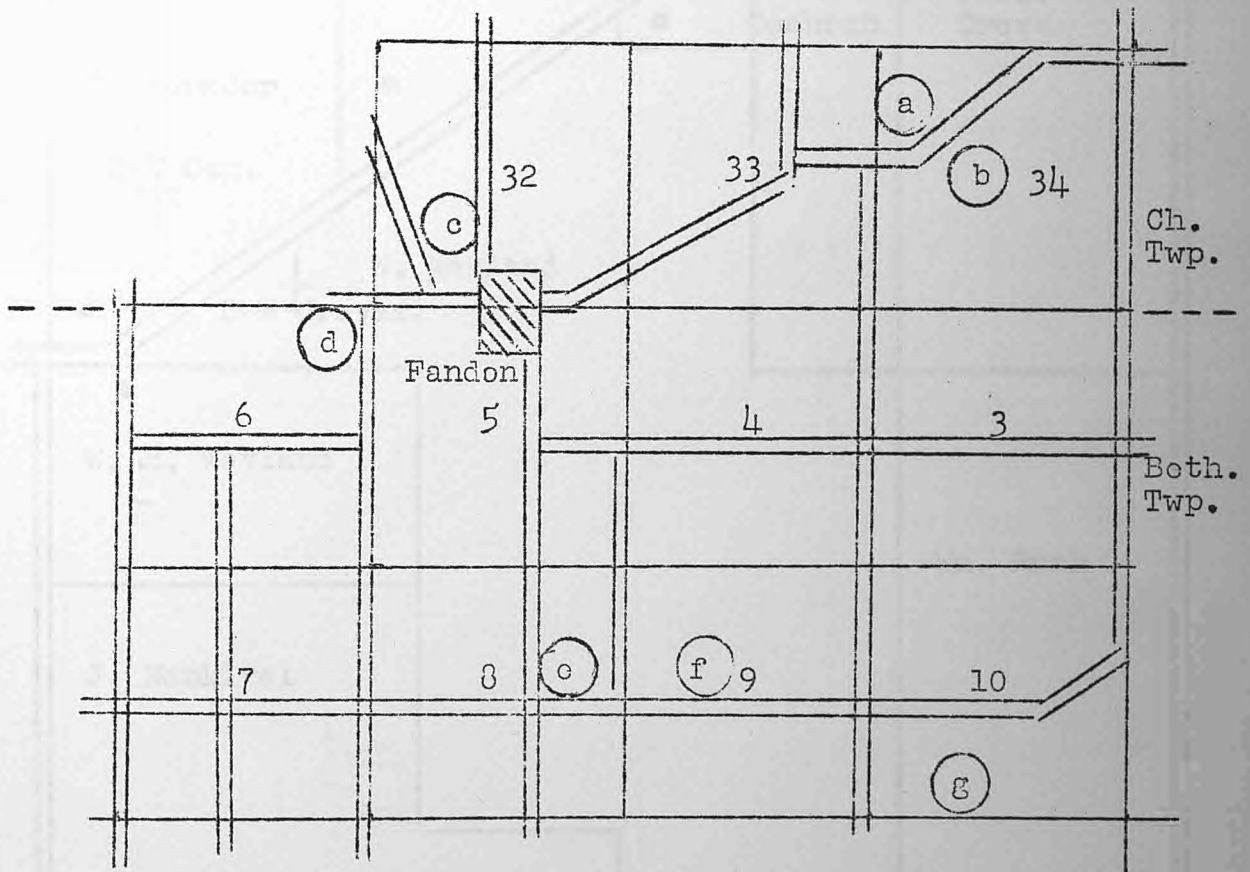

- a. Strader-Mankivel Cemetery
- b. Bowlin-Wayland Graves
- c. Miler Grave
- d. Gibson Cemetery
- e. Archer-Bethel Cemetery
- f. Waynack Cemetery
- g. Bethel Baptist Cemetery

Section 34

Chalmers Township, T5N R3W: 1871

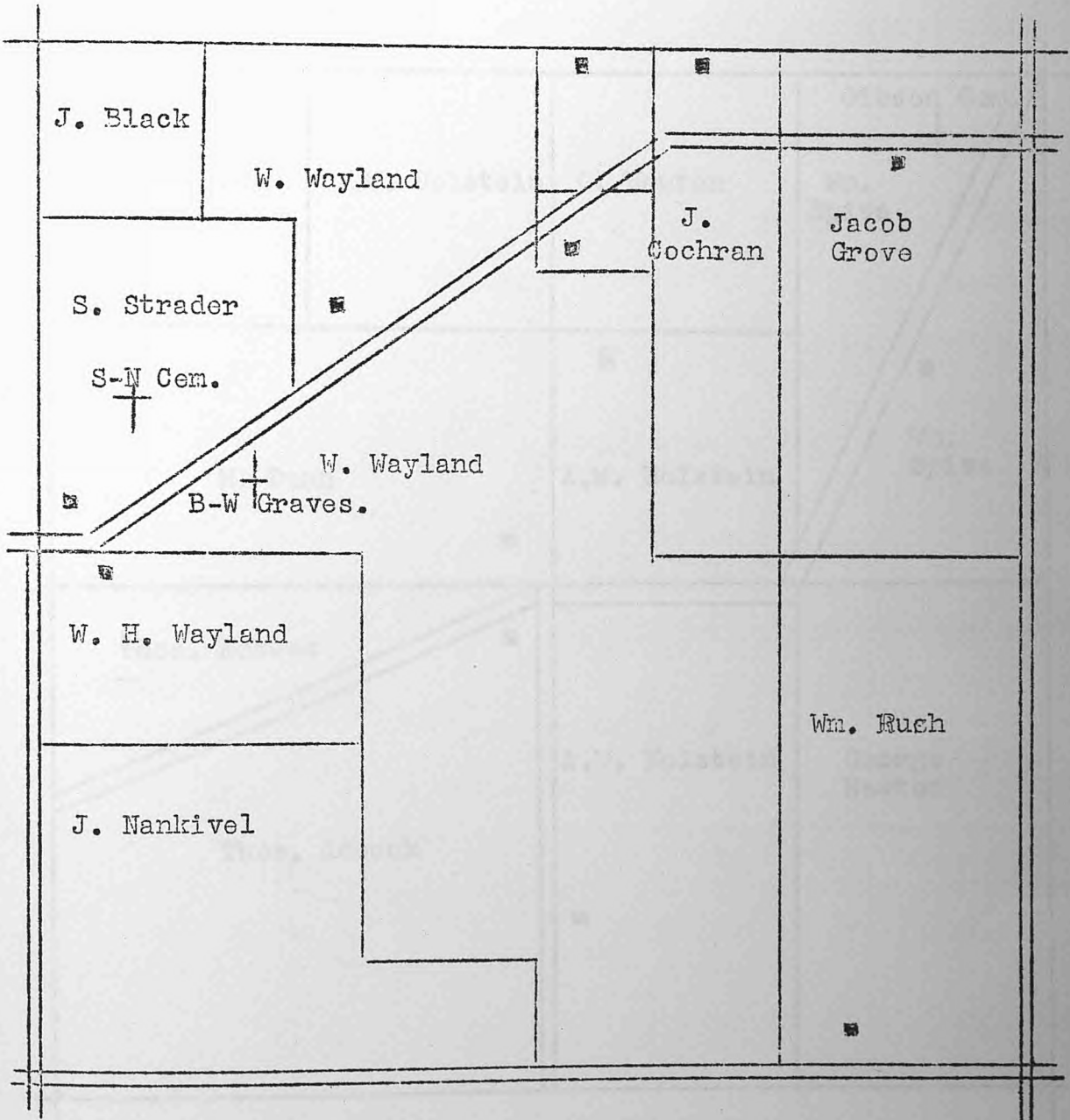

Section 6

Bethel Township, T4N R3W: 1871

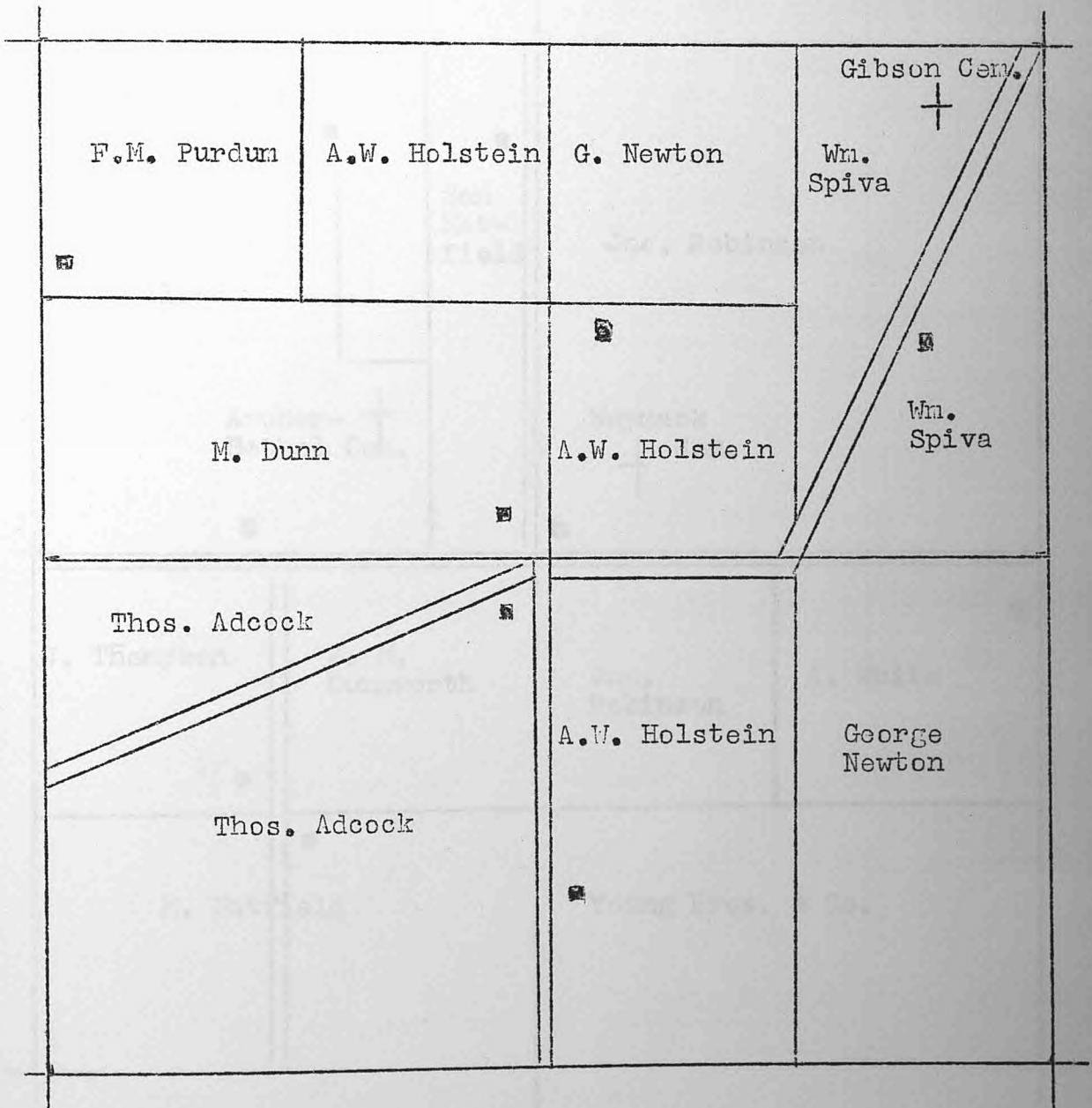

E $\frac{1}{2}$  Section 8 - W $\frac{1}{2}$  Section 9  
 Bethel Township, T4N R3W: 1071

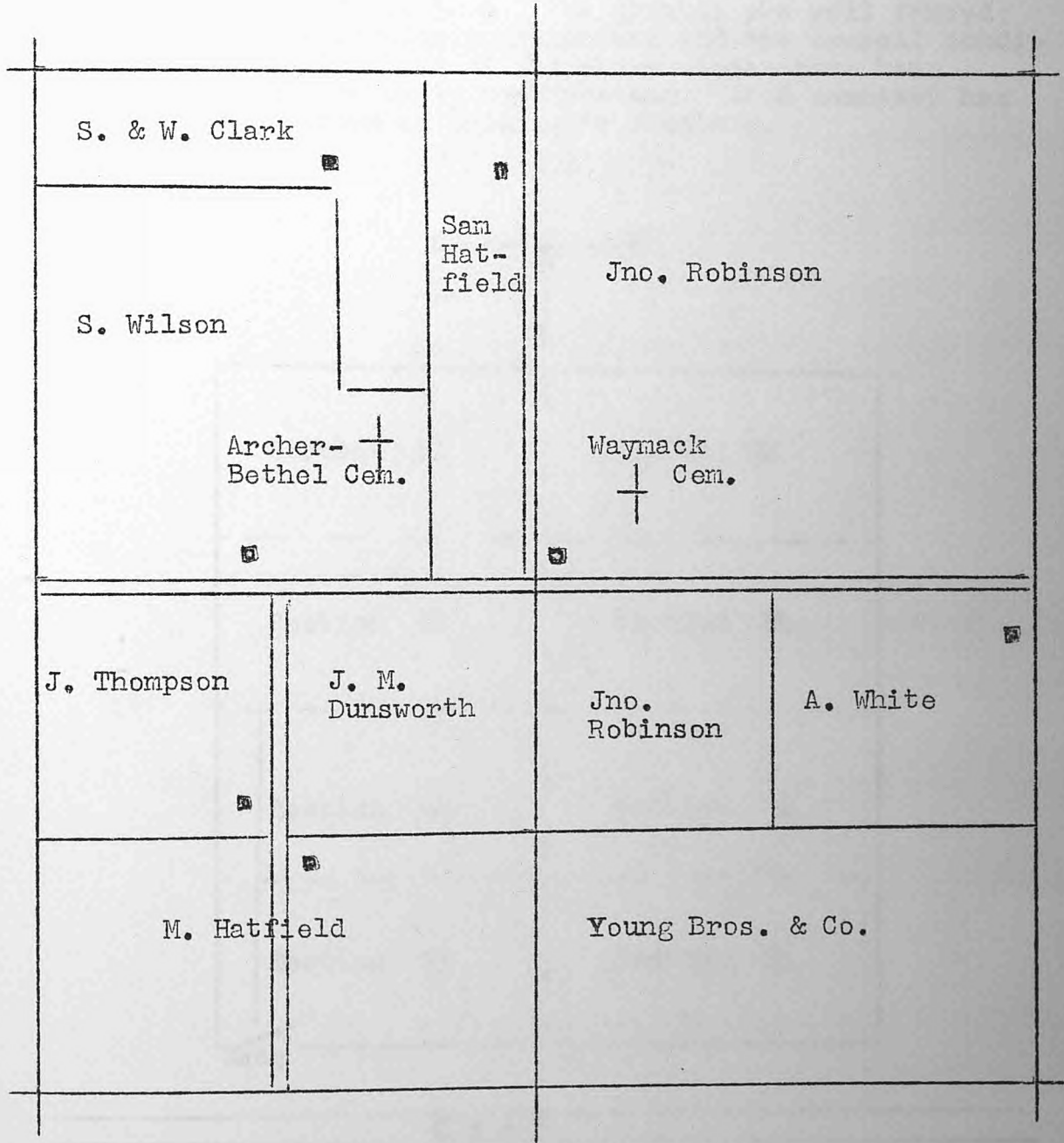

ARCHER-BETHEL CEMETERY

Location: Bethel township, NE $\frac{1}{4}$ , section 8; one and a half miles south of Fandon.

Remarks: This cemetery was originally two acres in size and contained 114 lots. The grounds are well fenced; the area is regularly maintained and the overall condition is good. Many of the older stones have been broken and are badly weather-worn. This cemetery has also been known as Sullivan's Cemetery.

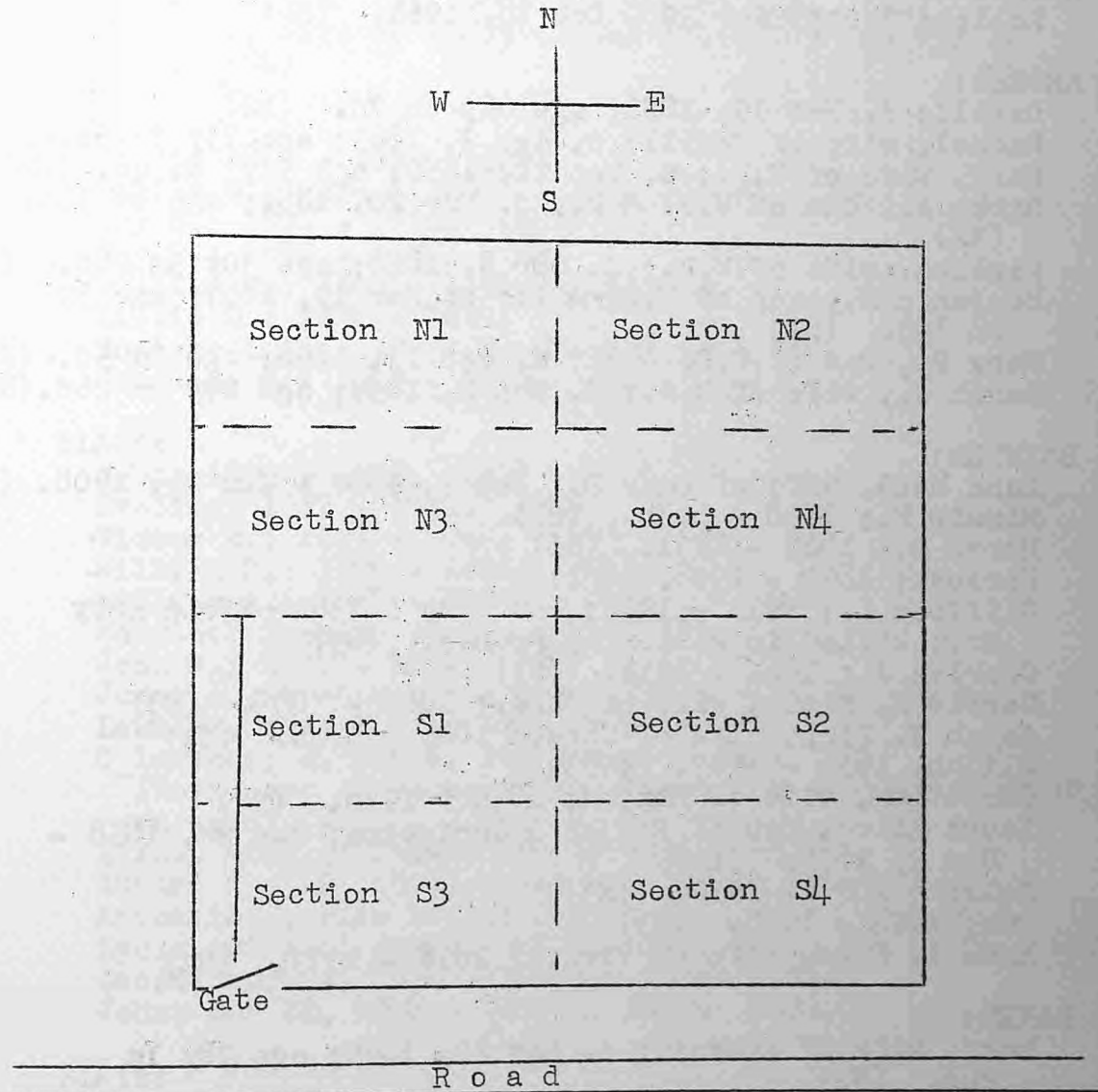

ALLEN:

Stephen W.; 1867 - 1951. (S1)  
Amanda C.; 1870 - 1933. (S1)

AMES:

Melissa J. Lane, wife of Oliver P.; May 3, 1842 -  
(no date). (S4)  
Oliver P.; Apr 11, 1842 - Jul 9, 1909. (S4)  
John P.; Apr 13, 1876 - Nov 22, 1904. (S4)  
Gertrude P. Clark, wife of J.P.; Oct 19, 1876 - (no  
date). (S4)

ANDERSON:

Rolland Scott; Apr 20 - Oct 14, 1964. (N4)

ARCHER:

Cavill; d. Nov 19, 1851; age 66y 9m 7d. (N2)  
Rachel, wife of Cavill; d. Apr 2, 1863; age 73y 7m 5d. (N2)  
Mary, wife of W.F.; d. Dec 21, 1850; age 33y 8m 2d. (N2)  
Sibbe A., dau of W.F. & M.; d. Mar 20, 1850; age 1m 15d.  
(N2)  
Paulina, wife of W.F.; d. Apr 8, 1848; age 30y 5m 26d. (N2)  
Benjamin E., son of W.F. & P.; d. Mar 19, 1847; age 3y  
6m 19d. (N2)  
Mary E., dau of W.F. & P.; d. Sep 13, 1848; age 7m 5d. (N2)  
Sarah J., wife of R.A.; d. Sep 2, 1859; age 29y 6m 26d. (N2)

BAINTER:

Lena Maud, wife of Omar D.; Sep 3, 1887 - Jun 26, 1908. (S1)  
Minnie F.; 1868 - 1948. (S1)  
Harve O.; 1865 - 1931. (S1)  
Forrest; 1890 - 1908. (S1)  
Clifford L.; 1911 - 1944; PFC Btry A 736th Field Arty  
Bn.; killed in action in France. (S3)  
Charles J.; 1862 - 1931. (S3)  
Carrie E. Blain, wife of Chas.; 1865 - 1875. (S3)  
Sarah E. Rigg, wife of Chas.; 1865 - 1935. (S3)  
Elijah; 1834 - 1907. (N#3)  
Christina, wife of Elijah; 1840 - 1930. (N3)  
Laura Alice, dau of Elijah & Christina; Jan 26, 1858 -  
Dec 2, 1878. (N3)  
Nelson; 1873 - 1959. (N3)  
Ada; 1874 - 1948. (N3)  
Emma L. Sims, wife of Virgil; 1898 - 1973. (N4)

BAKER:

Mary, wife of Ephraim; d. May 20, 1895; age 78y 1m  
24d. (N1)  
Ephraim; d. Feb 11, 1873; age 62y 6m 7d. (N1)  
John; d. Nov 16, 1874; age 29y 7m 5d. (N4)  
Sarah (See CLARK).

**BARKLEY:**

Henry; Nov 27, 1850 - Apr 22, 1925. (N2)  
Mary J.; May 23, 1851 - Oct 22, 1917. (N2)  
Infant son of H. & M.; d. Jun 20, 1884. (N2)  
George; Nov 7, 1812 - Feb 8, 1877. (N2)  
Catharine, wife of Geo.; Sep 13, 1816 - Dec 5, 1880. (N2)

**BARRETT:**

William T.; 1855 - 1920. (N3)  
Angeline; 1864 - 1938. (N3)

**BEEDEER:**

Job J.; d. Jul 29, 1886; age 64y 6m 28d. (N4)  
Eliza J., wife of J.J.; d. Sep 15, 1886; age 65y 2m  
1d. (N4)

**BIBLE:**

Grant; 1864 - 1930. (S2)  
Delila C., wife of Grant; 1869 - 1963. (S2)  
Ray S.; 1897 - 1916. (S2)  
Guy W.; 1892 - 1974. (S2)  
William W.; 1869 - 1953. (S4)  
Lillie D.; 1876 - 1919. (S4)  
Josiah; 1835 - 1897; Co E 142nd Ohio Inf. (S4)  
Caroline E.; 1842 - 1893. (S4)

**BLACK:**

John; 1873 - 1945. (S2)  
Evelina; 1877 - 1931. (S2)  
Victor E.; 1887 - 1940. (S2)  
William R.; 1894 - 1966. (S4)  
William A.; 1858 - 1953. (S4)  
Harriett Amanda; 1864 - 1952. (S4)  
John M.; 1860 - 1952. (S4)  
James A., brother of John M.; 1862 - 1943. (S4)  
Lawrence ; d. Feb 9, 1863; age 7m 27d. (N1)  
C larence; d. Feb 9, 1863; age 7m 29d. (N1)  
- (Twin sons of James & Mary Black; note obvious error  
on ages).  
Eliza, wife of James; (no dates). (N1)  
Abram; Sep 19, 1838; d. at age 64y 7m 10d. (N2)  
Arthalinda, wife of A.; Apr 4, 1842 - Aug 28, 1933. (N2)  
Lydia, wife of Jacob; Oct 24, 1812 - Aug 18, 1885. (N2)  
Jacob; Apr 23, 1808 - Nov 24, 1886. (N2)  
John; Mar 12, 1836 - Sep 11, 1908. (N2)

**BIAIN:**

Veda L.; d. ---; age 31y 3m. (N1)  
Mary L.; d. Aug 10, 188-; age 22y 17d. (N1)  
John; d. Nov 25, 1886; age 65y 9m. (N1)

BLAIN (cont'd):

Maggie E.; d. Oct 1, 1884; age 21y 5m 17d. (N1)  
Irene; d. ---; age 19y 2m 9d. (N3)  
Nancy; d. ---; age 24y 10m 1d. (N3)  
Carrie E. (See BAINTER).

BLOOMFIELD:

Peter C.; 1861 - 1930. (S4)  
Etta Myers; 1865 - 1940. (S4)

BOURELL:

Forrest May; d. Feb 4, 1893; age 11m 15d. (S3)  
Frankie; d. May 24, 1890; age 3m 26d. (S3)  
(Children of T.A. & M.R. Bourell)  
T. A.; Oct 2, 1857 - Sep 20, 1904. (S3)  
Martha; Jun 18, 1864 - Apr 5, 1933. (S3)  
Jesse R.; Oct 27, 1885 - Jan 22, 1952. (S3)

BOYD:

Elizabeth E. (See HOLSTINE).

BRUMMEL:

Addie M.; 1884 - 1950. (S2)

BURGARD:

Jane; 1839 - 1924. (N4)  
Jacob; 1834 - 1874. (N4)  
Samuel; d. Feb 5, 1867; age 17y 5m 5d. (N4)  
Jacob, son of S. & L.; d. Jan 19, 1867; age 2y 9m 16d. (N4)

CARNAHAN:

Matilda Elen; 1867 - 1948. (S3)  
William E.; 1870 - 1954. (S3)  
Tina May; 1891 - 1907; age 15y 6m 4d. (S3)

CAVETT:

Charles M.; b. 1891; d. Oct 11, 1918; Co B 121st Inf. (N4)

CLARK:

Reuben R.; Jun 10, 1832 - Apr 22, 1907. (S1)  
Hannah J., wife of R.R.; Jun 4, 1831 - Nov 11, 1905. (S1)  
L. D.; d. Oct 28, 1894; age 41y 6m 14d. (S3)  
Ruelann; 1853 - 1939. (S3)  
William O.; Dec 1, 1851 - Feb 7, 1932. (S3)  
Luda Walker, wife of Wm.; Oct 25, 1848 - Apr 27, 192. (S3)  
Infant; Nov 21, 1886. (S3)  
John P.; d. Oct 18, 1883; age 70y 4m 18d. (S3)  
Silas; 1845 - (no date). (S3)  
Emmaline, wife of Silas; 1843 - 1915. (S3)  
Angela Cooper, wife of Ira; 1871 - 1948. (S3)  
Ira Duane; 1870 - 1954. (S3)



CLARK (cont'd):

William; d. Aug 20, 1885; age 51y 7m. (N1)  
Sarah Baker; 1841 - 1915. (N1)  
Edward S., son of S. & S.J.; d. Dec 26, 1868; age  
2m 29d. (N1)  
Silas; d. Oct 23, 1882; age 57y 6m 19d. (N1)  
Martha E.; dau of L.D. & L.; d. May 21, 1862; age --. (N1)  
Lydia, wife of L.D.; d. Aug 26, 1867; age 52y 4m 7d. (N1)  
Milton; d. of pneumonia in military hospital at Nashville,  
Tenn., Dec 24, 1862; age 18y 7m 4d. (N1)  
Laura B.; dau of D.B. & E.E.; d. Dec 19, 1868; age 1m 1d.  
Eunice E. Robinson, wife of D.B.; Mar 27, 1836 - Apr 30,  
1902. (N1)  
Daniel B.; d. Feb 12, 1886; age 61y; Co A 1st Ohio Cav.  
(N1)  
Gertrude P. (See AMES).

CLEVINGER:

Mary C., wife of G.W.; d. May 19, 1872; age 29y 7m 17d. (N2)

COOPER:

Clara M.; 1885 - 1961. (S1)  
Frank C.; 1876 - 1963. (S1)  
John V.; Feb 14, 1842 - Feb 1, 1917; Corp Co I 103rd Ill  
Inf. (S2)  
Margaret, wife of John; Sep 12, 1835 - Sep 13, 1915. (S2)  
Angela (See CLARK).

DANIELS:

William S.; Oct 31, 1853 - Apr 18, 1901. (S1)  
Hannah M., wife of Wm.; Feb 24, 1854 - Nov 25, 1927. (S1)  
Pearl, dau of Wm. & Hannah; Nov 17, 1887 - Sep 26, 1898.  
William L.; Apr 30, 1894 - Mar 20, 1966; PFC Co C 54th  
Ammo Tn WWI. (S1)  
Gladys B.; Mar 29, 1893 - Apr 11, 1971. (S1)  
Ruth (See FINLEY).

DAVID:

Madora E., wife of J.E.; d. Jul 1, 1879; age 19y 2m  
7d. (N2)  
Emmie T., dau of J.E. & M.E.; d. Nov 16, 1878; age 6m  
16d. (N2)

DAVIDSON:

David C.; May 15, 1848 - Sep 16, 1908. (S1)  
Nettie E., wife of D.C.; Jun 6, 1841 - Oct 15, 1920. (S1)  
Hattie J., dau of D. & N.; Jan 9, 1874 - Mar 22, 1941.  
Jennie; Aug 3, 1882 - Sep 12, 1882. (S1)  
Baby; Aug 6, 1881. (S1)  
(Latter 3 were children of D.C. & N. Davidson)

DEPOY:

James; d. Dec 7, 1878; age 45y 3m 7d. (N2)  
Elisabeth A.; d. Jan 22, 1883; age 69y 3m 24d. (N2)  
Samuel; d. Oct 27, 1863; age 57y 2m 5d. (N2)  
Daniel; d. Feb 1, 1876; age 70y 5m 23d. (N2)  
Druzilla J. (See RIGG).

DIFFENDERFFER:

Dora L., dau of G.A. & A.E.; d. Dec 22, 1874; age 10m  
20d. (N2)  
Infant son of G.A. & A.E.; d. Jan 11, 1896. (N2)

DUNSWORTH:

-----, son of G.D. & L.F.; d. Sep 1, 1892; age 5m 4d. (S3)  
Melvin F., son of G.D. & L.F.; Dec 15, 1893 - Oct 2,  
1894. (S3)  
Martha M., wife of John; d. Dec 27, 1864; age 38y 8m. (N1)  
John M.; d. Dec 29, 1884; age 64y 2m. (N1)  
Jane, wife of James H.; d. Feb 10, 1860; age 51y 5m 27d. (N2)  
James H.; d. Aug 6, 1860; age 52y 1m 6d. (N2)  
Charles H., son of Thos. & Ad elia; d. Sep 11, 1878; age  
9y 6m 28d. (N2)  
William, son of J.T. & H.; d. Feb 17, 1875; age 1y 5m 2od;  
(N2)  
Charles W.; Mar 8, 1857 - Jun 20, 1877. (N2)  
Margaret A., dau of J.T. & H.; d. Mar 6, 1876; age 4y 24d.  
Peter Ausbury, son of J.A. & M.A.; d. Sep 27, 1862; age  
----. (N2)  
Dr. A. J.; d. Aug 19, 1861; age 26y --m 16d. (N2)  
Nancy, wife of Thomas M.; d. Oct 16, 1863; age 74y. (N3)  
Thomas, son of T.M. & N.; d. Apr 15, 1845; age 8y 11m  
15d. (N3)  
Mary J., dau of T.M. & N.; d. Oct 6, 1843; age 16d. (N3)  
Thomas M.; d. Oct 23, 1842; age 52y 10m 18d. (N3)  
Charles W., son of J.H. & J.; d. Sep 18, 1840; age 7m  
12d. (N4)

EHRHART:

Elbert; 1886 - 1919. (S2)  
Blanch M.; May 2, 1893 - Dec 1, 1913. (S2)  
Infant of C.E. & B.M.; (no dates). (S2)  
Jacob H.; 1860 - 1929. (S4)  
Anna B.; 1863 - 1927. (S4)  
Charlie L.; 1892 - 1905. (S4)  
Infant dau; d. 1894. (S4)  
Infant dau; d. 1891. (S4)

ELLIS:

Sarah J., wife of G. E.; d. Mar 21, 1888; age 26y 11m  
6d. (S3)  
George; 1855 - 1947. (S3)  
Ella Vance; 1871 - 1955. (S3)  
Albert; 1869 - 1954. (S3)

ELLIS (cont'd):

Kitty, wife of Albert; 1875 - 1962. (N3)  
Elsie May; 1911 - 1924. (N3)  
Robert; 1859 - 1933. (N3)  
Lafe; 1860 - 1927. (N3)

EWING:

Martha A., dau of W. & J.H.; d. Jul 8, 185-; age ---. (N4)

FEATHERLIN:

Elizabeth; d. Mar 8, 1898; age ---. (S3)  
Lottie, dau of G. & S.; Feb 5, 1887 - Mar 15, 1888. (S3)  
George W.; 1852 - 1930. (S3)  
Sarah E.; 1860 - 1930. (S3)  
Genieva G.; 1911 - 1921. (N3)

FERNOW:

F. P.; d. ---; age 78y 5m 19d. (S2)  
Ann, wife of F. P.; d. ---; age 76y 5m 8d. (S2)  
J. M.; 1864 - 1944. (S2)  
Ann, wife of J.M.; d. Apr 21, 1905; age 37y 1m 26d. (S2)  
Maymie C.; 1893 - 1966. (S2)  
Albert V.; son of F.P. & A.; d. Feb 3, 1869; age 18d. (N1)  
Viola May, dau of F.P. & Ann; d. May 14, 1877; age ---. (N1)  
John; Feb 4, 1839 - Aug 29, 1881. (N1)  
Elizabeth, wife of John; Nov 27, 1847 - Sep 17, 1881. (N1)

FINLEY:

Ruth Daniels, wife of Wm.; 1892 - 1927. (S1)

FLINT:

Viola B. Hagan, wife of G.E.; Mar 27, 1874 - Aug 27, 1894.  
(S4)  
William; Sep 2, 1858 - Jul 21, 1935. (S4)  
Melvira, wife of Wm.; May 5, 1855 - Aug 29, 1894. (S4)  
Ethel R., dau of Wm. & M.; Feb 8, 1890 - Nov 7, 1892.  
James; Feb 13, 1909 - May 12, 1913. (S4)  
Ora; 1897 - 1931. (S4)  
George; 1867 - 1931. (S4)  
Ella; 1872 - 1956. (S4)  
Ida S. Pierce; 1882 - 19---. (N4)  
Robert; 1876 - 1934. (N4)

FOWLER:

Louisa; 1865 - 1953. (N4)  
John; 1862 - 1933. (N4)

FREE:

Senora; 1859 - 1950. (S1)

FRISBIE:

Infant dau; d. Jan 22, 1878. (S3)  
Infant dau; d. Feb 6, 1879. (S3)  
Robert O.; d. Sep 22, 1876; age 2y 2m 14d. (S3)  
(Children of O.B. & E.J. Frisbie).

FUGATE:

Mary L. (See WEAR).

GALLAHUER:

Gracy Ann Wilson; Feb 26, 1888 - May 22, 1968. (S2)

GRIFFITH:

Sadie M.; 1892 - 1951. (S1)

Lyle E.; 1896 - 1974. (S1)

Grant; 1870 - 1958. (N3)

Ella; 1863 - 1929. (N3)

Freda S.; 1899 - 1923. (N3)

HAGAN:

John W.; 1848 - 1921. (S4)

Nancy E.; 1845 - 1934. (S4)

J. Elmer; 1877 - 1901. (S4)

Viola B. (See FLINT).

HAMILTON:

Urah Thompson; 1887 - 1917. (S3)

HAMM:

Joseph E., son of John B. & Sarah; Mar 15, 1880 - Dec 8, 1889. (S4)

HANTHORN:

Sarah, wife of Thos.; d. Apr 24, 1879; age 37y. (N4)

HARLACHER:

Alcortt, dau of Wm. & S.R.; d. Aug 13, 1877; age 11m 15d. (n4)

HATFIELD:

C. W.; 1859 - 1940. (S3)

Agnes; 186- - 1930. (S3)

Infant son of Elias & Mary E.; d. Jul 30, 1874. (N1)

Sarah; d. Mar 13, 1880; age 83y 11m 21d. (N1)

Samuel; d. Aug 2 5, 1877; age 79y 8m 19d. (N1)

HELMERICKS:

Margaretta; 1830 - 1900. (S4)

HELMS:

Donald E.; 1944 - 1945. (S4)

HENDRICKS:

Benjamin F.; (no dates); Co C 16th Ill Inf. (N1)

Georgie, son of J.B. & E.E.; d. Feb 18, 1878; age 2m 10d. (N1)

Josie, dau of J.B. & E.E.; d. Oct 17, 1865; age --7m 11d. (N1)

Haryet R., dau of F. & N.; d. Sep 23, 1866; age ---. (N1)

Sarah E., dau of E.P. & M.J.; d. Apr 2, 1870; age 8m 25d.

Mary J., wife of C.H.; d. Jul 11, 1871; age 24y. (N1)

HENDRICKS (cont'd):

Nancy, wife of F.; d. Nov 3, 1883; age 84y 7m. (N3)  
Fredrick; d. Feb 23, 1879; age 81y 6m. (N3)  
Harvey F.; 1842 - 1916. (N4) Co A 78th Ill Inf.  
Caroline, wife of Harvey; 1853 - 1934. (N4)  
Elyria; d. Feb 17, 1887; age 1y 1m 21d. (N4)

HENRICHS:

Fredrick; d. Feb 23, 1879; (see HENDRICKS; section N4)(N3)  
Nancy, wife of F.; d. Nov 3, 1883 (see HENDRICKS). (N3)  
Joseph Q.; d. Aug 25, 1848; age 23y 4m 20d. (N3)

HINRICHS:

Henry M.; May 27, 1901 - Mar 5, 1966. (S4)  
John R.; 1892 - 1918. (S4)  
Dena M.; Dec 7, 1899 - Jun 29, 1962. (S4)  
Johanna E.; 1906 - 1907. (S4)  
Louis H.; Dec 8, 1895 - Jan 6, 1935; N.J. Sgt US Army. (S4)

HOLSTINE:

William J.; 1853 - 1935. (S4)  
Emma J., wife of Wm.; 1858 - 1910. (S4)  
Elizabeth E. Boyd, wife of J.G.; 1890 - 1916. (S4)  
James G.; 1886 - 1937. (S4)  
Jessie C., wife of J.G.; 1887 - 1939. (S4)  
Elias; 1878 - 1943. (S4)  
Delila T., wife of Geo.; Aug 22, 1804 - Aug 19, 1879. (N2)  
George; Jan 13, 1802 - Nov 28, 1870. (N2)  
MaryAnn, wife of A.W.; 1828 - 1854. (N4)  
Mary (See MINER).

HORRELL:

Clarissa Kinkade, wife of James; 1835 - 1920. (S3)  
James N. N.; Oct 27, 1830 - Jun 28, 1890. (S3)  
Mary R., dau of J. & C.; Apr 22, 1863 - Dec 24, 1888. (S3)  
William H.; 1858 - 1925. (N1)  
Elizabeth; 1861 - 1946. (N1)  
Zelma; 1893 - 1905. (N1)  
Infant son; 1899 - 1900; age 22d. (N1)  
Infant dau; 1889 - age 1d. (N1)  
George W., son of J. & E.; d. Dec 21, 1863; age 2d. (N4)  
Leah, wife of J.L.; d. Jun 26, 1851; age 51y 8m 9d. (N4)  
James L.; d. Nov 2, 1841; age 46y. (N4)  
Anjunlina G., dau of J.L. & L.; d. Dec 11, 1841; age 18y 7m 18d. (N4)  
Harriet, dau of R.L. & M.A.; d. Jul 19, 1861; age 1y 7m. (N4)  
R. L.; Mar 19, 1825 - Jan 26, 1908. (N4)  
Mary A. Kinkade, wife of R.L.; Jun 21, 1833 - Dec 17, 1883.  
Clarence L., son of John D. & Anna; d. Aug 3, 1885; age 1y 5m 9d. (N4)  
M. Anna; 1860 - 1933. (N4)  
John J. D.; 1860 - 1927. (N4)  
Revy; 1902 - 1967. (N4)  
Clara R. (See RIDING).

HORTON:

Infant dau of Lee & Daisey; Feb 8 - Mar 1, 1909. (S1)

HOYT:

Enos R.; 1853 - 1934. (S2)

Arminda Lee Rippetoe, wife of Enos; 1859 - 1910. (S2)

Jessie; 1881 - 1925. (S2)

HUNT:

Sarah E., dau of T.W. & M.A.; d. Oct 12, 1838; age 3y  
9d. (N4)

JACKSON:

William A., son of W.H. & E.J.; Jun 27, 1883 - Jan 22,  
1903. (N3)

William H.; Aug 28, 1853 - Aug 24, 1906. (N3)

Eliza J., wife of Wm.; Sep 3, 1853 - 1926. (N3)

Edmun P., son of W.H. & J.; d. Oct 14, 1890; age 14y 2m  
22d. (N3)

Elizabeth, wife of C.E.; d. May 7, 1878; age 48y 25d. (N3)

Cyrus E.; d. Nov 21, 1875; age 53y 7m 6d. (N3)

JOHNSON:

Iva May, dau of J.M. & M.A.; d. Feb, 1869; age ---. (N1)

KINKADE:

Clarissa (See HORRELL).

Mary A. (See HORRELL).

KOST:

Charlie; 1874 - 1966. (S2)

Gladys; Jan 12 - Apr 10, 1902. (S2)

Simon; 1906 - 1907. (S2)

Simon; 1850 - 1927. (S2)

Phoebe Jane, wife of Simon; 1852 - 1926. (S2)

John; 1883 - 1961. (S2)

LANE:

Mary Jane; dau of Col. S. & S. Wilson, and wife of W. B.

Lane; d. Oct 20, 1864; age 25y 8m 27d. (N2)

William Henry, son of W.B. & M.J.; d. ---; age 1y 7m. (N2)

Melissa J. (See AMES).

LAWYER:

Samuel; May 10, 1837 - Mar 15, 1913. (S4)

Susan F., wife of Sam'l; May 28, 1844 - Jan 31, 1915. (S4)

Sarah J., wife of Sam'l; d. Apr 10, 1871; age 29y 3m 24d.

(N3)

Mary C., dau of S. & S.; d. Jan 17, 1863; age 2y 2m 28d.

(N3)

LOVETT:

Louisa, wife of John W.; d. Oct 2, 1862; age 18y 10m  
20d. (N3)

LOY:

Jacob, son of Hiram & Nancy B. ; Nov 18, 1848 - Aug 26,  
1864. (N1)  
Infant dau of H. & N.B.; d. Nov 29, 1856. (N1)  
Eliza C., dau of H. & N.B.; d. May 24, 1856; age 10m 7d.

MARTIN:

Gertie Ann, dau of S.T. & E.C.; d. Aug 6, 1881; age 9m (N3)  
James A., son of S.T. & E.C.; d. Apr 30, 1898; age 6y 6m  
15d. (N3)  
Sylvester T.; d. Oct 31, 1901; age 47y 9m 28d. (N3)  
Elizabeth C., wife of S.; d. Mar 27, 1928; age 72y 9m 13d.  
(N3)  
Tessie Ann; Jul 23, 1890 - Jan 9, 1972. (N4)  
Adriane E.; Apr 27, 1913 - May 23, 1929. (N4)

MASON:

Manie N.; Dec 3, 1865 - Nov 11, 1943. (S4)  
B. B.; 1860 - 1907. (S4)  
Bennie T., son of C. & E.; Jan 24, 1912 - Feb 6, 1912. (S4)  
Louise D., infant dau of Jess & Mary; b. & d. 1919. (N3)

MATHEWS:

J. S.; d. Feb 26, 1865; age 46y 9m 16d. (N3)

MATTHEWS:

Inez M., dau of S.T. & B.; d. Nov 29, 1887; a ge 6m  
20d. (N3)  
Leroy, son of S.T. & B.; d. Oct 8, 1880; age 3y 5m 5d. (N3)

MAYALL:

Dora; 1880 - 1961. (S1)  
Bessie; 1884 - 1960. (S1)

MC FADDEN:

Richard Lee; d. Dec 4, 1933. (N4)

MC KENZIE:

Ellen, wife of Joseph; d. Sep 4, 1864; age 33y 4m 9d. (N1)

MC MULLEN:

-----; 1843 - 1931. (S2)

MEYER:

Zera A., wife of M.C.; Nov 1, 1871 - Apr 11, 1905. (S3)  
Rubin Franklin, son of M.C. & Z.A.; May 22, 1893 - Jun 29,  
1893. (S3)  
Infant son of M. & Z.; d. Jul 25, 1899. (S3)

MINER:

Mary Holstine; 1877 - 1963. (S4)

MOORE:

John J.; d. Oct 30, 1867; age 51y 5m 26d. (N2)  
Infant son of J.H. & M.M.; d. Jan 22, 1868; age ---. (N2)  
Annie, wife of Edwin; May 24, 1841 - Jul 1, 1866. (N2)  
Annie E., dau of E. & A.; Feb 23 - Jun 17, 1865. (N2)

MULLETT:

Fred, Jr.; 1924 - 1930. (S1)  
Frederick William; 1884 - 1949. (S1)  
Anna M.; 1894 - 1958. (S1)  
Henry W.; May 25, 1919 - Oct 4, 1959; Sgt Co A 771st Tank  
Bn WWII. (S1)

MYERS:

Mable Clair; Jan 21, 1904 - Jul 28, 1921. (S3)  
Winifred W.; Jan 17, 1875 - Sep 24, 1966. (S3)  
Robert L.; Apr 18, 1874 - May 16, 1949. (S3)  
Adam; 1840 - 1924. (S4)  
Saporah E., wife of Adam; 1842 - 1932. (S4)  
Edith D.; Feb 28, 1912 - Jun 27, 1912. (S4)  
L. Blossom; May 26 - 28, 1911. (S4)  
George E.; b. & d. Feb 5, 1903. (S4)  
(Latter 3 were children of J.E. & Ora D. Myers)  
Joseph W., son of J.L. & A.; d. Nov 16, 1869; age 3y 11m  
23d. (N4)  
Etta (See BLOOMFIELD).

PIERCE:

Harry Lee; Jan 10, 1888 - Dec 21, 1969. (N3)  
Janey; 1856 - 1925. (N3)  
Aaron; 1856 - 1932. (N3)  
Ida S. (See FLINT).

POWELL:

Infant of D.G. & wife; (no dates). (S4)  
Walter S.; 1892 - 1930. (S4)  
David G.; 1865 - 1946. (S4)  
Ella R., wife of D.G.; 1871 - 1952. (S4)  
Infants of F.W. & wife; (no dates). (S4)  
Merry C.; 1907 - 1919. (S4)  
Lucinda M.; 1867 - 1950. (S4)  
Frank W.; 1862 - 1931. (S4)  
Jesse C.; 1891 - 1954. (S4)  
Amelia; d. Nov 7, 1899; age 69y 2m 1d. (N2)  
Samuel S.; Jul 9, 1829 - Jun 11, 1880. (N2)  
Rebecca E., dau of S. & A.P.; d. Oct 15, 1865; age 5y 1m.  
Florence I.; d. 1889. (N2)  
Edward H.; 1872 - 1948. (N2)

REDDING:

Leroy; Feb 20, 1917 - Dec 20, 1955. (S1)  
Leslie, a son of W.E. & B.A.; d. Nov 9, 1913; age 3d. (S1)  
Bessie A.; Apr 10, 1891 - Apr 4, 1931. (S1)  
William; Jan 15, 1888 - Dec 31, 1961. (S1)



REED:

Alice J., dau of G.R. & K.; d. Jun 3, 1862; age 8m 3d. (N1)

RIDEN:

Delmer C.; 1870 - 1956. (S3)

David; b. May 5, 1821; d. at age 72y 5m 4d. (S3)

Elamena, wife of David; b. Mar 28, 1842; d. Jun 21, 1925. (S3)

RIDING:

Clara R., wife of Elmer T.; dau of R.L. & M.A. Horrell;  
d. Jun 28, 1892; age 25y 10m 9d. (N4)

RIGG:

George E.; 1885 - 1963. (S1)

Dora L.; 1887 - 1957. (S1)

Howard, son of G.E. & D.L.; 1915 - 1917. (S1)

Ida M., wife of B.A.; d. Apr 1, 1890; age 21y 2m 16d. (S3)

Phebe L., wife of Jessie R.; d. Sep 4, 1890; age 52y 8m  
22d. (S4)

Thomas R., son of J.R. & P.L.; d. Apr 30, 1863; age 8y 3m  
9d. (S4)

Rillie, dau of E. & G.A.; d. Sep 17, 1888; age 6m 8d. (S4)

Infant son of E. & G.A.; d. Apr 25, 1892; age 28d. (S4)

William Z.; 1852 - 1945. (N2)

Druzilla J. Depoy, wife of Wm.; 1859 - 1928. (N2)

Zula M.; 1891 - 1893. (N2)

Perla M., dau of W.Z. & J.D.; d. Dec 12, 1880; age 1y 8m  
12d. (N2)

Mattie P.; 1879 - 1880. (N2)

Rola M.; 1877 - 1878. (N2)

Leonard; 1856 - 1932. (N4)

Louie A., wife of Leonard; 1861 - 1916. (N4)

Omar Milton; 1884 - 1962. (N4)

Joseph Ward; 1886 - 1929. (N4)

Dollie, wife of J. Ward; 1888 - 1973. (N4)

Sarah E. (See BAINTER).

RIPPETOE:

Arminda Lee (See HOYT).

ROBINSON:

O. G.; d. Jan 17, 1872; age 2y 8d. (S3)

J. C.; d. ---; age 2m 19d; buried at Mt. Moriah Cemetery,  
Pa. (S3)

Della A.; d. Feb 22, 1868; age 2y 5m 22d. (S3)

Samuel D. E.; d. Sep 10, 1886; age 54y 10m. (S3)

Hannah Louise, wife of S.D.E.; May 17, 1841 - Jun 6, 1911.

Della A., son of S.E. & H.L.; Jan 9, 1870 - Jan 17, 1872.

George D., son of S.E. & H.L.; Jan 9, 1870 - Jan 17, 1872.

M. E.; 1871 - 19---. (S3)

Gertrude; 1876 - 1956. (S3)

Benjamin E.; Mar 21, 1840 - Mar, 1910; QMSgt Co E 11th Pa  
Cav - Sep 9, 1862-May 10, 1865. (S3)

Sarah L. Schnatterly, wife of B.E.; Feb 2, 1843 - Aug 7,  
1920. (S3)

Robert S.; Apr 1, 1884 - May 27, 1905. (S3)

ROBINSON (cont'd):

Margaret Ann; Oct 17, 1846 - Dec 7, 1929. (S3)  
Vilasco C., son of J. & R.; d. Nov 20, 1876; age 4y 11m 27d. (N1)  
Lillie L.; 1865 - 1911. (N1)  
Robert F., son of J. & R.; d. Jul 31, 1873; age 24y 19d.  
Rebecca, wife of J.C.; Feb 5, 1811 - Feb 18, 1880; age 69y 13d. (N1)  
John C.; Nov 22, 1806 - Jul 22, 1888; age 81y 8m. (N1)  
Lizzie, dau of J. & R.; d. Mar 4, 1864; age 5y 2m 4d. (N1)  
Samuel E., son of J. & R.; d. Dec 2, 1863; age 2y 11m 27d.  
Andrew; Oct 9, 1834 - Nov 8, 1865. (N1)  
James A.; 1832 - 1923. (N1)  
Ruth, wife of James; d. Jul 29, 1874; in the 40th year of her age. (N1)  
Eunice E. (See CLARK).

ROWE:

Carol Ann, infant; Jul 7, 1950. (S4)

RUSH:

Anna L., wife of Allen; Mar 9, 1869 - Dec 21, 1906. (S1)

SCHNATTERLY:

Sarah L. (See ROBINSON).

SHELLEY:

L. Mabel, dau of W.H. & M.J.; Sep 20, 1884 - Jun 9, 1908. (S4)  
T. Earl, son of W.H. & M.J.; Jan 25, 1893 - May 22, 1907.  
J. Elbert, son of W. & M.J.; d. Sep 28, 1902; age 22y 11m 17d. (S4)  
William Guy; 1887 - 1972. (S4)  
M. Jane, wife of Wm. Harvey; Jan 24, 1856 - Mar 19, 1934.  
William Harvey; Mar 25, 1846 - Apr 20, 1921. (S4)

SIMS:

Eliza L.; Apr 18, 1861 - Jul 19, 1940. (N4)  
Charles M.; Jan 20, 1857 - Aug 10, 1942. (N4)  
John Roscoe; 1893 - 1971. (N4)  
Emma L. (See BAINTER).

SORENSEN:

Mary Louise; 1919 - 1971. (S4)

SPRING:

Rosa B.; 1872 - 1936. (S1)  
John W.; 1863 - 19--. (S1)

STARR:

Sarah J.; Sep 4, 1859 - Oct 12, 1907. (S2)

STRAIN:

Elizabeth, wife of C.H.; d. Feb 11, 1868; age 47y 3 m. (N1)

STUMP:

John; d. Dec 2, 1905; age 78y 10m 19d. (N4)  
Sarah, wife of John; d. Jan 27, 1895; age 64y 11m 21d. (N4)  
Levi, son of J. & S.; d. Dec 20, 1870; age 7y 2m 3d. (N4)

SULLIVAN:

---; children of J.M. & wife; (no dates). (S1)  
Joseph; Oct 24, 1826 - Dec 23, 1894; age 68y 1m 30d. (S3)  
Mary, wife of Joseph; d. Nov 20, 1897; age 68y 5m 27d. (S3)  
James, son of J. & M.; d. Jan 2, 1882; age 24y 11m. (S3)

THOMPSON:

Thomas A.; 1876 - 1943. (S2)  
John O.; 1871 - 1927. (S2)  
William V.; 1833 - 1911. (S2)  
Charles E.; d. Dec 24, 1883; age 24y 5m 15d. (N2)  
Mary M., wife of John; d. Nov 22, 1880; age 51y 7m 23d. (N2)  
Infant son of J. & M.M.; (no dates). (N2)  
Robert B.; 1892 - 1942. (N3)  
Minnie M.; 1894 - 1971. (N3)  
Wava Morine; 1919. (N3)

VAIL:

Harriet; 1850 - 1928. (S2)

VANCE:

Ella (See ELLIS).

VORHES:

John; d. Jul 17, 1878; age 56y 4m 26d; Co A 84th Ill Inf.  
Martha, wife of John; d. Dec 6, 1886; age 60y 11m 14d. (N1)  
Alice L., dau of J. & M.; d. Oct 3, 1864; age 8m 8d. (N1)  
Mattie, dau of J.H. & R.J.; Sep 30, 1878 - Aug 16, 1879. (N1)

WALKER:

Cyntha A., dau of P.T. & S.C.; d. Aug 28, 1856; age 24d. (N4)  
Sarah C., wife of P.T.; d. Aug 13, 1856; age 19y 5m 19d. (N4)  
Luda (See CLARK).

WEAR:

J. Mart; 1868 - 1948. (S1)  
Mary Belle; 1871 - 1938. (S1)  
Hugh E.; Jun 22, 1841 - Jan 16, 1916. (S2)  
Louisa C., wife of Hugh; Jun 16, 1842 - Mar 26, 1906. (S2)  
Laura M., dau of H.E. & L.C.; Dec 18, 1868 - Jul 8, 1906.  
James C.; 1884 - 1961. (S2)  
Nancy Louisa, wife of James C.; 1886 - 1941. (S2)  
Arthur C.; 1866 - 1946. (S2)  
Etta A.; 1868 - 1954. (S2)  
Lawrence Hugh; 1905 - 1906. (S2)  
James M.; 1845 - 1937; Co D 124th Ill Inf. (S3)  
Polly J.; 1848 - 1949. (S3)  
Andrew D.; Jun 16, 1821 - Feb 14, 1909. (S3)  
Mary L. Fugate, wife of A.D.; Dec 15, 1820 - Jan 18, 1909.

WEAR (cont'd):

Abbie; Sep 5, 1845 - Sep 23, 1894; age 49y 18d. (N3)  
J. B.; d. Mar 15, 1900; age 83y 9m 12d. (N3)  
Nancy L., wife of J.B.; Dec 10, 1836 - Feb 14, 1916. (N3)  
Mary G.; wife of J.B.; d. Mar 5, 1860; age 26y. (N3)  
John H., son of J.B. & M.; d. Jan 26, 1860; age 4m. (N3)  
Nancy E., wife of J.B.; d. Jan 12, 1853; age 30y 24d. (N3)  
George W., son of J.B. & N.E.; d. Nov 16, 1852; age 2y 4m 5d. (N3)  
Nell (See WILSON).

WILLY:

John; 1857 - 1923. (S2)

WILSON:

William N.; Feb 16, 1854 - Oct 18, 1923. (S2)  
Mary, wife of Wm.; Feb 27, 1856 - Oct 20, 1933. (S2)  
Charley, son of W. & M.; Oct 31, 1881-Apr 16, 1904. (S2)  
Roy A., son of W. & M.; Apr 21, 1886 - Oct 9, 1905. (S2)  
Mary J.; 1867 - 1950. (S4)  
Samuel; 1863 - 1933. (S4)  
Ralph D.; 1893 - 1953. (S4)  
Nell Wear; 1895 - 1944. (S4)  
Ray Clark; Feb 25, 1891 - Oct 20, 1956; Pvt USArmy WWI. (S4)  
Mary M.; 1897 - 1963. (S4)  
Frank J.; 1878 - 1962. (S4)  
Ada C.; 1879 - 1963. (S4)  
Samuel; (no dates); Lt Col 16th Ill Inf. (N2)  
Eli, son of Col S. & S.; d. at Hospital at Jeffersonville, Ind., Nov 20, 1864; age 20y 2m 22d; Co C 16th Ill Inf. (N2)  
William; (no dates); Co C 16th Ill Inf. (N2)  
Susan, wife of Sam'l; May 21, 1822 - Jun 6, 1884. (N 2)  
Gracy Ann (See GALLAHER).

WOLFE:

Lucy A., dau of P.F. & M.F.; d. Jul 13, 1873; age 2m. (N3)

Genealogical Notes - Archer-Bethel Cemetery

AMES: Melissa J., wife of Oliver; daughter of Isaac Lane; she was a sister to: Amanda, Lafayette, Alonzo, Thomas Benton, Isaac, Sarah Elizabeth, and Steven. After the death of her parents, the eldest 7 children were placed under temporary guardianship of Henry Venters in Schuyler Co.; Sarah & Steven Lane were placed under the guardianship of Alfred C. Wallace. The following obit appears in The Macomb Daily Journal, Apr 24, 1918:  
"Melissa J. Ames, daughter of Isaac and Mary (Jones) Lane, was born near Rushville, Schuyler Co., May 3, 1942. At the age of five, she was left an orphan and went to live with an uncle, John Lane, in Fulton Co., near Lewistown, with whom she lived until her marriage with Oliver P. Ames, March 1, 1866. They came to McDonough Co. in

AMES(cont'd): December, 1839, where they resided until the death of her husband, July 9, 1909. Since then she made her home with her daughter, Mrs. C. S. Wilson, in Bethel township, where she died April 19, 1918, aged 75 years, 11 months, and 14 days. She was the mother of three children: A lonzo E. died in infancy, and John P., who died in 1904, at the age of 28 years, leaving a wife and three small children. She leaves one daughter, Mrs. C. S. Wilson, seven grandchildren, and one great-grandchild."

ARCHER: Cavill (1785-1851) appears on the 1840 county tax list as # 656; he owned 80 acres in the E $\frac{1}{2}$  of the NE $\frac{1}{4}$  of section 8, Bethel Twp.; value of the land was \$5.00 per acre; he also owned \$250.00 worth of horses; \$190.00 in cattle; \$10.00 clocks & watches; \$100.00 wagons; and \$590.00 in other property; total taxes were \$7.70.

William F., husband of Pauline, appears on the 1840 county tax list as # 658; he owned no real estate; \$125.00 worth of horses; \$16.00 cattle; and \$50.00 in other property; taxes were \$ .96.

BAINTER: Elijah (1834-1907); his obit, in part, from the Macomb Daily By-Stander, Mar 16, 1907): "Elijah Bainter died at his home ten miles south of Macomb in Bethel township, Friday night at eight o'clock of pneumonia..... born January 15, 1834 in Fayette Co., Ohio. He was a son of Mr. and Mrs. Jacob Bainter. In 1857, he was married to Christina Farrow. In 1865, they came to Illinois, settling in Fulton Co. They came to McDonough Co. two years later and settled in Bethel township. He is survived by his wife and four sons and one daughter....Charles of Bethel township; Harvey and Clinton in Chalmers township; Nelson, at home; and Mrs. Clyde Black in Schuyler Co. He is also survived by 3 brothers and 1 sister."

BAKER: Mary, wife of Ephraim; b. in Ky.; maiden name was Goar; md. Mr. Baker in Ohio in 1835; died in Macomb; residence at the time of her death was 604 E. Murray St.

Ephraim; b. in Baltimore, Md.; married Mary Goar in Ross Co., Ohio in 1835; lived in Highland Co., Ohio before moved to this county in the 1860's. Mr. Baker served as a Pvt. during the Civil War with Co H, 73rd Ohio Inf. He and Mary had the following children: Levi, Charles, Lewis, William, John H., Mary Elizabeth (Mrs. J. W. Clark), Hannah, Sarah, and Net. While still residents of Ohio, the Clark family bought a 40 acre farm in section 17, Bethel township.

John (1812-1841) md. Abigail Dunsworth in this county on May 25, 1837; after Mr. Baker's death in 1841, his widow married Jacob S. Mathews on July 11, 1848.

BARKLEY: Henry (1850-1925) married Mary J. Black in this county in November, 1881.

BLAIN: John (Death notice, The Macomb Journal, Dec 2, 1886): "John Blaine, who came from Ohio several years ago, died this past week."

CARNAHAN: William E. (1870-1954), son of Barnett & Margaret A. (Sullivan) Carnahan; brother to J.M., Roscoe E., Martin H., George E., Mary Deborah, Annie, and Luella.

Tina May (1891-1907)(Obit, in part, from The Macomb Daily Journal, Mar 1, 1907): "Fandon, the little inland village a few miles south of Colchester, is undergoing a siege of diphtheria and one death was already resulted from the dread disease. Miss Tina, the 16-year-old daughter of Mr. and Mrs. Ed Carnahan, was stricken with a slight attack of the disease Sunday. By Thursday it had developed into the most malignant form and although every method known to the medical profession was used to save live it was of no avail and at 11:50 o'clock Thursday night she passed away. The family is under quarantine.....The diphtheria first appeared in the Carnahan family about 2 weeks ago, their little 4-year-old daughter being afflicted with it. She recovered and the family believed that the disease had been stamped out.....Besides her parents, she leaves three brothers and one sister....."

CLARK: Silas (b. 1845); b. in Ohio; moved to this county in 1863; lived on section 8, Bethel Twp.

Milton (1844-1862); enlisted in the army in Macomb on Aug 9, 1862; served as a private with Co A, 84th Ill Inf.; died at Nashville Dec 24, 1862.

Reuben R. (1832-1907)(Obit, in part, from The Macomb Daily By-Stander, Apr 27, 1907): "Ruben R. Clark was born in Ohio June 11, 1832; died at his home near Fandon...April 22nd, 1907. Deceased was married to Hannah Jane Black in 1851. To this union 12 children were born, four of these together with the wife and mother having preceded him.... He leaves eight children, a number of grandchildren, and a host of relatives....."

Daniel B. (1825-1886)(Obit, in part, from The Macomb Journal, Feb 18, 1886): "Daniel Clark, an old citizen of Fandon, died February 12th.....He is survived by his wife; he was a veteran of the Civil War. He was born in Ross Co., Ohio where he lived until 1849, when he went to California and remained there for 1-2 years. He then returned to Ross Co. where he lived until the outbreak of the war. He served with Company A 1st Ohio Cavalry. Afterwards, he came to McDonough Co. where he has since resided. In March, 1868, he married Miss Eunice E. Robinson, who survives. They had 1 child, a daughter, Laura, who died in infancy....."

CLARK (cont'd): John P. (1813-1883) (Obit, in part, from The Macomb Journal, Oct 25, 1883): "John P. Clark died at his residence in Macomb on October 18th, aged 71 years. He was born at Ross County, Ohio on May 30, 1813, where he grew to manhood and where, in 1836, he married Mary Near, who was also a native of the same county. In 1852, they moved to Illinois settling in this county. For many years he lived in Bethel Twp. He was the father of 13 children, 7 sons and 6 daughters, all of whom survived along with his widow. All his sons and 1 daughter were present at his funeral, with the others being in distant states."

DAVIDSON: David C. (1848-1908), b. Halland Co., Sweden; son of Christopher & Hannah (Anderson) Davidson, natives of Sweden; David, one of two sons born to his parents, went to sea at age 21 years; sailed throughout the world for 4 years; then moved to this county after living for a year in Warren Co., Ill.; Mr. Davidson lived in Emmet and Bethel townships; he md. here May 17, 1872, to Nettie C. Allison; they had 3 children: Hattie J.; N annie E. (Mrs. John L. Curtis); and Selma E. (Mrs. Fred R. Clark).

DEPOY: Daniel (1805-1876); b. in Va.; moved to this county in 1865, from Ohio; lived on section 7, Bethel twp.

James (1833-1878) served during the Civil War with Co A 54th Ohio Inf.; he was wounded during that service.

DUNSWORTH: John M. (1820-1884); b. in Johnson Co., Ill; son of Thomas M. & Nancy (Hall) Dunsworth; lived in the State of Tennessee from 1823-1830, when they returned to Ill.; moved to this county in 1832, and lived in Bethel Twp. His death notice, as follows, appears in The Macomb Journal, Jan 1, 1885): "John M. Dunsworth, one of the oldest settlers of McDonough Co., a resident of Bethel twp., died last Monday aged 64 years. He is survived by 7 children - 5 sons and 2 daughters, all grown."

James H. (1808-1860); b. in Tenn., Jun 20, 1808; md. there to Jane Baker, a native of Tenn.; moved to this county in 1830 and settled on section 8, Bethel twp. They had the following children: Mary A., William M., John A., Andrew J., James N., Abbie J., Jefferson W., Dimmon B., and Chas W. Mr. Dunsworth appears on the 1840 county tax list as # 678; he owned 80 acres in section 12, Lamoine Twp.; residence was at that location; he also had \$160.00 worth of horses; \$133.00 in cattle; \$10.00 clocks & watches; \$70.00 wagons; and \$228.00 in other property; taxes were \$3.91.

Thos. M. (1790-1842); b. in Washington Co., Tenn.; son of Chas.; md. Nancy Hall, daughter of Sam'l Hall, and moved to Ill. in 1819; returned to Tenn. in 1823; moved to this co. in 1832; lived on section 17, Bethel Twp. A daughter, Susan (Mrs. Augustus Lillard), moved to this co. in 1830.

FERNOW: F. P., b. in Ohio; moved to this county from Ross Co., Ohio in 1864; farmed on section 8, Bethel Twp.

HATFIELD: Samuel, b. in Pa.; moved to this co. from Fayette Co., Pa. in 1868; farmed on section 5, Bethel Twp.

Elias, father of an infant that d. 1874, was a Fandon merchant; moved here from his native State of Pa. in 1870.

HENDRICKS: Fredrick; b. Pendleton Co., Ky., Aug 17, 1797; son of George & Catherine (Boggs) Hendricks; moved to Ohio in about 1814; Fredrick worked there as a brickmason; md. there to Nancy Underwood; moved to this co., 1838, & built the first brick house in Lamoine Twp. in 1840; he and Nancy had the following children: Jane (Mrs. Wm. Erving); William; James B.; Joseph; Sarah (Mrs. John Archer - moved to Page Co., Iowa); George; Harriet (Mrs. N. Gibson); John W.; Rebecca (Mrs. T. P. Price - moved to Washington Terr.); Benjamin F.; Mary (Mrs. Hugh Wear); Harvey; Charley. Mr. Hondricks appears on the 1840 county tax list as #722; residence was in section 11, Lamoine Twp.; he owned 160 acres in sections 11 & 12, Lamoine; also had \$200.00 worth of horses; \$52.00 cattle; \$10.00 clocks & watches; \$30.00 wagons; and \$272.00 in other property; total taxes were \$8.42.

Nancy, wife of Fredrick; daughter of Borryman and Jane (Humphreys) Underwood, natives of Wales; Nancy, b. in Va.; moved with her family to Champaign Co., Ohio. (Nancy's obit, in part, from The Macomb Journal, Nov 8, 1883): "Mrs. Nancy Hendricks died at the residence of her daughter, Mary I. Wear, in Lamoine Twp. on November 3rd, aged 84 years, 7 months. She was born in Greenbriar Co., Va. on Apr 2, 1799, and at the age of 11 years, moved to Champaign Co., Ohio where she was married to Fredrick Hendricks by whom she had 14 children, all of whom but one reached maturity. In the autumn of 1838, with her husband and children, she came to Lamoine Twp., McDonough Co., where her husband died in 1879. Since that time she has lived with her youngest son, C. H., and with her daughter, Mary Wear. Eight of her children survive here one daughter resides in Iowa; another in Washington Terr., and a daughter and 4 sons in McDonough Co., and a son in Plymouth, Hancock Co....."

Georgio & Josie were children of James B. & Ellen E. (King) Hendricks; James B., the 3rd child of Fredrick & Nancy, was first married to H. A. Jackson in 1856; they had 2 children, Ellen & Eugone; Mrs. Hendricks died in 1860; James then md. in Oct., 1862, to Miss King, a dau of James & Mary (Thomas) King, natives of Ohio. James & Ellen had the following children: Flora Josie; Benjamin F.; Bessie; William; John; George; and Nora. James later farmed near Bardolph.

Caroline, wife of Harvey; daughter of Alonzo & Jane (Wilson) Harrington.



HENDRICKS (cont'd): Harvey F., son of Fredrick & Nancy; b. in Lamoine Twp., this co., Mar 29, 1842; enlisted in the army in 1862; disabled because of illness and discharged at St. Louis on July 18, 1862; re-enlisted in 1864; engaged in a number of battles and was with Gen. Sherman on the "March to the Sea"; wounded in his right hand at Atlanta; returned to Quincy, Ill. & mustered out in July, 1865; returned to this area; then, in 1867, moved to Montana & mined there a few months; returned home for a few years; moved to Dakota in 1872 and was a government carpenter there for 8 years; came back to this county, 1880; bought a Lamoine Twp. farm; md. Oct., 1879, to Caroline Harrington; had 3 children: Fredrick, Edith, and Esther.

HORRELL: Robert L., b. in Adair Co., Ky.; son of James & Loah (Carson) Horrell; moved with the family to Scott Co., Ill. in 1827; then to this co., 1835; lived on section 4, Bethel Twp.; Robt. md. on Feb 16, 1854, to Mary A. Kinkado, a native of this co.; had 6 children: William Hugh; John D.; Harriet L.; Clara R. (Mrs. E. T. Riding); Mary E.; and Robt. Jesso. Robert served as a co. supervisor, tax collector, and road commissioner.

James L. (1795-1841), b. in Va.; son of Oliver C. & Mary (Tate) Horrell, natives of Va.; moved to Ill. in 1827. Mr. Horrell appears on the 1840 county tax list as # 584; he owned \$140.00 worth of horses; \$186.00 cattle; \$10.00 clocks & watches; \$15.00 carriages; and \$225.00 in other property; no real estate; taxes were \$2.88.

Loah (1799-1851), wife of James L.; daughter of James & Catherino (Nosbit) Carson, natives of N. Carolina.

James N. N. (1830-1890), son of James & Loah; b. in Scott Co., Ill.; md. Feb 18, 1856, to Clarissa Kinkado; had 5 children: Julia A.; Mary R.; Ida M.; Eliza L.; and Martha J.

Zelma (1893-1905) (Obit, in part, from The Macomb Weekly Sentinel, Jul 8, 1905): "Sunday afternoon the death angel visited the home of Mr. & Mrs. Wm. Horrell of near Colchester and removed their 12-year-old daughter, Zelma. She had been sick but a few days, her disease being appendicitis. Her death leaves a void in the heart of father, mother, sister, and brothers....."

HUNT: Thomas W., father of Sarah E., appears on the 1840 co. tax list as #659; he owned no real estate; had \$150.00 worth of horses; \$56.00 cattle; \$10.00 clocks & watches; \$30.00 wagons; and \$236.00 in other property; taxes were \$2.41. Thomas W. Hunt md. Mary Ann Archer in this co. on Nov 23, 1834.

- LANE: William B., husband of Mary Jane, served as a private with Co C 16th Ill Inf. from Dec 9, 1861 to Aug 10, 1862; he enlisted at Colchester. After the war, Mr. Lane ran a confectionery in Colchester.
- LAWYER: Samuel (1837-1913), a son of William; Wm., a native of Pa.; moved to Brown Co., Ill. in 1835; then to this co., 1836; lived in Tonn. Twp.; moved to Appanoose Co., Iowa in 1856, then to Wayne Co., Iowa, where Samuel's mother died; Wm. then moved to Union Co., Iowa and died there in 1883; Samuel was a brother to: Elizabeth (Mrs. Hoagland); Dodmarius (Mrs. Wm. Broodon); George J.; Catharine (Mrs. Ethan Jarvis); John W.; William; and Susan.
- LOVETT: John, husband of Louisa, later lived in Hiro Twp., this county, and taught school in district 6 in the late 1870's.
- MASON: Benjamin B. (1860-1907), son of Burrow & Eveline (Hendrickson) Mason; Burrow, b. in 1814, in Cook Co., Tenn., a son of Adin & Mary (Warmact) Mason; Eveline, a native of Ohio. Benjamin was a brother to: Adin P.; Jesso H.; Eliza J.; George W.; William E.; Samuel P.; and Etta R.
- MATHEWS: J. S. (1818-1865). Jacob S., b. in the State of Tenn.; son of Benjamin & Polly (Shoopman) Mathews, natives of Tenn.; Jacob owned and operated a grist-mill at Fandon for several years; on July 11, 1848, he md. Mrs. Abigail (Dunsworth) Baker, widow of John Baker; they had 4 children, included a son, James M., b. 1849. Benjamin, father of Jacob, was b. in 1792; md. in Tenn. to Polly Shoopman; moved to Cass Co., Ill. in 1813, and to this co. in 1829; lived in Bethel Twp.; Benj. died in 1878. Jacob appears as #731 on the 1840 county tax list; he owned no real estate; had \$100.00 worth of horses; \$30.00 cattle; \$20.00 wagons; and \$35.00 in other property; taxes were \$ .93. His father, Benj., appears as #651, on that list; he owned no real estate; had a total of \$323.00 worth of personal property with taxes of \$1.62.
- MOORE: Edwin, husband of Annie, served in the army during the Civil War; he enlisted at Colchester and served as a 1st Lt with Co C 16th Ill Inf.; he was later promoted to Major and served with the 21st Mo Inf.
- MYERS: Adam (1840-1924), b. in York Co., Pa., May 18, 1840; son of John & Elizabeth Myers, natives of Pa.; John b. in 1821, and moved to Fulton Co., Ill. in 1853. Adam had the following brothers & sisters: Anna M. (Mrs. Henry Miller); Dina (Mrs. Sam'l Neighbours); Solomon; Elizabeth. After the death of Adam's mother, John md. Lydia C. Dressler; they had the following children: Jacob; Abraham. The 2nd Mrs. Myers died and John md. 3rd to Mary Ann Vance; they had 3 children: Lucy (Mrs. G. McLung); Alice (Mrs. Nathan Forkenraw); and

MYERS (cont'd): Charles. Adam lived in Fulton Co. till 1859, then moved to Morgan Co. and farmed there till 1864; then moved to Cass Co., Ill. and lived there 2 years; returned to Fulton Co.; moved to this co., 1871; md. in April, 1865, to Mrs. Elizabeth (Horr) Batsen. They had the following children: Willota, Ida May, Isodoro, James Martin, Robert Lee, John Emory, and Ella.

RIDEN: David (1821-1893), b. in Pa.; moved to this co. in 1869; lived on section 33, Chalmers Twp.

RIDING: Clara R. (1866-1892), wife of Elmor; daughter of Robert L. & Mary A. (Kinkado) Horrell.

RIGG: Howard (1915-1917) (Death notice, in part, from The Macomb Daily Journal, Apr 24, 1917): "The 2-year-old baby of Mr. & Mrs. George Rigg, residing southeast of Colchester, met with a fatal accident this morning when he fell into a tub of water and drowned....."

ROBINSON: John C. (1806-1888), b. in Maryland; son of James R. & Martha (McMullon) Robinson; md. in 1827, to Rebecca Elliott; lived in Fayette Co., Pa. before moving to this co. in 1855; lived on section 9, Bethel Twp.; had the following children: Martha, Becca, Mary, Thomas, John, Samuel, Robert, Benjamin, and Nancy.

James A. (1832-1923), b. in Pa.; moved to this co. from Adams Co., Ill. in 1862; lived on section 7, Bethel Twp.

Samuel D. E. (1831-1886) (Obit, in part, from The Macomb Journal, Sep 16, 1886): "Samuel E. Robinson died at his home in Bethel Twp. on September 10th, aged 55 years 10 months. He was born in Fayette Co., Pa., where he grew to manhood. When he was 30 years old he married Miss Hannah L. Anderson, who with 2 sons, aged 10 years and 10 years, survive. In 1864, they moved to Bethel Twp. He was a member of the Baptist Church...."

STUMP: John (1827-1905), b. in Pa.; moved to this co. from York Co., Pa. in 1865; lived on section 17, Bethel Twp.

SULLIVAN: Joseph (1826-1894) moved to this co. from his native Pa. in about 1835; married in this co. on Sep 27, 1848, to Mary Penrose. They lived on section 4, Bethel Twp.

THOMPSON: William Vance (1833-1911); b. Butler Co., Pa.; md. to Mary Ann Griffin in 1871; had 13 children: John Ora; Dolly; Ada May; Thomas A.; Robert; Grover; Theodore (moved to Oregon); Sylvia; Sadie (moved to Ky.); James Willard; Fred; Charles; Edward; and Cora. The family lived in Bethel Twp. William's sister, Martha, married John Kerr.

VORHES: John (1822-1878), b. in Ohio & moved here from there in 1855; farmed on section 32, Chalmers Twp. He served in the army from Aug 11, 1862 to Jun 8, 1865. Another Vorhos, George R., enlisted at the time and place as John; Geo. died while in service.

WEAR: Andrew (1821-1909), son of Hugh E. & Sarah (Duncomb) Wear; Hugh, Sr., b. in Washington Co., Tenn. in 1789; the family moved to Lamoine Twp., this co., in 1835; Andrew's parents, along with other members of the family, are buried at Scott Comotory. Mr. Wear appears on the 1840 county tax list as #915; he owned \$50.00 worth of horses; \$20.00 cattle; and \$11.00 in other property; taxes were \$ .41.

James M. (1845-1937) enlisted in the army in Lamoine Twp. on Dec 16, 1863; transferred to the 33rd Ill Inf.; discharged Nov 24, 1865.

John B. (1816-1900) appears on the 1840 county tax list as # 913; he owned \$50.00 worth of horses; \$39.00 cattle; and \$12.00 in other property; taxes were \$ .51.

WILSON: Samuel (Sr); son of John & Jane (McComsey) Wilson; b. Mar 17, 1817, at Mechanicsburg, Ohio; John, b. in 1781, in Greenbriar Co., Va.; moved to Ohio & md. there on Dec 20, 1809, to Miss McComsey; Jane was b. in Harrodsburg, Ky. in 1787. John & Jane Wilson had 7 children: Melissa, Margaret, Samuel, John, Eli, Jane, and Mary Ann. The family moved to this co. in 1835, settling in Bethel Twp.; John, father of Sam'l, died in 1843; Jane, died in 1861. Samuel md. Susan Edmonston in this co., Nov 30, 1837. They had 10 children: Mary Jane, Annie, William, Eli, Zachary T., Nicholas E., James E., Samuel, Laura, Lizzie, and Edwin M. Samuel, Sr. was county assessor in the 1840's. In 1850, Samuel and Susan and their children were living in Bainbridge Twp., Schuyler Co. in the James Edmonston household. Sam'l Wilson appears on the 1840 county tax list as # 630; he owned \$75.00 worth of horses; \$20.00 cattle; and \$100.00 in other property; no real estate; taxes were \$ .98. At the beginning of the Civil War, Mr. Wilson formed a company of men and was later made Lt. Col. in the 16th Ill Inf.; he was released from active duty on Nov 14, 1862, because of ill health; he was elected county sheriff in 1866; in 1881, Mr. Wilson moved to Peoria, where he was employed by the federal government.

Susan (1822-1884), wife of Sam'l, was a daughter of James & Polly Edmonston; her father was born in N.C. and in 1850 was farming in Bainbridge Twp., Schuyler Co.; her mother, Polly, was born in S.C. in about 1792; Susan had a sister, Polly G., born in Iowa in about 1827, and a brother, Joel, born in Iowa in 1830. Susan's obit appeared in The Macomb Journal, Jun 12, 1884. It reads, in part, as follows:

WILSON (cont'd): "Mrs. Sam'l Wilson died at her home in Fandon last Saturday, June 6, 1884, aged 63 years. She was born Susan Edmenston in Dubois County, Indiana in 1822. When she was 8 years old she came with her parents to this county and settled in Middletown (now Fandon). Before she was 15 years old, she married Samuel Wilson who survives. Most of her life has been spent in the area where she died except for a few years residence in Kansas and two in Macomb. She was the mother of 10 children, 7 sons and 3 daughters.....Her husband and 3 sons served in the Civil War....."

Notes, Corrections, Additions, & Changes

## BAPTIST CEMETERY

Location: Bethel township; SW $\frac{1}{4}$ , section 10. Two miles southeast of Fandon.

Remarks: Very little remains of this cemetery at the present time. The general area has been used as a pasture for a number of years and the perimeter of the original grounds cannot now be established. The few remaining stones that were located during this 1975 survey were broken and scattered over about a half-acre of ground. A Baptist Church was organized at this location in November, 1831, and a log building was erected in about 1832. Two and one-half acres were set aside for church and cemetery grounds. This tract is situated about a quarter-mile east of a public road and is now on privately owned property. In about 1875, the organization rebuilt their church about a mile and half west of this original site.

### ARCHER:

Lizzio; d. Feb 17, 1863; age 11m 23d.

Willio; d. Dec 10, 1858; age 1m 5d.

(Above were 2 children of J. & S. Archer)

### DUNSWORTH:

Mary A. Kerr, wife of S.; d. Jul 31, 1887; age 19y 2m 20d.

### KERR:

John B.; d. Jul 9, 1873; age 38y 8m 20d.

Alexander, son of John & Mary; d. Apr 8, 1883; age 21y 5m 16d.

Mary A. (See DUNSWORTH).

Lizzie V. (See THOMPSON).

### MATTHEWS:

Hannah A.; d. Sep 3, 1858; age 18d.

Silvo....; d. Sep 7, 1862; age 1y 7m.

(Children of G.W. & Mary A. Matthews).

Jacob S.; d. May 12, 1858; age 45y 6m 24d.

### OSBORN:

Francos, wife of J.; d. Jul 16, 1870?; age ---.

### THOMPSON:

Lizzie V. Kerr; d. Feb 19, 1889; age 22y 6m 17d; wife of F.L.

Charles, son of F.L. & L.V.; d. Sep 6, 1887; age 16 9m 21d.

### WHEELER:

Nathan; d. Mar 11, 1850; age 30y 17d.

Charles M., son of J.D. & M.J.; d. Oct 1, 1856; age 1y 1m 13d.

America K., son of J.D. & M.J.; d. Jun 12, 1851; age 1y 1m 27d.

John L., son of T.C. & H.; d. Aug 21, 1851; age 6m 7d.

Genealogical Notes - Baptist Comotory

ARCHER: Lizzio & Willie were children of John & Sarah (Hondricks) Archer, who later moved to Page Co., Iowa.

DUNSWORTH: Mary A. was a dau of John & Martha (Thompson) Kerr.

KERR: John B. (1834-1873), b. in Pa.; son of John & Jane (Black) Kerr, natives of Pa.; John, Jr. moved to Ill. in about 1855; remained here 3 years; then returned to Pa. and md. there to Martha Thompson; Martha was a native of Butler Co., Pa.; they were md. July 4, 1859; returned to this county in about 1867; lived in Bethel Twp.; had 7 children: Alexander; William C.; Nancy J.; Francis E.; Morry A. (Mrs. S. Dunsworth); Elizabeth (Mrs. F. L. Thompson); John R.; and George T.

THOMPSON: Lizzio V., daughter of John B. & Martha (Thompson) Kerr.

WHEELER: John (d. 1851) was a son of Train C. and Hannah (Mathows) Wheeler. Mr. Wheeler was born in N.C. in about 1824, and moved to this State in 1850; he married in McDonough Co. to Hannah Mathews on Feb 20, 1850; they then lived in Eden Twp., Schuyler Co. Mrs. Wheeler was born in Ill. in 1830.

Notes, Corrections, Additions, & Changes

## BOWLIN-WAYLAND GRAVES

Located about a half-mile southeast of the Strader-Nankivol Comotery in Chalmers township, are the stones of three individuals listed below. This small burial ground is located on the south side of a country road, about two miles east of Fandon. The grounds are completely fenced. Neighborhood sources state that this area was once known as the Riden Graveyard. In 1871, W. Wayland was indicated as the owner of the property on which these stones now stand. These three graves lie in the NW $\frac{1}{4}$  of section 34, Chalmers township.

### BOWLIN:

Mary Adlino, dau of J. & A.; d. Feb 16, 1872; age 10y 3m 1d.

### WAYLAND:

Wesley; d. Jul 25, 1874; age 77y.

Lucinda; d. Jun 28, 1870; age 61y.

## Genealogical Notes

WAYLAND: Wesley moved to this county in about 1832 and lived on section 34, Chalmers township. He moved here from Carroll Co., Ky. He appears on the 1840 county tax list as # 579. He owned no real estate at that time; had \$230.00 worth of horses; \$20.00 cattle; \$100.00 carriages; \$190.00 worth of other property; and had \$100.00 cash loaned out. His total taxes were \$3.20. On page 60, Clarkes, "History of McDonough County", 1878, the following item appears: "In the year 1836, Wesley Wayland came before the County Commissioner's Court and stated that he had given a certificate of freedom to a certain negro woman whom he had brought with him from Kentucky a few years previous, for the purpose of acting as nurse to his invalid wife. We believe Mr. Wayland had been taxed on this species of property since 1832, and had reached the conclusion it didn't pay."

## Notes, Corrections, Additions, & Changes



GIBSON CEMETERY

Location: Bethel Township; NE $\frac{1}{4}$ , section 6; one-half mile west of Fandon.

Remarks: The grounds are completely fenced and regularly cared for. This cemetery is in excellent condition.

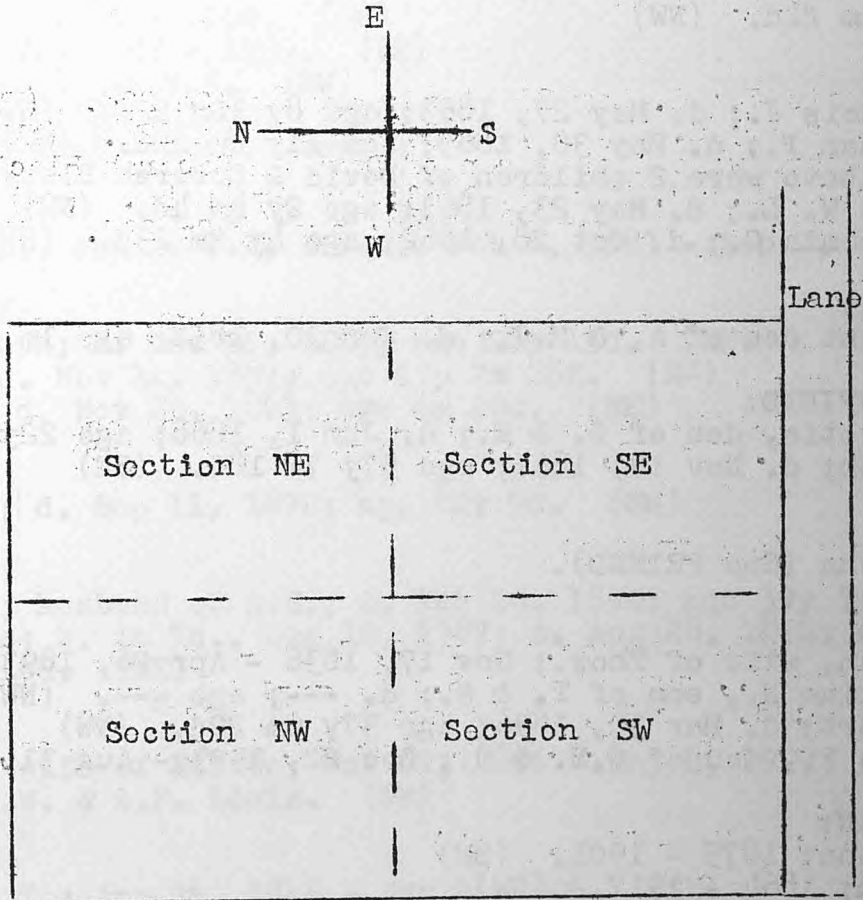

BARBER:

Lena M., dau of J.J. & M.L.; d. Oct 6, 1876; age 11m 22d.  
(SW)  
Bertha A., dau of J.J. & M.L.; d. Nov 7, 1879; age 2y 6m  
14d. (SW)

BARRITT:

John; b. in Ohio Dec 12, 1805; d. --- 21, 1883; age 77y  
11m. (NW)  
Cynthia, wife of John; Nov 10, 1812 - --- 2, 1898; age 85y  
11m 22d. (NW)

BLACK:

Francis J.; d. May 27, 1863; age 8y 10m 22d. (NW)  
Nathan P.; d. May 30, 1863; age 11y 8m 22d. (NW)  
(Above were 2 children of David & Deborah Black)  
John W. L.; d. May 23, 1863; age 2y 4m 4d. (NW)  
Louvenia C.; d. Oct 28, 1862; age 4y 2m 23d. (NW)

BURTON:

Infant dau of A. & M.J.; d. Jun 10, 1858; age 1m 11d. (SE)

BUTTERFIELD:

Lucrotia, dau of G. & E.; d. Jun 1, 1868; age 22y 9m 9d. (SE)  
Green; d. Nov 19, 1861; age 57y 7m 18d. (SE)

CAVE:

Rosana (See FRIEND).

CLARK:

Susan, wife of Thos.; Nov 17, 1836 - Apr 26, 1893. (NW)  
William H., son of T. & S.; d. ---; age ---. (NW)  
Albert; d. Mar 30, 1896; age 37y 6m 29d. (NW)  
Nola F., dau of G.M. & C.; Dec 22, 1903 - Aug 31, 1905. (NW)

COCHRAN:

Martha; 1875 - 1901. (SW)  
John; 1864 - 1917. (SW)

COGHILL:

Elza; 1847 - 1898. (SE)  
Margaret; 1853 - 1940. (SE)  
J. Lawson; 1874 - 1888. (SE)  
Florence; 1891 - 1897. (SE)  
John; 1880 - 1957. (SW)  
Maude; 1884 - 1955. (SW)  
Cecil Garold; 1904 - 1924. (SW)  
Dorthea; Apr., 1923. (SW)  
Alice E. (See MC MILLEN).

COON:

Florence; 1859 - 1931. (NW)  
William; 1854 - 1923. (NW)

(34)?

COON (cont'd):

Infant; (no dates). (NW)  
Jennett C., dau of J. & F.A.; d. Apr 9, 1865; age 1y 5m  
24d. (NW)  
Jacob; Sep 18, 1818 - Nov 24, 1900. (NW)  
Frances A., wife of Jacob; Apr 20, 1822 - Jan 17, 1899. (NW)  
Frances G., dau of J.A. & E.J.; d. Apr 14, 1883; age 1y  
10m 27d. (NW)

CORDELL:

Mary R.; 1877 - 1962. (SE)  
Claude T.; 1887 - 1959. (SE)  
Alicc; 1863 - 1945. (NW)  
William; 1859 - 1940. (NW)  
Sophia; 1900 - 1909. (NW)

DAVID:

Elmer D., son of T.J. & E.J.; Feb 6, 1883 - Sep 1, 1883. (SW)

DELBRIDGE:

Elizabeth; d. Dec 26, 1863; age 28y 15d. (NE)  
John; d. Nov 11, 1851; age 47y 7m 25d. (NE)  
Eliza; d. Nov 26, 1863; age 6m 20d. (NE)

DEPOY:

Seigle; d. Sep 11, 1892; age 22y 9d. (SW)

DICKASON:

Samuel; husband of A.E.; d. Feb 20, 1860; age 39y 7m (NE)  
Charles; b. in Va., Aug 10, 1787; d. Aug 28, 1874; age  
86y 18d. (NE)

ELLIS:

Alice, wife of Nelson; Nov 29, 1876 - May 4, 1907; dau  
of S.W. & A.F. Lewis. (NW)

FIELDS:

Martin T.; Aug 16, 1845 - Jun 4, 1906. (SE)  
Phidolia Thompson; Jul 8, 1846 - Nov 23, 1877. (SE)  
Hoyt E.; Jun 25, 1876 - Sep 29, 1876. (SE)

FRIEND:

Thomas J.; 1840 - 1929; Co I 11th Ill Cav. (SE)  
Mary A., wife of T.J.; 1855 - 1928. (SE)  
Charles L. C.; d. Apr 20, 1876; age 24y 8m 26d. (SE)  
Rosana Cave; d. Jun 5, 1909; age 98y 5m 12d. (SE)

GAMBLE:

George; 1851 - 19---. (NW)  
----; 1857 - 1933. (NW)

**GIBSON:**

Samuel; Apr 30, 1821 - Apr 3, 1897. (NE)  
 Elizabeth, wife of Sam'l; Jan 18, 1823 - Mar 11, 1855. (NE)  
 Pearl, dau of S.E. & F.J.; d. Nov 30, 1878; age 11m 20d.  
 Nancy, wife of John; d. Oct 2, 1860; age 53y 10m 21d. (NE)  
 John; d. Apr 22, 1869; age 81y 11m 12d. (NE)  
 Nancy, wife of John; d. Mar 10, 1849; age 51y 20d. (NE)  
 James; d. Jan 10, 1850; age 16y 11m 13d. (NE)  
 Nancy, wife of F.J.; d. Apr 10, 1849; age 51y 20d. (NE)  
 Isaac R.; d. Oct 10, 1840; age 1y 1m 7d. (NE)  
 Jasper N.; d. Nov 10, 1849; age 14y 5m 10d. (NE)  
 Amos; d. Dec 4, 1875; age 57y 10m 1d. (SE)  
 Cynthia E., dau of Amos & Rebecca; d. Jul 7, 1872; age 17y  
 8m 9d. (SE)  
 William A., son of Amos & Rebecca; d. Nov 15, 1859; age 4m  
 12d. (SE)  
 Ella; 1867 - 1923. (NW)  
 Samuel; 1860 - 1927. (NW)  
 Clara E. (See HATFIELD).

**GILLIAN:**

Samuel; Nov 30, 1830 - May 30, 1863; age ----. (SW)  
 Permolia; Jun 9, 1825 - Jan 4, 1907. (SW)  
 Joseph L.; 1854 - 1924. (SW)  
 George M.; 1855 - 1936. (SW)  
 William H.; 1862 - 1950. (SW)  
 Ada (See LEWIS).

**GREENFIELD:**

Alta Mae; 1871 - 1937. (SE)

**GRISWOLD:**

Lyman; Apr 24, 1816 - Dec 12, 1887. (NW)  
 Mary Jane, wife of L.; Dec 9, 1826 - Mar 30, 1908. (NW)  
 Sally; Jul 8, 1770 - Nov 8, 1874. "The British tyranny  
 did much oppress, the sacred rights that we possess;  
 and from my schoolroom I could see, the men a march-  
 ing, who set us free." (NW)

**GROVES:**

James M.; 1849 - 1915. (NE)  
 William; d. Aug 27, 1852; age 48y 2m 25d. (NE)

**GUNNING:**

John L., son of ---; d. Dec 23, 1874; age 1m 7d. (SE)

**HANK:**

John S., son of J. & A.E.; d. May 29, 1865; age 1m. (NE)

**HATFIELD:**

Clara E. Gibson; d. Sep 25, 1876; age 19y 7m 17d. (SE)  
 Willie, son of O.M. & C.E.; d. Jul 17, 1877; age 1y 10m.

HAYS:

Jeremiah; Jan 23, 1846 (no other date, age, etc.). (NW)  
Martha, wife of Jeremiah; (no dates); age 62y 3m 8d. (NW)

HILLS:

Sarah, wife of J.; d. Jul 27, 1876; age 55y 8m 20d. (SW)

HODGEN:

Roy; 1884 - 1962. (NW)

HODGES:

Robert F.; 1858 - 1908. (NW)  
Martha A., wife of R.F.; 1865 - 1938. (NW)  
Nellie; 1884 - 1967. (SE)  
Bertha, sister of Nellie; 1888 - 1973. (SE)  
C. Elizabeth; 1864 - 1930. (SE)  
Benjamin F.; 1856 - 1913. (SE)  
Infant son; d. Oct 11, 1884. (SE)  
B. N.; 1824 - 1890. (SE)  
S. A.; 1827 - 1913. (SE)  
Eva Irono, dau of Andrew J. & Sarah J.; d. Sep 16, 1892; age  
2y 1m 19d. (SE)

HORRELL:

Annis R.; d. Jan 16, 1909; age 70y 10m 23d. (NW)  
Maggio, dau of L.P. & A.R.; d. May 22, 1867; age 1y 11m  
22d. (NW)  
L. P.; d. Mar 11, 1873; age 53y 5m 25d. (NW)

HUSTON:

J. Riley; 1841 - 1906. (NE)  
Mary E.; 1841 - 1913. (NE)  
William Clem; 1883 - 1965. (SE)  
Clementine; 1886 - (no date). (SE)

JOHNSON:

Mary E., wife of Harry W.; d. Nov 10, 1884; age 25y 2m  
27d. (NW)

KELLOGG:

Dolmar D.; 1884 - 1964. (SW)  
Dollie E.; 1892 - 1963. (SW)

LEWIS:

Ada Gillian; 1857 - 1944. (SW)  
Ina; 1889 - 1969. (NW)  
Samuel W.; 1847 - 1929. (NW)  
Alvira F., wife of Sam'l; 1850 - 1914. (NW)  
Alicia (Soo ELLIS).

MC COY:

Mary M.; Apr 24, 1845 - Jan 29, 1911. (NW)  
Mira, wife of Peter; Oct 25, 1807 - Aug 23, 1888. (NW)  
Peter; Apr 4, 1808 - Aug 4, 1880; age 72y 4m. (NW)  
Mahala Molton; Oct 24, 1811 - Aug 8, 1887. (NW)

MC GARY:  
Emma (See WHEELER).

MC MILLEN:  
Alice E. Coghill, wife of Joseph; d. Jul 28, 1892; age 23y  
7m 3d. (SE)

MELLOR:  
Mary, wife of T.; d. Jul 23, 1870; age 52y 8m 23d. (NE)

MELTON:  
Mahala (See MC COY).

MILLS:  
Annie P., dau of C.W. & M.; b. Feb 23, 18-1; d. age 2d. (NE)

MINNER:  
David; d. Dec 10, 1870; age 42y 3m 10d. (NE)  
Samuel; b. in Delaware, 1810; d. Feb 7, 1883. (NE)  
Margaret; d. Jun 11, 1861; age 46y 7m 17d. (NE)  
Carrie; 1892 - 1910. (SE)

MONK:  
Walter L.; Jan 16, 1865 - Feb 25, 1887. (SE)  
----, dau of W. & R.A.; Apr 3, ?1866? - Jun 29, 1882. (SE)

MYERS:  
Sarah L.; d. Mar 7, 1853; age 10m 2d. (NE)  
Julia Ann; d. Sep 14, 1857; ag3 2d. (NE)  
John; d. Apr 15, 1858. (NE)  
(Above were 3 children of Robt. & Mary A. Myers).  
Robert; d. Apr 27, 1886; age 66y 1m 25d. (NE)  
Mary A., wife of Robt.; d. Jul 11, 1888; age 68y 9m 19d. (NE)

PARKS:  
George W., son of James & N.E.; d. Oct 28, 1891; age 14y  
10m 28d. (SW)

RIGGS:  
Andrew; d. Apr 17, 1887; age 61y 11m 26d. (NW)

ROSS:  
Walter O., son of T. & M.; d. Dec 3, 1854; age 8y 2m 3d. (NE)

SIMMONS:  
Eammaliel; May 14, 1854 - Dec 2, 1917. (SW)  
Silence; May 19, 1853 - Dec 15, 1917. (SW)

SPIVA:  
George, son of G.W. & S.; d. Jan 28, 1889; age 4y 7m 12d. (SW)  
Rebecca E., wife of Wm.; d. May 11, 1881; age 68y. (SW)  
William; d. Jun 4, 1881; age 78y. (SW)

STALIAN:

Jay C.; 1892 - 1968. (SE)  
Amanda, wife of C.C.; Jan 7, 1851 - May 13, 1896. (SE)  
C. C.; 1854 - 1928. (SE)  
Rosa; 1850 - 1921. (SE)

STANLEY:

Mary Elda; 1859 - 1934. (SE)  
William L.; 1861 - 1936. (SE)

STEELE:

Ada; 1902 - 1954. (NW)  
Clifford E.; 1905 - 1932. (NW)  
Alex Andrew; 1851 - 1920. (NW)  
Elizabeth; 1871 - 1951. (NW)

STRADER:

Willie M., son of M. & D.A.; Jan 17, 1853 - Jan 17, 1867. (NE)  
----; d. ----; age 77y 1m. (NE)  
William S., son of J. & C.; d. Mar 3, 1863; age 1y 8m 27d.  
Reuben H.; Jun 5, 1838 - Feb 1, 1906. (NE)  
Ann Elizabeth, wife of R.H.; Jun 3, 1847 - (no date). (NE)  
Robbie; d. Sep 27, 1879; age 1m 15d. (NE)  
Etta; d. Oct 13, 1867; age 1m 1d. (NE)  
Edwin; d. Aug 4, 1876; age 23d. (NE)  
John; b. Mar 16, 1817; killed by Indians on his way home  
from Idaho; 1863. (SE)  
Caroline, wife of John; Jun 20, 1828 - Feb 1, 1904. (SE)  
Matilda Ann, dau of J. & C.; Dec 23, 1849 - Jan 8, 1903. (SE)  
Hattie, dau of D. & E.M.; d. Sep 7, 1869; age 1y 2m 16d. (SE)  
Dollie, dau of D. & E.M.; d. Nov 19, 1870; age 6y 10m 11d.

SULLIVAN:

Mary R., wife of W.R.; d. Oct 30, 1879; age 35y 5m 24d. (SE)  
J. Price; 1852 - 1926. (SW)  
Sarah L., wife of J.P.; 1857 - 1920. (SW)  
Infant; 1891. - (SW)  
Nora; 1884 - 1885. (SW)  
Purla; 1883 - 1883. (SW)  
Infant; 1881. (SW)  
Gurna; 1895 - 1925. (SW)

SUMNER:

Richard, son of W.S. & E.A.; d. Mar 7, 1860; age 5m 20d. (NW)

TALLMAN:

Mary, wife of J.; d. Jan 10, 1853; age 56y. (NE)

TAYLOR:

Alice Ann, dau of J. & E.; d. Feb 8, 1856; age 9m 18d. (NE)

TANDY:

Frank; 1867-1935. (SW)  
Jeptha M.; (no dates); Co C 84th Ill Inf. (SW)  
Lottie L.; 1850 - 1930. (SW)  
James; 1877 - 1945. (NW)  
Lowis; 1879 - 1920. (NW)

THOMPSON:

Lavina, wife of S.H.; d. May 2, 1874; age 52y 11m 19d. (NE)  
Mary Ann, dau of S.H. & L.; d. Apr 4, 1850; age 3y 2m 19d.  
Phidelia (See FIELDS).

TRACEY:

Caroline M., wife of J.S.; d. Aug 19, 1876; age 72y 11m  
11d. (SE)  
John S.; d. Jan 3, 1880; age 77y 2m 28d. (SE)  
John S.; 1864 - 1934. (SW)  
Mary E.; 1865 - 19--. (SW)  
Ora Lee, son of J.S. & M.E.; d. Mar 29, 1893; age 2y 4m 29d.

TUGGLE:

Pamela, dau of C. & C.; d. Feb 13, 1863; age 7y 8m. (NE)  
John; d. Nov 10, 1857; age 76y 10m 5d. (NE)

UNKNOWN:

Mary M.; d. Nov 24, 1875; age 4y 6m 21d. (NE)

VALENTINE:

Stove, son of Wm. & Mary; d. Sep 11, ---; age ---. (SW)  
Zelma E., dau of G.F. & L.F.; d. Oct 30, 1894; age 1y 8m  
17d. (SW)

VANCE:

Samuel; 1837 - 1898. (SW)  
Sarah Ann; 1834 - 1920. (SW)

WHEELER:

Emma McGary; Jul 18, 1860 - Jun 24, 1895. (SW)

WHITE:

Richard; (no dates); age 67y 5m 6d. (SW)  
Phillis J., wife of Richard; (no dates); age 72y. (SW)  
Charlie, son of R. & P. (no dates); age 86y. (SW)  
Ann, dau of R. & P.; (no dates); age 31y 27d. (SW)  
Emory; (nodates); age 42y. (SW)  
Keith; 1926 - 1962. (NW)

WOODWORTH:

Rhoda J., wife of Nelson; Jun 10, 1833 - Jan 5, 1899. (SW)  
Nelson; Oct 10, 1830 - Sep 27, 1901. (SW)

YOUNG:

George H.; d. May 18, 1857; age 40y 3m 26d. (NE)



Genealogical Notes - Gibson Comotery

BARRITT: John owned a farm a mile north of Fandon.

CLARK: Thomas farmed on section 1, Lamoine Twp.; he was a native of Ohio and moved to this county from Adair Co., Mo. in 1863.

COGHILL: Elza (Death notice, in part, from The Macomb By-stander, Apr 13, 1898): "Elza Coghill, an old resident of Fandon neighborhood, died at his home last evening at 8 o'clock of dropsy and rheumatism....."

COON: Jacob farmed in Chalmers Twp., about a half-mile north of Fandon.

Frances A. (1822-1899)(Death notice, in part, from The Macomb Times, Jan 19, 1899): "Mrs. Frances A. Coon died at her home in Chalmers Township early Tuesday morning of paralysis, in the seventy-seventh year of her age..... Deceased leaves a husband and five grown-up children."

FRIEND: Thomas J. enlisted in the army at Middletown (Fandon) on Nov 7, 1861; served as a private with Co I 11th Ill Cav. till being discharged on Jan 8, 1863.

GIBSON: John (1787-1869), credited by local historians as the first settler of Bethel Twp., arrived here in 1829; he and family settled on section 2, Bethel; John was born in N.C. Mr. Gibson was apparently a veteran of the War of 1812; on page 391, Clarke's, History of McDonough County, the following is quoted, in part: ".....John Gibson, who lived near Middletown. He was a strong Democrat, but had formerly been a soldier under Gen'l Harrison, and had the utmost respect for the old warrior. Though he would not vote for his old general, he allowed no one to speak evil of him in his presence, and would get fighting mad if any one dared to do so.....". John Gibson appears on the 1840 county tax list as # 697; he owned no real estate; had \$145.00 worth of horses; \$157.00 cattle; \$10.00 clocks & watches; \$50.00 wagons; \$309.00 in other property; his taxes were \$3.36. The first marriage in Bethel township was that of Thos. Driskill & Miss Sarah Gibson, a daughter of John & Nancy Gibson. The first birth in Bethel was a son, Joseph, to Mr. & Mrs. John Gibson, in 1832.

Amos (1818-1875) appears on the 1840 county tax list as #700; he had no real estate; \$65.00 worth of horses; and his total taxes were \$ .33. Appearing immediately before Amos on that tax list, as #699, was John G. Gibson, who owned \$126.00 in personal property. Amos Gibson and Miss Rebecca Dickason were md. in this county on Sep 29, 1848.

GIBSON (cont'd): Samuel (1821-1897) and Elizabeth Huston were md. in this co. on Mar 2, 1843.

Nancy (1806-1860), 2nd wife of John Gibson, was a native of Ky.; the federal census for 1860, taken in Bothol Twp. during June/July of that year, indicates the John Gibson household consisting of the following members: John; Nancy (age 54); Nancy (age 16); Allen (16); & Aguilla (14).

GRISWOLD: Lyman (Death notice, in part, from The Macomb Journal, Dec 29, 1887): "Lyman Griswold died recently in Colchester Twp., aged 71 years. He was born in New York in 1816 and came to this county in 1863."

HILLS: Sarah, wife of John; maiden name was Massingale; she and John Hills were md. in this co. on Mar 26, 1839.

HORRELL: L. P. (1819-1873), b. in Adair Co., Ky., Sep 16, 1819; moved with parents to Ill. in the early 1820's; lived for awhile in Morgan Co. L. P. was a son of Chas. & Elizabeth Horrell; L. P. md. Annis R. Beadles on Sep 19, 1850, and lived about 8 miles from Jacksonville, Ill. till about 1864, when he moved to this co. and bought a farm in Chalmers Twp.

JOHNSON: Mary E. (Obit, in part, from The Macomb Journal, Nov 13, 1884): "Mary, wife of Harry Johnson, died at the residence of her mother, Mrs. A. R. Horrell, of near Colchester, on November 10th, aged about 24 years. She married Harry Johnson, the stonemason, about 6 years ago. They came to Macomb to reside. She was a sister of Dr. Chas. Horrell of Colchester."

FINNER: Samuel (1810-1883) farmed on section 31, Chalmers Twp.; he was a native of Delaware and moved to this co. in 1850, from Ohio.

MONK: Walter (Death notice, in part, from The Macomb Journal, Mar 10, 1887): "Walter Munk, of Lamoine, died last Thursday and was buried in the Gibson burying ground, aged 22 years. He is survived by a wife and one child."

MYERS: Robert (1820-1886); b. Allegheny Co., Pa., Mar 2, 1820; son of Eli & Ann (Porter) Myers; the family moved to Pickaway Co., Ohio in about 1823; Eli & Ann died in that county; Robt. then lived with an uncle, Wm. Porter, till his marriage in 1846, to Mary Ann Hollowell; moved to Adams Co., Ill. in 1849; and to this co. in 1850; lived in Tenn. Twp.; Robt. & Mary's children included: Sarah; Julia; John; Ann Elizabeth (Mrs. Reuben Strador); Mary Jane (Mrs. Cassius M. Strador); and Wm. Kenton.

Mary Ann (1819-1888), wife of Robt.; daughter of John and Elizabeth (Johnson) Hollowell.

RIGGS: Andrew (Death notice, The Macomb Journal, Apr 28, 1887): "Jackson Riggs, for over 20 years, a resident of the vicinity of Colchester, died Sunday at his home, 3 miles southeast of town, aged 60 years."

SPIVA: The William Spiva family appears on the 1850 federal census for Schuyler Co., Ill.; they were living in Oregon Twp.; the household consisted of the following persons: William, b. in N.C., farmer; Rebecca, age 34, b. N.C.; and 7 children, all b. in Ill., as follows: John S., 14; Susan J., 12; Francis M., 10; Wm. J., 9; Andrew N., 7; James H., 5; and Elizabeth, 3.

STRADER: John (1817-1863) md. Caroline Tracey in this co. on Mar 7, 1849. Both John & Caroline, natives of Ohio.

John M. (a son of John & Caroline) md. Allie Welch; he was born near Macomb on May 29, 1856, and farmed in Chalmers Twp.; John M. d. in 1922, in Macomb.

SULLIVAN: Mary, wife of W. R.; born & died in this county.

TUGGLE: John (1781-1857) lived in the State of Va. and in Morgan Co., Ill. before coming to this co. in about 1836; his wife was the former Elizabeth Gennyen. A son, John, Jr., was b. in Va. in 1817.

Notes, Corrections, Additions, & Changes

## MILER GRAVE

Located on the west side of a gravel road leading north from Fandon, is a single gravestone; that of Martha Miler. This site is about a half-mile north of town.

MILER: Martha; d. Apr 23, 1840; age 56y 27d.

Mrs. Miler (name also spelled as MYLER) was the mother of Mary (Mylor) Stevens, wife of William D. Stevens, who came to this area in about 1839. William & Mary were md. in Indiana in about 1826 and lived in Harrison Co., Ind. till the late-1830's, when they moved to Schuyler Co., Ill. They lived there about a year, then moved to Chalmers Twp. in this county. They had the following children: Emily; Amanda; Lewain; Jasper Nowton; Henry H.; Charles A.; Thomas; and Mary. Mary (Mylor) Stevens, and other members of this family are buried in a family cemetery about two miles southeast of Colchester.

Notes, Corrections, Additions, & Changes

STRADER-NANKIVEL CEMETERY

Location: Chalmers township; NW $\frac{1}{4}$  section 34; 5 miles south of Macomb on county road 16, then 3 miles west on county road 22; or, 2 miles northeast of Fandon on county road 22. The grounds are located about  $\frac{1}{4}$  mile north of county road 22 on a ridge between two deep gullies. This cemetery is on privately owned property and no type of roadway least directly to this graveyard.

Remarks: This family cemetery is located in semi-heavy timber and the grounds are covered with woods and brush. The old wire fencing is nearly gone from all sides. A large number of the stones are yet standing, however, most are badly weather-worn. Several stones were located under 4-5 inches of grass, leaves, and dirt. There are an estimated 30 field stones on which any engraving that may have been placed is not totally unreadable.

BRADLEY:

Ella Jane, dau of W.H. & M.C.; d. Sep 14, 1865; age 1y 9m 10d.

BURTON:

Laura A., wife of R.M.; d. Apr 8, 1878; age 25y 6m 10d.

Infant son of R.M. & L.A.; d. Apr 3, 1878.

Clarence A., son of R.M. & L.A.; d. May 15, 1880; age 3y 8m 5d.

COCKERHAM:

Edward W., son of A.J. & M.; d. Oct 2, 1859; age 1y 4m 1d.

CURRY:

Flora M., dau of A.B. & M.C.; d. Sep 29, 1855; age 1y 2d.

MC CORMICK:

John, son of John & Nancy; d. Sep 18, 1841?; age 27m.

Elisabeth Ellen, dau of Jesse; d. Nov 16, 1859; age 4y 11m 24d.

Clement O., son of Jesse & Judith; d. Nov 11, 1880; age 16y 11m.

Judith Wayland, wife of Jesse; d. Dec 5, 1890.

William D., son of T.B. & E.; d. Dec 2, 1848; age 4y 1m 10d.

Melissa, dau of -----; d. ---; age-----.

Nancy, wife of John; d. May 31, 1838; age 45y 4m 16d.

Parthona, 2nd wife of John; d. Apr 16, 1889; age 84y 7m 20d.

John; d. Dec 18, 1880; age 91y 3m 28d.

MITCHELL:

----; d. Jan 18, 1869; age 35y 4m.

Theophilus; Oct 18, 1820 - Sep 2, 1879.

Alpha O.; Aug 4, 1820 - Nov 24, 1883.

Jennie H.; Mar 9, 1864 - Jul 20, 1882.

Hanna, wife of Andrew; d. Jun 29, 1864; age 70y 6m 23d.

Andrew; d. Mar 14, 1847; age 60y 4m.

William V., son of A. & H.; d. Sep 7, 1850; age 18y 11m 17d.

NANKIVEL:

William H.; Feb 13, 1835 - Oct 20, 1899.  
Mary F., wife of Wm.; Sep 20, 1837 - Oct 19, 1879.  
Amelia C.; d. May 10, 1883; age ---.  
John; Jan., 1808 - Feb., 1870.  
Mary M., wife of John; Nov., 1814 - Nov., 1893.  
John, son of J. & M.M.; d. Aug 15, 1855; age 18y 6m 27d.  
Ella H., dau of W.H. & M.F.; d. Oct 22, 1861; age 18m 18d.  
Anna A., dau of W.H. & M.F.; d. Sep 11, 1864; age 18d.  
Mary A.; d. May 18, 1845.  
Emily J.; d. May 10, 1847.  
Leah; d. Jan 10, 1848.  
George C.; d. Jul 15, 1844.  
Lucy A.; d. Jul 12, 1842.  
Cornelia; d. Aug 24, 1842.  
Anna; d. Dec 18, 1843.

(Latter 7 were children of J. & M. Nankivel; all names contained on a single stone; no ages shown).

RUSH:

Alllice, dau of W. & M.A.; d. Aug 13, 1864; age 2y 8m 20d.  
Frank A., son of Wm. & M.A.; d. Dec 31, 1877; age --m.

SMYSER:

?Willard/William?; son of J.H. & F.W.; d. Feb 15, 1867;  
age 1y 9m 20d.

STRADER:

Maggie, wife of D.B.; Jan 9, 1874 - May 10, 1902.  
John H., son of S. & H.; d. Aug 16, 1864; age 1y 2m 11d.  
Margaret, wife of Simeon; d. May 2, 1856; age 33y 9m 19d.  
Charlie G., son of S. & H.; (no dates).  
Harriett, wife of Simeon; d. May 23, 1895; age 63y 7m 28d.

SULLIVAN:

Jeremiah; d. Jan 28, 1867; age 74y 1m 1d.  
Samuel; d. Aug 12, ?1839?; age 56y.  
Elisabeth, wife of Sam'l; d. Mar 8, 1877; age 83y 9m 6d.

THOMPSON:

Infant son of S.G. & E.E.; Nov 11 - 19, 1882.

WAYLAND:

Judith (See MC CORMICK).

WORMLEY:

Barbara, wife of George; d. Sep 15, 18?69?; age 71y.

Genealogical Notes  
Strader-Nankivel Cemetery

MC CORMICK: John (1789-1830); b. Carroll Co., Md.; moved to Fayette Co., Ky. in about 1793; later lived in Sullivan Co., Ky.; moved to this county in about 1835; married first to Nancy Cox and had 7 children. After his first wife died in 1838, John married Parthena Ball in this county on Dec 22, 1838. John & Parthena were original members of the Antioch Church of Regular Baptists organized at Fandon in 1841. The following is quoted, in part, from page 533, Clarke's, History of McDonough Co. (1878): "John McCormick, one of (the church's) constituents, came from Kentucky in 1835 or 1836, and has been for many years living with his second wife, both estimable people, and the old gentleman is now largely over eighty, but is able to attend to his own business...." Mr. McCormick appears on the 1840 county tax list as # 581; he owned no real estate; had \$70.00 worth of horses; \$92.00 cattle; \$50.00 carriages; and \$282.00 worth of other property; total taxes were \$2.47.

Theodore B., father of William D. (1844-1848), was a son of John & Nancy (Cox) McCormick; T.B. was born in Ky. & md. in this county to Emily Stevens on Dec 28, 1843; Emily was a daughter of Wm. Stevens; their children included: William D.; Nancy J.; and Florence L. Mr. & Mrs. McCormick are buried at the Stevens Cemetery south of Colchester.

MITCHELL: Theophilus L.; b. in Harrison Co., Ky.; moved to this county in about 1841; farmed in Bethel Twp.

NANKIVEL: John appears on the 1840 county tax list as #586; he owned no real estate; had \$100.00 worth of horses; \$20.00 cattle; \$80.00 cash loaned out; and \$90.00 worth of other property; taxes were \$1.45. The Nankivel's moved to this county from Maryland in about 1838; farmed on section 3, Bethel Twp.

Amelia; according to court records was born in Maryland & moved to this county with her parents in the 1830's. She never md.; died at age 49y.

William H.; b. in Md.; son of John & Mary; moved here with parents in about 1838.

STRADER: Simeon moved to this county from Ohio in about 1855; he and his family lived on section 34, Chalmers Twp. where Mr. Strader farmed and worked as a blacksmith.

SULLIVAN: Jeremiah moved to this co. in about 1835 from Washington Co., Pa.; a son, Jeremiah, Jr., was born in that county in 1817. Jeremiah, Sr. appears on the 1840

SULLIVAN (cont'd); county tax list as # 375; he owned no real estate; had \$40.00 worth of horses; \$8.00 in clocks & watches; \$15.00 wagons; and \$40.00 worth of other property; taxes were \$ .52. Jeremiah, Jr. appears as # 376 on that list; Jeremiah, Sr. was identified on the tax list as "white headed".

Notes, Corrections, Additions, & Changes



## WAYMACK CEMETERY

Location: Bethel township, NW $\frac{1}{4}$  section 9. One and one-half miles south-southeast of Fandon; or, one-fourth mile east of Bethel Church.

Remarks; This small family burial ground is located on privately owned property. It is unfenced, however, the area is non-pasture land, and the stones are in relatively good condition. The name, Waymack, is noted to be spelled on the various stones here as "Warmack and/or Wormack.

### DARK:

Christina, wife of S.L.; Nov 25, 1826 - Jul 6, 1863.

### WAYMACK:

Jacob; 1821 - 1863. (Note: An older stone, possibly this individual's original stone, reads: "Jacob Wormack, d. Sep 9, 18--; age 45y 2m 5d.)

Nancy, wife of Jacob; 1820 - 1893.

Adan, son of J. & N.; 1842 - 1852. (Note: An older stone for this son reads: "A. Warmack, son of J. & N.; d. May 12, 1852; age 9y 8m 15d.)

Francis M., son of J. & M.; d. Aug 17, 1855; age 1y 1m 17d.

### Genealogical Notes - Waymack Cemetery

DARK: Christina was a daughter of Buckner Waymack; b. in Va.; she was the 2nd wife of Sam'l L. Dark; they had 10 children including Andrew Jackson Dark, b. in this county in 1850; Sam'l died in 1899 at age 93y. Mr. Dark lived several years in Brooklyn, Schuyler Co. He became a Baptist preacher in 1832.

WAYMACK: Jacob appears on the 1850 federal census for Brooklyn Twp., Schuyler Co., Ill.; he was b. in the State of Tenn.; farmed, and owned \$300.00 worth of real estate; his wife, Nancy, was al so b. in Tenn.; their 4 children, listed on that report, were b. in Ill.; they were: Aden, age 7; Rosetta, 5; Mary E., 4; and Buckner, 2. Jacob was a son of Buckner & Nancy Waymack. Jacob's father died in Schuyler Co. in about 1856. On Mar 5, 1840, Jacob md. Nancy Mason in this county. Daughter, Rosette, b. Aug 12, 1844, md. Nimrod Robinson; she died in Macomb on Jan 29, 1922; buried at Cox Cemetery in Schuyler Co.

### Notes, Corrections, Additions, & Changes