



"Crossroads of
West-central
Illinois"

**McDONOUGH COUNTY
HISTORICAL AND GENEALOGICAL
MISCELLANY
1826 - 1976**

RURAL CEMETERIES
OF
McDONOUGH COUNTY, ILLINOIS
VOLUME IX
MOUND & NEW SALEM TOWNSHIPS

McDONOUGH COUNTY, ILLINOIS

REF. 977.342 L567 V. 9
Lester, Duane.
Rural cemeteries of
McDonough County, Illinois

MID-CONTINENT PUBLIC LIBRARY
Midwest Genealogy Center
3440 S. Lee's Summit Rd. **MGC**
Independence, MO 64055

MID-CONTINENT PUBLIC LIBRARY

MC DONOUGH PUBLIC LIBRARY
Historical Genealogy Center
101 S. Main Street
McDonough, MO 64858 MGC

RURAL
CEMETERIES
of
MC DONOUGH COUNTY, ILLINOIS

Volume IX
Mound & New Salem

By Duane Lester
Good Hope, Illinois

Printed by
Schuyler - Brown
Historical and Genealogical Society
and
The Schuyler Jail Museum

MID-CONTINENT PUBLIC LIBRARY



3 0000 13101759 6

MID-CONTINENT PUBLIC LIBRARY

Midwest Genealogy Center

3440 S. Lee's Summit Rd.

Independence, MO 64055

MGC

Preface

Maps and

Clark

Bound

Upper

"A monument is erected,
not because a person died,
but because a person lived."

Volume IX

Table of Contents

Preface i - ii

Maps and plats iii - vii

Clark - Evans - Woods Graves 1

Mound M. E. Cemetery 2 - 13

Upper Mound Cemetery 14 - 26

MID-COUNTY PUBLIC LIBRARY

Preface

Within the boundaries of McDonough County, Illinois are more than a hundred cemeteries and gravesites ranging in size from a single burial site to the expansive Oakwood Cemetery at Macomb. Within these cemeteries are the remains of an estimated 40,000 individuals who have died since the first settler arrived here over 150 years ago. Graves of countless others are scattered over the countryside of McDonough County; but, exact sites of many of these resting places are no longer known for various reasons. During the early days of this county, there were obviously no central burial grounds; thus, a pioneer family having the misfortune of losing one of its members placed the deceased in a grave on a family homestead and erected a makeshift marker. A number of these family burial grounds later became public cemeteries, however, many of the grave sites soon became "lost". Crude wooden markers or a hand engraved stone soon succumbed to the elements and were never replaced; scores of families moved further west after staying in this area only a short time and the gravesites of their loved ones shortly became insignificant mounds of earth; a number of families passing through this vicinity suffered individual losses. A prime example of the latter is contained in a history of Bethel Township. In 1830, four children of an emigrant family died while enroute through McDonough County. They were buried near their places of death which occurred about two miles southwest of Fandon. All traces of those graves have long been gone. During the summer of 1834, a widow lady died at her home in northern Tennessee Township. Her coffin of dressed walnut lumber was built by a local cabinet maker and she was buried in the timber near her home. Within a few years, no evidence remained to indicate the presence of her final resting place. A family who created an excellent farm from the prairies a few miles north of Macomb, maintained a fenced family burial site for several years. This cemetery contained the graves of about 12 former family members. During the early 1900's, the farm changed ownership. Shortly thereafter, the new owner removed all the stones, took down the fence, and this graveyard became part of a cornfield. These are only three of the countless incidents involving the total disappearance of burial sites. At this time, it is impossible to determine the locations of hundreds of individual's graves in this county.

Vandalism is responsible for the destruction of many grave stones. Countless markers have been partially or totally destroyed. Inscriptions have been obliterated by shotgun blasts, stones have been broken into dozens of pieces, and some markers have been entirely removed from their original locations.

While weather-wear and vandalism accounts for most of the destruction of individual tombstones, neglect is directly responsible for the eventual deterioration of graveyards. Several local cemeteries have had no protective fencing for a number of years and the grounds have become grazing land for livestock. Groundhogs and other burrowing animals have undermined large portions of various cemeteries. Some areas are nearly invisible because of massive growths of weeds and brush. Stones have fallen, broken, and become completely covered with soil and debris.

The overall conditions of our county cemeteries is a pathetic case. While some grounds are well maintained, or at least partially kept-up by various families, many have been totally forgotten. This situation is appalling and should never have come about. Apparently, lack of time, expense, and most of all regard has brought about the present-day poor conditions of many of our rural cemeteries.

Genealogical notes accompanying the various cemetery listings were prepared from a wide variety of sources including: Local area history books and atlases; newspaper files; county, state, and federal archives; family histories. These notes were collected at random from readily available sources and little, or no attempts were made to search for material for more complete genealogies. These notes are presented only for the purposes of identification and/or clarification.

Every attempt has been made to present complete and accurate information. Readers will find errors and omissions. Others will not agree with portions of my findings; however, no information contained herein is based solely on assumption or guesswork. It must be remembered that this information has been prepared for use only as a tool for further research and that nothing must be taken as final and absolute.

The larger cemeteries contained in these volumes are accompanied by grave location charts. These charts in no way are intended to represent any professionally prepared plat or survey that may exist. Their preparation and presentation are solely for general location purposes.

When copying inscriptions from grave markers, it is sometimes impossible to read some portions of the engraving. Names, dates, ages, etc. that were found to be unclear or totally missing are indicated by the use of question marks or dashes, i.e., SPICER, James T., infant son of ?J.B. & S.J.?.; d. -----; age -----. The letters or numbers enclosed in parenthesis following the inscription, indicate general location as indicated on the accompanying chart.

Abbreviations used are as follows:

b.	born	m.	months
Cav.	Cavalry	md.	married
Co.	County/Company	sec.	section
d.	died/days	twp.	township
dau.	daughter	y.	years
Inf.	Infantry		

Time and space prohibits proper recognition for all those individuals who gave assistance in preparing and publishing these volumes. Deep and sincere appreciation is extended to all concerned, especially to the following: My parents, Mr. and Mrs. Lloyd Lester, and my wife, Rose; and to Mrs. Lavina Walton and other members of the Schuyler County Historical and Genealogical Society for printing and binding the finished product. Thank you.

Duane Lester



Mc Donough County, Illinois

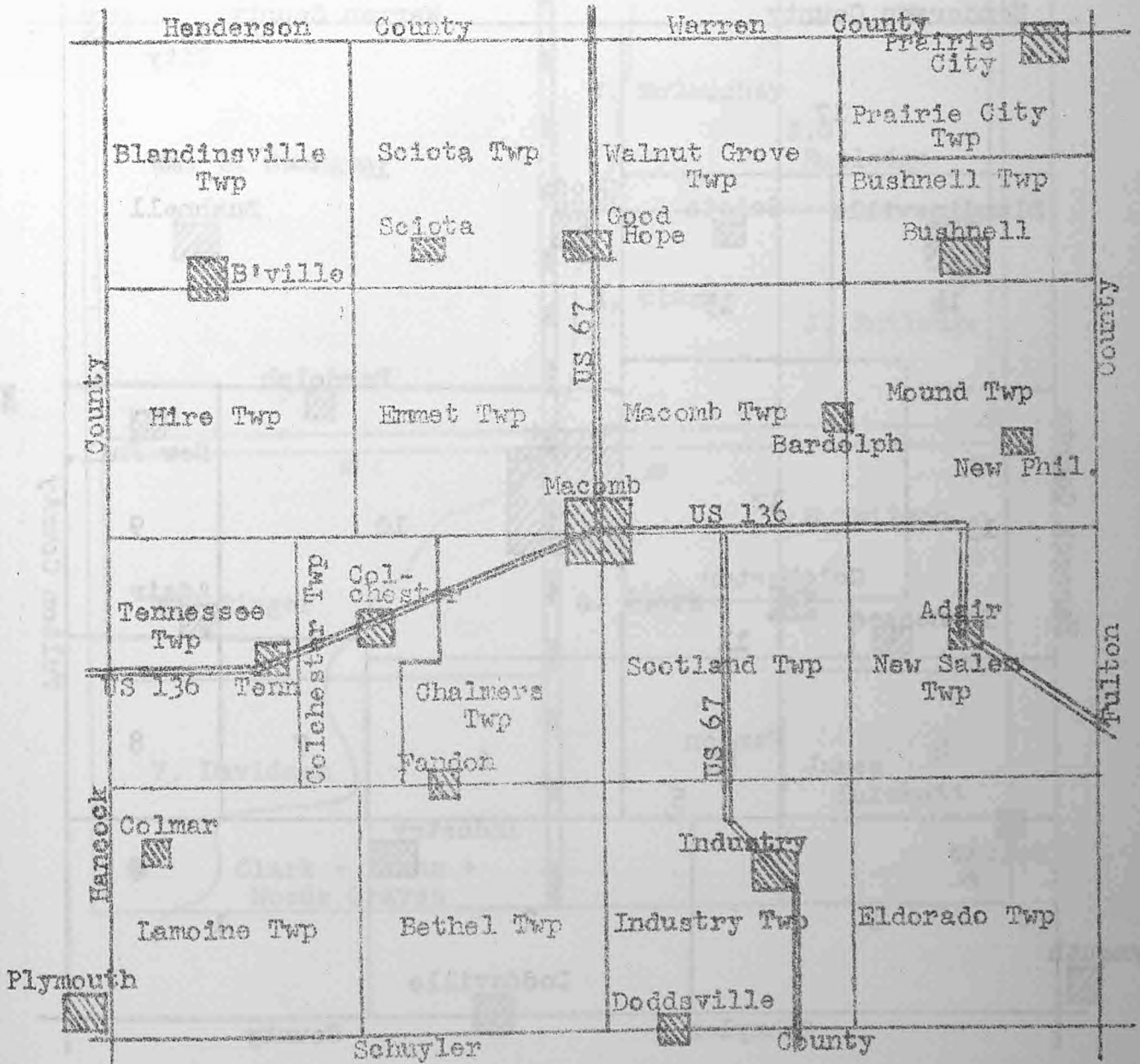

Areas covered by volumes I - XVII
 "Cemeteries of McDonough County, Illinois"

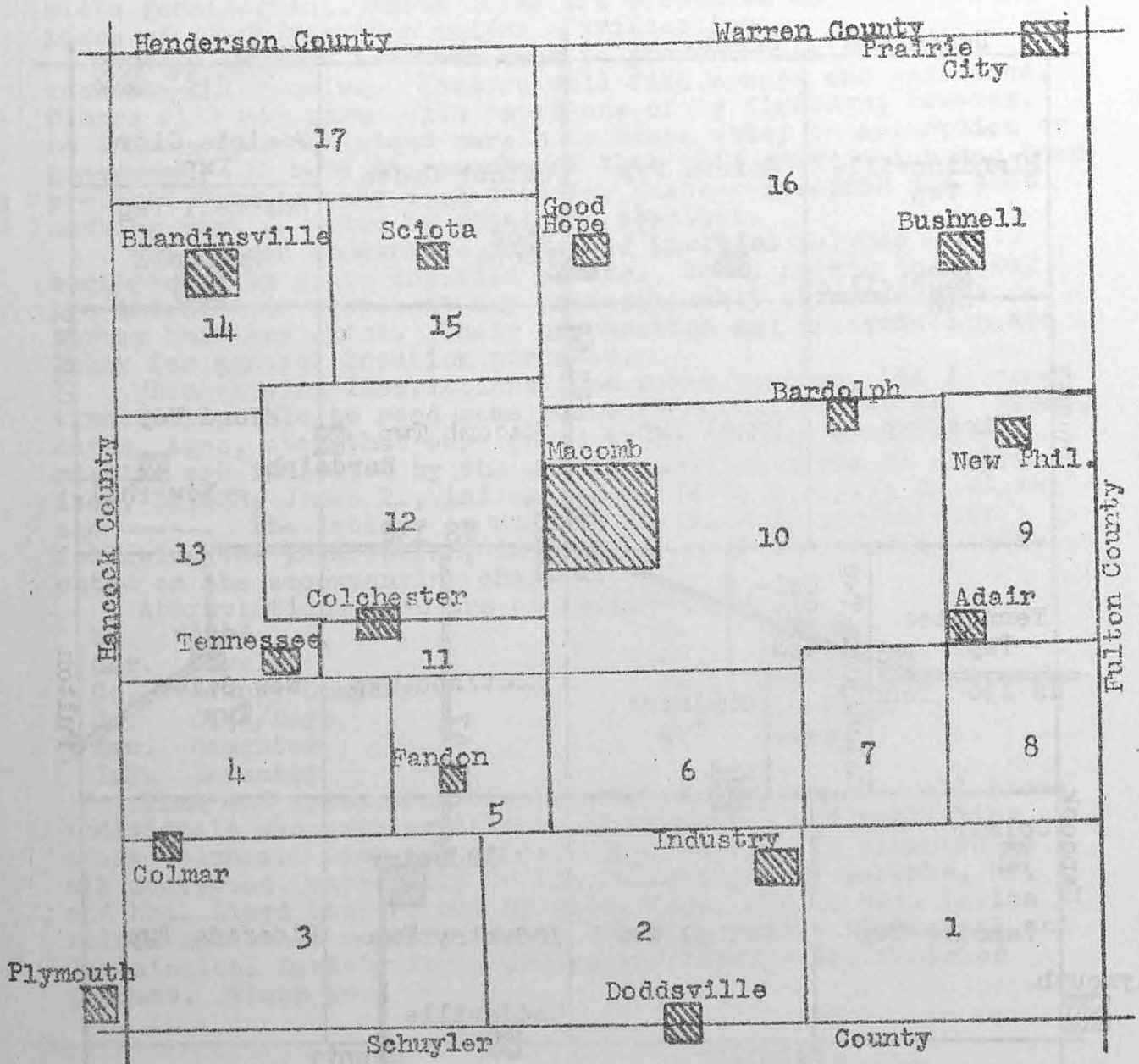

Section 3

New Salem Township, T5N R1W; 1871

Wm. B. Swango	J. McGaughey	R.G. Rutledge
	A. Clark	J. Rutledge
Wm. Ringer	A. Clark	H. Wilson
V. Davidson Clark - Evans + Woods Graves		James Burchett

Section 22
Mound Township, T6N R1W; 1871

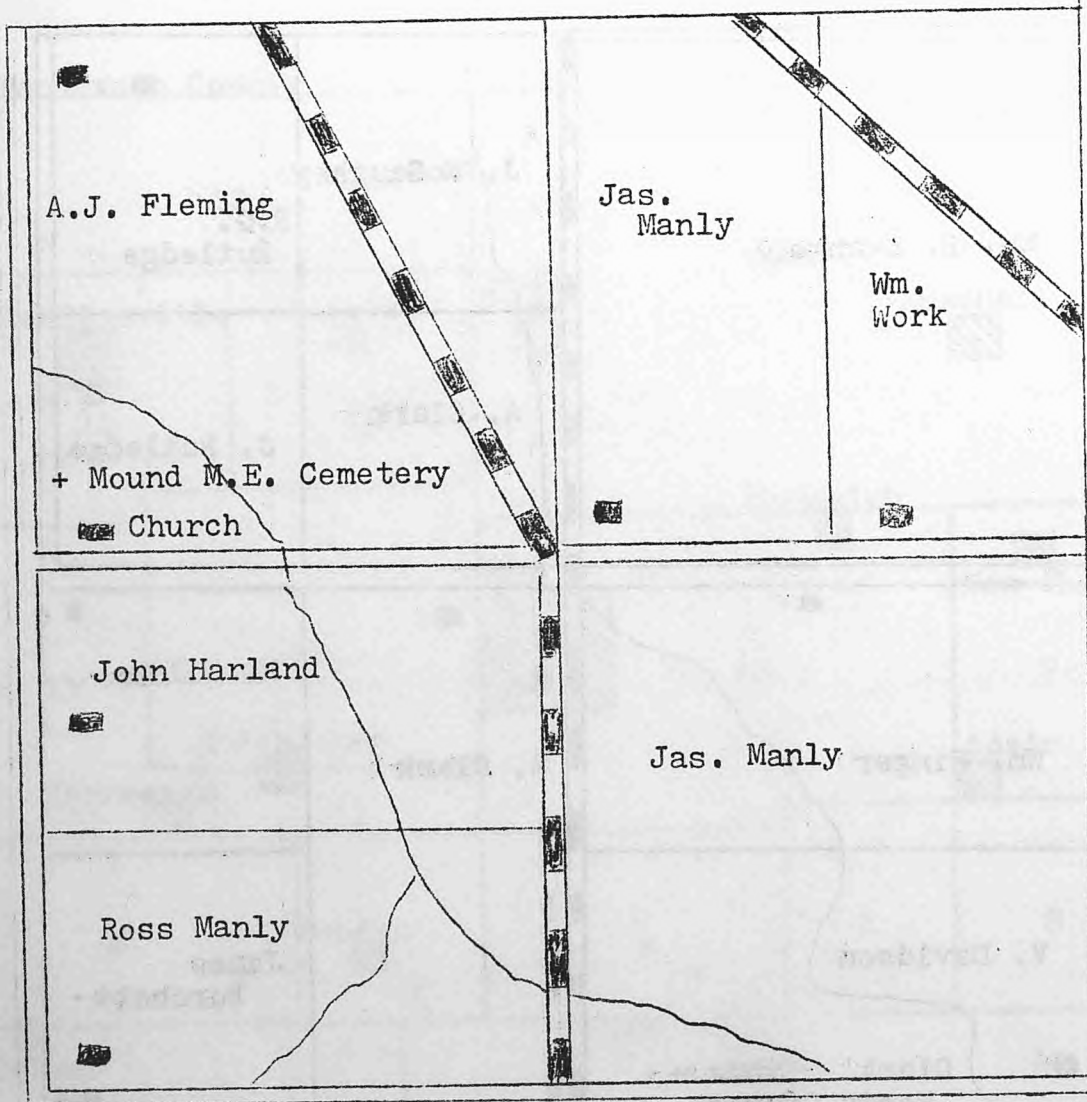

Section 14
 Mound Township, T6N R1W; 1871

Wm. Wallers (?)		James Lemaster	
Wm. Crawford			
J.P. Boaz	H.A. Boaz	Church	Upper + Mound Cem.
			Geo. W. Sheets

Clark - Evans - Woods Graves

This small family cemetery is located in New Salem township, SW $\frac{1}{4}$, Section 3; about a mile and a half north of Adair and is on Burlington Northern Railroad property. The area is not fenced and is weed and brush-covered; the stones lie adjacent to the BN railroad, on the west side of the tracks.

BRIDGE:

Orelia (See WOODS).

CLARK:

Sarah E., wife of Alvah; Jun 28, 1822 - Jul 7, 1909.

Alvah; d. Dec 18, 1890; age 86y 1m 20d.

Marion, son of A. & S. E.; d. Jan 4, 1843; age 20d.

Nathan, son of A. & S. E.; d. Aug 1, 1853; age 3y 1m 1d.

EVANS:

Michael T., son of J. O. & E.; d. Jan 21, 1858; age 2m 27d.

WOODS:

Henry, son of Silas & Orelia; b. Chatauque Co., N. Y., Jan 28, 1833; d. McDonough Co., Ill., Aug 14, 1845.

Silas; b. Cheshire Co., N. H., Jan 6, 1799; d. McDonough Co., Ill., Jul 28, 1845.

Orelia Bridge, wife of Silas; b. Cheshire Co., N. H., Feb 28, 1804; d. McDonough Co., Ill., Jan 24, 1847.

Notes, Corrections, Additions, and Changes

MOUND M. E. CEMETERY

Location: Mound Township, NW $\frac{1}{4}$, Section 22; 3 $\frac{1}{2}$ miles south of Bushnell on Illinois Route 41.

Remarks: Well fenced except on road frontages; regularly maintained and the majority of the stones are in excellent condition.

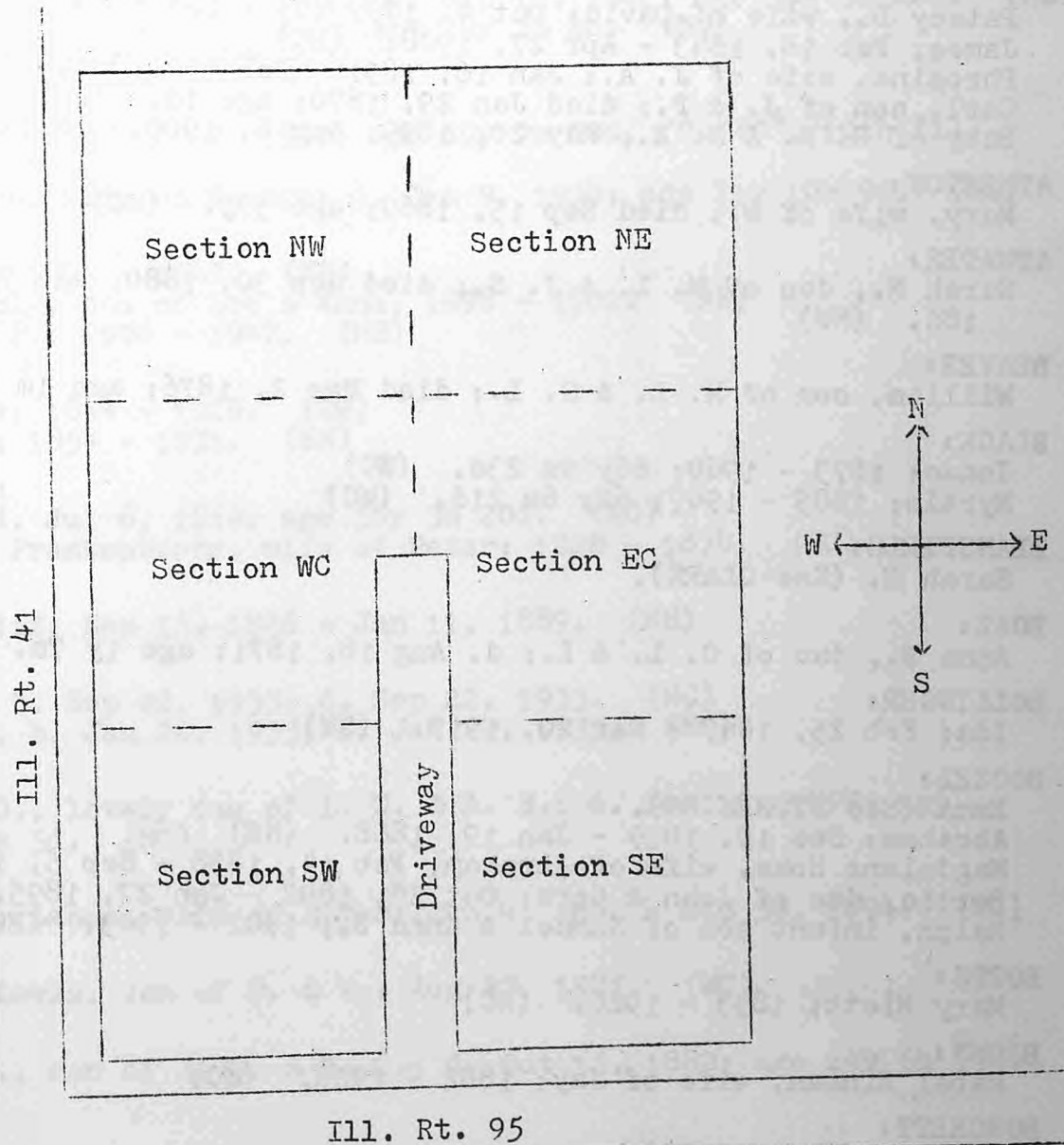

ADAMS:

Margaret E.; 1864 - 1940. (SW)
James D.; 1856 - 1938. (SW)
Newton; Nov 25, 1850 - Feb 13, 1892. (NW)
Laura Bell (See WILSON).

ALLEN:

Rufus Thompson; Aug 29, 1819 - Feb 26, 1904. (NE)
Rhoda, wife of Rufus; Dec 15, 1819 - Apr 20, 1917. (NE)
David; died Oct 18, 1881; age 84y 1m 1d. (NE)
Patsey D., wife of David; Oct 4, 1797 (?) - Oct 19, 1875. (NE)
James; Feb 18, 1843 - Apr 27, 1908. (EC)
Phrosine, wife of J. A.; Jan 16, 1851 - Feb 11, 1935. (EC)
Carl, son of J. & P.; died Jan 29, 1870; age 1d. (EC)
Baby of R. M. & M. E.; May 20, 1899; Aug 8, 1900. (EC)

ATHERTON:

Mary, wife of W.; died Sep 15, 1869; age 57y. (WC)

ATWATER:

Sarah M., dau of M. L. & J. S.; died Sep 30, 1880; age ?y 4m
18d. (NW)

BEAVER:

William, son of H. L. & S. L.; died Mar 2, 1876; age 1m 1d. (EC)

BLACK:

Isaac; 1873 - 1960; 86y 9m 23d. (WC)
Myrtle; 1885 - 1947; 62y 6m 21d. (WC)

BLANSFIELD:

Sarah E. (See CLARK).

BOAZ:

Anna B., dau of C. L. & L.; d. Aug 18, 1871; age 1y 7m. (NE)

BOLLINGER:

Ida; Feb 25, 1867 - Mar 20, 1919. (SW)

BOOZEL:

Emma (See STONEKING).
Abraham; Dec 19, 1819 - Jan 19, 1888. (NE)
Magdalane Hoke, wife of Abraham; Feb 14, 1838 - Sep 5, 1912. (NE)
Bertha, dau of John & Cora; Oct 28, 1892 - Jan 27, 1895. (NE)
Ralph, infant son of Samuel & Anna B.; 1902 - 1903. (IEC)

BOTTS:

Mary Hiatt; 1853 - 1926. (WC)

BROWN:

Mabel Hinman, wife of Jay; 1882 - 1928. (WC)

BURCHETT:

Lucy A. (See PARKER).

BURTON:

Roscoe N.; d. Feb 19, 1976; age 83y 11m 6d. (SE)

CADWALADER:

Mitilda F.; 1863 - 1949. (SW)
Henry L.; 1860 - 1940. (SW)

CAMPBELL:

Iva Lucile; 1896 - 1909. (NW)

CLARK:

Zaidee (See HAYES).

Jonathan; Sep 9, 1816 - Aug 16, 1896. (NE)

Milissa; May 1, 1830 - Mar 7, 1897. (NE)

Lucy M.; Apr 23, 1864 - Nov 9, 1895. (NE)

Sarah E. Blansfield; Feb 27, 1850 - Feb 17, 1919. (NE)

Anderson A.; d. Apr 12, 1919; age 73y 8m 8d. (NE)

Martha L., wife of Anderson; d. Sep 10, 1901; age 52y 5m 22d. (NE)

Lucius W.; d. Jun 18, 1899; age 29y 3m 2d. (NW)

Flora Turner (See LOFFTUS).

CONNOR:

George W.; d. Aug 22, 1900; age 69y 9m 20d. Co "C", 10th Ill.
Inf. (NE)

Nancy Ann, wife of George; d. Jan 9, 1904; age 71y 10m 9d. (NE)

CRABTREE:

Anne E.; 1875 - 1949. (NE)

Winnie Bly, dau of Lee & Anna; 1898 - 1902. (NE)

Barbara F.; 1900 - 1947. (NE)

CRAMBLET:

Theodore; 1844 - 1928. (SW)

Rebecca; 1854 - 1931. (SW)

CROWNOVER:

Peter; d. Jul 6, 1869; age 56y 3m 20d. (EC)

Mary G. Frankenberry, wife of Peter; 1828 - 1874. (EC)

DAVIDSON:

Vandagriff; Sep 12, 1826 - Jan 11, 1889. (NE)

DAY:

May I.; b. Sep 22, 1933; d. Sep 22, 1933. (WC)

Patty A. b. Jan 20, 1935; d. Jan 24, 1935. (WC)

DERRY:

Winnie D., lovely dau of L. C. & A. E.; d. Dec 16, 1899; age
19y 6m 5d. (WC)

DILTS:

Rusha A. Lance, wife of Elmer; Jan 4, 1862 - Sep 30, 1894. (WC)

DIMMITT:

Robert Lewis, son of D. & V.; Aug 27, 1921. (WC)

DOBBINS:

Finis E., son of J. C. & N. C.; d. Oct 15, 1882; age 24y 6m 19d.
(NW)

EBBERT:

Anna Hare; 1866 - 1939. (NW)

Samuel B.; 1864 - 1935. (NW)

Elmer D.; 1898 - 1938. (NW)

ENDRES:

Corda B.; 1878 - 1972. (NW)

John; 1879 - 1965. (NW)

FALER:

May Idola; d. Jan 26, 1942; age 63y 4m 20d. (WC)

George; b. Dec 30, 1882 - d. Oct 12, 1960. (WC)

Martha E. Price; 1877 - 1952. (WC)

FLEMING:

Andrew J.; Jan 27, 1830 - Aug 27, 1910. (WC)

Eliza C. Melvin, wife of Andrew; Nov 6, 1831 - Mar 17, 1914. (WC)

Lorena, dau of A. J. & E. C.; May 21, 1864 - Apr 10, 1953. (WC)

FRANKENBERRY:

Mary G. (See CROWNOVER).

FRASER:

Charlotte (See MURKEY).

FRIZZELL:

Johnsa; 1803 - 1892. (NW)

Catherine, wife of Johnsa; 1810 - 1902. (NW)

GARDNER:

Conwell Earl; Apr 26, 1876 - Jan 31, 1907. (NE)

Harriet Miller, wife of C. E.; Jun 14, 1877 - Oct 1, 1903. (NE)

J. Earl; Jul 9, 1888 - Feb 7, 1905. (NW)

Ethel E.; Sep 17, 1889 - Nov 6, 1894. (NW)

Loreta May; May 16, 1905 - Jul 17, 1905. (NW)

Zerilda; 1863 - 1937. (NW)

Joseph L.; Oct 19, 1831 - Aug 22, 1882. (NW)

Cornelia A., wife of Joseph L.; Jun 25, 1835 - May 31, 1920. (NW)

Jessie, son of J. L. & C. A.; d. Aug 7, 1880; age 1y. (NW)

Lewis L.; 1866 - 1944. (WC)

Jennie D.; 1870 - 1951. (WC)

R. Leo; 1898 - 1967. (WC)

Gaylord B.; 1896 - 1919. (WC)

GILLAM (GILLIAM)

Willie, son of J. G. & M. M.; d. Oct 15, 1872; age 1y 10d. (EC)

Bert; d. 1937; age 75y 2m 14d. (SW)

Verta Anna; d. at age 65y 5m 26d. (SW)

GOFF:

Pearl (See RICH).

GRAY:

I. Adelbert; 1845 - 1917. (NW)

Sylvia, wife of I. A.; 1844 - 1917. (NW)

George W.; 1879 - 1899. (NW)

GREEN:

George; d. Oct 31, 1872; age 50y 8m 23d. (WC)

HAYES:

Zaidee Clark; 1876 - (no date). (SW)

William H.; 1867 - 1954. (SW)

HENDRIX:

Mary (See RINGER).

HETHERLY:

Rebecca; d. Jun 1, 1936; age 81y 9m 28d.

HIETT:

Mary (See BOTTIS).
Jeremiah William; 1850 - 1929. (WC)
Father; '86. (WC)
Mother; '73. (WC)

HINMAN:

Mabel (See BROWN)
Orin W.; 1835 - 1908. (NW)
Cornelia M. Mosher, wife of Orin; 1840 - 1909. (NW)
Charles E., son of O. W. & C. M.; Jul 13, 1862 - Oct 2, 1879. (NW)
Mary; 1901 - 1943. (WC)
Earl; 1888 - (no date). (WC)
C. M. May 19, 1871 - Mar 9, 1914. (NE)
George Marion; Mar 23, 1907 - Jun 22, 1907. (NE)
Baby Jay; Jan 14, 1913 - Mar 29, 1913. (NE)
Amy; Jul 24, 1883 - Jan 11, 1968. (NE)

HOKE:

Madalane (See BOOZEL)

HOLMES:

Mary E., wife of E. E.; Jun 27, 1850 - Aug 1, 1884. (NW)
Little Tommy, son of J. M. & ?. T.; died Jan 16, 1871; age 1y
10m. (NW)

HUMPHREY:

Mary E. Sharp, wife of E. J.; Jun 15, 1843 - Mar 14, 1907. (NW)

INGRAM:

Infant son of W. H. & M. E.; born Jun 8, 1876. (NE)

? IRWIN ?

Jerry Lee; Sep 19, 1943 - Nov 15, 1943; age 6 weeks. (SW)

JAMES:

Francis M.; died Jul 17, 1879; age 24y 7d. (WC)

JONES:

Mary F. (See TURNER).
Sarah (See WELCH).

KING:

Mary S.; wife of D. B.; (no dates). (WC)
David B.; Sep 29, 1850 - Jan 8, 1946. (WC)

KUGLER:

Mary (See ROSE)
Hannah L.; Sep 20, 1804 - Jan 4, 1889. (NE)
George F.; Dec 11, 1831 - Jan 8, 1889. (NE)
Henry, son of G. F & Jane; May 20, 1885 - Nov 18, 1893. (NE)
Jane Taggart, wife of G. F.; Jul 9, 1842 - Jul 14, 1928. (NE)

LANCE:

Rusha A. (See DILTS).
Gladys, dau of G. S. & L. E.; died Jan 2, 1902; age 12 d. (NW)
Julius, son of G. S. & L. E.; died May 3, 1901; age 1y 6m 18d. (NW)
Mary A.; died Sep 10, 1896; age 70y 7m 12d. (NW)

LOFFTUS:

Flora Turner Clark; 1867 - 1954. (NW)

?LOMMON?:

Michael, son of J. & M. E.; died Jan 23, 1875; age 6m 6d. (EC)

LOVELL:

Mable E. Swartzbaugh; 1884 - 1960. (SE)

Joseph; 1882 - 1948. (SE)

LOY:

Willie A., son of L. & M.; died --- 23, 1875; age 1m 3d. (WC)

Albert G., infant son of L. & M. E.; died Feb 1, 1876; age 6d.
(WC)

William; Feb 28, 1847 - Jan 4, 1916. (WC)

Lillian I., wife of Wm.; Nov 19, 1863 - Jun 16, 1905. (WC)

William B., son of Wm. & L. I.; died Aug 12, 1903; age 6y 8m
13d. (WC)

Hazel, dau of Wm. & L. I.; died Nov 2, 1894; age 1m 29d. (WC)

LYBARGER:

Nancy M.; 1842 - 1879. (NE)

MANLY:

Allen; died Aug 7, 1870; age 82y 11m 4d. (EC)

Rachel, wife of A. M.; died Apr 19, 1872. (SC)

Catherine, wife of B.; died Jun 6, 1874; age 40y. (EC)

MANLEY:

Gertrude L., dau of A. W. & E.; 1881 - 1884. (NW)

MARTIN:

John; Sep 25, 1787 - Aug 15, 1876. (NW)

MC HENDRY:

Clair E.; Jan 19, 1920 - Nov 10, 1953. S1 USNR WWII. (NW)

MELVIN:

Eliza C. (See FLEMING).

Infant son of G. N. & L. J.; died May 7, 1874. (EC)

C. Martin; 1833 - 1915. (NW)

Elizabeth, wife of Charles; May 22, 1789 - Nov 6, 1876. (NW)

MAY:

Arrah W.; 1914 - 1915; age 7m. (WC)

Mary Almina; 1925 - 1926; age 8m. (WC)

MILLER:

Harriet (See GARDNER).

MILLINGTON:

Norman; Jan 2, 1818 - Aug 22, 1898. (WC)

Emily A., wife of Norman; Mar 27, 1839 - Jun 2, 1909. (WC)

Charlie; died May 30, 1874; age 4m 21d. (WC)

Birdie; died Oct 5, 1877; age 1y 1m 10d. (WC)

Allie E.; died Mar 14, 1882; age 2y 9m 15d. (WC)

(Later 3 were children of N. & E. A. MILLINGTON).

David; Feb 23, 1861 - Mar 13, 1896. (WC)

MOORE:

Jeffie E.; 1895 - 1958. (SW)
Walter E.; 1896 - 1934. (SW)
Harriet M.; 1868 - 1918. (SW)
Ellzy; 1868 - 1937. (SW)
Mary J.; 1849 - 1947. (SW)
Walter T.; 1847 - 1919. (SW)

MOSHER:

Cornelia M. (See HINMAN.)

MURKEY:

Charlotte Fraser; 1890 - 1966. (SE)

OSBURN:

Bertha, dau of Emmaline; Oct 28, 1884 - Dec 28, 1887. (NE)

PARKER:

Orpha J. (See STEWART).
Burnice, twin dau of J. W. & L. A.; 1898 - 1899. (NW)
Gale Richard, son of J. W. & F.; 1895 - 1899. (NW)
Fannie E., wife of J. W.; died Apr 11, 1896; age 23y 3m 19d. (NW)
Lucy A. Burchett; 1879 - 1973. (WC)
John W.; 1864 - 1949. (WC)
Charles R.; 1860 - 1947. (WC)

PORTLOCK:

Johnsa L., son of S. V. & M. L.; died Oct 11, 1880; age 22y 9m 14d. (NW)

PRICE:

Martha E. (See FALER).

RHODES:

Minerva; 1855 - 1939. (NW)
Isaac; 1852 - 1931. (NW)
Elva Roy, son of I. L. & M.; died Jan 31, 1884; age 1y 10m 25d. (NW)

RICH:

Pearl Goff; 1890 - 1936. (NE)
Gloyd S., son of W. G. & J. M.; Jul 21, 1888 - Feb 17, 1899. (NE)

RICHARDS:

Harvey A.; Jan 10, 1855 - Oct 19, 1903. (NW)
Mary L., wife of Harvey; Aug 22, 1857 - Jan 27, 1942. (NW)
James F.; May 4, 1825 - Feb 6, 1878. (NW)
Martha J.; Sep 1, 1834 - May 5, 1900. (NW)
Gracie, dau of C. O. & J. R.; died Jan 24, 1878; age 1y 5m 12d. (NW)
Julia R., wife of ??; died Jul 19, 1879; age 24y 6m 17d. (NW)

RICHARDSON:

Vada; Jul 3, 1894 - May 9, 1973. (SE)

RINGER:

John; 1816 - 1881. (NW)
Mary Hendrix, wife of John; 1825 - 1910. (NW)

ROBERTS:
 Andy M.; 1863 - 1933. Co "H", 6th Ill. Inf. Sp. Am War. (SW)

ROBINSON:
 Martin; Aug 26, 1815 - Jun 12, 1885. (NE)
 Elzina, wife of Martin; Jun 20, 1834 - (no date). (NE)

ROSE:
 Mary Kugler; Jul 18, 1867. (NE)
 Shirley B.; May 18, 1874 - Jul 20, 1950. (WC)
 Nanetta; Jun 2, 1880 - Feb 7, 1948. (WC)

ROSS:
 Clifford; Jan 6, 1879 - Jan 31, 1901. (NW)

SCOTT:
 Walter H.; Jan 30, 1875 - Mar 1, 1901. (NE)
 Hannah, wife of H. R.; Apr 21, 1832 - Dec 6, 1914. (NE)
 Harrison R.; Jul 2, 1818 - Sep 3, 1888. (NE)

SCUDDER:
 Irvin, son of A. & D.; 1899 - 1909. (NE)
 Alta; 1863 - 1932. (NE)
 Duston; 1857 - (no date). (NE)

SHANNON:
 Angie M., wife of Edward; May 12, 1854 - Sep 21, 1901. (NE)

SHARP:
 Mary E. (See HUMPHREY).
 Lewis; Nov 5, 1873 - Sep 20, 1900. (NW)
 Thomas; died Dec 24, 1891; age 81y. (NW)
 Elizabeth, wife of Thomas; died Feb 15, 1896; age 78y. (NW)
 Mattie; Aug 16, 1850 - Jun 16, 1916. (NW)

SHEETS:
 George W.; 1901 - 1971. (SW)
 Ira H.; 1878 - 1946. (SW)
 Dora D.; 1876 - 1952. (SW)

SHELEY:
 Eddie A., son of J. W. & S. L.; died Sep 13, 1872; age ---. (EC)

ST. CLAIR:
 Lillian; 1869 - 1956. (SW)
 Joseph K.; 1867 - 1930. (SW)

STEWART:
 Orpha J. Parker, wife of Wm. S.; 1862 - 1948. (WC)

STONEKING:
 Emma Boozel; 1862 - 1938. (NE)

SULLIVAN:
 Lottie M.; 1885 - 1970. (SE)
 Joseph F.; 1884 - 1947. (SE)

SWARTZBAUGH:
 Mabel E. (See LOVELL).
 Ronald Glen; Sep 12, 1947 - Mar 7, 1964. (SE)
 Edna; 1889 - 1961. (SE)

SWARTZBAUGH:

Glenn J.; 1887 - (no date). (SE)
Mary Ann; Sep 6, 1843 - Feb 26, 1902. (EC)
John W.; 1837 - 1921. (EC)
Lorena Alas; Jun 11, 1875 - Dec 5, 1880. (EC)
Galvin E., son of J. W. & M. A.; Oct 26, 1871; age 1y 1m 3d. (EC)
Nancy, dau of J. W. & M. A.; died Oct 28, 1874; age 1y 2d. (EC)
Juanita, dau of G. R. & M. A.; died Apr 26, 1909; age 5y. (NW)
Minnie May, dau of John W. & Mary Ann; Jun 8, 1880 - Mar 17,
1918. (NW)
Sarah S.; 1867 - 1953. (WC)
Isaiah M.; 1860 - 1943. (WC)

SWISE:

Leither; 1887 - 1945. (SW)
Charles H.; 1883 - 1968. (SW)

TAGGART:

Jane (See KUGLER).

THRASHER:

Lillie; 1877 - 1954. (SW)
Frank; 1874 - 1951. (SW)
Dewey; 1900 - 1931. (SW)

THROCKMORTON:

Henrietta, wife of James; Aug 30, 1856 - Mar 23, 1885. (WC)

TURNER:

Laura C.; Oct 17, 1886 - Feb 10, 1889. (NE)
Glenn; Apr 5, 1885 - Feb 13, 1889. (NE)
(Above 2 were children of Rev. E. H. & P. J. TURNER.)
E. Herbert; 1861 - 1926. (NE)
Phoebe J., wife of E. H.; 1858 - 1929. (NE)
Mary E., wife of Isaac; 1848 - 1926. (NW)
E. Josephine, dau of Isaac & M. E.; 1881 - 1903. (NW)
Isaac; 1822 - 1892. (NW)
George W., son of Isaac; 1864 - 1881. (NW)
I. Burton; Nov 2, 1858 - Sep 2, 1898. (NW)
Mary F. Jones, wife of I. B.; Oct 30, 1863 - Sep 11, 1905. (NW)

WALKER:

Phebe A., wife of Jesse; died Jan 31, 1873; age 65y 9m 18d. (EC)

WALTERS:

Mary F.; 1888 - 1970. (SW)
Samuel E.; 1879 - 1957. (SW)

WEAVER:

Grant; 1869 - 1947. (SW)
Molana; 1875 - 1961. (SW)
Virgil W.; Jun 21, 1974; age 77y 9m 15d. (WC)

WEED:

Sarah E., wife of Rev. S. J.; May 24, 1855 - Jul 23, 1884. (NE)
Sarah Stella, dau of Rev. S. J.; Jul 20, 1884 - Sep 27, 1884.
(NE)

WELCH:

John S.; Apr 30, 1848 - Jun 20, 1904. (NW)
Frances, wife of John; 1852 - 1937. (NW)
Rax; Nov 14, 1818 - Dec 9, 1884. (NW)
Sarah Jones, wife of Rax; Dec 11, 1820 - May 6, 1907. (NW)
Florence J.; 1863 - 1951. (NW)
Herbert F.; 1856 - 1937. (NW)

WILSON:

Charles; 1868 - 1948. (NW)
Laura Bell Adams; 1858 - 1942. (NW)

YOUNG:

Our Darling Elmer, son of Orville & Alma; Mar 3, 1920 - Aug 22,
1928. (SW)
Orville; 1885 - 1945. (SW)
Charles W.; 1893 - 1917. (NW)
H. L.; Co "A", 49th Ill. Inf. (No dates). (NW)

NOTE: Five stones in this cemetery were totally unreadable at the
time of this study made in September, 1974.

Genealogical Notes - Mound M. E. Cemetery

ALLEN: Rhoda (1819-1917), wife of Rufus T. Allen; maiden name was
Allen. A son, John, b. at Somerset, Ky., Jul 23, 1841, d. in
Macomb in 1922. (Obit, in part, from The Macomb Daily Journal,
Apr 20, 1917): "Mrs. Rhoda Allen who is generally believed to
have been the oldest woman, if not the oldest citizen, of Mc-
Donough county, passed away this morning at 5:40 o'clock at the
home of her daughter, Mrs. William Ingram, on East Carroll street,
after a brief illness of heart trouble.....She was 97 years, 4
months, and 5 days of age.....She was an unusually healthy lady
for her years, never having suffered with a headache or the
slightest sickness with the exception of one time when she was
a short time with pneumonia, and her last illness.....Deceased
was born in Pulaski county, Kentucky, near Somerset, Dec. 15,
1819. There she lived for a number of years and was united in
marriage to R. Thompson Allen, Nov. 19, 1840. They left Kentucky
in 1854 and migrated to Missouri, where they spent eleven years,
coming to this State in 1863, and settled near where Good Hope
now is, and lived there but a short time before taking up their
residence east of this city nine miles. In 1894, they moved to
this city, and Mr. Allen passed away thirteen years ago last
February.....She was a member of the Cottonwood Baptist Church..
..She was the last of a family of ten children and has lived to
see five generations of her family. They are: son, John Allen,
his daughter, Mrs. Oscar Thompson; her son, Laverne, and his baby
son, Aten Thompson. Two children, John Allen and Mrs. Wm. Ingram,
both of East Carroll street, this city, are the only surviving
ones to mourn the loss....One son, James, is deceased."

David (d. Oct 18, 1881); age 84y 1m 1d; farmer; widower; b. at
Charleston, S. C.; resident of Ill. 10 years; d. Mound Twp.

- ATWATER: Sara Malissa; d. Sep 30, 1880; age 14y 4m 18d; b. in this county; d. of typhoid fever in Mound Twp.
- BOOZEL: Ralph (1902-1903), son of Samuel and Anna B.; (Death notice, in part, from The Macomb Times, Jan 22, 1903): "Ralph Boozel of Mound township died at the hospital Saturday afternoon at 1:30 o'clock after a surgical operation to removed a tumor from the brain, aged 2 months, 21 days....."
- CLARK: Melissa (1830-1897) (Obit, in part, from The Macomb Eagle, March 11, 1897): "Mrs. Jonathan Clark died at her home in New Philadelphia last Sunday morning, aged 68 years, 6 months and 24 days. The funeral was preached by Rev. Dodge, of Prairie City, at the Mound M. E. Church Monday, after which the remains were laid to rest in the M. E. cemetery beside those of her husband, who died some seven months ago. She leaves four daughters and two sons: Mrs. J. B. LeMatty, Mrs. J. M. Humphrey, Mrs. Herbert Turner, and Mrs. John McClure, of N. Philadelphia, and G. M. Clark, of Macomb."
- Lucy M. (1864-1895) (Death notice from The Bardolph News, Nov 13, 1895): "Mrs. Lucy Clark, wife of Jay Clark, was buried at the Mound cemetery on last Sunday. Mrs. Clark had long suffered from an internal tumor and underwent an operation at Chicago for its removal. She survived the ordeal but a short time. The deceased was a daughter of Jonathan Clark, who resides east of Bardolph."
- DAILEY: Gale Leslie; d. Oct 20, 1923; age 15y 4m 14d; b. near Macomb; son of Warren & Bernice (Rich) Dailey; buried Mound M. E. cemetery.
- DOBBINS: Finis E. (Death notice, in part, from The Macomb Journal, Oct 19, 1882): "Fineas S. Dobbins, son of John and Nancy Dobbins died last Sunday....." Farmer; age 25y 6m 17d; single; born Cass Co., Mo.; resident of Ill. 17 years; d. at Bardolph.
- GARDNER: Jessie; d. Agu 7, 1880; age 2y; b. & d. Mound Twp.
- GRAY: Sylvia (1844-1917) (Obit, in part, from The Macomb Daily Journal, Nov 7, 1917): "Mrs. Del Gray died at the St. Francis hospital, Tuesday at 7 P.M., of Bright's disease, with which she had been suffering the past two years, aged about 65 years.Mrs. Gray buried her husband only two months ago. For several years they lived on the William Ingram farm, but have resided in Bardolph the past six or seven years. Se children survive....."
- HINMAN: Charles E.; d. Oct 2, 1879; of typhoid fever; age 17y 2m 19d; farmer; b. Ill.; d. New Salem Twp.
- HOLMES: Mary E. (Death notice from The Macomb Journal, Aug 14, 1884): "Mrs. Emery Holmes of the New Philadelphia area died recently; she is survived by a husband and 5 children."

- INGRAM: The infant, that died in 1876, was a child of William H. and _____ (Allen) Ingram. This family lived in this area for several years before moving to Macomb where they lived on E. Carroll street. Mrs. Ingram was a daughter of Mr. and Mrs. Rufus Thompson Allen.
- MANLEY: Elizabeth Gertrude; d. Feb 25, 1884; age 2y 3m 26d; b. & d. in Mound Twp.
- PORTLOCK: Johnson L.; d. Oct 11, 1880 of typhoid ; age 22y 9m 14d; single; farmer; b. in this county; d. at Bardolph.
- RINGER: John (Death notice from The Macomb Journal, Mar 31, 1881): "Old Mr. Ringger of Mound Twp., was buried on the 10th."
- ROBINSON: Martin (Death notice, in part, from The Macomb Journal, Jun 18, 1885): "Mr. Robinson died June 12th age 70 years. He had lived in the vicinity of New Phila. since 1855. He is survived by a widow."
- SCOTT: John; d. Nov 29, 1880; age 90y 5m 3d; shoemaker till age 40, then a minister; widower; b. in Mass.; resident of Ill. 48 years; d. at Prairie City.
- SHANNAN: Infant male; d. Aug 19, 1879; age 2d; b. & d. in Mound Twp.
- SWARTZBAUGH: John W.; d. Oct 10, 1921 at New Phila.; age 84y 8m 9d; b. Jan 31, 1837 at Condras Twp., Pa.; son of John A. and Mary Ann (Bupp) Swartzbaugh; John A. b. Md.; Mary, b. Pa. John W. was a farmer in Mound Twp.
- TURNER: George W.; d. Oct 24, 1881; age 16y 11m 26d; farmer; b. Pa.; d. of typhoid fever in Mound Twp.
Phoebe J. (1858-1929), wife of E. Herbert; daughter of Jonathan and Milissa Clark.
- YOUNG: H. L. (no dates) (Death notice from The Macomb By-Stander, Jul 1, 1896): "Harry Young, Sr., died at his late home in New Philadelphia Thursday, June 25. He had been sick but a short time and his death was unexpected. The funeral was conducted by Rev. Lumpkin at the Methodist church on Friday and the interment was in the same cemetery."

Notes, Corrections, Additions, and Changes

UPPER MOUND CEMETERY

Location: Mound Township; SE $\frac{1}{4}$, Section 14; 1 mile north, $\frac{1}{2}$ mile east of New Philadelphia.

Remarks: This cemetery is regularly maintained and is in excellent condition; also known as the Sheets Graveyard or Dyer Cemetery.

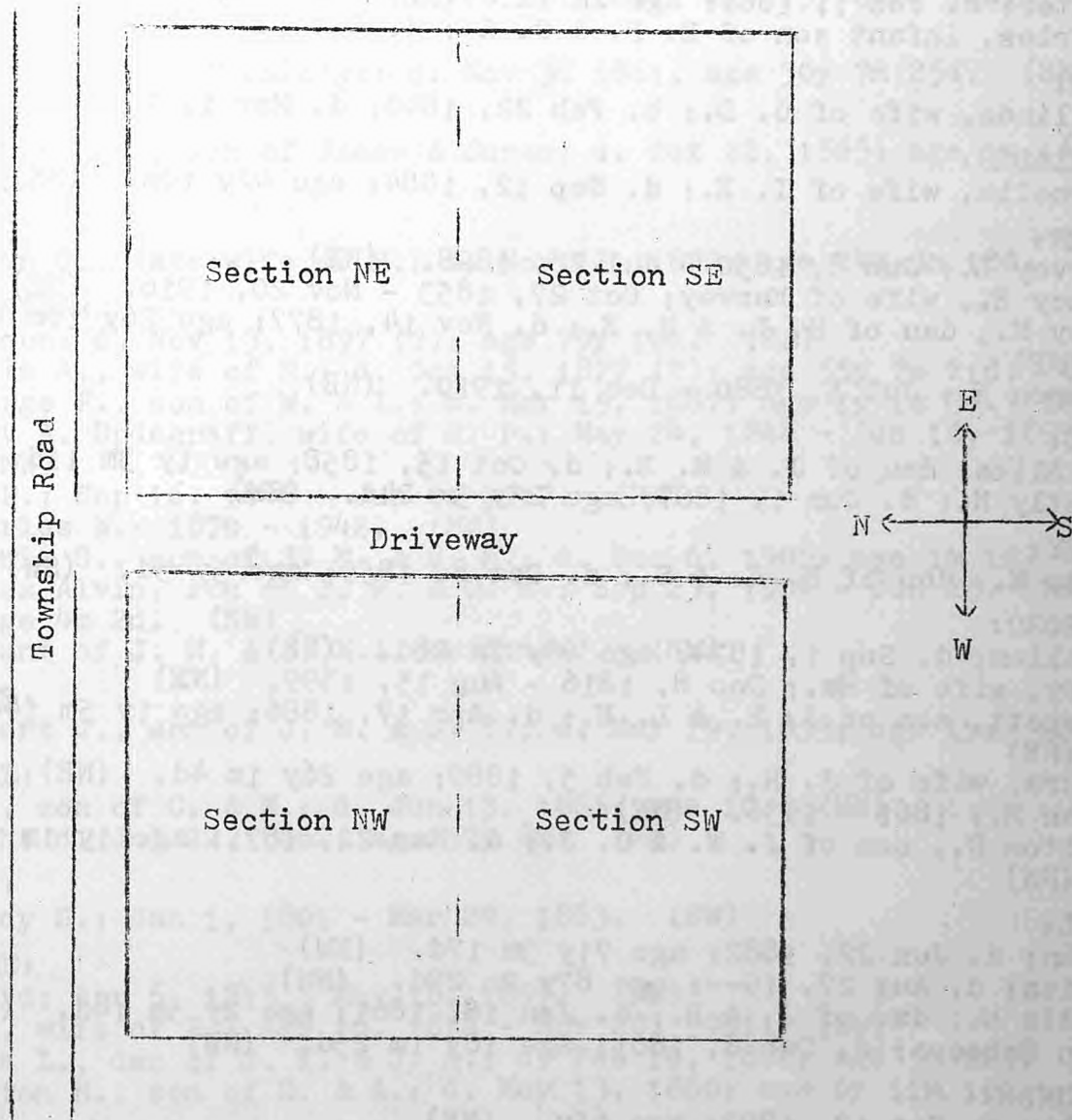

ANDERSON:
Rosana; d. Mar 23, 1864; age ?50?y 7m 17d. (SW)

BAILEY:
James M., son of L. & M.; d. Jul 9, 1855; age 21y 3m 25d. (SW)

BARTLETT:
 Father William; 1835 - 1902. (SW)

BOND:
 Mary C., wife of J. H.; d. Jun 6, 1865; age 24y 21d. (SW)

BOZLEY:
 Calista Stanton; Oct 11, 1817 - Mar 17, 1886. (NW)

BROWN:
 Lena May, dau of E. F. & C. S.; d. Nov 8, 1882; age 10m 10d. (NE)
 Walter; d. Feb 1, 1881; age 2m 1d. (NE)
 Charles, infant son of E. F. & C. S.; d. Oct 18, 1885. (NE)

BYOUS:
 Philinda, wife of O. D.; b. Feb 22, 1840; d. Mar 1, 1884. (SW)

CADWALADER:
 Permelia, wife of I. E.; d. Sep 12, 1884; age 42y 10m. (NE)

CARTER:
 Harvey L.; Jun 8, 1850 - Jul 28, 1898. (NE)
 Nancy E., wife of Harvey; Oct 27, 1853 - Nov 20, 1916. (NE)
 Lucy M., dau of H. L. & N. E.; d. Nov 14, 1877; age 26y 10m 14d.
 (NE)
 Simeon E.; Jul 5, 1880 - Dec 11, 1910. (NE)

CLARK:
 A. Eliza, dau of J. & M. E.; d. Oct 15, 1858; age 1y 3m 11d. (NE)
 Bently N.; d. Jun 1, 1867; age 23y 5m 24d. (SW)

COOLEY:
 Kate M., dau of F. A. & S.; d. Oct 8, 1859; age 5y 5d. (SW)

CRAWFORD:
 William; d. Sep 1, 1874; age 68y 2m 28d. (NE)
 Mary, wife of Wm.; Dec 8, 1816 - Aug 15, 1899. (NE)
 Everett, son of J. H. & L. E.; d. Apr 17, 1886; age 1y 5m 14d.
 (NE)
 Laura, wife of J. H.; d. Feb 5, 1889; age 26y 1m 4d. (NE)
 John H.; 1861 - 1936. (NE)
 Milton D., son of J. W. & O. J.; d. Mar 22, 1871; age 1y 1m 11d.
 (NW)

CROWL:
 John; d. Jun 22, 1882; age 71y 3m 17d. (NW)
 Eliza; d. Aug 27, 19--; age 87y 2m 27d. (NW)
 Lydia M., dau of J. & E.; d. Jan 16, 1861; age 2y 5m 14d. (NW)
 Ann Rebecca; d. Dec 8, 1861; age 16y 1m 25d. (NW)

CULLUMBER:
 John; d. Sep 13, 1893; age 65y. (NE)
 Drusilla, wife of John; d. Apr 6, 1890; age 58y 9m 3d. (NE)

DELFORD:
 Eleanor, wife of T.; d. Jul 7, 1866; age 60y 9m 21d. (NE)

DERRY: (?)
 Ethel May, dau of J. W. & L. A.; died Jan 31, 1899; age 3y 9m
 9d. (SE)

DONKLE:

Mary (See SHEETS).

DIER:

Mary A., dau of E. & J.; d. Feb 10, 1853; age 1y 13d. (SW)

Edward, son of E. & J.; d. Oct 23, 1859; age 8y 21d. (SW)

George W., son of E. & J.; d. Aug 18, 1855; age 5m 4d. (SW)

FORTNER:

George F.; d. Sep 14, 1859; age 24y 7m 20d. (SW)

GIBBS:

Marion, son of J. & M.; d. Feb 26, 1877; age 15y 2m. (SW)

GURNEY:

George; Res. of Chicago; d. Nov 3, 1861; age 30y 7m 25d. (SW)

HAVENS:

Jonathan H., son of James & Susan; d. Oct 22, 1863; age 1m 16d.
(SW)

HEAD:

Susan G., late wife of H.; d. Nov 12, 1872; age 24y 3m 12d. (SW)

HOLLISTER:

Munson; d. Nov 13, 1897 (?); age 79y 10m. (SE)

Julia A., wife of M.; d. Oct 15, 1877 (?); age 55y 7m 21d. (SE)

George F., son of W. & L.; d. Mar 15, 1887; age 1y 1m 3d. (SE)

Mary A. Updegraff, wife of S. P.; May 24, 1848 - Jun 10, 1899.
(NW)

S. P.; Sep 16, 1846 - Jun 6, 1917. (NW)

Charles W.; 1870 - 1942. (NW)

Vernie G., son of J. M. & D. M.; d. Dec 6, 1900; age 1m 1d. (NW)

James Alvin, son of J. M. & D. M.; Sep 23, 1904 - Jan 25, 1905;
age 4m 2d. (NW)

Infant of J. M. & D. M.; (no dates). (NW)

HOLMES:

Albert J., son of J. M. & S. T.; d. May 19, 1853; age 1y. (NW)

HUKILL:

Ira, son of C. & M.; d. Jun 13, 1865; age 1d. (NW)

Seth; d. Jul 22, 1862; age 57y 8m. (NW)

JAMES:

Nancy S.; Jan 1, 1801 - Mar 29, 1863. (SW)

KEPPLE:

David; Apr 6, 1815 - May 18, 1891. (NW)

Ann, wife of D.; Apr 16, 1816 - Nov 29, 1901. (NW)

Adda L., dau of J. K. & J. A.; d. Feb 10, 1866; age 5m 10d. (NW)

Milton H., son of D. & A.; d. May 13, 1860; age 6y 11m 10d. (SW)

KOST:

Samuel; Jan 25, 1817 - Jan 21, 1880. (NE)

Ruth A., wife of S.; d. Aug 20, 1875; age 58y 6m 19d. (NE)

Mary, dau of S. & R. A.; d. Jul 12, 18--; age 15y 9m 2d. (NE)

Cora, dau of J. W. & M. E.; d. Jun 24, 1870; age 11m 21d. (NE)

Frank, son of J. W. & M. E.; d. Jan 15, 1872; age 4m 17d. (NE)

Permelia, dau of J. W. & M. E.; d. Sep 1, 1868; age 1m 18d. (NE)

KOST:

John W.; d. Mar 14, 1875; age 28y 6m 15d. (SE)
Effie, dau of J. W. & M. E.; d. Jun 15, 1874; age 1y 3m 6d. (SE)

LANGE:

Infant dau of J. B. & A. E.; d. Nov 13, 1873. (NW)
Infant dau of J. B. & A. E.; d. Feb 26, 1871; age 3m 10d. (NW)

LANGSFORD:

J. H.; d. Nov 26, 1900; age 82y 8m 20d. (SE)
Narsissa W.; d. Jul 26, 1898; age 78y 9m 20d. (SE)

LANGSTON:

Maud A., dau of A. G. & M. M.; d. Dec 3, 1886; age 4y 10m 8d. (SE)
John T., son of A. G. & M.; d. Aug 9, 1871; age 2y. (SE)
Mary M., dau of A. G. & M.; d. Nov 30, 1875; age ---. (SE)

LEMASTER:

Joseph F.; 1847 - 1922. (NE)
Mary L.; 1850 - 1917. (NE)
Elizabeth, wife of J. F.; d. Oct 28, 1881; age 24y 6m 26d. (NE)
George W.; Dec 22, 1832 - Jun 18, 1901. (NW)
Eliza J., wife of George; Oct 18, 1844 - Jan 26, 1901. (NW)
Jane A., wife of -----; d. Mar 17, 1874; age 25y 6m 9d. (SW)
Everett, son of -----; Aug 28, 1871 - Apr 26, 1876. (SW)
Emily, wife of James; Jan 28, 1813 - Feb 11, 1896. (SW)
James; Jan 8, 1804 - Dec 23, 1893; age 89y 11m 15d. (SW)
Joseph; d. Mar 4, 1876; age 55y 7m 12d. (SW)

LINDSAY:

Jesse O., son of H. & S.; d. Dec 5, 1872; age 5y 10m 5d. (NW)
Ella, dau of H. & S.; d. Jun 8, 1875; age 6y 6m 4d. (NW)

LITTLE:

George, son of T. P. & E.; d. Nov, 1860; age 11m. (SW)
Tobias, son of T. P. & E.; d. Sep, 1864; age 10m. (SW)
Infant dau of T. P. & E.; d. 1858. (SW)

MAKINSON:

George W.; Sergt., Co "B", 98 Ohio Inf. (No dates). (SE)
Lizzie B., dau of G. W. & A. M.; d. Feb 2, 1875; age 1y 3m 9d. (SE)

MC DONALD:

Josiah; Oct 18, 1858 - Mar 28, 1882. (SE)
Johnie, son of J. & M. H.; Jan 31, 1881 - Feb 15, 1881. (SE)
Isaac G.; Mar 3, 1815 - Apr 14, 1883. (SE)
Catherine, wife of I. G.; Sep 9, 1830 - Sep 6, 1895. (SE)
Emma L., dau of I. G. & C.; Nov 5, 1864 - Mar 27, 1890. (SE)

MC DONOUGH:

Sarah, wife of Redman; Feb 5, 1817 - Jan 26, 1888. (SE)
Redman; d. Aug 30, 1879; age 65y 11m 29d. (SE)
Jemima, dau of R. & S.; d. May 3, 1867; age 27y 2m 27d. (SE)
Willie, son of J. W. & R. A.; d. Apr 30, 1872; age 10m 14d. (SE)

MC MANIMIE:

W. W.; Sergt., Co "G" 50 Ill. Inf. (No dates) (NW)
Lucy W., wife of W. W.; d. Nov 6, 1884; age 41y. (SW)

MC MANIME:

Infant; 1879. (SW)
Mary; 1872 - 189-. (SW)

MC VAY:

John; d. Aug 19, 1864; age 74y 2m 12d. (SW)
Ann, wife of John; d. Feb 10, 1862; age 64y 5m 1d. (SW)

MELVIN:

John T.; Aug 25, 1840 - Sep 28, 1898. Co. "B" 10th Reg. Mo.
Vol. Inf., 1861-64, GAR. (NE)
Margaret, wife of J. T. (NE)

MILLER:

Elizabeth, dau of P. & S. J.; Jun 17, 1878 - May 15, 1883. (NE)
J. H.; d. Sep 15, 1889; age 42y 6m. (NE)
Barbery G., dau of A. & E.; d. Dec 31, 1863; age 20y 17d. (NW)

MITCHELL:

John M.; d. Feb 6, 1859; age 37y 6m 5d. (NW)
John M., son of E. & N.; d. Jan 6, 1867; age 17y 10m 19d. (NW)
Edward; d. Jan 2, 1867; age 48y 3m. (NW)

MOATS:

Charity, wife of F. B.; d. Apr 7, 1865; age 40y 1m 2d. (SW)

MODESITT:

Justis M., son of M. & ?A. J.?; d. Apr 29, 1859; age 3m 2wks 3d.
(SW)

MOREY:

Sarah Nicholson; Sep 12, 1855 - Oct 9, 1913. (NE)

MYERS:

Sophia, wife of James; d. May 10, 1864; age 42y 8m 9d. (SW)
James G., son of J. & S.; d. Nov 19, 1857; age 5y 2m 13d. (SW)

NICHOLSON:

Sarah (See MOREY).

PARKER:

Genora, dau of E. B. & R. J.; d. May 22, 1864; age 7m 14d. (SW)

PORTER:

Infant son of W. M. & A.; d. Nov 10, 1886; age 9d. (SE)

PURMAN: (PERMAN)

Mary, wife of Wm.; d. Jan 6, 1864; age 44y 7m 22d. (SW)
John W., son of J. H. & M. C.; d. Dec 11, 1862; age 5d 6hrs. (SW)
Infant dau of W. & M.; d. Mar 15, 1860. (SW)
Infant son of J. H. & M. C.; d. Apr 25, 1861; 10hrs. (SW)
Mary C., dau of George W. & M. M. Sheets and wife of J. H. Perman;
b. Aug 24, 1833; d. Apr 30, 1869. (SW)

PURNELL:

William, son of J. & V.; d. Jan 23, 1872; age 13y 5m 15d. (NE)

RICE:

George A., son of G. M. & E.; d. Aug 31, 1862; age 9m 20d. (SW)
Elizabeth, wife of George M.; d. Jun 25, 1865; age 35y 9m 4d.
(SW)

RIDDLE:

John; d. Sep 10, 1870; age 69y 11m 11d. (NW)
Christena, wife of John; d. Oct 17, 1865; age 61y 11m 15d. (NW)
Logan H., son of H. & H.; d. Apr 11, 1868; age 1y 1m 14d. (SW)
Thomas; d. Feb 5, 1890; age 62y 4m 24d. (SW)

RINGO:

Alfred W., son of A. & E.; d. Jan 7, 1856; age 2y 6m 16d. (NW)
Elizabeth, dau of A. & E.; d. Jan 19, 1855; age 17d. (NW)

SANDERS:

Charles, son of -- & M. F.; d. Feb 22, 1860; age 8m 5d. (SW)
George, son of C. D. & J. M.; d. Jan 20, 1866; age 9m 30d. (SW)

SCOTT:

Jane M., wife of W. C.; d. Dec 26, 1858; age 62y 9m 24d. (SW)
John; b. at Westford, Mass., Aug 3, 1790; d. at Prairie City,
Ill., Nov 28, 1880. (SW)

SHAW:

Infant dau of A. M. & M.; d. May 6, 1879; age 3d. (NW)

SHEETS:

Mary Dunkle, wife of H. W.; 1837 - 1911. (SE)
Henry W.; 1835 - 1911. (SE)
Margaret J., wife of G. W.; b. in Augusta Co., Va., Nov 28,
1809; d. Mar 15, 1869; age 59y 3m 18d. (SW)
George W.; d. Feb 14, 1887; age 79y 11m 18d. (SW)
Twin sons of G. R. & A. K.; Orrin; d. Feb 8, 1875; age 5y 5d.
Oscar; d. Feb 17, 1876; age 6y 14d. (SW)
John H., son of G. R. & A. K.; d. Sep 25, 1872; age 11m 17d. (SW)
Milan K., son of H. W. & M. J.; Oct 2, 1865 - Nov 25, 1870. (SW)
Michael A., son of H. W. & M. J.; d. Dec 3, 1861; age 2m 26d.
(SW)
Mary C.; (See PURMAN/PERMAN).

SIVELY:

Elizabeth, wife of Joseph; d. Oct 12, 1858; age 72y 11m 11m. (NW)

SLATER:

Victoria, dau of J. & E.; d. Dec 11, 1874; age 9y 2m. (NE)
John, son of J. & E.; d. Jul 26, 1870; age 2m 15d. (NE)

SMITH:

Mary J., dau of Thomas & M.; d. Sep 23, 1865; age 11y 4d. (SW)

SNAPP:

James N., son of A. & B.; d. Apr 22, 1858; age 6m 16d. (SW)

SNCOOK:

Henry; d. Jun 18, 1891; age 75y 7m 1d. (NE)
Fanny, wife of H.; d. Mar 18, 1886; age 67y 4m 4d. (NE)
Adline L., dau of H. & F.; Mar 28, 1854 - Jun 26, 1879. (NE)

SOLOMON:

James H.; d. Jul 4, 1874; age 39y 6m 9d. (SE)
Harriet N., wife of J. H.; d. Nov 18, 1893; age 64y 16d. (SE)

SPARGER:

William H., son of Julia; d. Jul 13, 1871; age 1y 3m 9d. (NE)

SPEAR:

Laura E., dau of J. T. & S. E.; d. Jan 13, 1864; age 7m 9d. (SW)
Malinda, dau of D. & L. A.; d. Jun 2, 1863; age 20y. (SW)

SWAYZE:

Sadie, dau of H. C. & Mary E.; (no dates). (NW)

THOMAS:

Laura, wife of Wm.; d. May 15, 1865; age 40y 3m 27d. (NE)
William; d. Sep 15, 1864; age 51y 3m 2d. (NE)
Frances E., dau of J. P. & S. O.; d. Jan 1, 1861; age 2y 11d.
(NW)
Frances, wife of Lloyd; d. Oct 4, 1859; age 52y 11m 21d. (NW)

UNKNOWNNS:

-----; Three twin infants -- 2 sons & 1 dau of E. & --; d.
Jan 14, 1863. (NW) (NOTE: This single stone is broken and
portions are unreadable at this time. Local history sources
report the birth of triplets to a Mr. & Mrs. Thomas of New
Philadelphia in the early 1860's; all died at birth. This is
possibly the monument to those children.)

-----; Lillie; d. Dec 12, 1863; age 3y 2m 17d. (NW) (NOTE:
No surname on this stone; it is located between stones of Crowl
and Holmes.)

UPDEGRAFF:

Mary A. (See HOLLISTER.)

WALLACE:

Cyrus M., son of E. G. & L.; d. Jun 9, 1859; age 18y 5m 9d. (SW)
William F., son of E. G. & L.; d. Sep 23, 1868; age 25y 6m 21d.
(SW)

WALTERS:

Eva E., dau of J. & H.; d. Oct 1, 1862; age 1y 3m 6d. (NW)
Ida E., dau of J. & H.; d. Jul 21, 1863; age 1d. (NW)
Infant dau of W. & M. E.; d. Nov 12, 1854; age 10d. (NW)
L. Orilla, wife of Michael; Aug 26, 1873 - Jul 21, 1904. (NW)
Rhoda M., dau of Wm. & M. E.; d. -----; age 6y 24d. (NW)

WELCH:

Jacob R.; Jun 27, 1835 - Jun 22, 1907. (NW)
Almeda, wife of Jacob; Jul 7, 1845 - Apr 27, 1909. (NW)
Sarah M., dau of J. R. & A.; d. Jan 7, 1878; age 10y 5m 20d. (NW)
Isaac, son of J. R. & A.; d. Jan 8, 1878; age 11y 1m 16d. (NW)
Isaiah; d. Nov 27, 1862; age 53y 3m 20d. (SW)
Lucy J., dau of R. & S.; d. Sep 27, 1864; age 1y 3m 1d. (SW)

WILSON:

S.; d. Jan 21, 1900; age 22y 10m 13d. (NE)
John; 1823 - 1899. (NE)
Zerilda; 1844 - 1922. (NE)
Susan, dau of R. & E.; d. Feb 16, 1866; age 2y 27d. (NW)
Mary A., dau of M. & S. E.; d. Sep 19, 1862; age ---. (NW)
Granvill W., son of S. & L.; d. May 20, 1856; age 5y 20d. (SW)
Liuna, dau of B. B. & E.; d. Apr 30, 1860; age 1y 1m 20d. (SW)

WILSON;

Leota, dau of B. B. & E.; d. Oct 5, 1860. (SW)
Emeline, dau of B. B. & E.; d. Jan 24, 1864; age 4d. (SW)
Emma, dau of B. B. & E.; d. Aug 14, 1868; age 1y 3m. (SW)
Samuel, b. in Mercer Co., Kentucky Oct 9, 1819; d. Sep 23, 1886;
age 66y 11m 14d. (SW)
Lucinda, wife of S.; d. Feb 13, 1898; age 73y 1m 22d. (SW)
Judge D., son of J. H. & R.; d. Dec 19, 1885; age 20y 11m 3d.
(SW)
James H.; Jun 11, 1826 - Jul 21, 1912. (SW)
Rebecca J., wife of James; Dec 13, 1832 - Feb 19, 1909. (SW)
Susie (See YOCUM).

YOCUM;

Rachael, dau of H. & M.; d. Feb 21, 1851; age 1y 1m 8d. (NW)
George; d. Dec 25, 1869; age 61y. (NW)
Susie Wilson, wife of S. W.; 1875 - 1922. (NW)
Sol W.; Jan 21, 1875 - Nov 16, 1948. (NW)
Sarah, dau of E. H. & M. M.; d. Sep 12, 1871; age 1y. (NW)
Infant; (No dates). (NW)
Silas G.; 1898 - 1934. (SW)
Abner E.; Apr 13, 1859 - Jan 5, 1936. (SW)
Lillie Gray, wife of Abner; Dec 14, 1863 - Sep 26, 1923. (SW)
Susanna, wife of S.; b. Oct 27, 1820; (no death date). (SW)
Solomon; d. Apr 5, 1893; age 83y 1m 19d. (SW)

Genealogical Notes - Upper Mound Cemetery

BYOUS: Philanda; d. Mar 1, 1884; age 44y; widow; b. in Ind.; re-
sident of Ill. 33 yrs; d. Mound Twp.

CRAWFORD: Laura (1863-1889), wife of John H.; daughter of Garret
Ackerson and Elizabeth (Kost) Cadwalader; Laura was a sister to
Henry L., Isaac L., and Ollie M. Cadwalader; her mother died in
1872.

DYER: Edward Dyer and Jane Kepple were the first couple to be
married in Mound Twp.; their wedding took place on Apr 17, 1838,
by a Methodist minister, Rev. John Richmond.

Mary, Edward, and George were children of Edward and Jane (Kepple)
Dyer; Mr. Dyer moved to this county in 1837 from Philadelphia, Pa;
he was born in Pa. in 1815; Mr. Dyer followed the trade as a
wheelright and owned a wagon shop in Macomb before moving to
Mound Twp.; the family lived on section 15; he later moved to the
city of Bushnell, then, to Bardolph, where he operated a hardware
business several years. Mr. & Mrs. Dyer were married April 1838;
they had 11 children, as follows: Jane Maria (Mrs. G. W. Amos);
Elizabeth (Mrs. N. H. Jackson); David; Margaret; Jacob, Susan;
Samuel; Edward; Mary Ann; George W.; and one that died in infancy.

FARR: Floy; d. Jul 12, 1880; age 2y 8m 20d; b. at Ipava; d. in
Mound Twp.

JAMES: Nancy S. (1801-1863), wife of William; lived in Putnam Co., Ind. before moving to this county; a daughter, Rebecca, married James H. Wilson.

KEPPLE: David (1815-1891) was born in Botetourt Co., Va.; son of Jacob; the family moved to the State of Tennessee, then in 1832, to this county; they lived in Mound Twp.; David and Anna (King) Kepple were married in this county on May 14, 1837; they lived on section 20, Mound Twp.; later on section 36; they also lived for a few years in Lamoine Twp. on a farm of Mr. King's. Mr. & Mrs. Kepple moved to the town of Bushnell in the early 1880's.

Ann (1816-1901), wife of David; daughter of Rev. James and Lydia (Tilton) King; the King family moved to this county from Jonesboro, Tenn. in 1835 and lived for several years near Hill's Grove; the family later moved to Walnut Grove Twp.; several members of this family are buried at the McMahill Cemetery in Warren County, Illinois. Ann was a sister to: Thomas, Richard Tilton, James, John W., and Clark King; and to Olethea (King) Tannehill.

Adda L. (d. 1866) was a daughter of James K. and Jane A. (Greene) Kepple; James was born in this county in 1838, a son of David Kepple; he and Miss Greene were married on Mar 24, 1859; they had the following children; Adda L.; Clara E.; Lucy Ann; Etta M.; Richard F.; Ollie J.; and Bessie.

KOST: Samuel; d. Jan 21, 1880; age 62y 11m 26d; merchant; b. in Pa.; resident of Ill. 31 years; d. at New Phila.

LANGSFORD: James Harvey (1818-1900), born in Nelson Co., Ky.; son of Nicholas and Sallie (Tichinor) Langsford; Nicholas was born in Plymouth, England and moved to this country at age 16 years; he later moved to Ky. and died there in 1838; his widow also died there in the 1840's. James moved to Adams Co., Ill. and lived there for several years; he married on Apr 20, 1843, to Narcissa Dunlap. In 1859, James and Narcissa Langsford moved to Mound Twp., this county and began farming on section 26; they had no children of their own, however, raised several in their home, including Samuel Ramage, Mary Carnes, and Narcissa Messick.

Narcissa W. (1819-1898), wife of James H.; daughter of Andrew & Rachel (Malone) Dunlap, natives of Ky.; the family moved to Adams Co., Ill. in 1841; the parents of Mrs. Langsford died in that county; after her marriage to James Langsford, Narcissa and her husband raised several children, including two of her sisters, Lizzie and Louisa J.

LEMASTER: Joseph F. (1847-1922), born in Sangamon Co., Ill.; son of Joseph and Sarah (Yocum) LeMaster; the family moved to this county in 1863; he farmed till his father's death in 1876, then he took over the father's store; Joseph married first to Jane A. Sheets, on Sep 8, 1870; they had 2 children; Ellis and John Everett; Jane died in 1876; Joseph then married on Sep 26, 1877 to Elizabeth Cullumber; there were no children by the second marriage.

LEMASTER: Elizabeth (1857-1881), second wife of Joseph F.; daughter of John and Drusilla Cullumber, of Mound Twp.; Joseph F. was postmaster at New Philadephia for a number of years.

Jane A. (1848-1874); first wife of Joseph F.; daughter of George W. and Margaret Sheets.

Joseph (1820-1876); moved to this county from Sangamon Co., Ill. in 1863; wife was the former Sarah Yocum; in 1864, Joseph and his son, James, moved to Oregon where they farmed for 3 years; they later lived in Marshall Co., Iowa and in Indiana, before returning to this county; Mr. LeMaster opened a general store in New Philadephia in about 1872 and operated it till his death.

Frances Elizabeth; d. Oct 28, 1881; age 24y 6m 28d; b. in Ohio; d. at New Philadephia.

George (1832-1901), born in Brazil, Ind.; married to Eliza J. Bosley; moved to this area in 1854, and first lived in Fulton Co.; moved to a farm 5 miles south of Bushnell in 1860; a son, Benjamin E., born in 1877, later became physician and lived in Bushnell.

MAKINSON: George W. was born in Belmont Co., Ohio on Feb 25, 1843; enlisted in the army in 1861, and after 3 months service was discharged because of failing health; he later re-enlisted, in 1862, and served throughout the war; he later taught school and worked for a rail service; married on Apr 10, 1869, to Alice Baughman; they had 3 children.

MC DONALD: John; d. Feb 15, 1884; age 3y 9m; b. & d. in Mound Twp.; died of scarlet fever.

MC DONOUGH: Redman (1813-1879), born in Warren Co., Ohio; md. Sarah Fox in Warren Co., and moved to this county in 1847; was a resident of this county 33 years; lived on the "Randolph" farm, 2 miles north of Macomb for a short time; then bought a farm in Macomb Twp.; later moved to the Bushnell area, where he died in 1879. Children of Redman and Sarah McDonough were: Rachael A. (Mrs. Jacob Spangler); Charles; Thomas; John W.; Jemima; and Mary E. (Mrs. John Bricker).

Sarah (1817-1888), wife of Redman McDonough; daughter of Charles and Rachel (Squire) Fox; born in Warren Co., Ohio; her father died in 1823; Sarah was raised by an uncle, David Fox, in Ohio. Married Mr. McDonough in about 1837 and moved to this county in 1847. Sarah was a sister to Thomas, Rebecca, Absalom, and Charles Fox. Her brother, Thomas, and his wife and children, later moved to this county and lived in and around Macomb for several years. He died in Macomb in 1906. Sarah's death notice, in part, from The Macomb Journal, Feb 2, 1888: "Mrs. Redmon McDonough died at her residence in Bushnell last Friday and was buried Saturday, aged 3 score years and 10. Her husband is also deceased. She was the mother of Thos. McDonough, now of Keokuk and of Prof.

MC DONOUGH: Sarah (cont'd)
C. F. McDonough of Altona."

Willie (d. 1872) was a son of John W. and Rosa A. McDonough; this family appears on the local 1880 census and were living in Bushnell Twp.; the household consisted of: John, age 37; Rosa, 32; Ella, 12; and Charles, 7.

MC MANIMIE: Winchester Wayne; d. Jul 3, 1922; aged 84y 7m 19d; b. Nov 14, 1837 at Green Co., Ind; son of Nelson & A. (Stevenson) McManimie; W. W. McManimie was a retired mason and died at Prairie City. Winchester McManimie enlisted in the army at Bushnell on Oct 1, 1861; served with Co G 50th Ill Inf. till mustered out on Sep 27, 1864. Also serving in the same unit, also enlisted at Bushnell, was Marion A. McManimie.

MINOR: Ella; d. Mar 9, 1884; age 5y 21d; b. & d. New Phila; died of scarlet fever.

MITCHELL: Jennie Ardel; d. Sep 3, 1879; age 7m 25d; b. Winchester, Scott Co., Ill.; d. at Bardolph.

PURMAN/PERMAN: William (1819-1864), was living in Macomb Twp. in 1880; at that time his age was 61, and the following persons were living in the Purman household: Ellen, age 40; Mary M., 17; George S., 13; David C., 10; Fielding, 7; and Charles B., 5. William operated a blacksmith shop in Bardolph during the late 1870's; was the husband of Mary C. (Sheets) Purman, and father of John W. (d. 1862), and the infant (d. 1861), enlisted in the army at Macomb on Aug 14, 1862; served with Co H, 119th Ill Inf till discharge on Aug 26, 1865.

SCOTT: John (Death notice, in part, from The Macomb Eagle, Dec 4, 1880): "Died at his residence in Prairie City on Nov 29th, Dr. John Scott, aged 90 years 4 months. He was a native of Mass. and moved to Illinois in 1833."

SHEETS: George R., father of the twins, Orrin and Oscar, and John H., enlisted in the army at Bushnell on Mar 28, 1864; served with Co D 124th Ill Inf and the 33rd Ill Inf; mustered out on Nov 24, 1865.

Henry W. (1835-1911), son of George W. Sheets; born in Clarion Co., Pa.; moved with the family to this county in 1840; married in 1857, to Mary Dunkle; they had 7 children; Henry Sheets operated a general store in New Phila. for several years.

SLATER: Victoria and John were children of John and Esther (Butterworth) Slater; Mr. Slater was born in England in 1826, a son of Jonathan and Anna (Taylor) Slater; John moved to this country in 1851 and lived in New Jersey and in Whitneyville, Mass. before moving to Canton, Ill. in 1865; he and Miss Butterworth were md. in England on Jun 14, 1851; they had 6 children: Victoria, John,

SLATER: (cont'd)

Edmund T., Mary H. T., Sarah E., and Adaline. In about 1869, the family moved to a farm near New Phila.

SMITH: Thos. and Mary (Barber) were married in this county on Feb 7, 1838.

SNAPP: James Nelson (d. 1858) was a son of Alex and Barbara (Arthur) Snapp; the family lived in Mercer Co., Mo. and in Walnut Grove Twp., this county. Alex and Barbara were married on Jan 1, 1856; they had 9 children: James N.; John Henry; Elizabeth; Clara; Mary Ann (Mrs. Moses Gallahue); Marion; Nora May; Clara Ellen; and Franklin. Three of the children died young; two are buried in the Pearce Cemetery in Walnut Grove Twp.; Mr. and Mrs. Snapp are buried at the Good Hope Cemetery.

SPEAR: James T., father of Laura E. (d. 1864) enlisted in the army at Bushnell on May 24, 1861; served with Co A 16th Ill Inf.

WILSON: James H. (1826-1912), son of Samuel and Ann (Boyle) Wilson; James was born in Mercer Co., Ky. and moved with the family to Putnam Co., Ind. in about 1828; married on Oct 4, 1849, to Rebecca James; they moved to Fulton Co., Ill. and lived near Table Grove about 3 years; they moved to near Bushnell; they had the following children: a son, born in 1850; Mary Jane (1853); Joseph A. (1855); Lewis L. (1858); Peneta J. (1860); Mariam J. (1862); Judge D. (1865); Delana E. (1867); Louie E. (1870).

B. B., father of several children buried at this cemetery, was a brother to James H.

Rebecca (1832-1909), wife of James H.; daughter of William and Nancy James; she was born in Crawfordville, Ind.; moved with her family to Putnam Co., Ind.; her parents later moved to this county; her father died at age 77; her mother died in Bushnell in 1863.

YOCUM: Lillie Eulilia; d. Sep 26, 1923 at Prairie City; aged 59y 10m 12d; b. Dec 14, 1863 in Fulton Co., Ill.; dau of James & Jane (Kimble) Gray; James native of Ohio; Jane b. in England; Lillie married Abner Yocum.

Susie; d. Jan 1, 1922; age 46y 1m 10d; b. Nov 22, 1875 in Mo.; daughter of John & Jane (Yocum) Wilson; John, a native of Ind; Jane, from Ky.

Jarilda Jane; d. Feb 21, 1922; age 78y 7m 5d; b. Jan 16, 1844 at Montgomery Co. (Ill. ?); daughter of Solomon & Susan (Hensley) Yocum, native of Ky.; widow.

Notes, Corrections, Additions, and Changes